

BALDWIN®

Single & Double Cylinder with Escutcheon Plate Installation Instructions

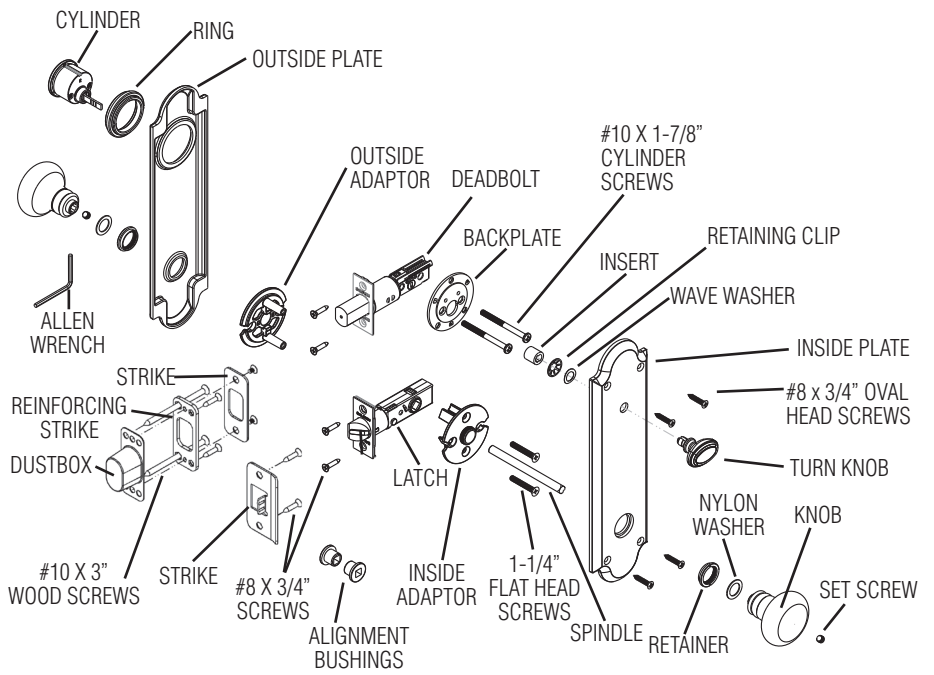

DOOR PREPARATION: LATCH, DEADBOLT & MOUNTING HOLES

ADJUSTING DEADBOLT BACKSET

1. Fold template on scored line and locate, using the bottom 2-1/8" bore, at desired height (about 40" from floor). Place folded edge on low side of door bevel. Mark hole locations on the door for appropriate backset & plate style.

2. **Caution: Re-check bore hole locations before drilling.** Drill the 2-1/8" Face Bore through the door first. Drill the 1" diameter Edge Bore through to the inside of the 2-1/8" Face Bore.

3. Insert the latch & deadbolt into the edge of the door. Trace an outline of the faceplate onto the door edge. Mark screw hole center locations and drill 1/8" pilot holes.

4. Remove latch & deadbolt and chisel out both areas marked in Step 3 to a depth of 5/32" or until the faceplates are flush with door edge.

5. Prior to drilling the 3/32" holes, align knob/lever hole on inside plate with lower 2-1/8" face bore and temporarily place over the template. Ensure the correct hole locations were marked in Step 1.

6. Using a 3/32" drill bit, drill the mounting holes 3/4" deep at the locations previously marked in Step 1.

The deadbolt supplied with this unit has an adjustable backset feature. It will be set at 2-3/8" backset. To adjust to 2-3/4" backset, grasp body and twist faceplate/bolthead assembly 180° until it stops. Unit is now ready for installation in a 2-3/4" backset configuration.

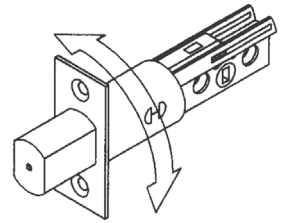
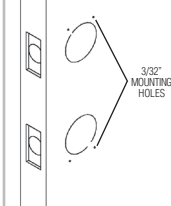
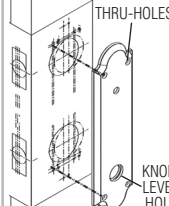
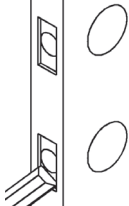
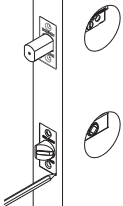
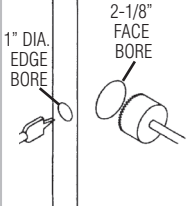
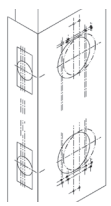

STRIKE PREPARATION – LATCH

STRIKE PREPARATION – DEADBOLT

1. Using the strike portion of the marking template, locate and mark strike mounting screws and centering points for your door thickness.

2. Align the strike and trace outline onto the door frame using mounting screw marks for location.

3. At the screw marks, drill (2) 1/8" dia. pilot holes for the screws. Bore 7/8" dia. X 3/4" deep hole.

4. Chisel out the area marked in step 2 to a depth of 1/16" or until strike is flush with door frame.

Install strike using (2) #8 Flat Head combination screws.

1. Close door and extend deadbolt several times. Deadbolt center will leave mark on door frame. If mark is not present, rub chalk on deadbolt center and repeat.

Position strike on center mark. Trace outside of strike and mounting holes.

2. Position the reinforcing strike and mark locations for reinforcing screws.

Drill (2) 5/32" pilot holes for 3" long screws and (2) 1/8" pilot holes for #8 x 3/4" long screws. Mark drill points 5/16" above and below centering point. Bore (2) 1" dia. holes x 1-1/4" deep. Chisel out holes for dust box.

3. Chisel out area 7/32" deep or until all strikes are flush with the door frame.

Install strike as illustrated.

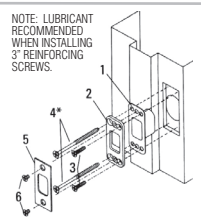
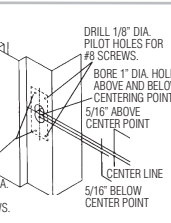
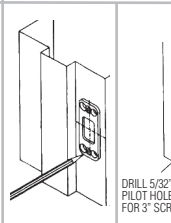
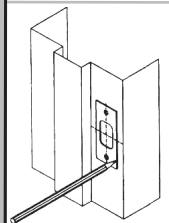
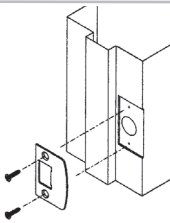
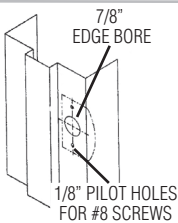
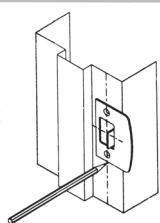
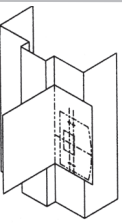

SINGLE CYLINDER INSTALLATION

1. a. With backset marking facing up, grasp the latch faceplate and rotate to assure bevel side of latchbolt faces jamb.

b. Deadbolt should be thrown prior to installation. Slide the latch & deadbolt into the door as shown. Secure with (2) #8 x 3/4" screws per each component.

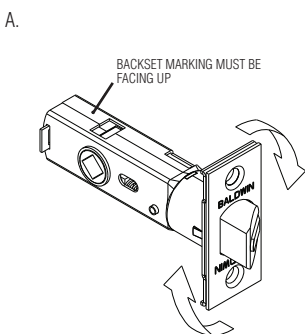

2. Install both adaptors onto door and insert (2) 1-1/4" Flat Head Screws into inside adaptor. The inside adaptor will have thru-holes and countersinks for the screws. Do not fully tighten at this time.

3. Insert the spindle into the latch with the ends protruding from both adaptors. Slide the alignment bushings onto the spindle ends and into the adaptors. Tighten the screws and remove the alignment bushings.

4. Place the outside rose onto the adaptor and thread on retainer using the spanner tool.

Do not fully tighten.

5. Insert the cylinder into outside ring. Slide the cylinder tailpiece into deadbolt and place cylinder & ring into outside plate. Place backplate against door & secure with (2) #10 screws.

6. Place interior plate subassembly onto door, inserting the cylinder tailpiece into back of the turnpiece. Thread retainer onto adaptor. Do not fully tighten. Install #8 oval head screws into door. Do not fully tighten.

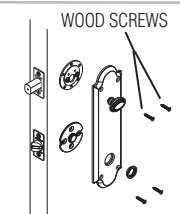
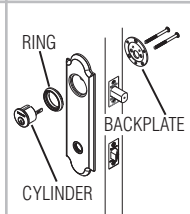
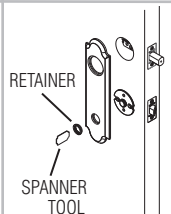
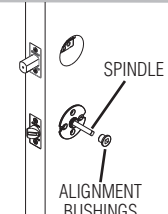
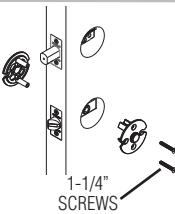
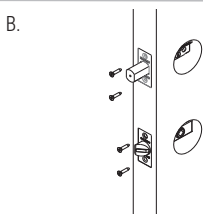

SINGLE CYLINDER INSTALLATION – CONTINUED

7. Rotate turnpiece to check operation of deadbolt.

Tighten all screws and retainers.

Rotate turnpiece again to check operation of deadbolt.

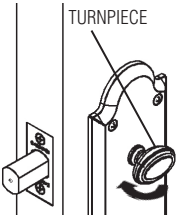

8. Insert the spindle into a knob or lever. Align scribed mark with correct door thickness and secure with set screw.

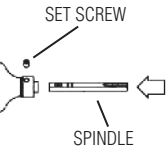
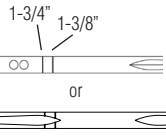

9. Slide a nylon washer onto the base of both knobs or levers. Slide the spindle with the previously attached knob or lever into the latch with the set screw pointed down and toward the hinges of the door. Secure the other knob or lever to the exposed spindle end.

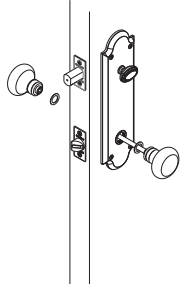

DOUBLE CYLINDER INSTALLATION

Follow Steps #1 through #4 in the Single Cylinder Installation section before proceeding to Step # 1.

DOUBLE CYLINDER INSTALLATION

1. a. Carefully break off cylinder tailpiece at required mark for your door thickness.

Caution: Use (2) pairs of pliers as shown or tailpiece will be damaged.

b. Align tailpiece with slot. Keep tailpiece vertical and curved toward right side of hole as illustrated.

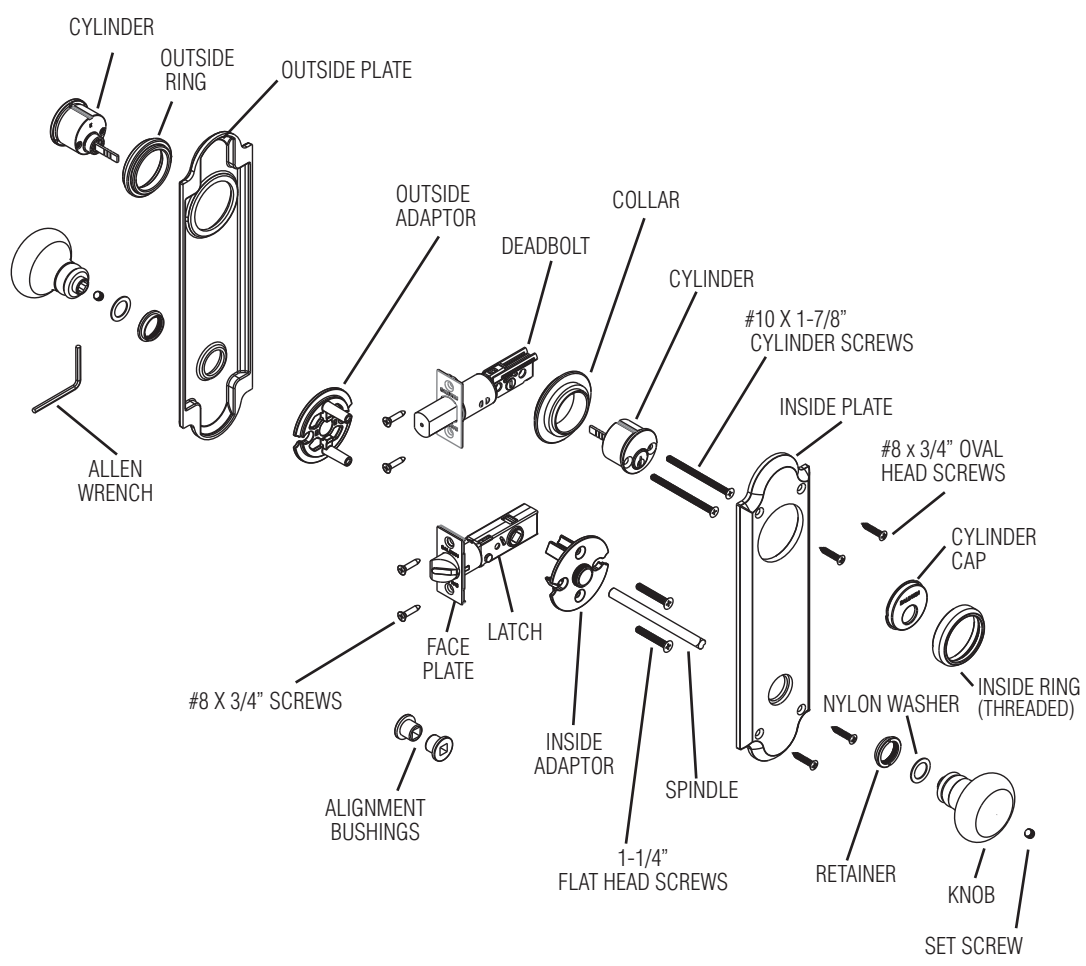
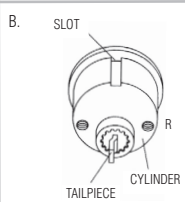
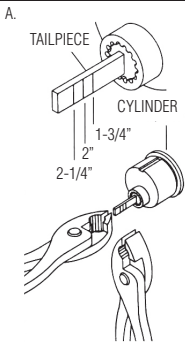

DOUBLE CYLINDER INSTALLATION – CONTINUED

2. Insert the cylinder into ring. Slide the cylinder tailpiece into the deadbolt and place cylinder & ring into outside plate.

Keeping tailpiece vertical and curved toward right side of the hole, insert inside cylinder with threaded collar into the deadbolt.

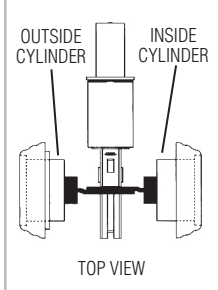
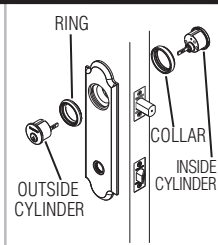

3. Insert (2) #10 screws through inside cylinder and thread into outside cylinder. Place cylinder cap over inside cylinder and secure with inside cylinder ring.

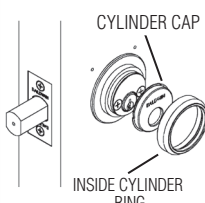

4. Place interior plate onto door. Thread retainer onto adaptor. Do not fully tighten. Install #8 oval head screws into door. Do not fully tighten.

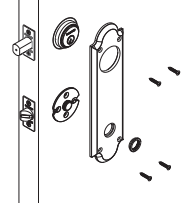

5. Insert key to check operation of deadbolt. Tighten all screws and retainers. Rotate key again to check operation of deadbolt.

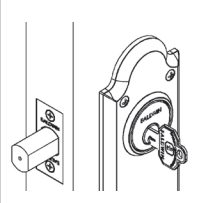

6. Insert the spindle into a knob or lever. Align scribed mark with correct door thickness and secure with set screw.

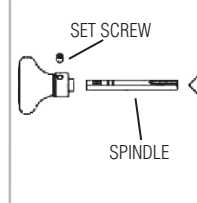
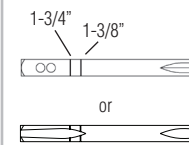

7. Slide a nylon washer onto the base of both knobs or levers. Slide the spindle with the previously attached knob or lever into the latch with the set screw pointed down and toward the hinges of the door. Secure the other knob or lever to the exposed spindle end.

