



# ASSEMBLY INSTRUCTIONS FOR 9943 SERIES GAS BARBECUE GRILL

## ASSEMBLER/INSTALLER:

LEAVE THESE INSTRUCTIONS WITH THE CONSUMER.

## CONSUMER/USER:

READ ALL THESE INSTRUCTIONS AND KEEP THEM IN A SAFE PLACE FOR FUTURE REFERENCE.

## WARNING:

THE EDGES OF SHEET METAL PARTS CAN CAUSE INJURY IF NOT HANDLED WITH CARE.  
**USE EXTREME CAUTION!**

## IMPORTANT!

TO ENSURE PROPER GAS FLOW, BURNER CONTROL VALVES **MUST** BE "OFF" **BEFORE** OPENING THE GAS CYLINDER VALVE.

9943-054 (04/26/02)

**LOOK INSIDE FOR:**  
Easy Assembly Instructions  
Repair Parts List  
Safety, Maintenance  
and Cleaning Tips

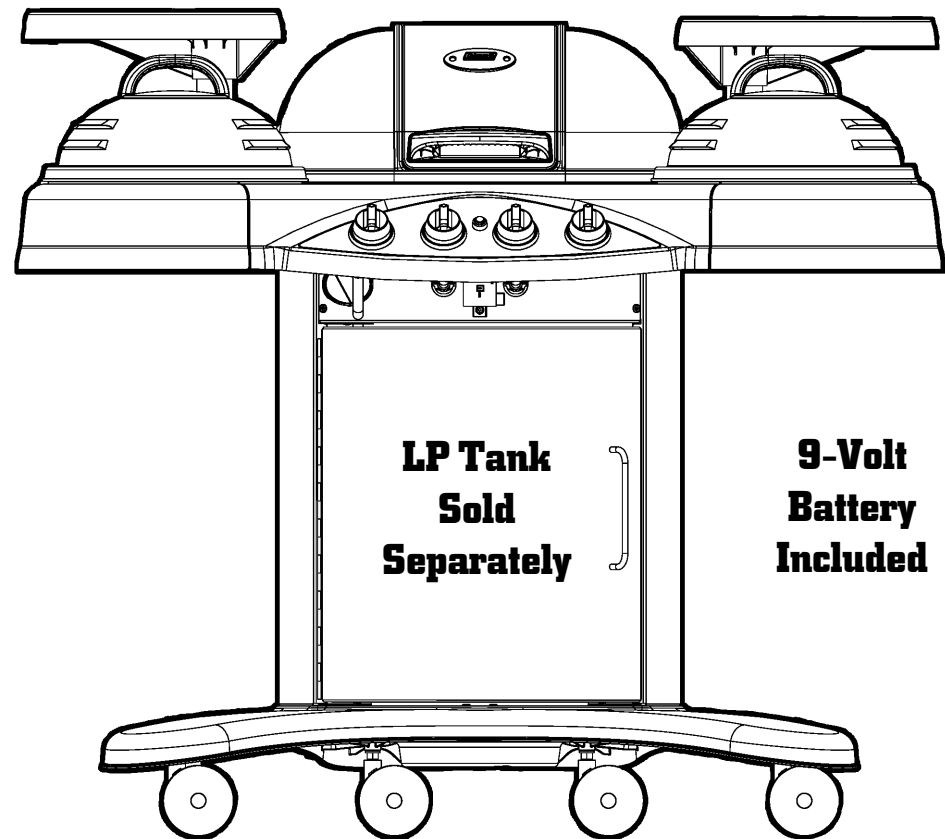

## **⚠ WARNING**

Combustion by-products produced when using this product contain chemicals known to the State of California to cause cancer, birth defects, or other reproductive harm.

Coleman Company, Inc.  
3600 N. Hydraulic  
Wichita, KS 67219  
Internet site:  
[www.coleman.com](http://www.coleman.com)  
1-800-356-3612  
TDD: 316-832-8707

# **TORX BIT SOCKET INCLUDED**

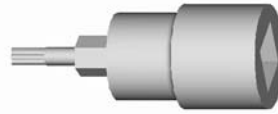

⇒ #T-20, 3/8" Square Drive Torx Bit Socket

## **ADDITIONAL TOOLS NEEDED:**

- ⇒ #2 Phillips Screwdriver
- ⇒ 3/8", 7/16" and 11/16" Open End Wrenchs
- ⇒ 3/8" Square Drive Ratchet Wrench
- ⇒ 3/8" Square Drive Extension

## **OPTIONAL TOOLS:**

- ⇒ Electric or Cordless Screwdriver
- ⇒ #2 Phillips driver bit
- ⇒ #T-20 6-Lobe Screwdriver

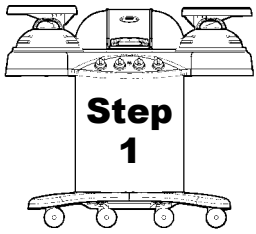

- ⇒ Assemble the Electrode to the Left Burner Casting per illustration (1-A).
- ⇒ Assemble the Electrode to the Right Burner Casting illustration (1-B).

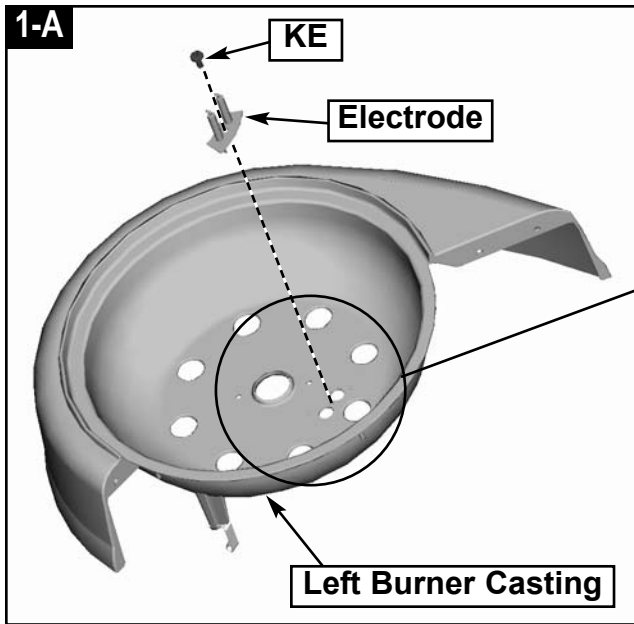

1-A. Assemble the Electrode to the Left Burner Casting using one self-tapping screw (KE).  
 ⇒ Tighten all fasteners.

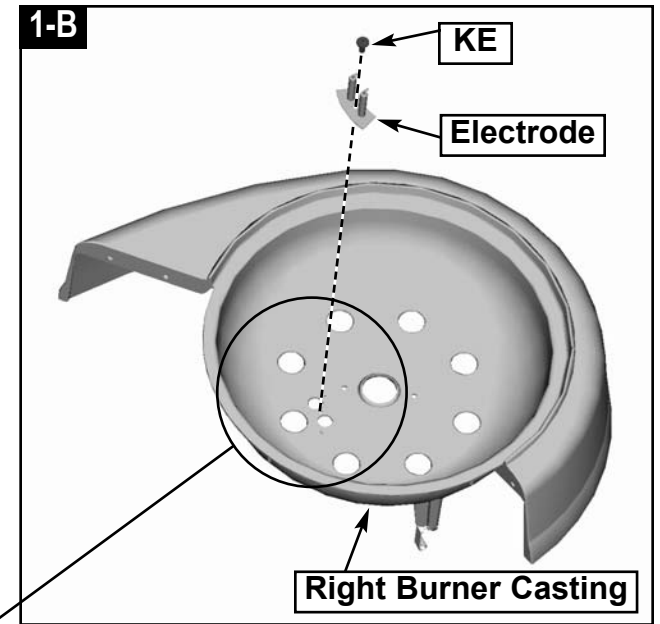
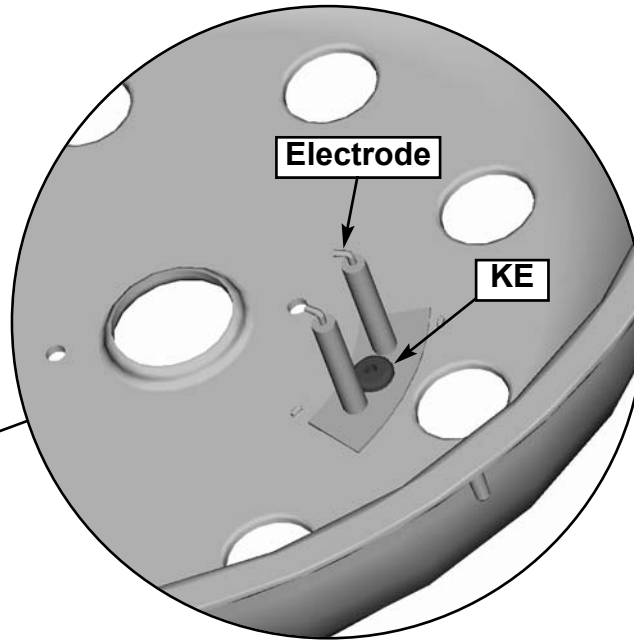

1-B. Assemble the Electrode to the Right Burner Casting using one self-tapping screw (KE).  
 ⇒ Tighten all fasteners.

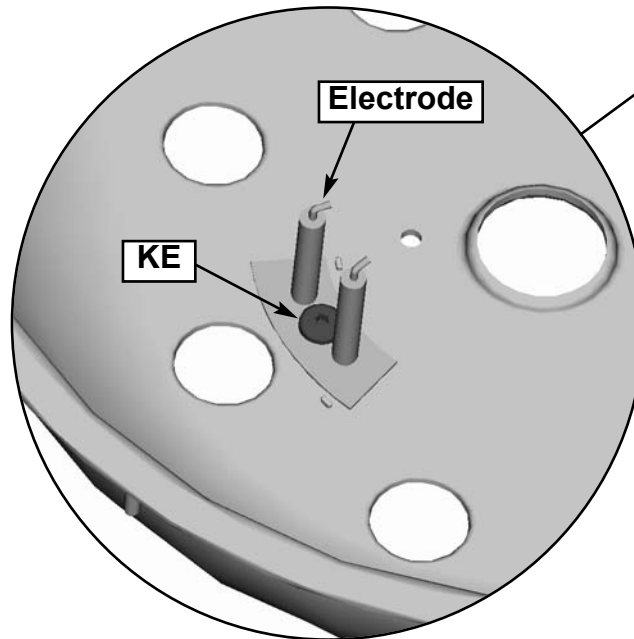

**Hardware shown actual size**

(KE)  
 #6-32 x 3/8 Self-tapping Screw  
 (2) Qty.

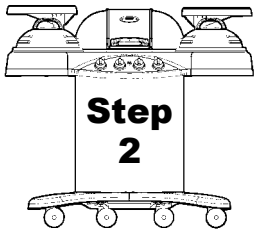

- ⇒ **NOTE:** The grill is upside-down during this assembly step.
- ⇒ Assemble the CONSOLE CASTINGS.
- ⇒ Use a large piece of cardboard or a ground cloth to protect the painted finish on the castings.
- ⇒ Lay all three castings on a level surface with the top (smooth) surface downward.

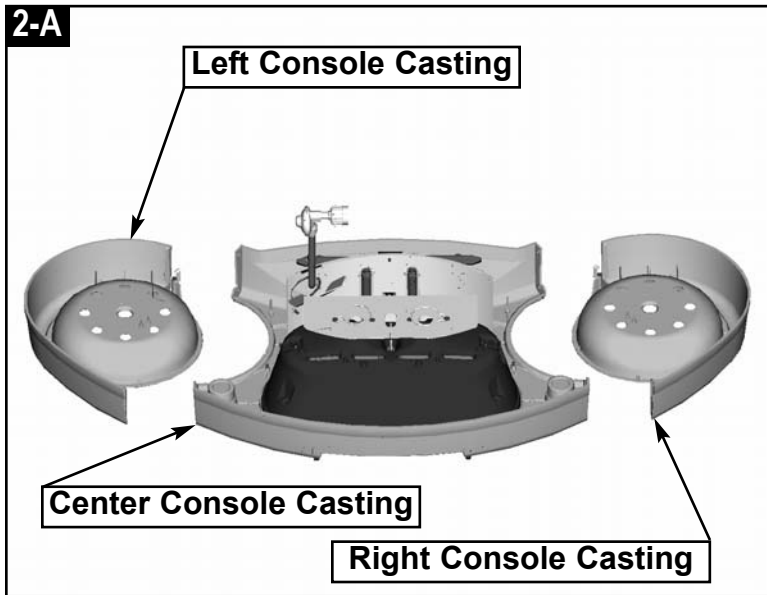
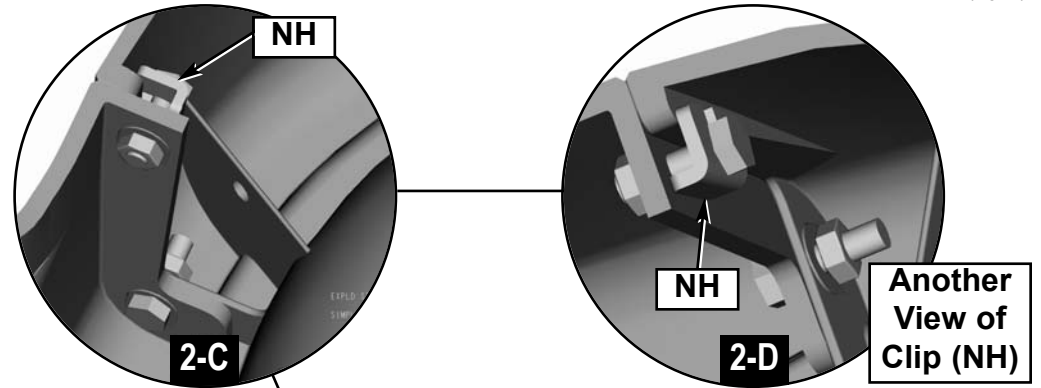

2-A. Lay all three castings on a level surface with the smooth (top) surface downward.

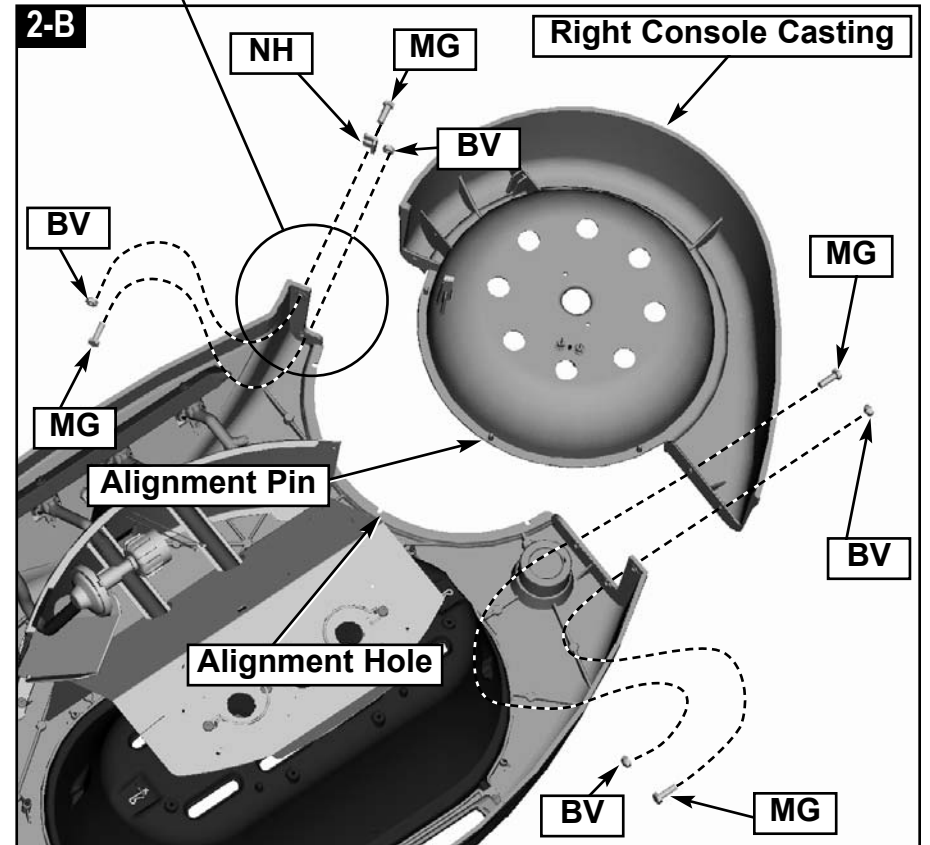
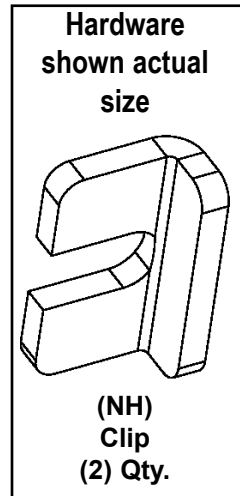

2-B. Assemble the Right Console Casting to the Center Console Casting. Three Alignment Pins mate with three Alignment Holes in castings. Fasten with four SCREWS (MG) and four HEX NUTS (BV) and one Clip (NH). See Detail 2-C and Detail 2-D for location of Clip (NH). Tighten the fasteners.

- ⇒ Repeat Step 2-B to assemble the Left Console Casting to the Center Console Casting.

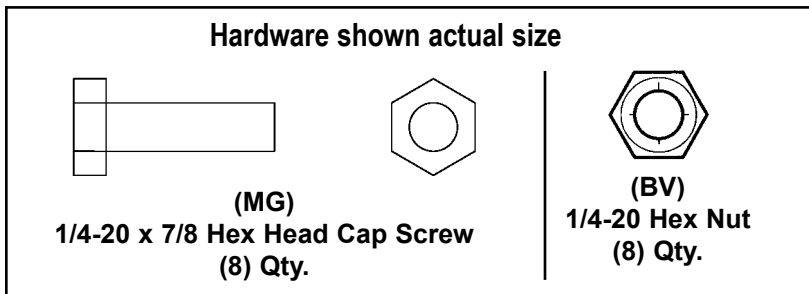

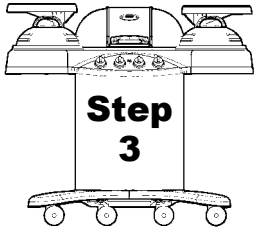

- ⇒ **NOTE:** The grill is upside-down during this assembly step.
- ⇒ Assemble the Tool Rack to the console.
- ⇒ Assemble the Towel Rack to the console.

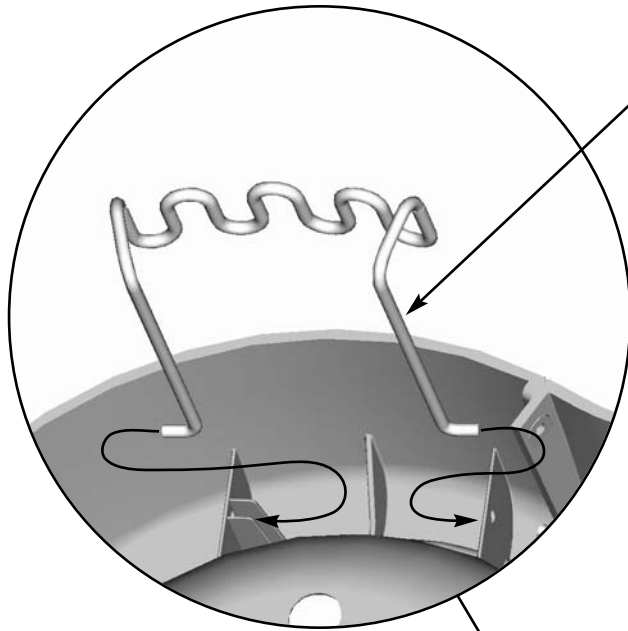

**Squeeze the Tool Rack to slip into the mounting holes.**

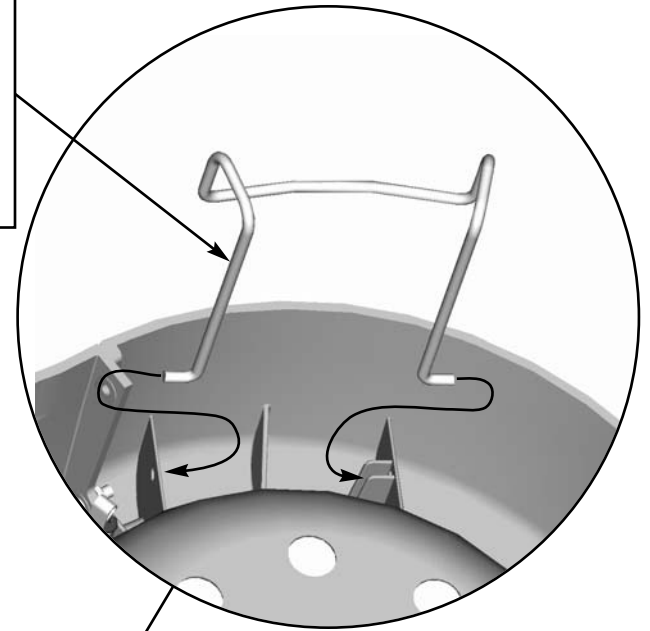

**Squeeze the Towel Rack to slip into the mounting holes.**

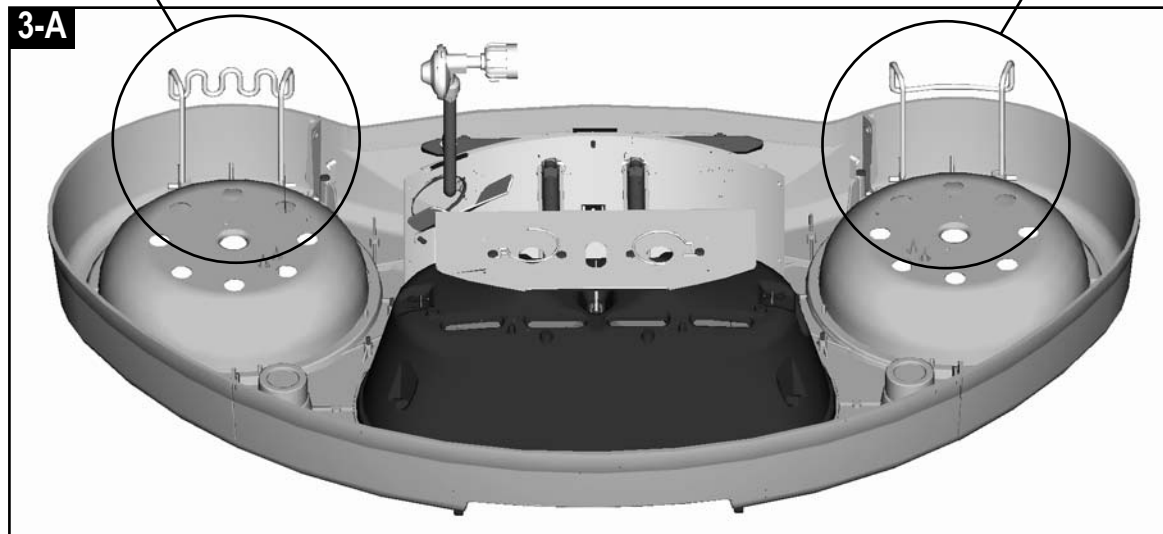

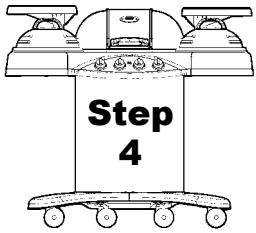

- ⇒ **NOTE:** The grill is upside-down during this assembly step.
- ⇒ Assemble the 9-VOLT BATTERY to the ELECTRODE MODULE.
- ⇒ Attach two wires (27" long) from the ELECTRODE MODULE labeled **LB1** and **LB2** to the LEFT BURNER (thread thru wire clip).
- ⇒ Attach two wires (27" long) from the ELECTRODE MODULE labeled **RB1** and **RB2** to the RIGHT BURNER.
- ⇒ Verify that two wires are attached from the MAIN BURNER to the ELECTRODE MODULE labeled **MB1** and **MB2** (factory installed).
- ⇒ Verify that two wires are attached from the IGNITER BUTTON to the ELECTRODE MODULE on the left side (factory installed).

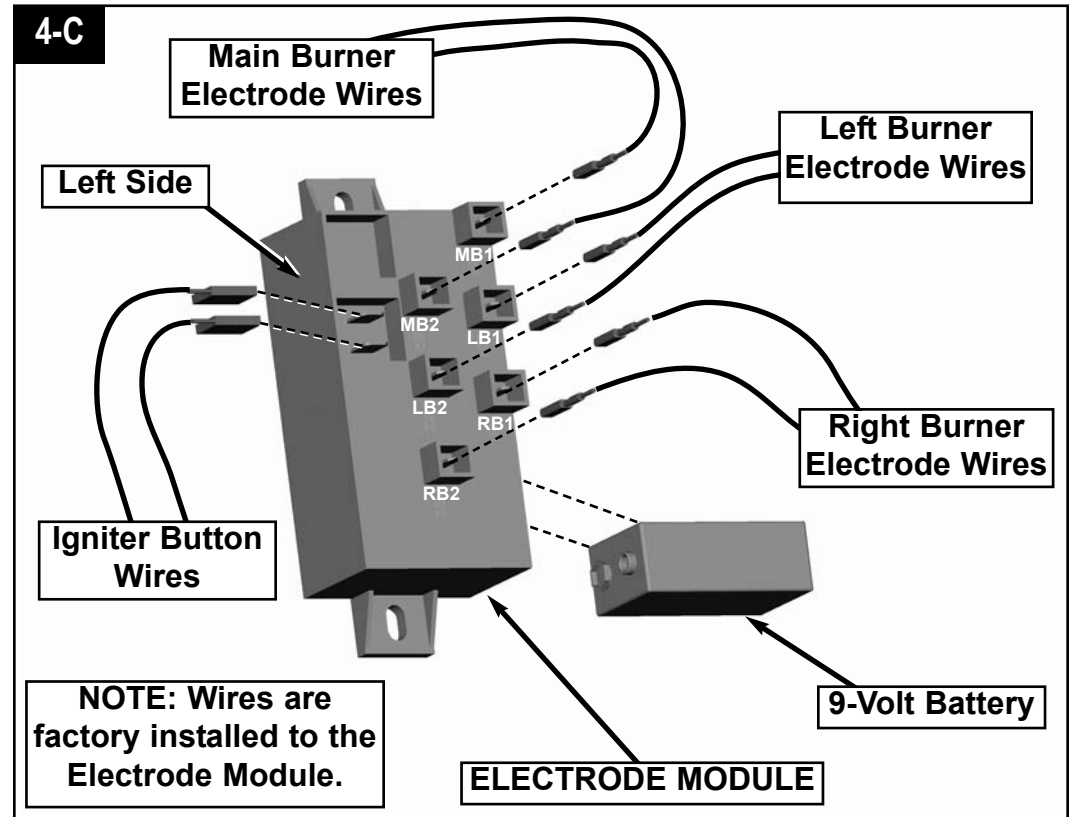
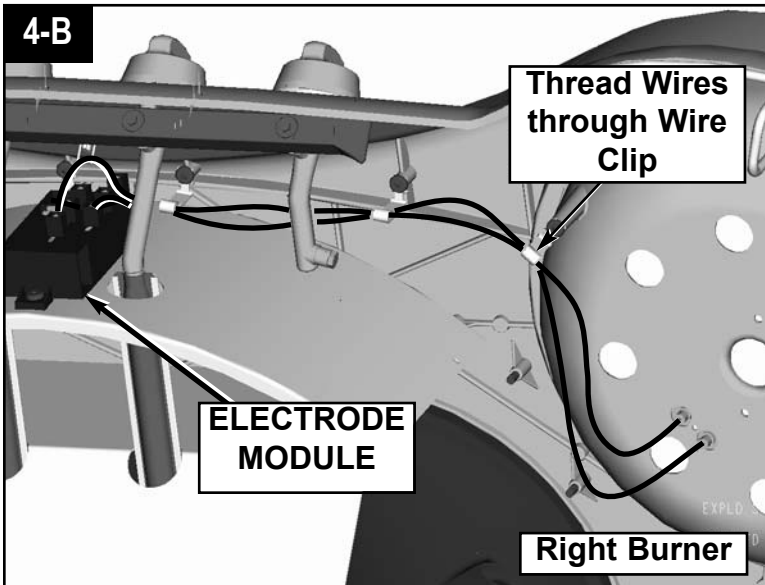
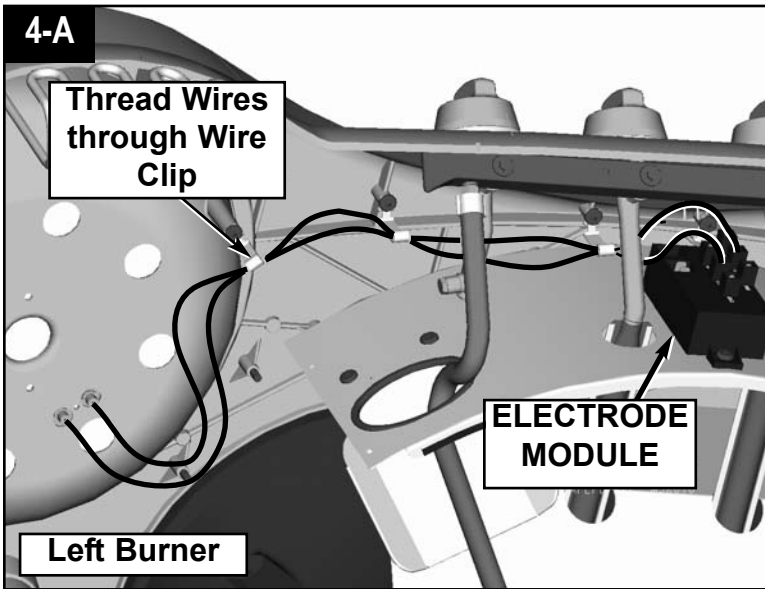

**⚠ Caution:** Insure that the wires **DO NOT** touch hot surfaces such as the grill casting!

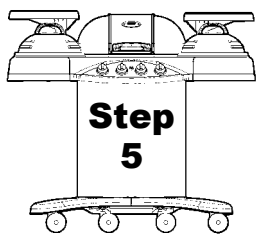

⇒ Assemble the PEDESTAL PANELS.

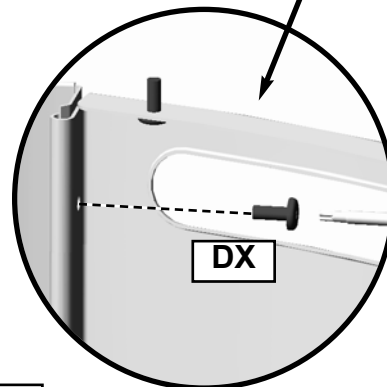
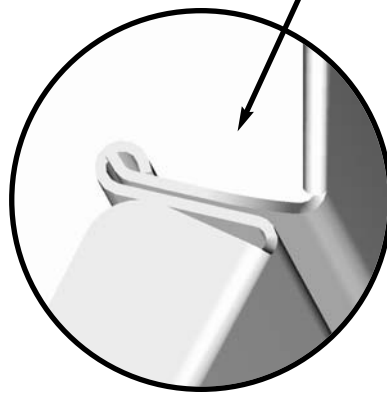
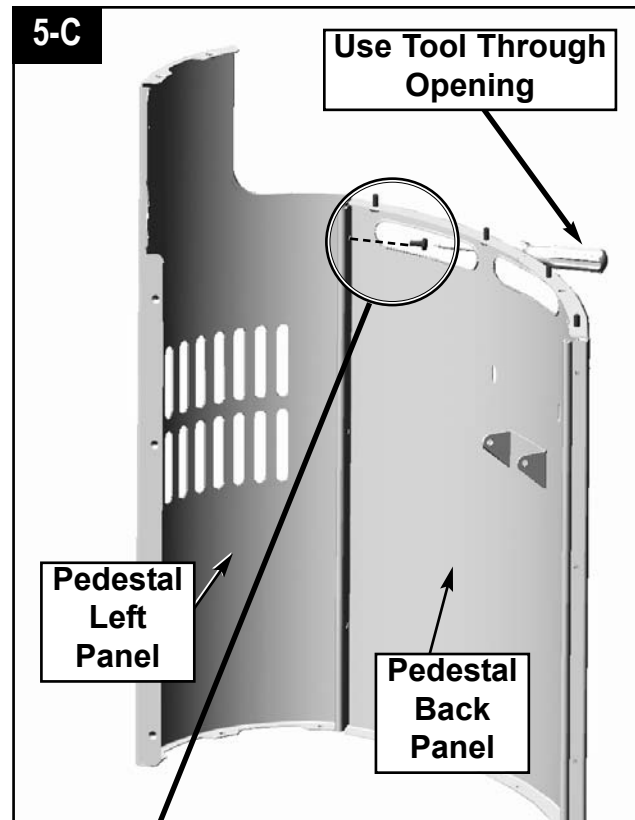
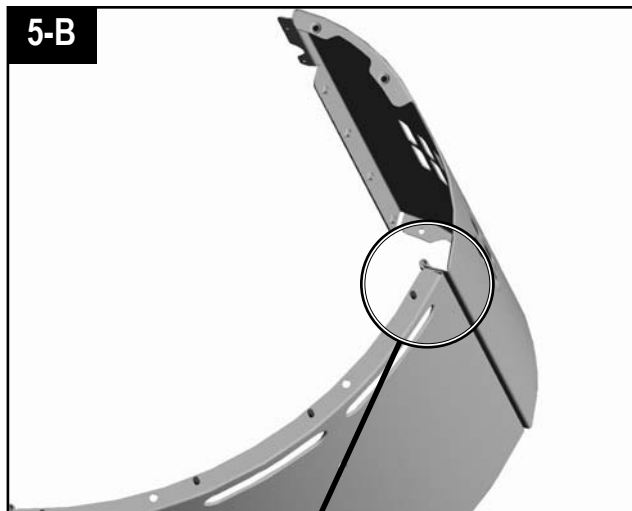
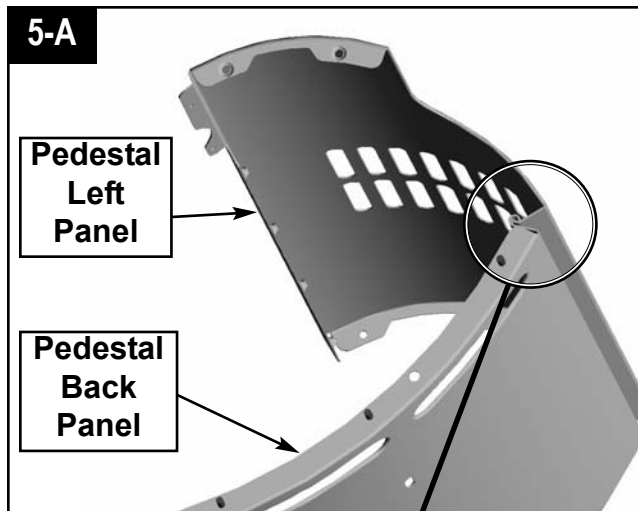
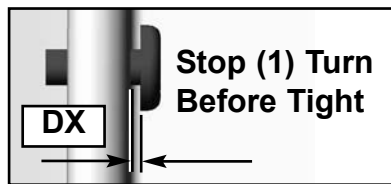

**5-A.** Assemble the PEDESTAL LEFT PANEL to the PEDESTAL BACK PANEL.  
 ⇒ Insert the flat lip of the PEDESTAL LEFT PANEL into the curled lip of the PEDESTAL BACK PANEL, taking care to align the bolt holes.

**Hardware shown actual size**

**(DX)**  
**#10-24 x 1/2 Self-tapping Screw**  
**(2) Qty. Per Side Panel**

**5-C.** LOOSELY fasten together with one SCREW (DX). One at top only.  
 ⇒ **NOTE:** You will tighten this screw **LATER**, after the panels are fastened to the grill console in Step **8-B** (this helps with alignment).  
 ⇒ Repeat Step 5 to assemble the **RIGHT PANEL**.

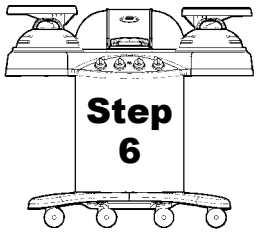

⇒ Assemble PROPANE TANK RETAINER WIRE to the Pedestal Back Panel.

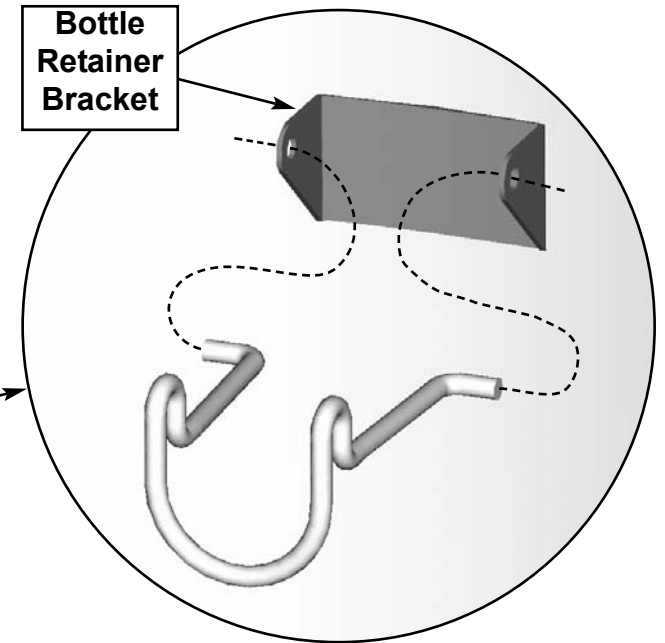
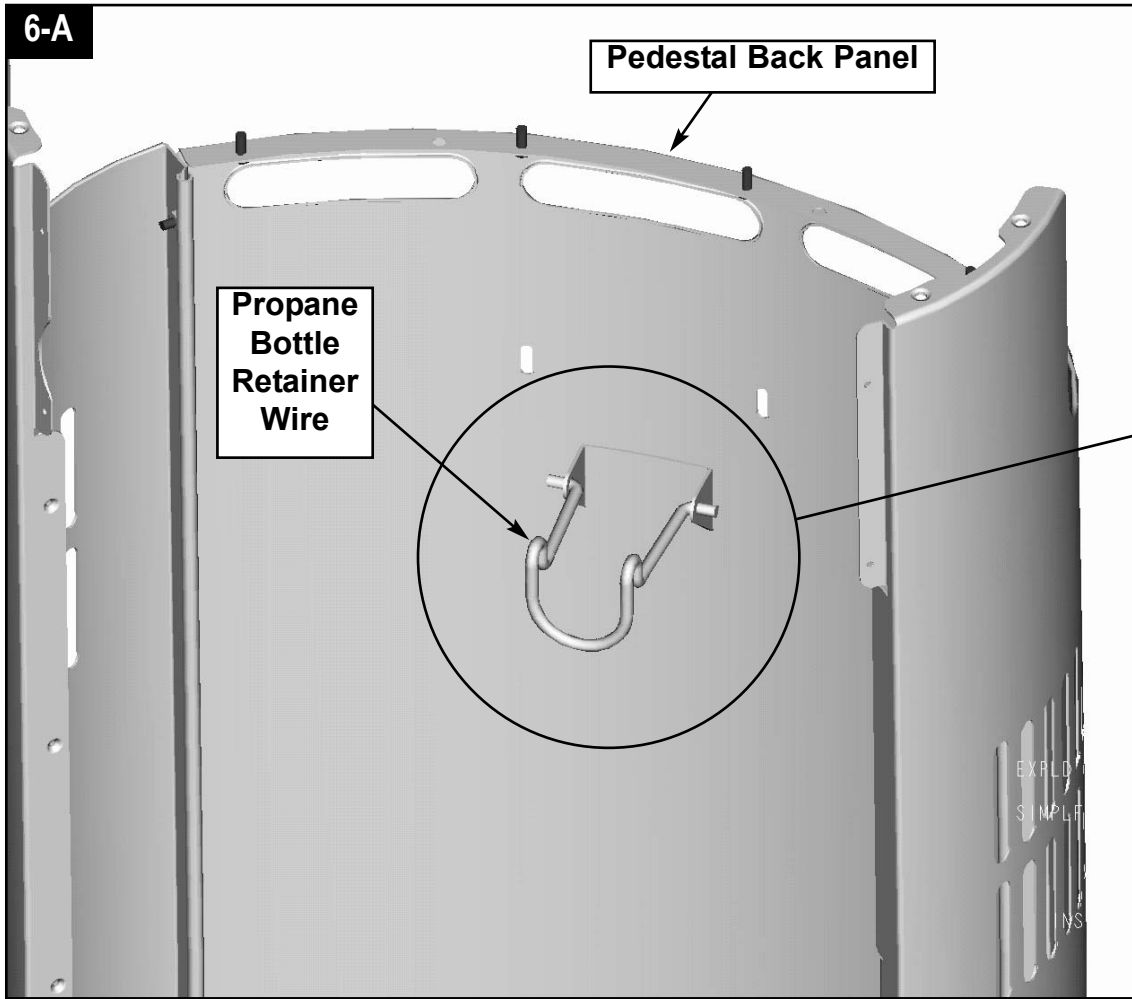

**6-A.** Assemble Propane Bottle Retainer Wire to the Pedestal Back Panel.

⇒ Squeeze the Wire and insert into Bottle Retainer Bracket on Pedestal Back Panel.



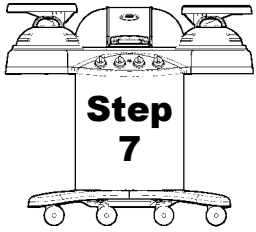

- ⇒ **NOTE:** The grill is upside-down during this assembly step.
- ⇒ Place the PEDESTAL onto the CONSOLE.

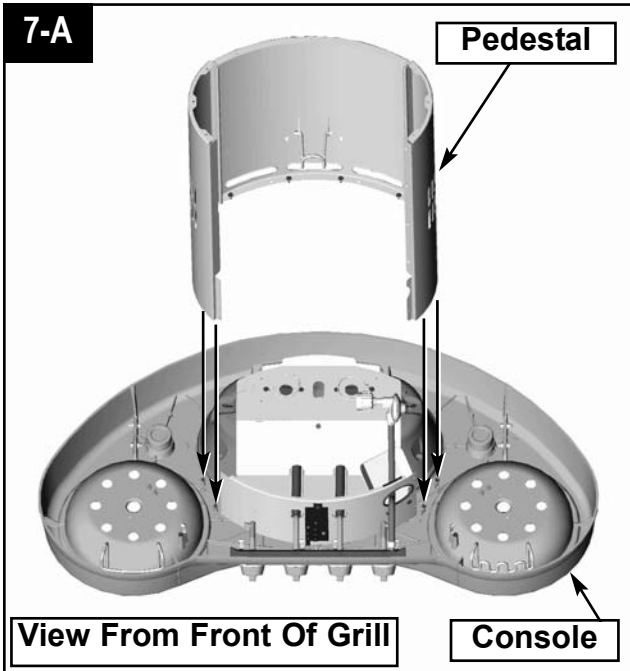

- 7-A. Place the PEDESTAL onto the CONSOLE.
- ⇒ Align the studs and pins with the assembly holes.

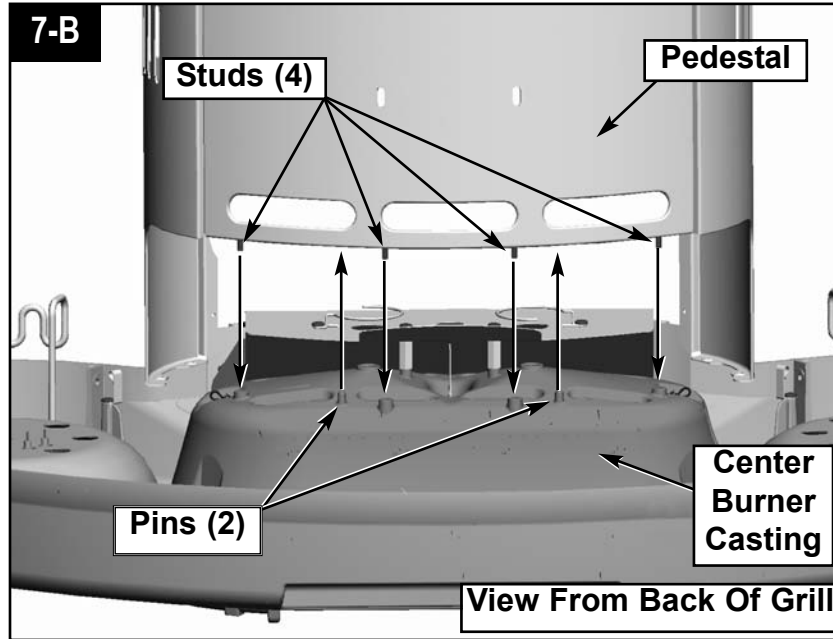

- 7-B. Align four studs with holes in the Center Burner Casting.
- ⇒ Align two pins (part of the casting) with two holes in the Pedestal.

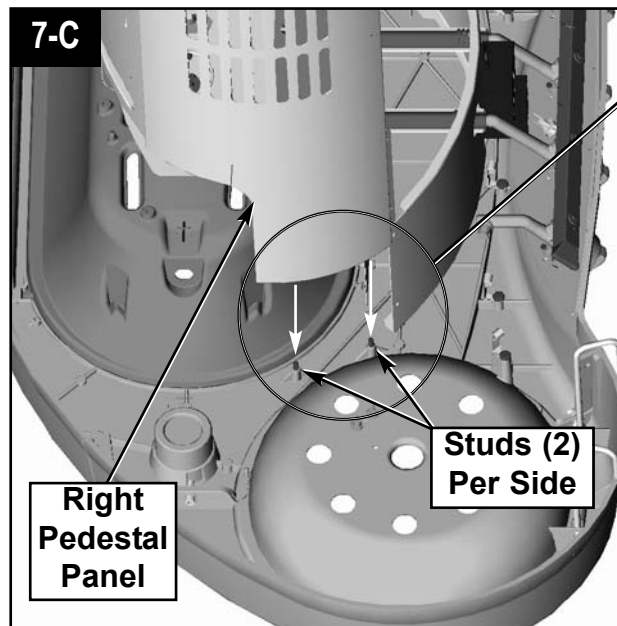
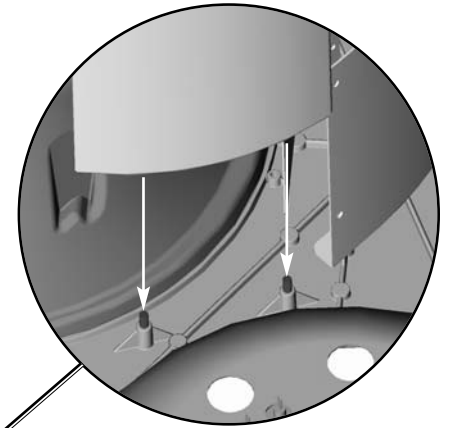

- 7-C. Align two studs with holes in the **right** pedestal panel (shown).
- ⇒ Align two studs with holes in the **left** pedestal panel on the opposite side (not shown).

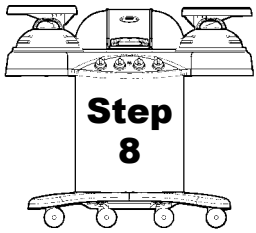

- ⇒ **NOTE:** The grill is upside-down during this assembly step.
- ⇒ Fasten the PEDESTAL to the CONSOLE per Step (8-A).
- ⇒ Tighten and secure the Pedestal Panel Fasteners per Step (8-B).

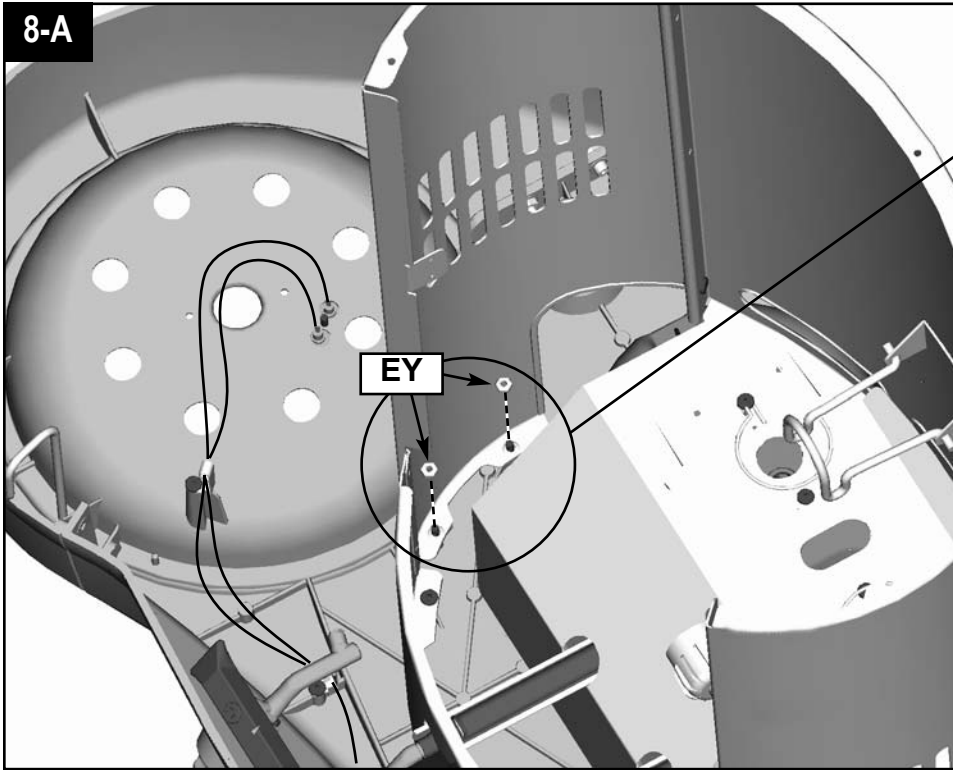

**8-A.** Assemble four HEX NUTS (EY), one on each stud that protrudes up from the casting into the pedestal (they can be reached through the front door opening).

- ⇒ Assemble two on the **right** pedestal panel (shown in Illustration 7-C and 8-A), and two on the **left** pedestal panel (not shown).
- ⇒ Tighten all fasteners.

**Hardware shown actual size**

(EY)  
#10-24 Hex Nut  
(6) Qty.

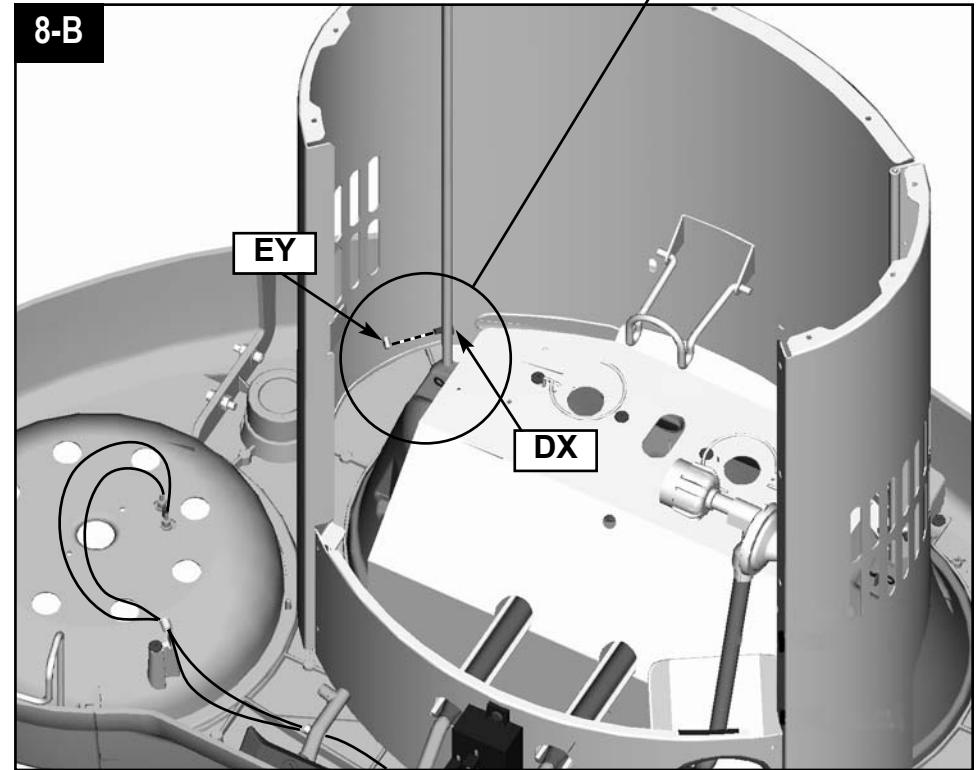
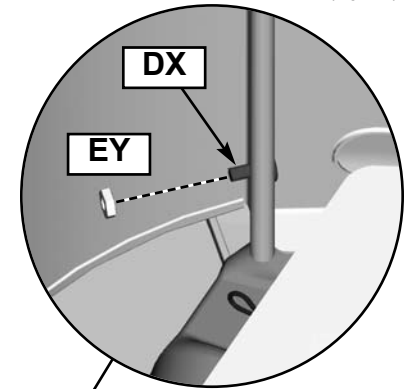
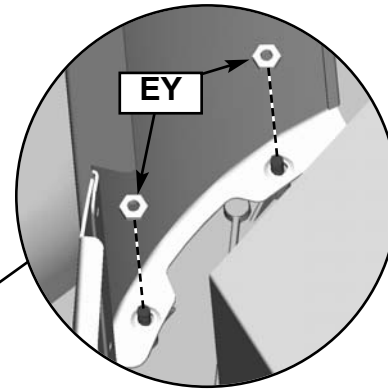

**8-B.** Tighten the two screws (DX) loosely fastened earlier in Step 5-C.

- ⇒ Lock the two screws (DX) holding the PEDESTAL PANELS together with (2) HEX NUTS (EY).
- ⇒ One HEX NUT (EY) assembles onto the right pedestal panel as shown. One HEX NUT (EY) assembles onto the left pedestal panel.
- ⇒ Tighten all fasteners.

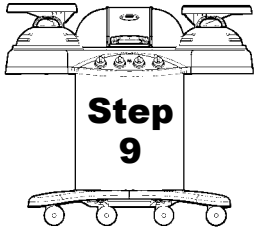

- ⇒ **NOTE:** The grill is upside-down during this assembly step.
- ⇒ Fasten the FRONT CONSOLE PANEL to the PEDESTAL.

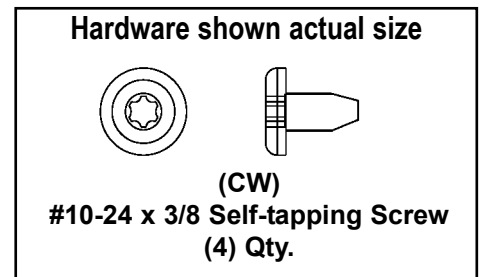
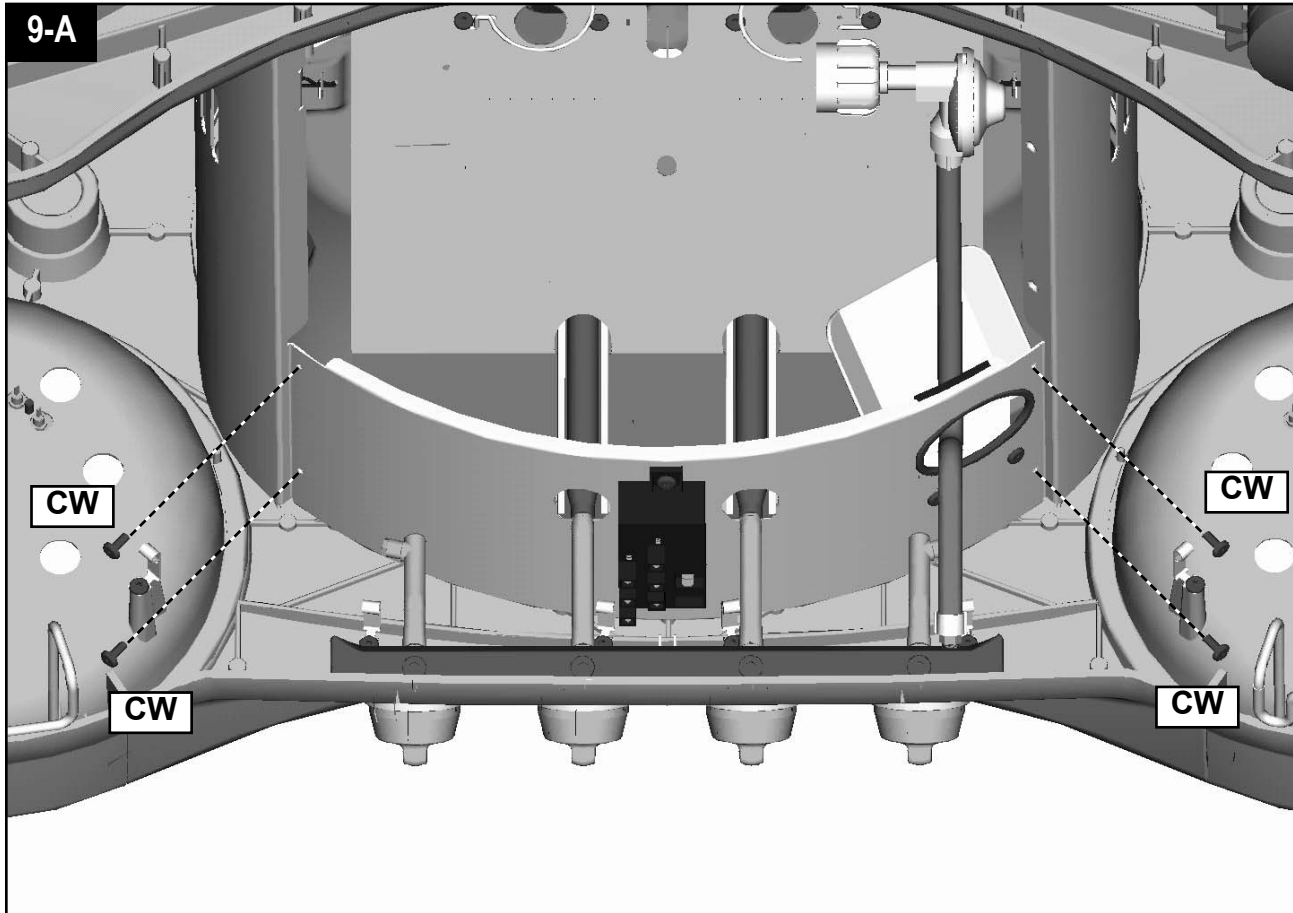

**9-A.** Assemble four SCREWS (CW) through the FRONT CONSOLE PANEL to the PEDESTAL.

- ⇒ Tighten all fasteners.

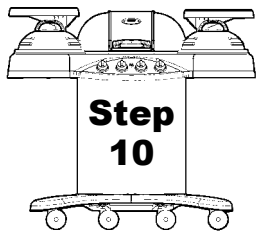

- ⇒ **NOTE:** The grill is upside-down during this assembly step.
- ⇒ **HINT:** A second person may be helpful when aligning the Base Casting.
- ⇒ Assemble the Base Casting to the Pedestal.

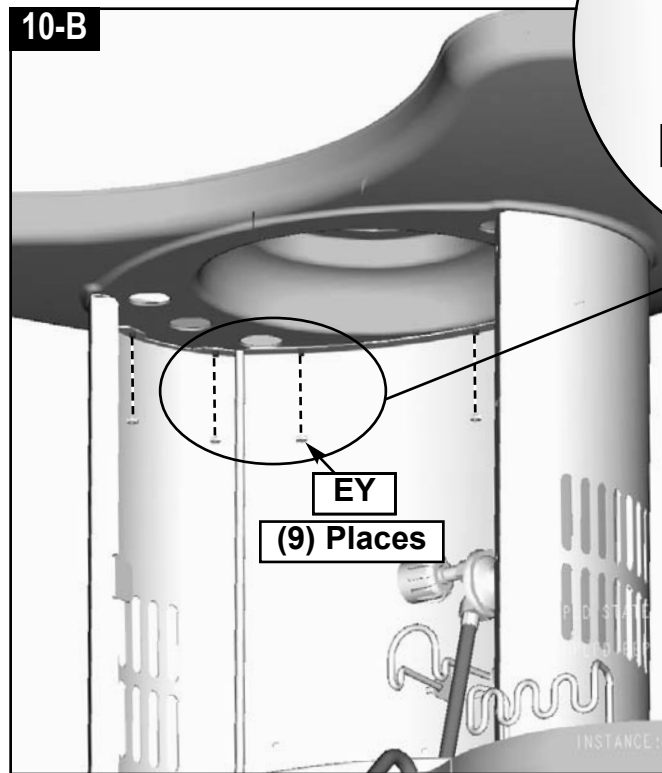
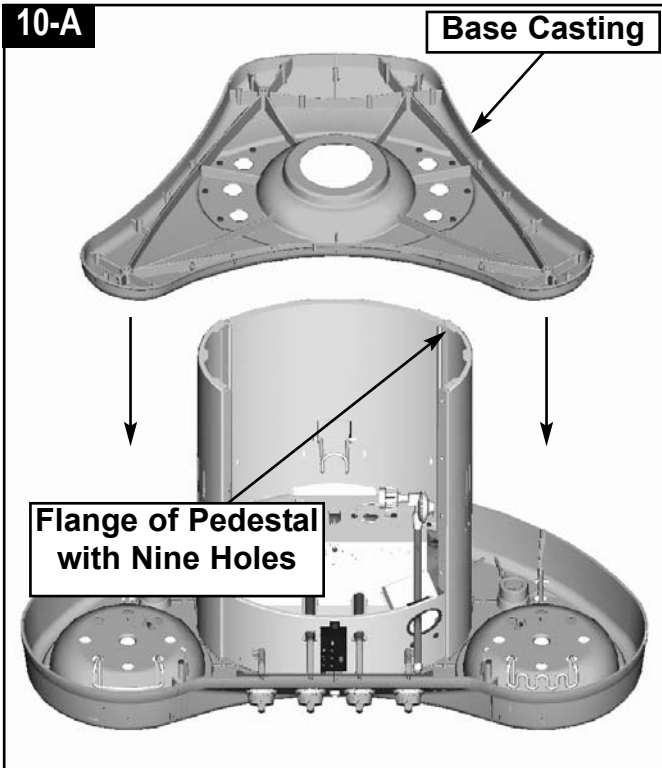

- 10-A.** Carefully place the Base Casting onto the Pedestal.
- ⇒ The Base Casting has nine factory installed studs. Carefully align the nine studs with the nine matching holes in the Flange of the Pedestal.

- 10-B.** Assemble nine Hex Nuts (EY) to the nine studs in the Base Casting.
- ⇒ Tighten all fasteners.

**Hardware shown actual size**



(EY)  
**#10-24 Hex Nut**  
**(9) Qty.**

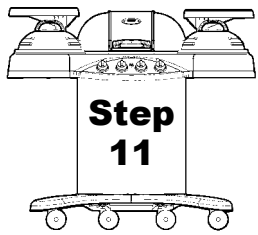

- ⇒ **NOTE:** The grill is upside-down during this assembly step.
- ⇒ Assemble casters.
- ⇒ Level and tighten the casters.

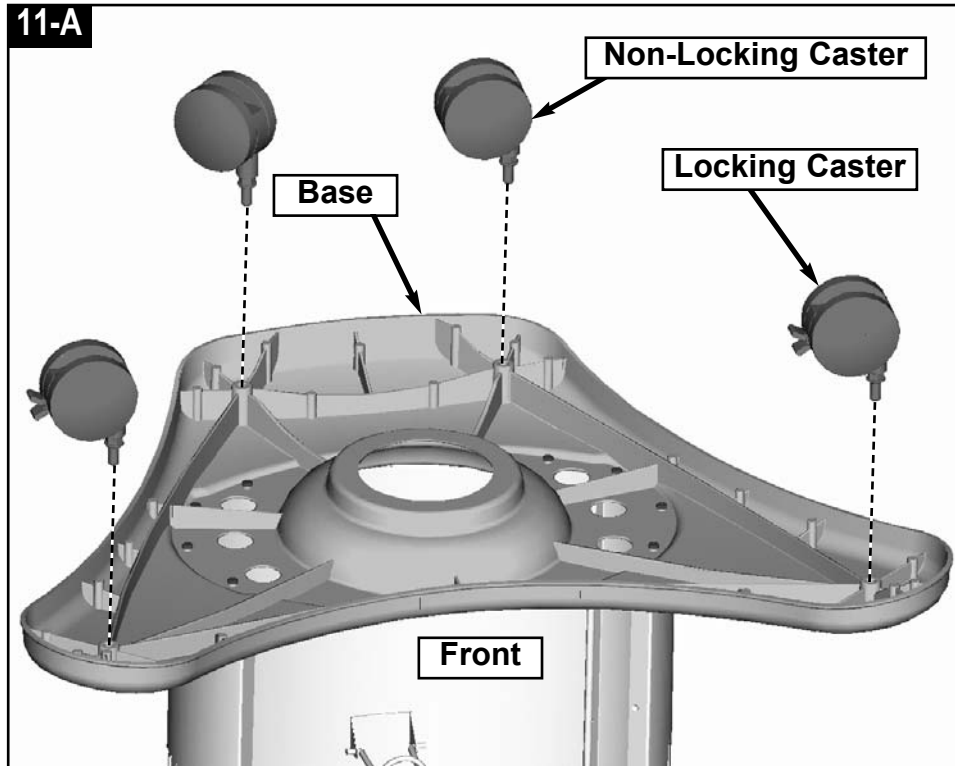

- 11-A.** Assemble locking casters to front of base.
- ⇒ Assemble non-locking casters to back of base.
  - ⇒ Make sure hex bottoms out on base.

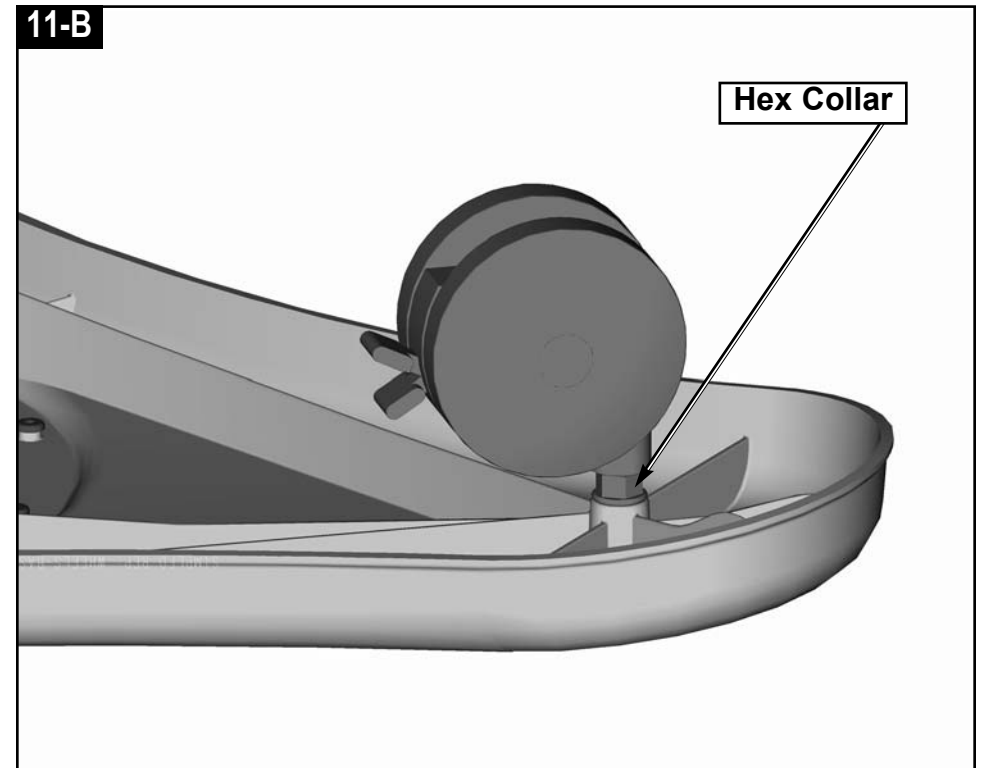

- 11-B.** Fasten wheels tight against the Base Casting.
- ⇒ Use an 11/16" open end wrench to tighten the Hex Collar against the Base Casting.

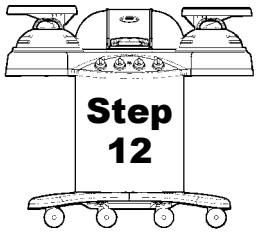

- ⇒ **NOTE:** Use a ground cloth to protect the paint finish during this step.
- ⇒ Check that all fasteners are tightened before turning the grill **Right-Side-Up**.
- ⇒ Carefully turn the grill **Right-Side-Up**.

**12-A**

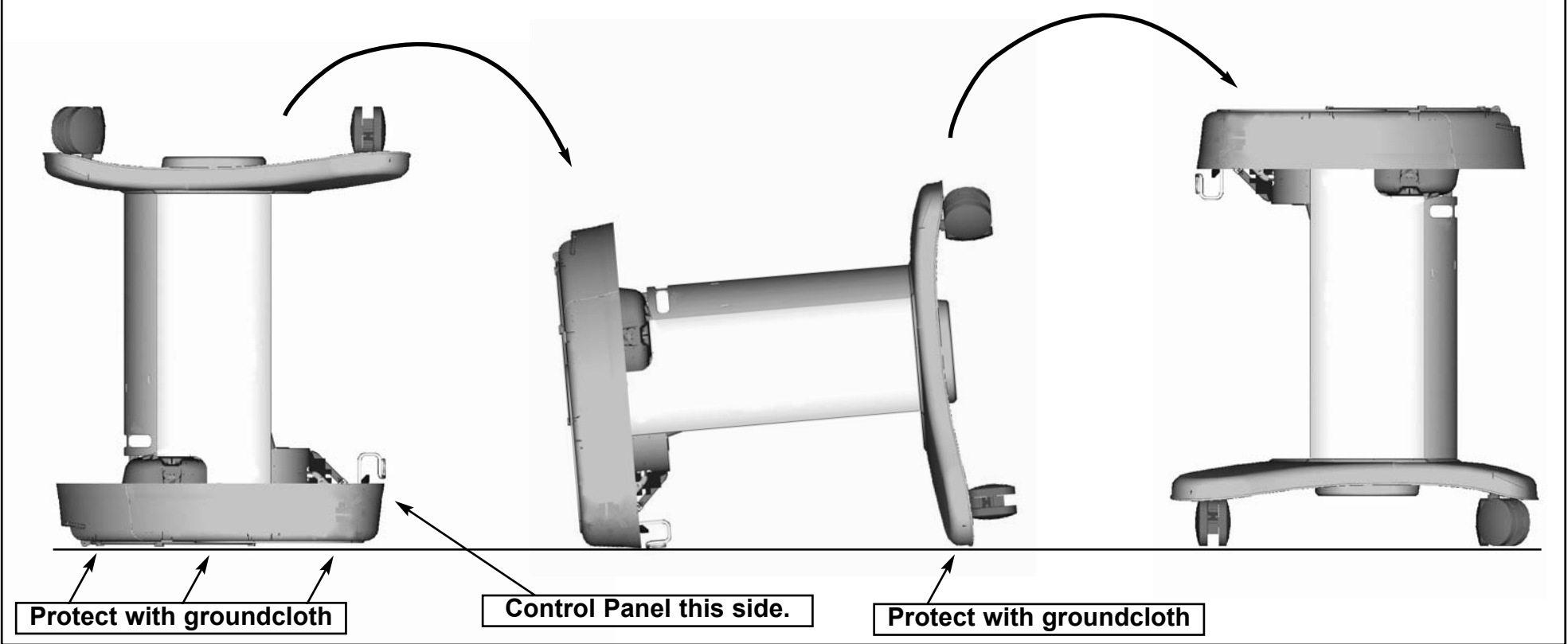

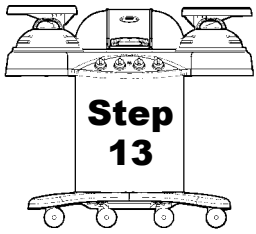

⇒ Complete Assembly of the Console to the Pedestal.

13-A

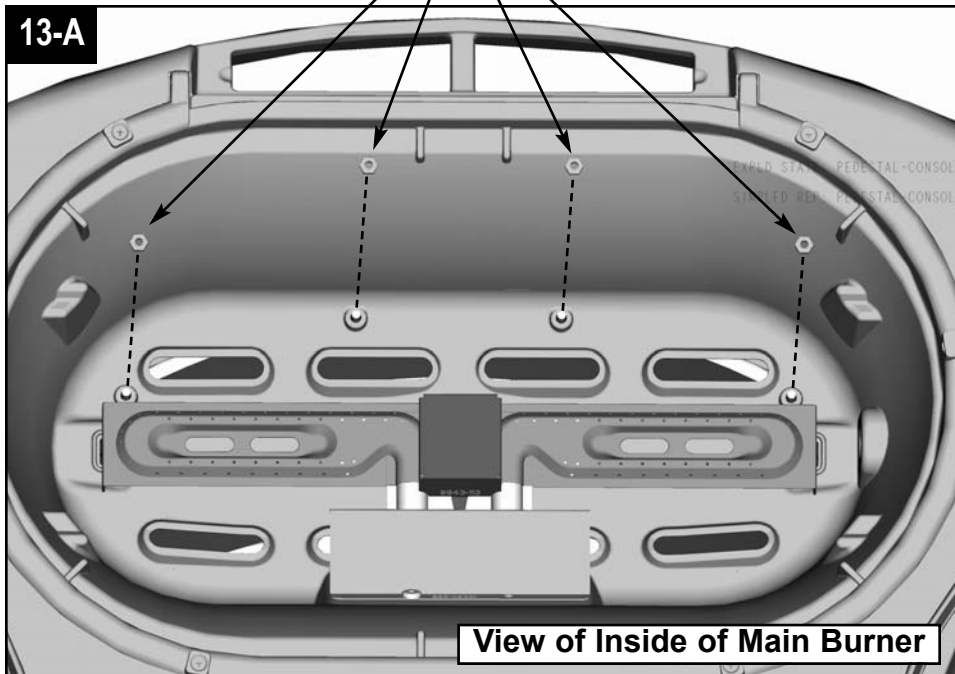

13-A. Assemble four HEX NUTS (EY) onto the four studs that protrude through the center burner casting.

⇒ Tighten all fasteners.

Hardware shown actual size



(EY)  
#10-24 Hex Nut  
(4) Qty.

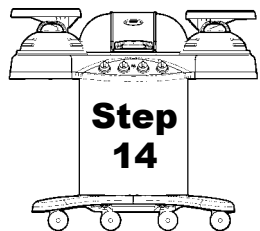

- ⇒ Assemble the BURNER to the RIGHT CONSOLE.
- ⇒ Slip BURNER TUBE through RIGHT CONSOLE per detail 14-A.
- ⇒ Align BURNER TUBE with VALVE TUBE per detail 14-B.
- ⇒ Slip BURNER TUBE over VALVE TUBE per detail 14-C.
- ⇒ Fasten BURNER in place per detail 14-D.

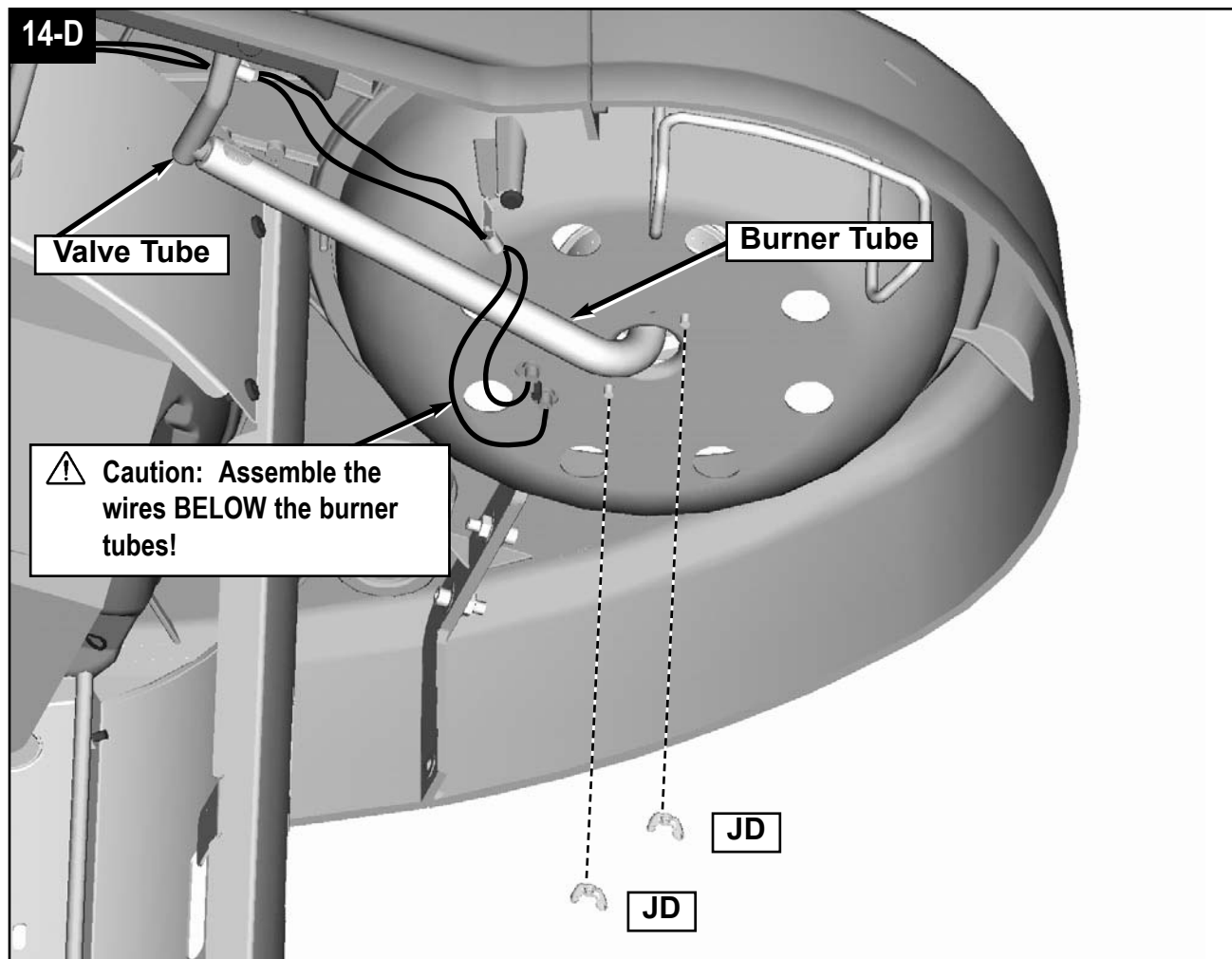
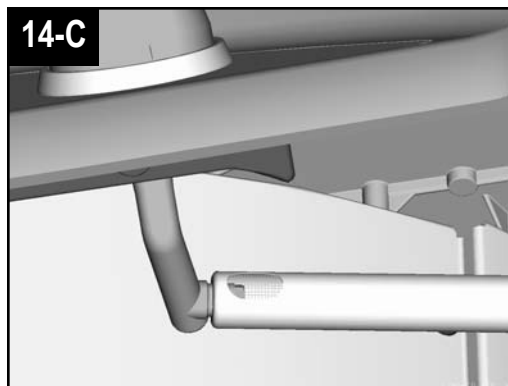
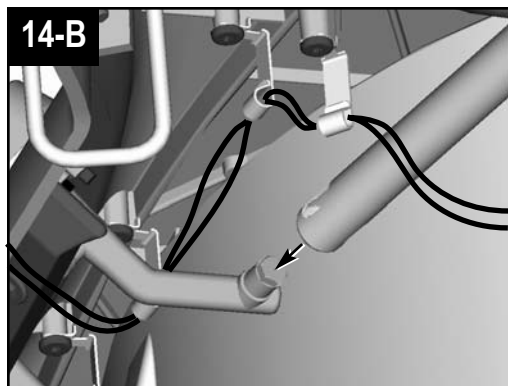
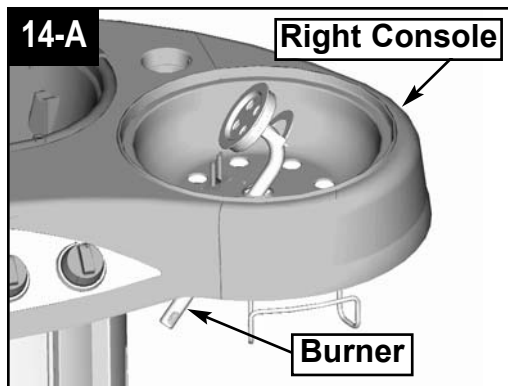
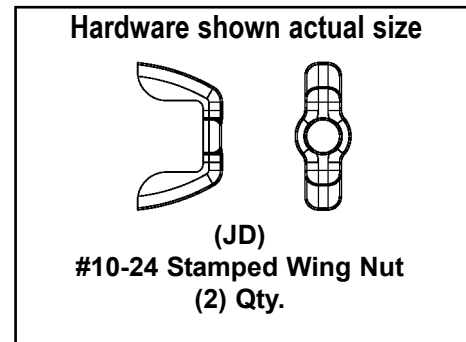

- 11-D.** Fasten the burner in place with two WINGNUTS (JD).  
⇒ Tighten all fasteners.



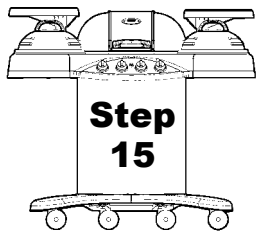

- ⇒ Assemble the BURNER to the LEFT CONSOLE.
- ⇒ Slip BURNER TUBE through LEFT CONSOLE per detail 15-A.
- ⇒ Move the Flexible Fuel Hose downward to give clearance for inserting the burner tube.
- ⇒ Slip BURNER TUBE over VALVE TUBE per detail 15-C. The Flexible Fuel Hose and Wiring must be routed **BELOW** the burner tube per detail 15-D.
- ⇒ Fasten BURNER in place per detail 15-D.

Hardware shown actual size

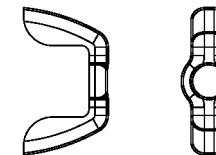

(JD)  
#10-24 Stamped Wing Nut  
(2) Qty.

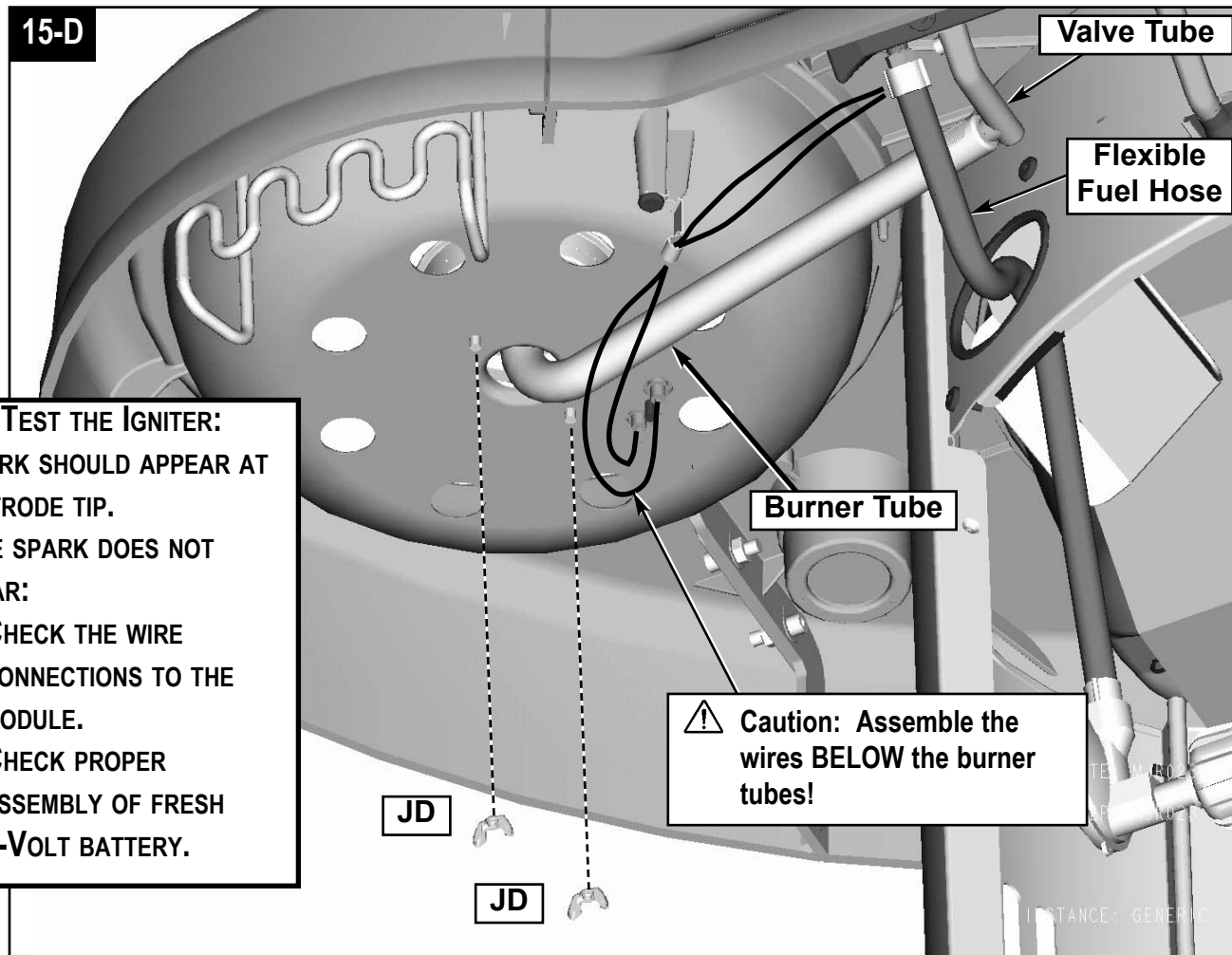
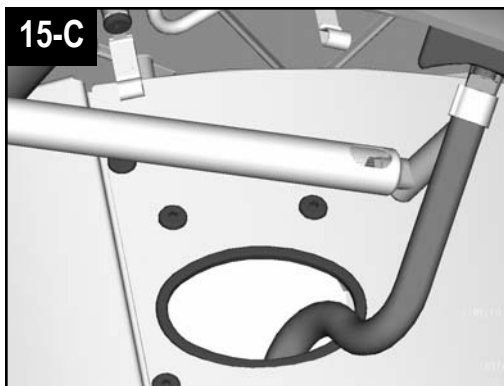
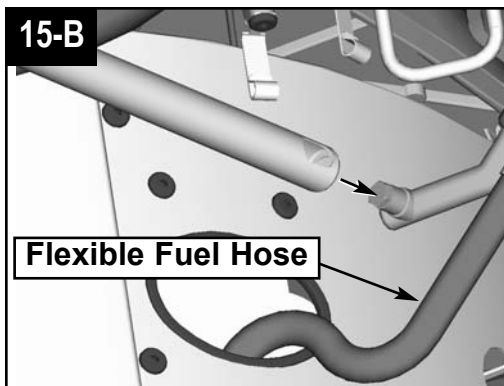
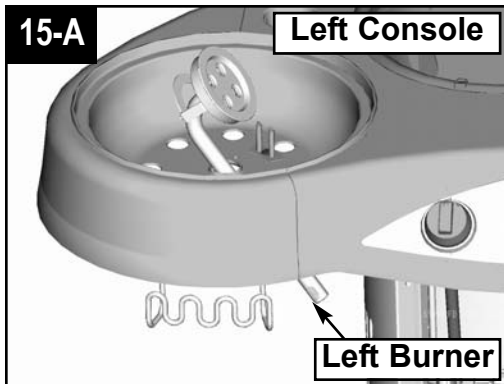

**TEST THE IGNITER:**  
A SPARK SHOULD APPEAR AT ELECTRODE TIP.  
IF THE SPARK DOES NOT APPEAR:  
-CHECK THE WIRE CONNECTIONS TO THE MODULE.  
-CHECK PROPER ASSEMBLY OF FRESH 9-VOLT BATTERY.

- 15-D. Fasten the burner in place with two WINGNUTS (JD).  
⇒ Tighten all fasteners.

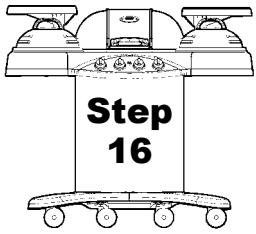

⇒ Assemble the DOOR LATCH to the PEDESTAL.

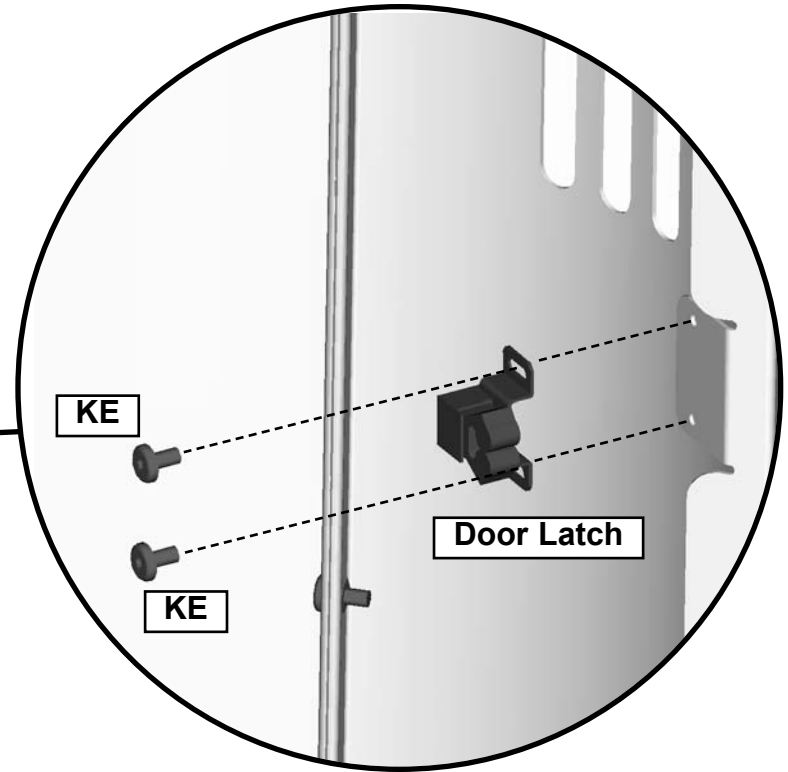
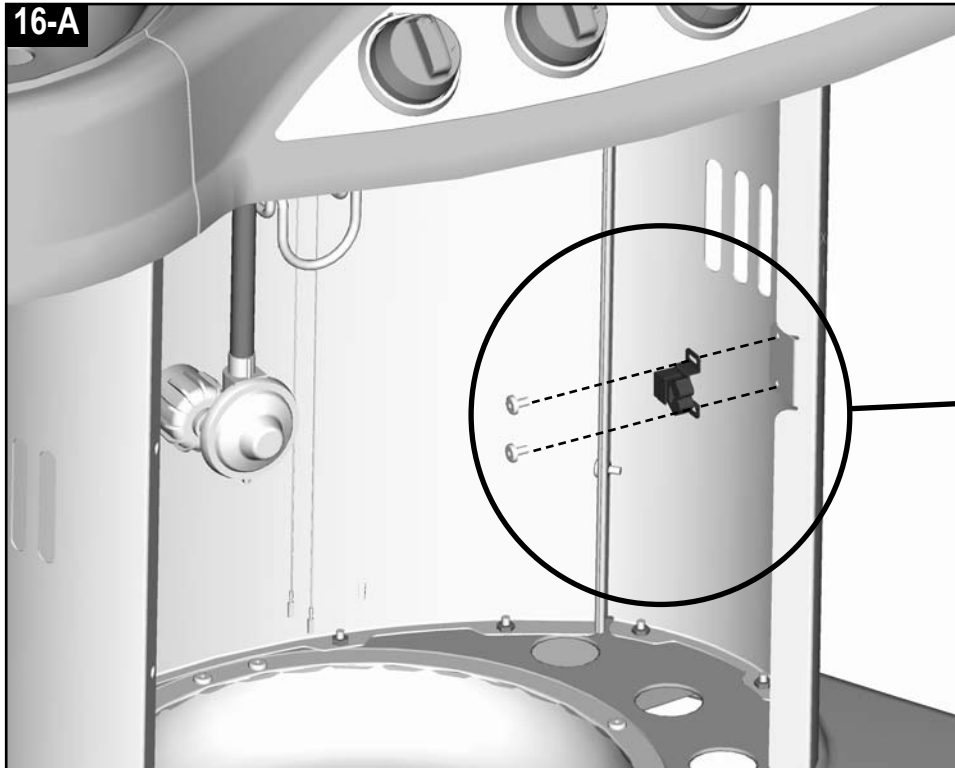

16-A. Assemble the DOOR LATCH with two SCREWS (CW).

**NOTE:** You may have to adjust door latch to insure proper alignment of door latch post. Refer to Step 18-B.

Hardware shown actual size



(KE)  
#6-32 x 3/8 Self-tapping Screw  
(2) Qty.

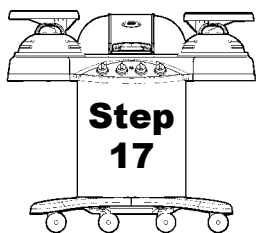

- ⇒ Assemble the DOOR HANDLE to the DOOR.
- ⇒ Assemble the DOOR LATCH POST to the DOOR.

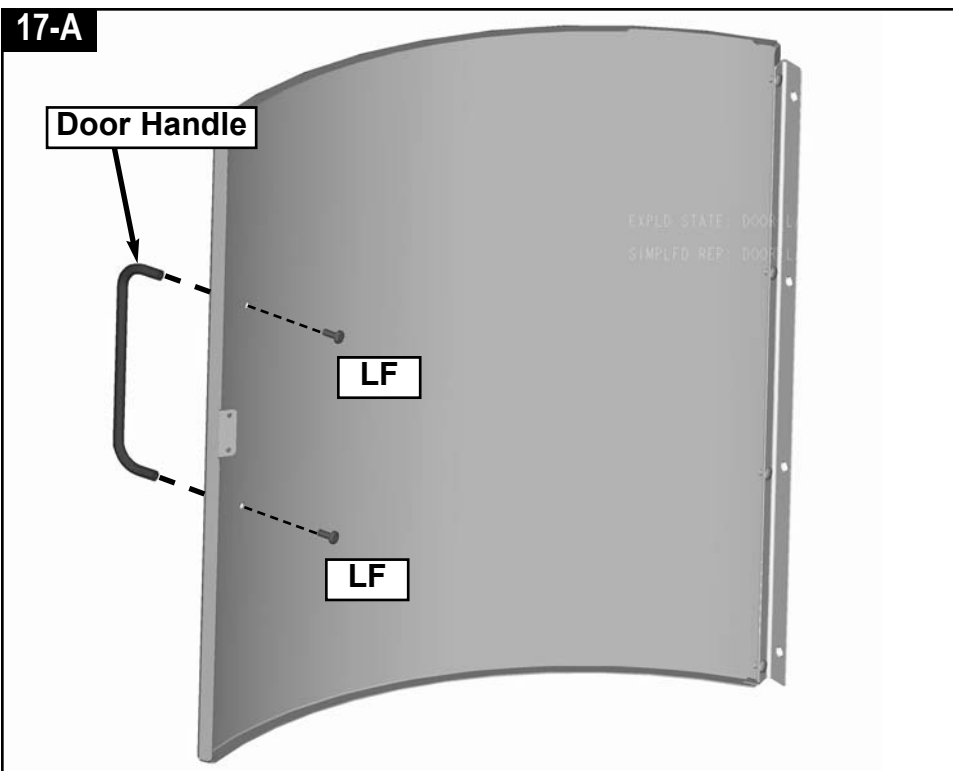

17-A. Attach the DOOR HANDLE to the DOOR with two SCREWS (FZ).

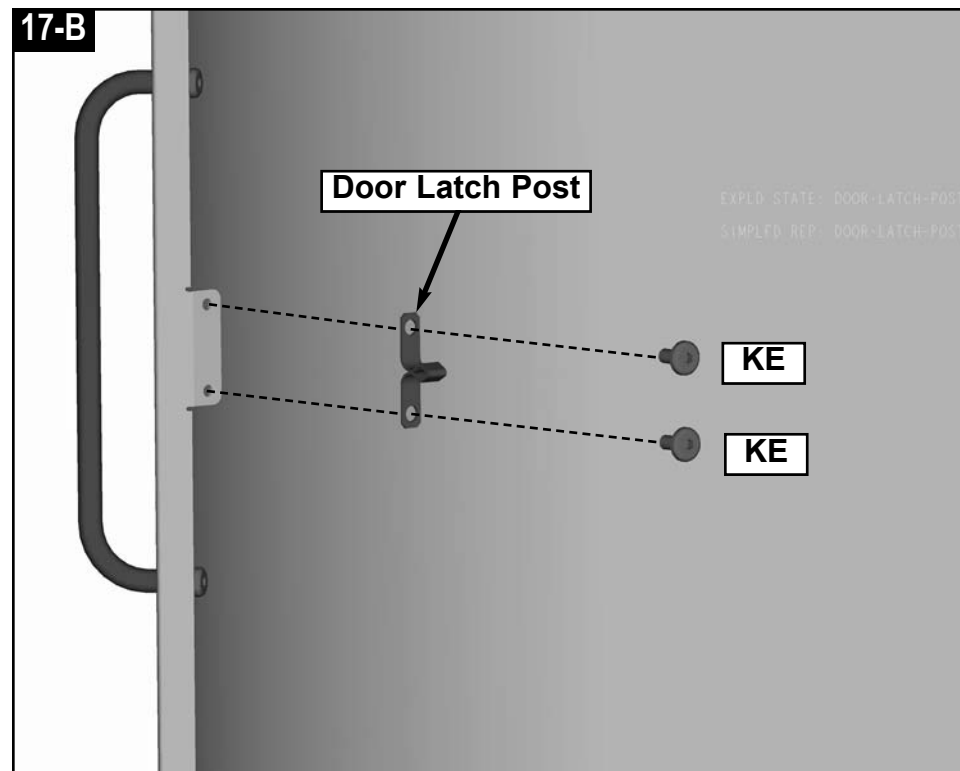

17-B. Attach the DOOR LATCH POST to the DOOR with two SCREWS (CW).

Hardware shown actual size

(LF)  
 #8-32 x 1/2 Self-tapping Screw  
 (2) Qty.

Hardware shown actual size

(KE)  
 #6-32 x 3/8 Self-tapping Screw  
 (2) Qty.

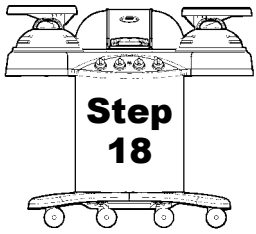

- ⇒ Assemble the DOOR to the PEDESTAL.
- ⇒ Adjust the DOOR LATCH on the PEDESTAL for proper door closure.

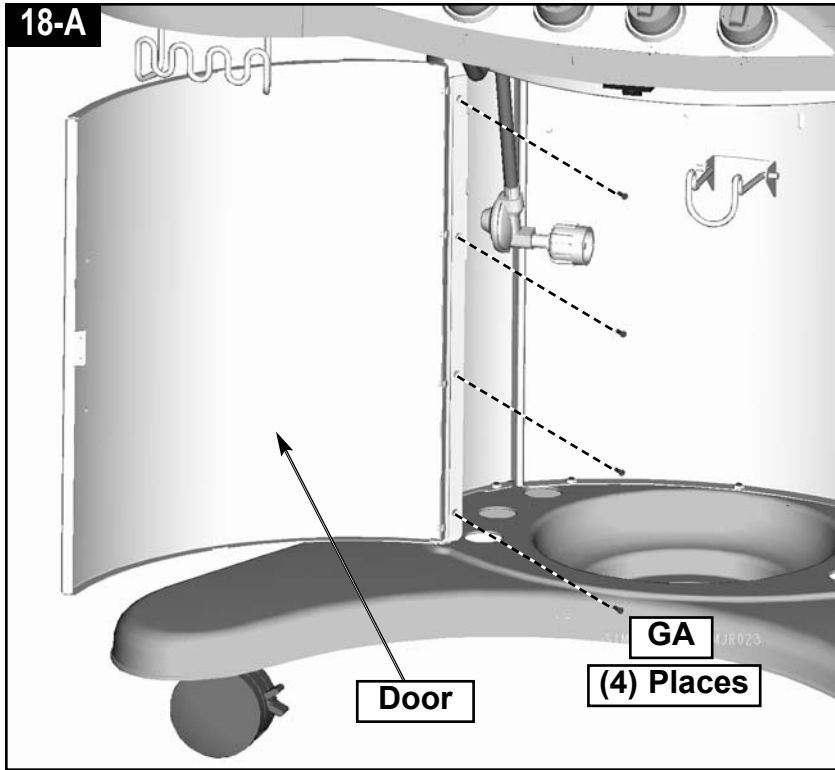

18-A. Attach the DOOR to the PEDESTAL with four SCREWS (GA).

**Hardware shown actual size**

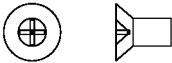

**(GA)**  
**#10-24 x 3/8 Flat Head Screw**  
**(4) Qty.**

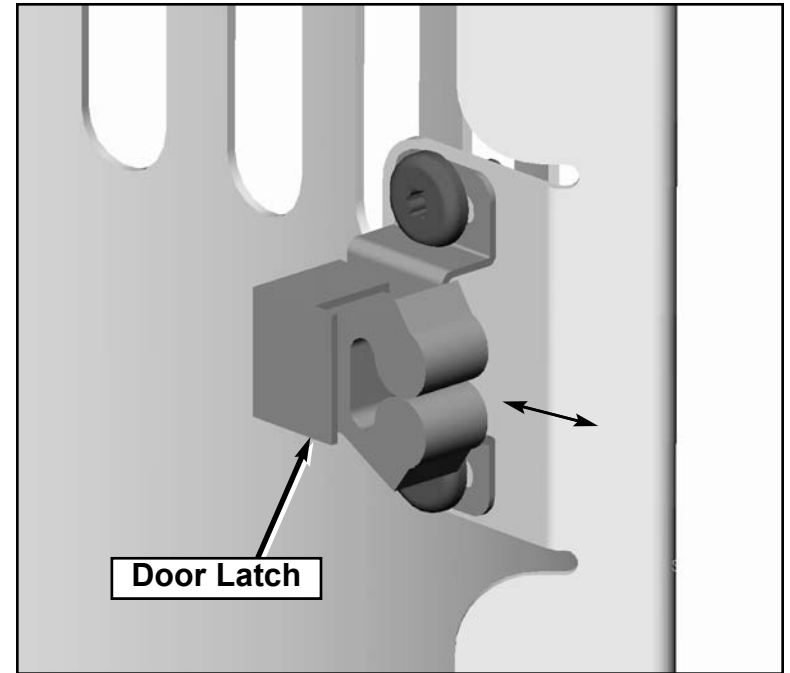

18-B. Adjust the DOOR LATCH on the PEDESTAL for proper door closure.

- ⇒ Tighten all fasteners.

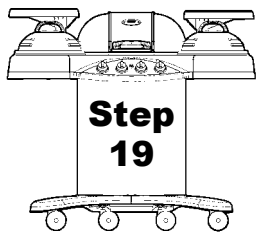

- ⇒ Assemble the MAIN BURNER LID.
- ⇒ Adjust the DOOR LATCH on the PEDESTAL for proper door closure.

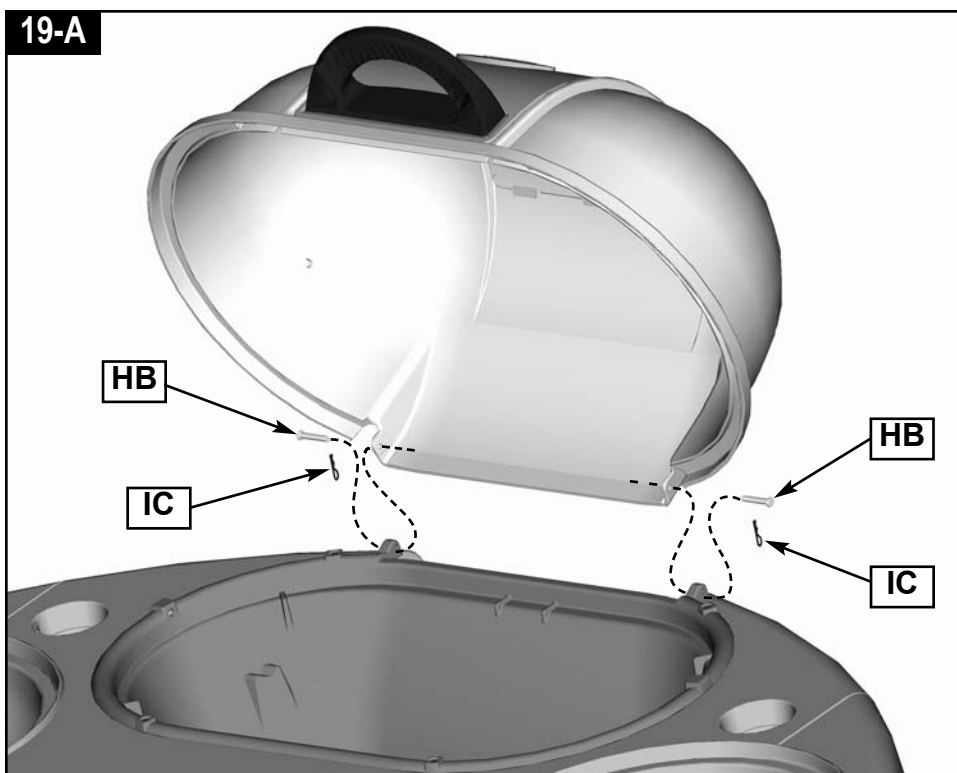

**19-A.** Attach the MAIN BURNER LID with two clevis pins (HB).  
⇒ Lock the clevis pins in place with two hairpin cotters (IC).

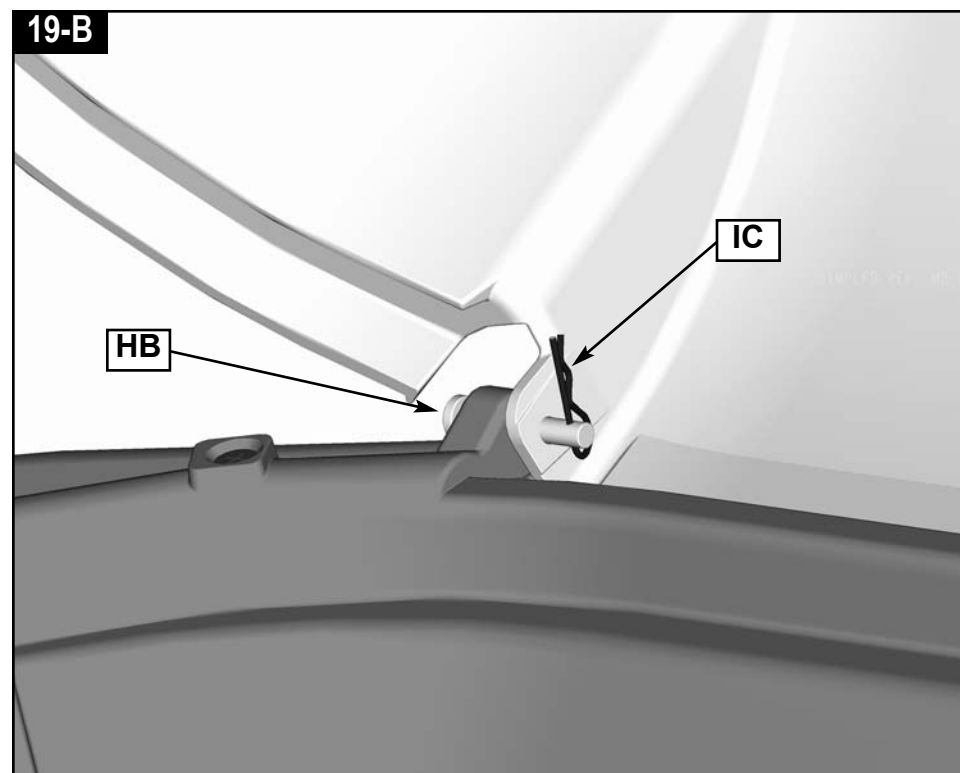

**19-B.** Detail showing location of clevis pin (HB) and hairpin (IC).

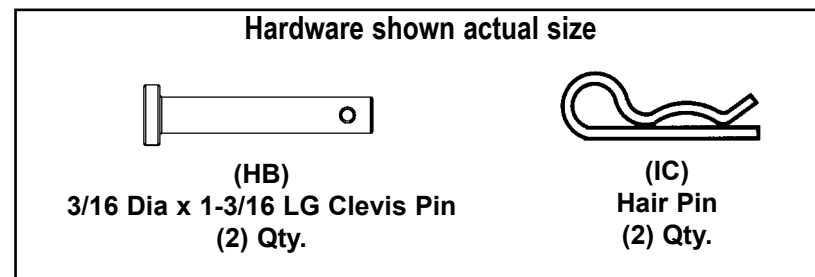

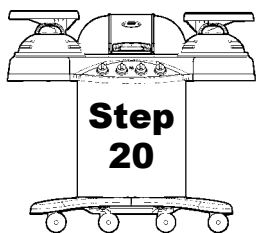

- ⇒ Assemble the WARMING RACK and SUPPORT WIRE into the middle burner lid.
- ⇒ **Note:** Steps 20-A and 20-B are pre-assembled at the factory. Proceed to Step 20-C.

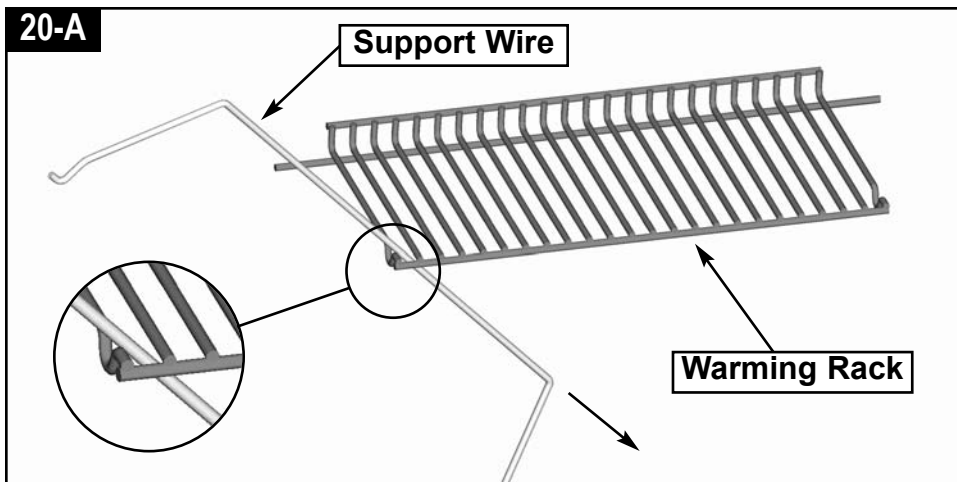

**20-A.** Insert the SUPPORT WIRE into the left end of the WARMING RACK.

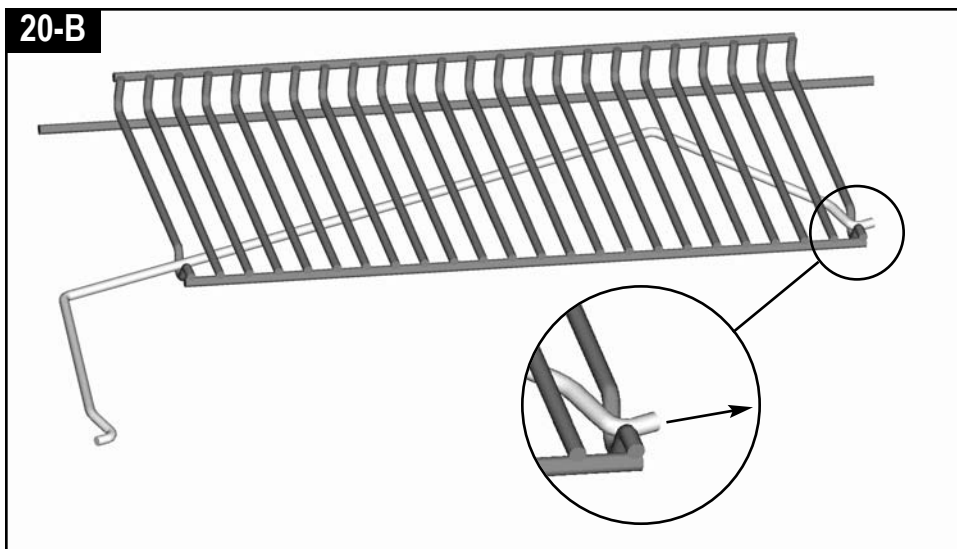

**20-B.** Thread the SUPPORT WIRE through the right end of the WARMING RACK.

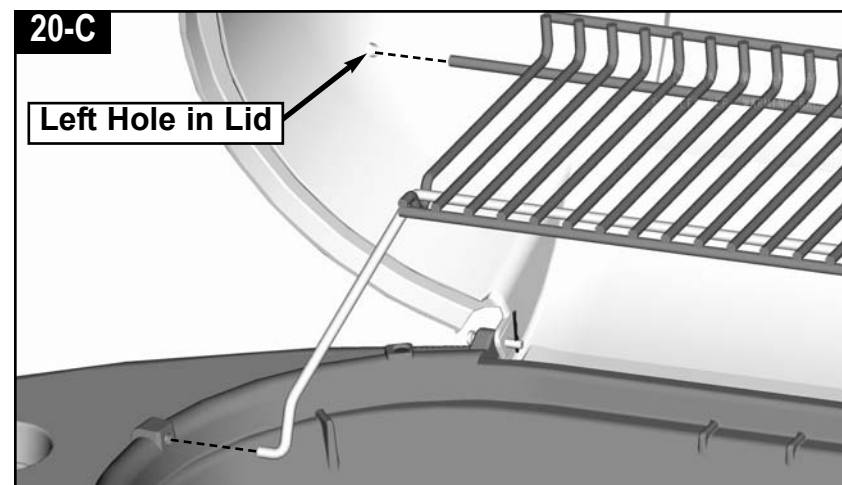

**20-C.** Insert the WARMING RACK through the Left Hole in the lid (far enough to clear the Right Hole), then slide the WARMING RACK into the Right Hole of the lid.

- ⇒ Center the Warming Rack in the lid.

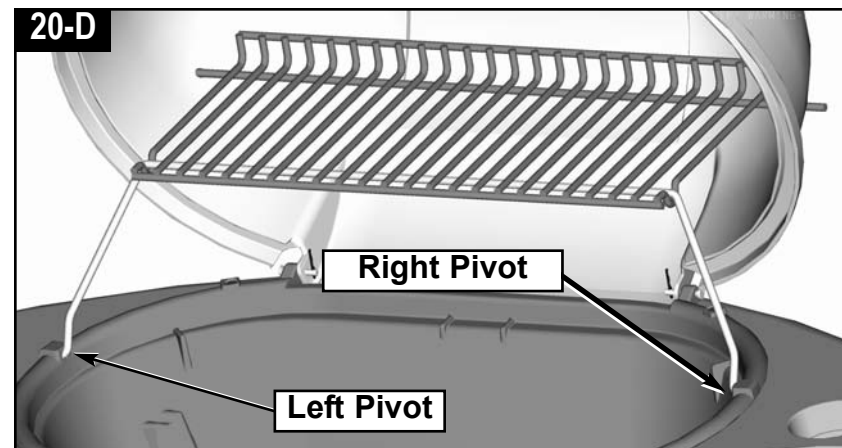

**20-D.** Insert the SUPPORT WIRE into the Left Pivot.

- ⇒ Squeeze the SUPPORT WIRE to fit into the Right Pivot.

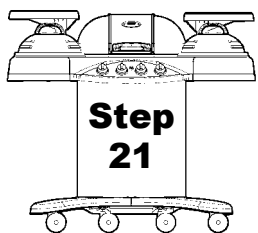

⇒ Assemble the SIDE TRAYS to the grill.

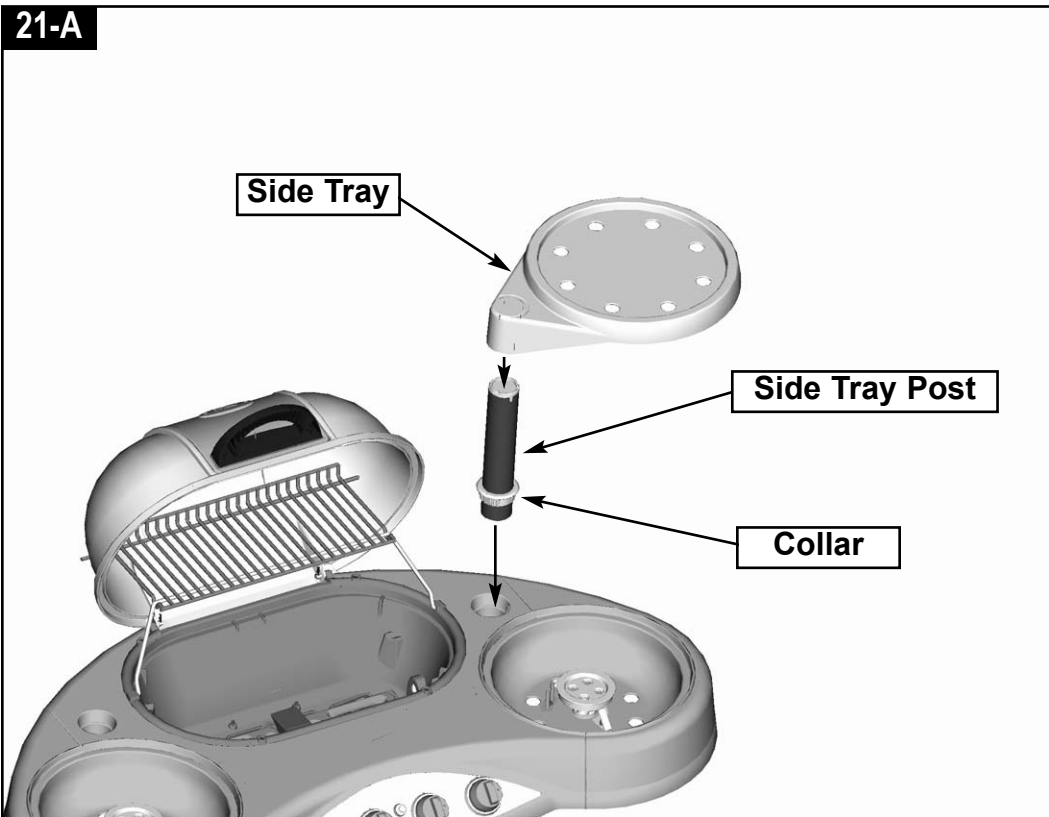

**21-A.** Insert one SIDE TRAY POST into the grill. Align the notch in the collar with the grill casting. It should not rotate in the hole.

⇒ Place the SIDE TRAY onto the POST. It can be rotated from the forward position (above the burner) to a limited outward position (away from the burner).

⇒ Repeat Step **21-A** for the left SIDE TRAY.

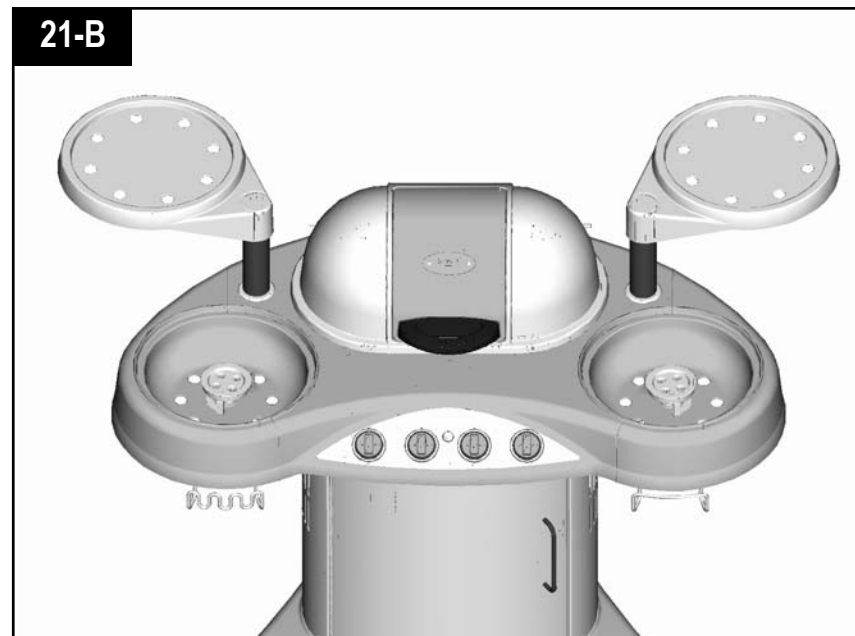

**21-B.** SIDE TRAYS installed.

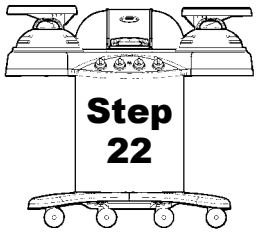

- ⇒ Place DRIP PAN, SIDE BURNER GRID, and ROUND GRILL CASTING onto the left grill per Fig 22-A.
- ⇒ Place DRIP PAN, SIDE BURNER GRID, and ROUND GRIDDLE CASTING onto the right grill per Fig 22-A.

**22-A**

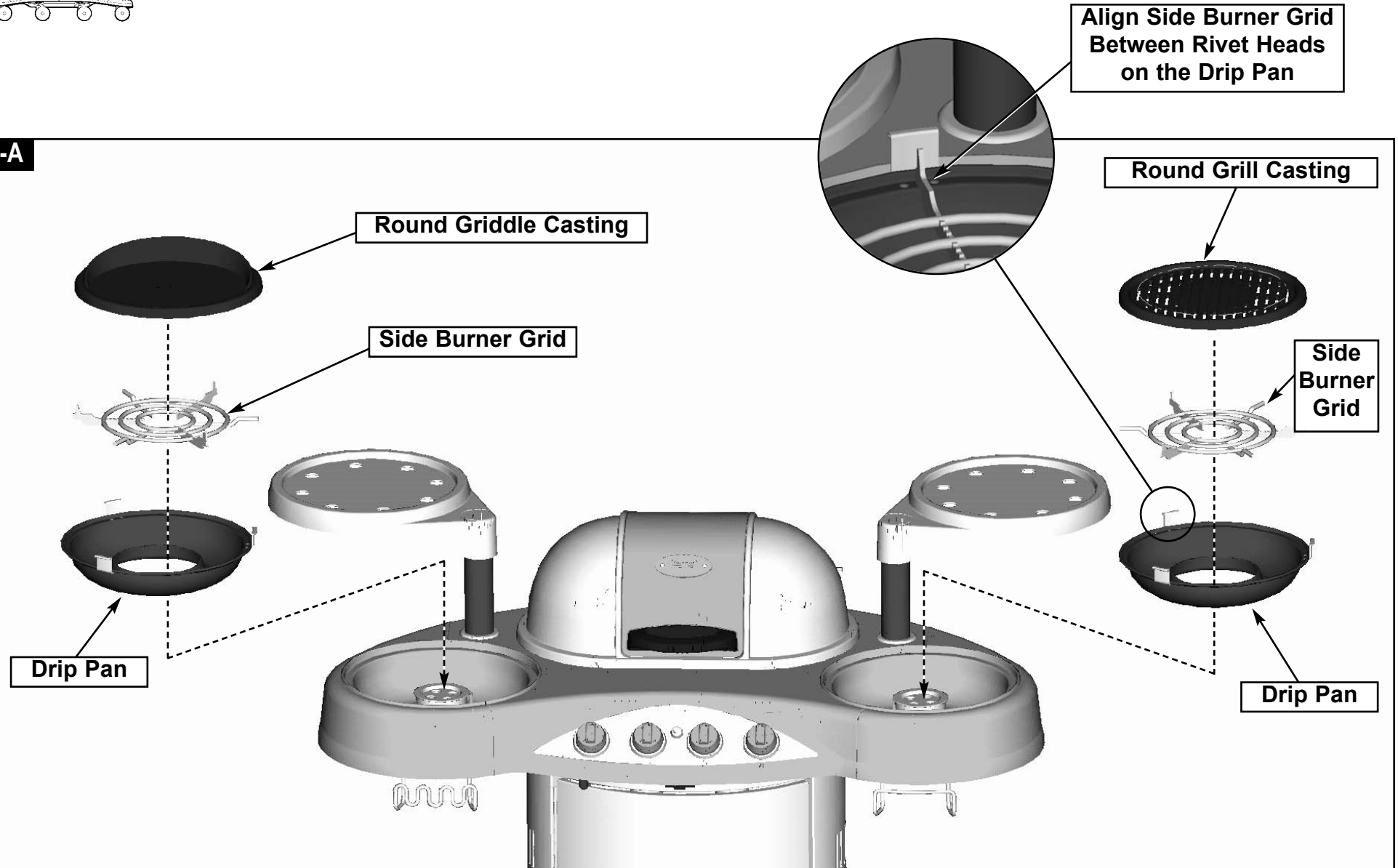



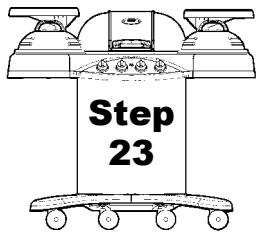

- ⇒ Place one Heat Tent on the main burner casting.
- ⇒ Place two D-GRILLS on the main burner casting.

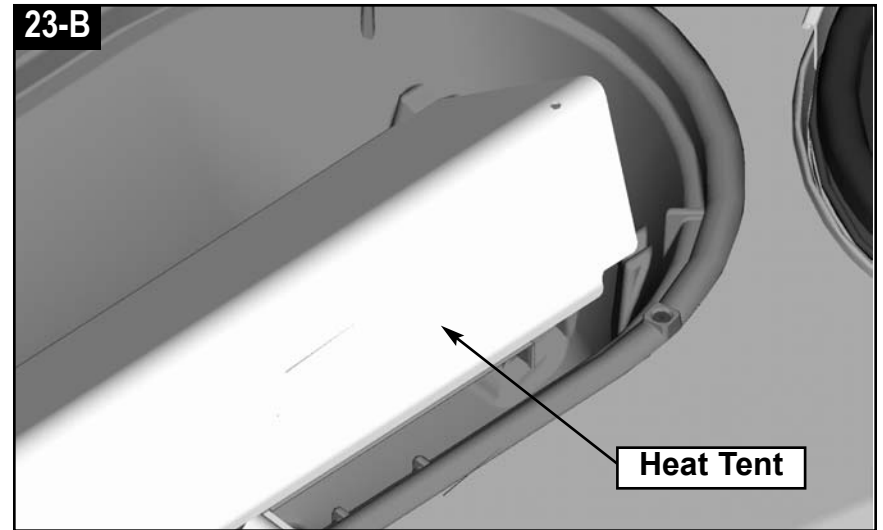
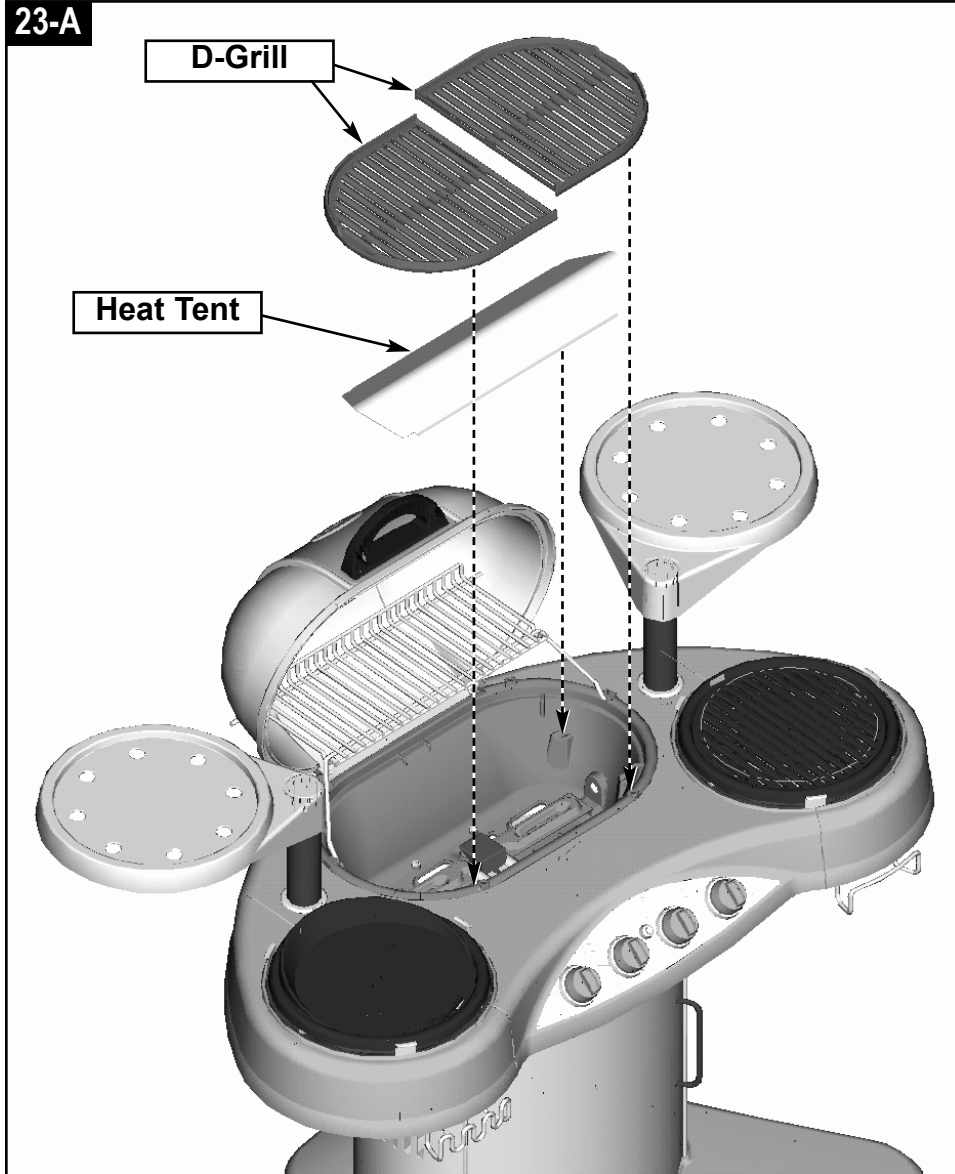

23-B. HEAT TENT installed.

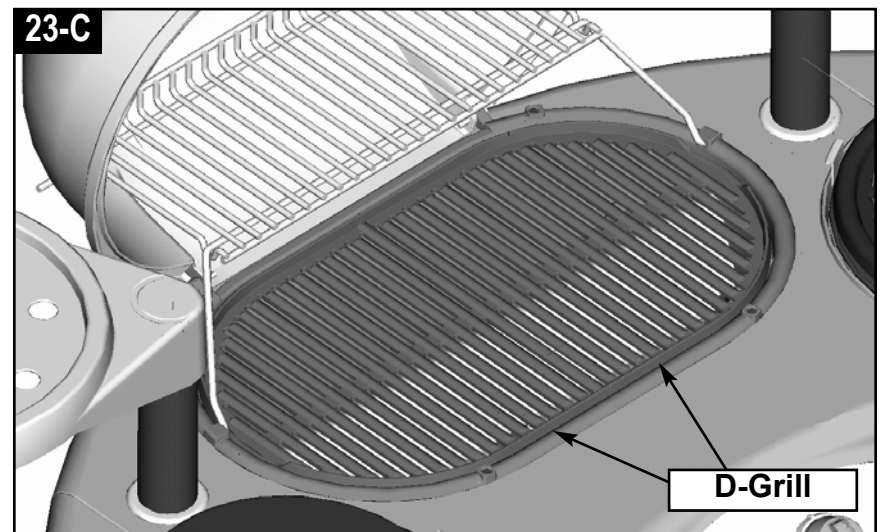

23-C. D-GRILLS installed.

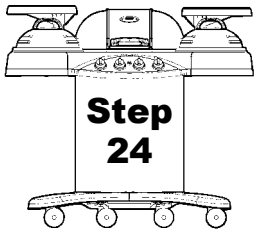

⇒ Place two SIDE LIDS on the side burners.

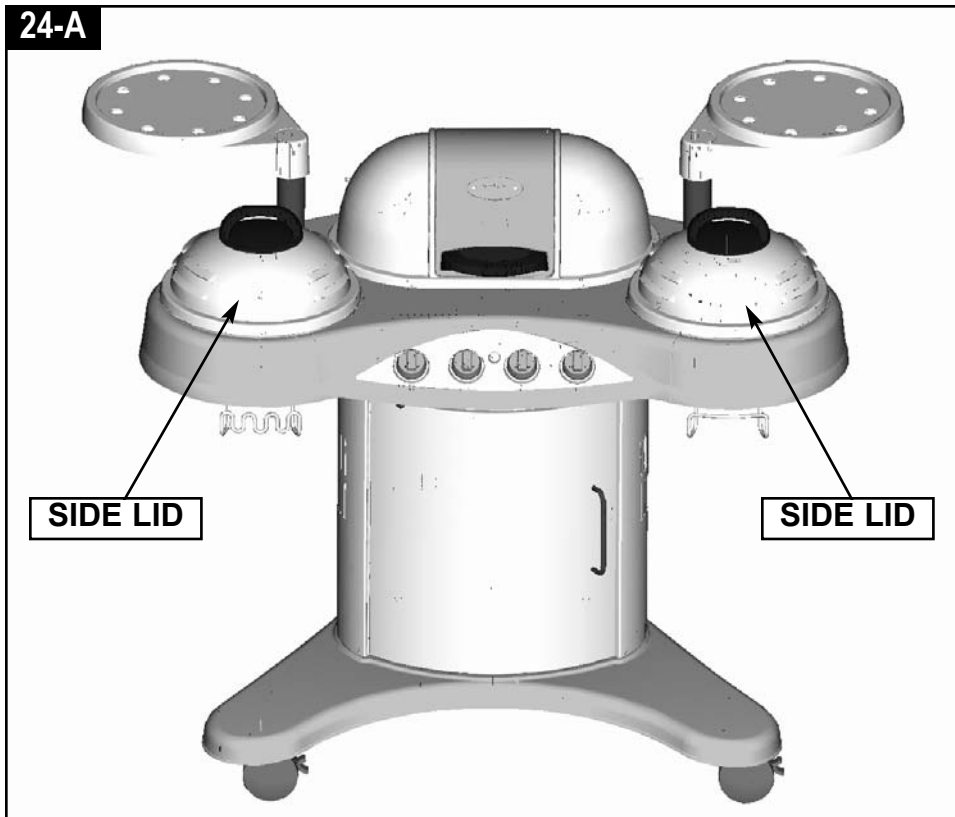

**24-A.** Place one SIDE LID on each side burner.



**24-B.** SIDE LIDS can also be placed onto the SIDE TRAYS.

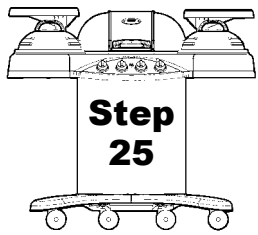

- ⇒ Open the front access door to place two GREASE CUPS under the main burner.
- ⇒ Place the GREASE CUPS into the two wire holders below the main burner. See illustrations 25-A and 25-B.
- ⇒ Place the GREASE DRIP TRAY into the holder behind the main burner lid. See illustrations 25-C and 25-D.

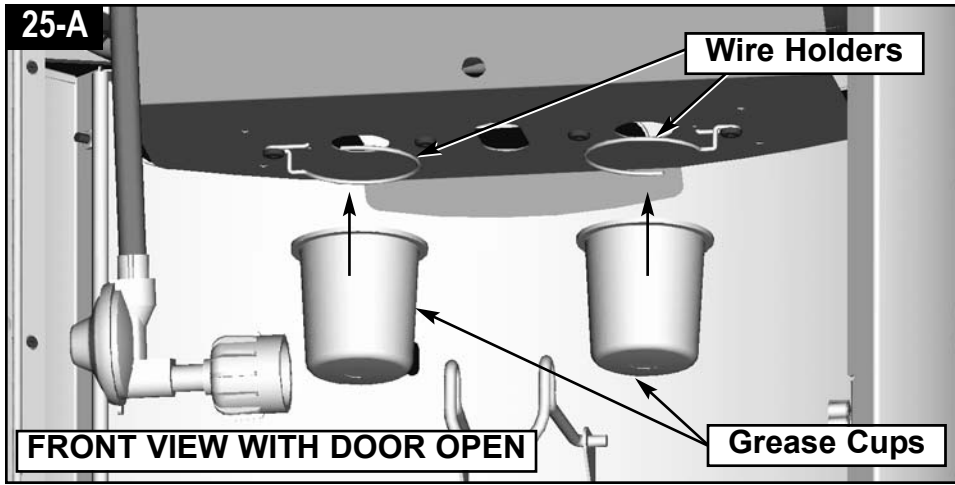

25-A. Place the GREASE CUPS into the wire holders.

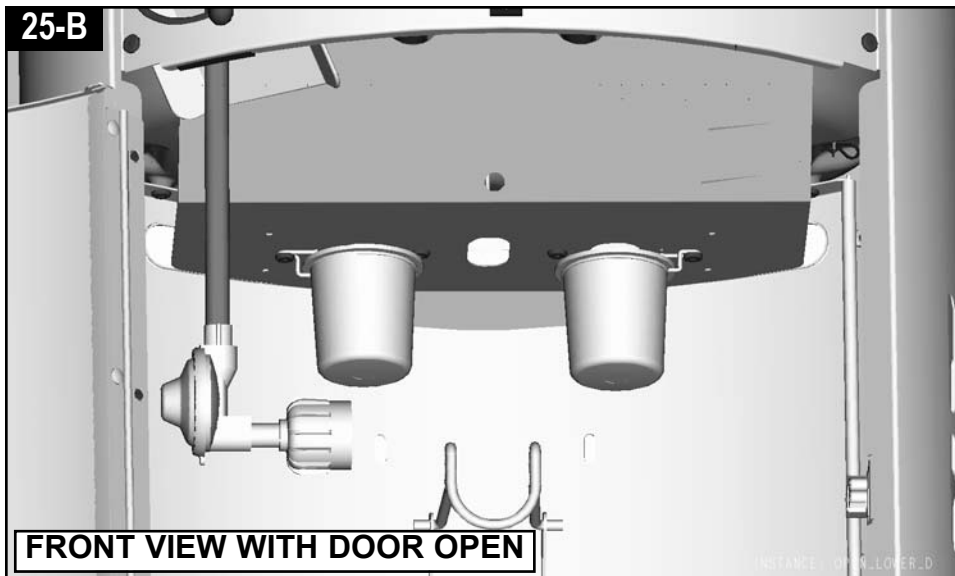

25-B. Detail showing correct installation of the GREASE CUPS.

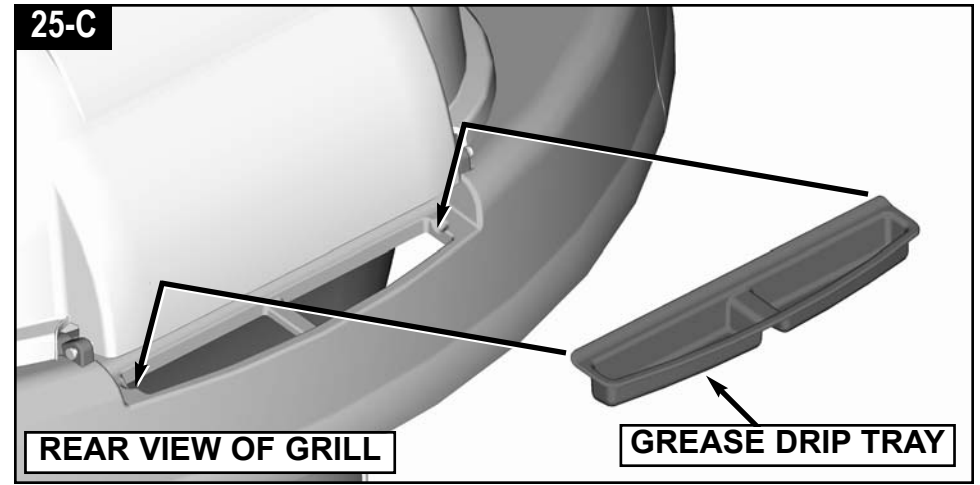

25-C. Place the GREASE DRIP TRAY into the holder.

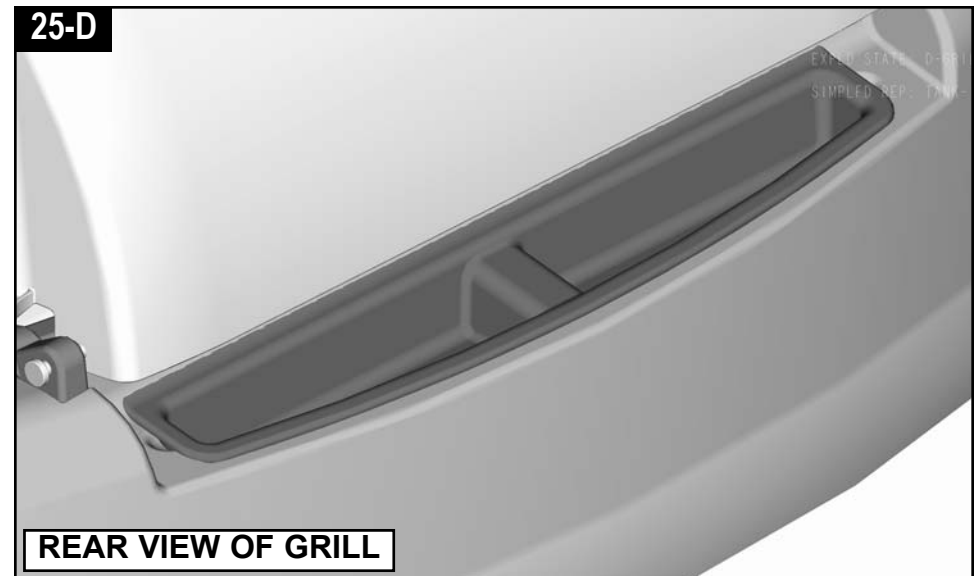

25-D. Detail showing correct installation of the GREASE DRIP TRAY.

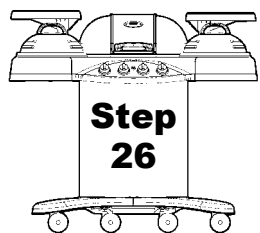

- ⇒ Assemble an LP CYLINDER to the Cylinder Caddy. See detail **26-A**.
- ⇒ Place the CYLINDER RETAINER WIRE over the Cylinder Collar. See detail **26-B**.
- ⇒ Attach the TYPE 1 fitting to the Fuel Valve Outlet per detail **26-C**.

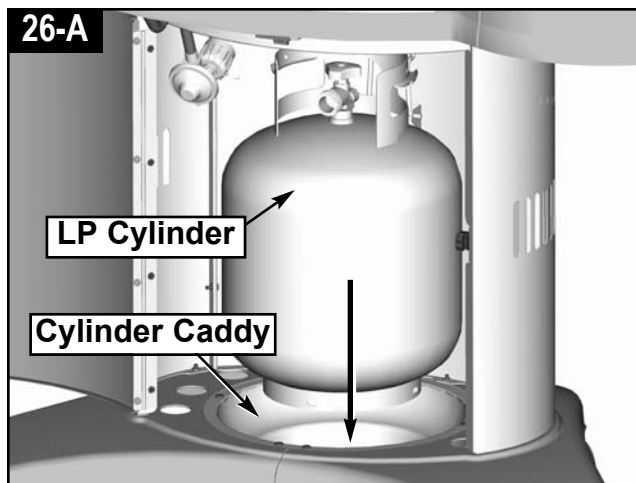

**26-A.** Set LP CYLINDER in the cylinder caddy with the outlet valve facing toward the front of the grill.

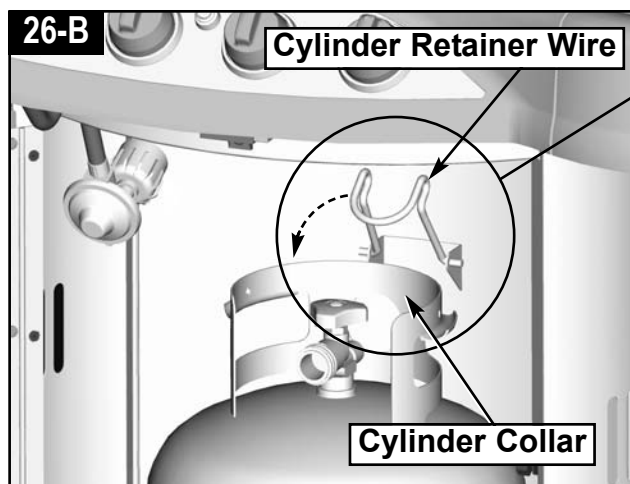

**26-B.** Place the CYLINDER RETAINER WIRE over the Cylinder Collar, by rotating the wire from the upward position over the cylinder collar.

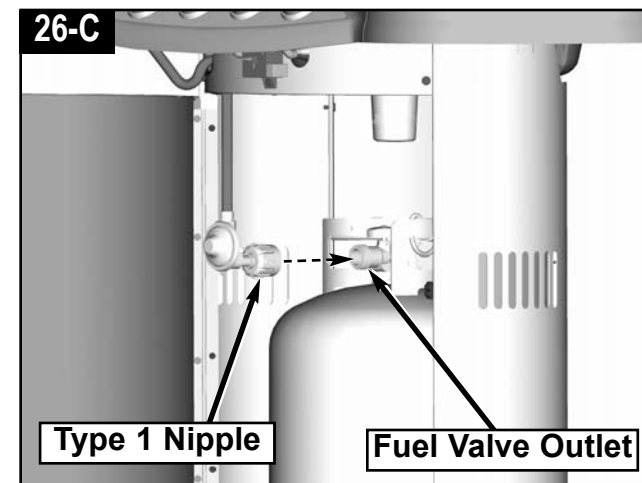
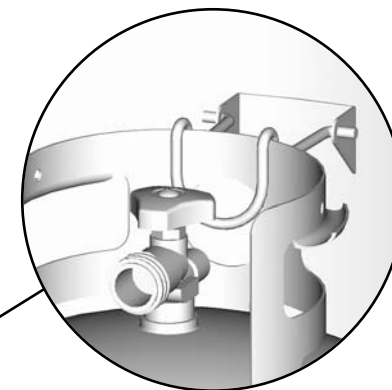

**26-C.** Insert the TYPE 1 Nipple of the regulator into the cylinder's Fuel Valve Outlet as shown. Turn the regulator hand wheel clockwise to tighten. No tools are needed. The hand wheel will come to a complete stop when the connection is secure, and gas will not flow until a positive seal is achieved.

**IMPORTANT!**

TO ENSURE PROPER GAS FLOW, BURNER CONTROL VALVES **MUST** BE "OFF" **BEFORE** OPENING THE GAS CYLINDER VALVE.

**⚠ WARNING:** During assembly of grill and when attaching or replacing the L.P. gas cylinder, insure that the gas supply hose is free of kinks and/or damage and is at least 3" away from hot surfaces such as the grill casting.

## REPAIR PARTS

Key	Part #	Description
1	9943-2701	Side Tray/Post Kit
2	9943-4101	Lid Assembly - Side
3	9943-4201	Lid Assembly - Center
4	9942A3181	Griddle - Side
5	9943A3201	Burner
6	9941-3161	D-Grill-Center
7	9943-3151	Grid - Side
8	9943-5301	Drip Pan Assembly
9	9943-3181	Warming Rack
10	9943-4851	Electrode and 27" Wires
11	9943-1421	Tool Hook/Towel Hook
12	9943-0461	Grease Cup
13	9943-0821	Latch Post
14	9943-5601	Door Assembly
15	9943-1721	Door Handle
16	9943-0901	Bottle Retainer
17	9943-0411	Caster Set (4 pc)
18	9943-1151	Heat Tent
19	9943-1161	Drip Tray
20	9942-3161	Grill - side
21	9943-5341	Main Burner
22	9943-2801	Igniter Switch
23	9943-1501	Knob & Bezel Kit
24	9943-1951	Control Panel Overlay
25	9943-0601	Trim Ring
26	9943-2601	Electrode Module
27	9943-0921	20" Igniter Wire
28	9943-6101	Hose/Valve/Regulator
29	9943-0351	Misc. Parts Kit
30	9941-3181	D-Griddle-Center (sold sepertely)

**REPAIR PARTS**

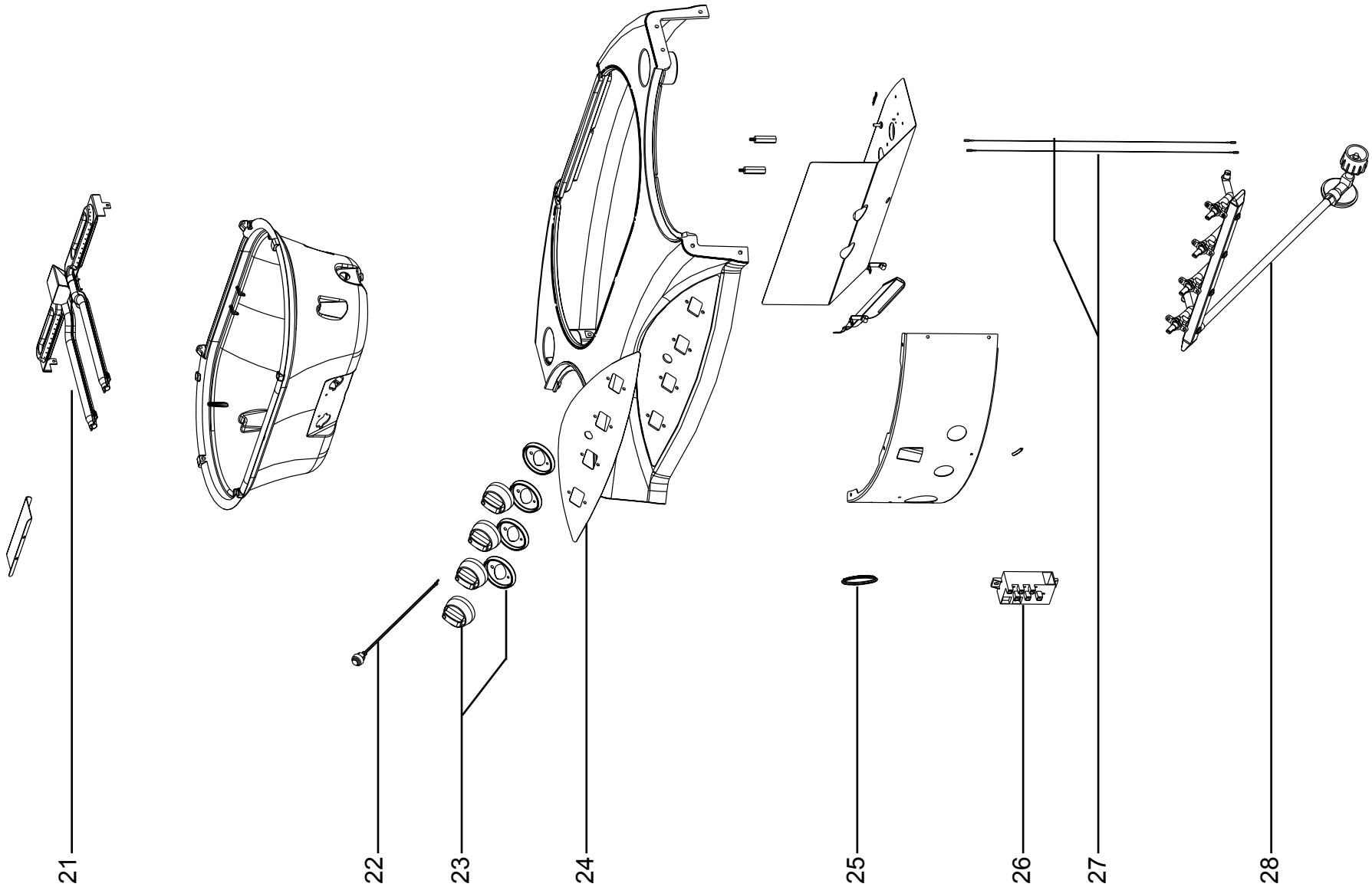

# REPAIR PARTS

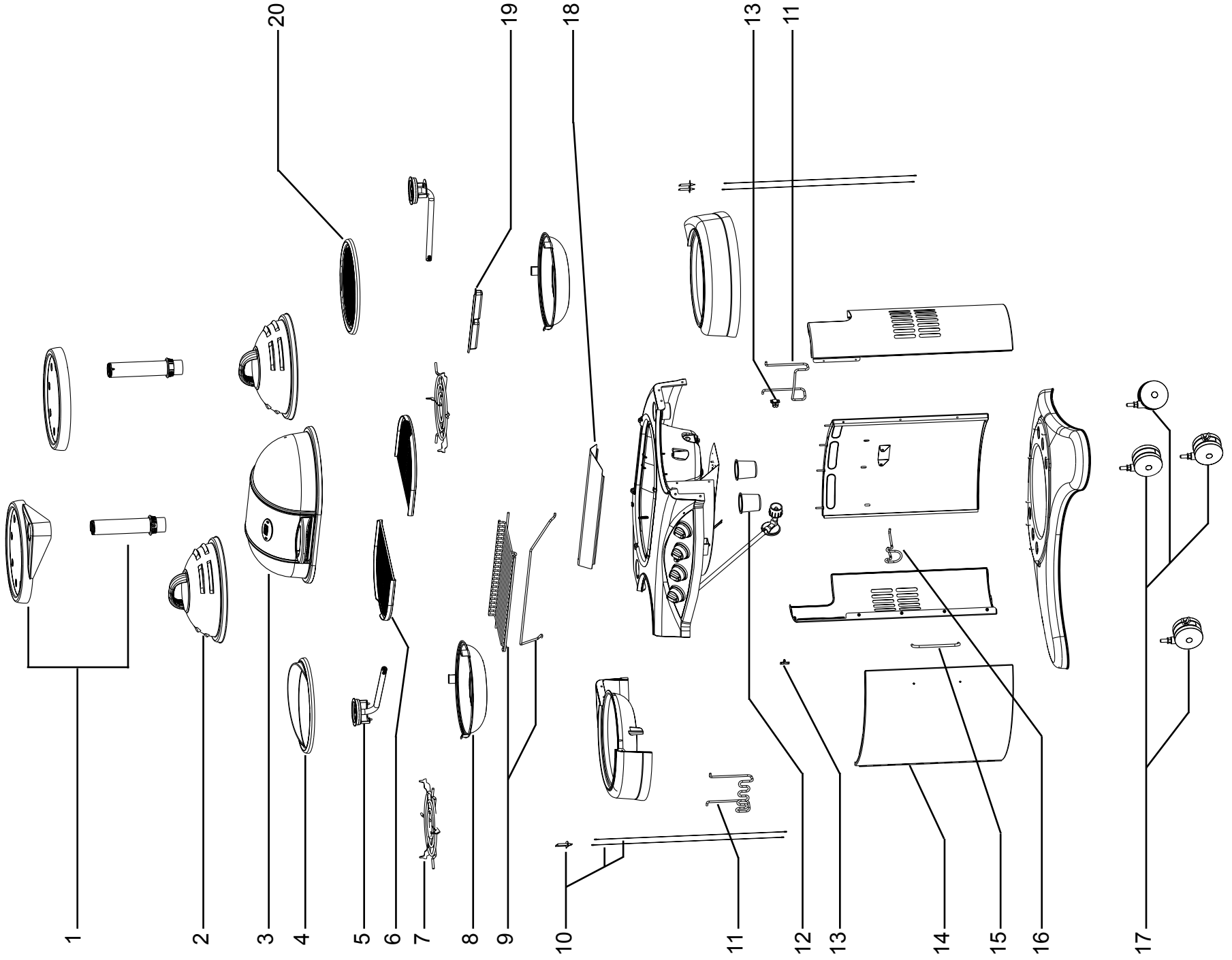

**COLEMAN GAS BARBECUE GRILL WARRANTY****CASTINGS - LIMITED LIFETIME****BURNER - LIMITED TEN (10) YEARS****ELECTRONIC IGNITION COMPONENTS - LIMITED THREE (3) YEARS****COOKING SURFACES - LIMITED (2) YEARS****OTHER PARTS - LIMITED ONE (1) YEAR**

The Coleman Company, Inc. ("Coleman") warrants that for the period that you own this product, it will be free from defects in material and workmanship. This warranty applies to the following parts for the following time periods: the castings are warranted for LIFETIME against burn through; the burner is warranted for ten (10) years; electronic ignition components are warranted for three (3) years; cooking surfaces are warranted for two (2) years; and other parts are warranted for one (1) year, except the propane cylinder and paint finish. We **DO NOT WARRANT** in any way the propane cylinder (see label on cylinder for cylinder manufacturer's warranty) or the paint finish of the product. Coleman, at its option, will repair or replace this product or any component of the product found to be defective during the warranty period. Replacement will be made with a new or remanufactured product or component. If the product is no longer available, replacement may be made with a similar product of equal or greater value. This is your exclusive warranty.

This warranty is valid for the original retail purchaser from the date of initial retail purchase and is not transferable. Keep the original sales receipt. Proof of purchase is required to obtain warranty performance. Coleman dealers, service centers, or retail stores selling Coleman products do not have the right to alter, modify or any way change the terms and conditions of this warranty.

This warranty does not cover normal wear of parts or damage resulting from any of the following: negligent use or misuse of the product, use on improper voltage or current, use contrary to the operating instructions, disassembly, repair or alteration by anyone other than Coleman or an authorized service center. Further, the warranty does not cover Acts of God, such as fire, flood, hurricanes and tornadoes.

Coleman shall not be liable for any incidental or consequential damages caused by the breach of any express or implied warranty. Except to the extent prohibited by applicable law, any implied warranty of merchantability or fitness for a particular purpose is limited in duration to the duration of the above warranty. Some states, provinces or jurisdictions do not allow the exclusion or limitation of incidental or consequential damages or limitations on how long an implied warranty lasts, so the above limitations or exclusion may not apply to you. This warranty gives you specific legal rights, and you may also have other rights that vary from state to state or province to province.

**DO NOT RETURN THIS PRODUCT TO THE PLACE OF PURCHASE.**

Take the product to an authorized Coleman service center. You can find the nearest authorized Coleman service center by calling 1-800-356-3612. If a service center is not conveniently located, you may call the same number for instructions on shipping the product to the Coleman Company, Inc. You may also call the same number if you have any questions concerning this warranty.

**NOT VALID IN MEXICO.****For WARRANTY, SERVICE and PARTS**

Locate your model number and serial number on the label found on the inside of your grill door.

**CARE AND CLEANING OF GRILL PARTS**

- ⇒ BEFORE cleaning any part of the grill, allow the grill to cool down completely.
- ⇒ Clean the grill with warm soapy water and a soft cloth.
- ⇒ NEVER USE OVEN CLEANERS.
- ⇒ To protect the integrity of your grill against the effects of the environment, use a grill cover when the grill is not in use.
- ⇒ Failure to comply with the owner's USE & CARE MANUAL INSTRUCTIONS & ASSEMBLY INSTRUCTIONS can void right of warranty.

**BEFORE USING YOUR GRILL****READ OWNER'S USE AND CARE MANUAL:**

- For proper filling and purging of the cylinder
- For leak testing all gas supply connections
- For correct grill lighting instructions
- For use and storage of the grill and cylinder

**⚠ WARNING!** The edges of sheet metal parts can cause injury if not handled with care.  
**USE EXTREME CAUTION!**

**⚠ WARNING! WHEN LEAK TESTING:**  
DO NOT smoke.  
DO NOT use fire to test for leaks.

**⚠ DANGER:**  
NEVER store a spare LP gas supply cylinder under the grill body nor inside grill enclosure to avoid the possibility of an explosion. Refer to the Use and Care manual.

**⚠ IMPORTANT:**  
Be sure to tighten up all hardware (screws, nuts, bolts, etc.) at least once a year or each grilling season.

Leak test gas supply connections outdoors as indicated by arrows.

