



KENAI™ 10'x8'

Instructions apply to Part Number 9234-908

When You Are Ready To Set Up Your Tent

- Select a level campsite clear of rocks, branches and other hard or sharp objects.
- Do not set up your tent under trees.
- For best results in windy conditions, do not position the door of tent into the wind.

POLE ASSEMBLY PARTS

Main Tent Poles

Part No. 9234-3301

Rainfly Pole

Part No. 9234-3311

Rainfly Part No. 9234-3321

1 Layout & Positioning of Tent, Pole Assembly

- Layout and position tent with door facing desired direction. (illus. 1)
- Unzip door.
- Stake down tent corners only, using the rings at the end of the stake loops. Keep the floor taut. (illus. 2)
- Assemble frame poles by interlocking shock-corded poles. This will make two long poles.
- Insert the poles diagonally into pole sleeves. The center of the poles should cross forming an "X" in the middle of tent. (illus. 1)

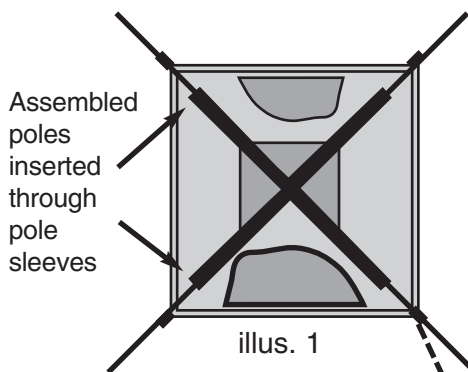

illus. 2
Tent stake through ring

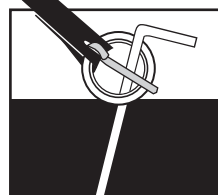

2 Connect Frame to Tent

- Insert one end of the main tent pole onto pin of pin & ring system, at the tent corner. (illus. 3)
- Go to opposite end of pole and gradually apply pressure to the pole forming an arch until you are able to insert the pin into the pole.
- Repeat for second pole. (illus. 4)



illus. 4
Tent frame set-up

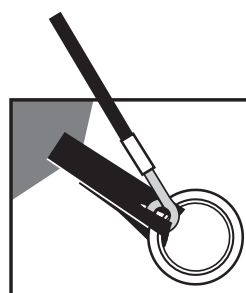

illus. 3
Insert pole end onto pin & ring

3 Attach Tent to Frame Using Frame Clips

- Attach frame clips along the edges of tent to frame poles. (illus. 5), (illus. 6)
- Make any adjustments to the tent corner stakes that are needed.



4 Attach Rainfly

- Assemble rainfly pole by interlocking shock-corded pole.
- Insert rainfly poles into pole sleeves located at the center edges of the underside of rainfly. (illus. 6)
- Drape rainfly over tent frame, pole side down. Rainfly poles should cover door and rear window.
- Connect the four elastic loops with “S” hooks, (found at the rainfly corners) to the fabric loops near frame clips. (illus. 9)
- Insert the tips of the rainfly poles into the grommets.
- Secure rainfly with attachments located on underside of fly. (illus. 10)
- Attach and stake out guylines. (illus. 10)

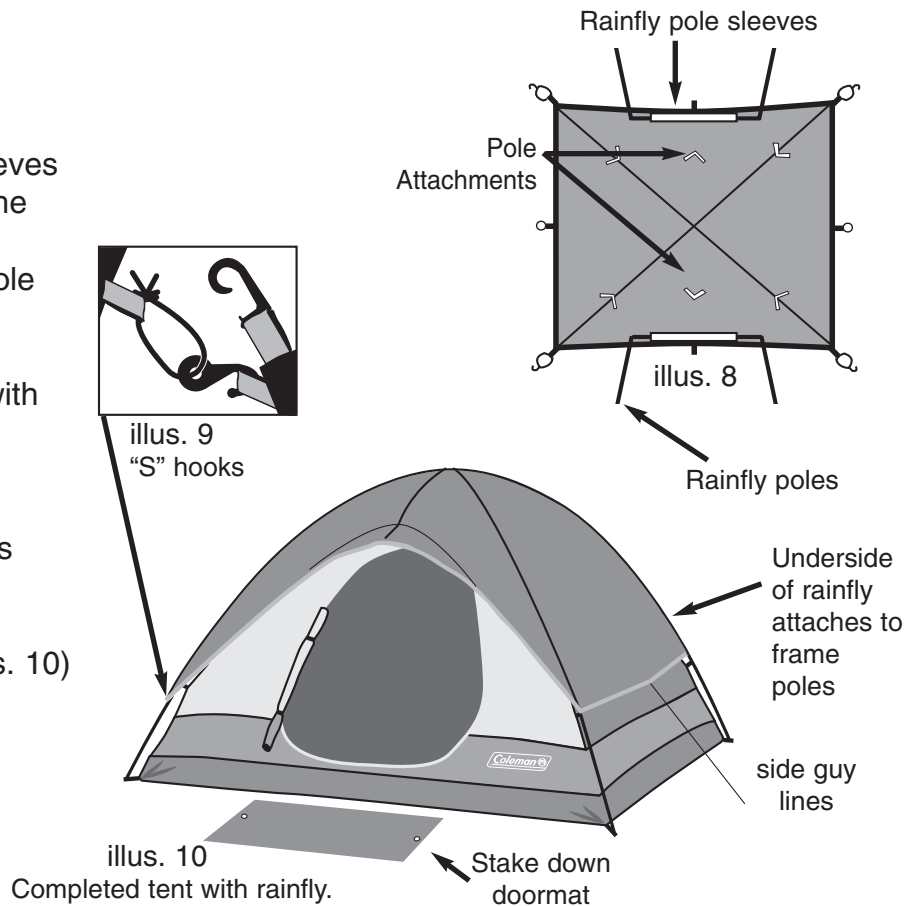

Things You Should Know

- Under certain conditions (cold weather, high humidity, etc.) condensation will form on the inside surfaces of your tent. Condensation is caused by water vapor from your breath, perspiration, or any wet clothing inside your tent. It is NOT LEAKAGE through the tent fabric. It can be minimized by removing wet clothing from your tent and by providing good ventilation through the tent.
- Never store tent, even for a short period of time, without drying it thoroughly and brushing off caked dirt. Do not pack stakes or poles inside your tent. Use a separate storage bag.
- STAKES SHOULD BE REMOVED BY PULLING ON THE STAKE ITSELF. NEVER PULL ON THE TENT FABRIC OR TENT STAKE LOOP TO REMOVE STAKE.
- TENT POLES SHOULD NOT BE LEFT TELESKOPED TOGETHER DURING STORAGE.
- Seam sealer has not been provided with your tent. For additional protection we recommend seam sealing your tent prior to camping. Seam sealer may be purchased through your local retailer or at your local sporting goods store.

- Do not leave your tent set-up for weeks at a time, be aware that exposure to the ultraviolet rays of the sun can seriously damage material and/or cause it to become discolored.

WARNING: KEEP ALL FLAME AND HEAT SOURCES AWAY FROM THIS TENT FABRIC. This tent meets the flammability requirements of CPAI-84. The fabric will burn if left in continuous contact with any flame source. The application of any foreign substance to the tent fabric may render the flame-resistant properties ineffective.



THE COLEMAN CO., INC.

3600 N. Hydraulic • Wichita, Kansas 67219

1-800-835-3278 • www.coleman.com

MADE IN CHINA