



# Assembly and Instruction Manual for Copper Fireplace

Model 5059-700



Follow these instructions for assembly and read carefully, particularly the safety statements. The safety alert symbol, **▲** is a universally recognized symbol used to identify safety information about hazards that can result in personal injury. When this symbol is used you should pay very close attention to what is written. Review these instructions before beginning assembly or using your fireplace.

**FOLLOW INSTRUCTIONS AND WARNINGS TO AVOID FIRE, SERIOUS INJURY OR DEATH.**

## ▲WARNING

- Outdoor use only. Never use in enclosed area. Use in unventilated areas will endanger your life.
- Keep away from all combustible materials including gasoline and other flammable liquids and vapors.
- Use on a level, noncombustible surface only. Keep away from house, garage, balconies, or eave overhangs.
- Keep out of the reach of children.
- Be sure screen is in place while in use and do not use in windy conditions.
- Do not overfill firebox or use to burn leaves and trash.
- Exercise the same care you would with an open fire.
- Never leave unit unattended when hot or in use.
- Completely extinguish fire before leaving.
- Use gloves when handling or moving. Ashes can remain warm for a long time after extinguishing.
- Dispose of cold ashes properly.
- Do not modify in any way nor use with parts not expressly approved by Coleman.
- Combustion by-products produced when using this product contain chemicals known to the State of California to cause cancer, birth defects, or other reproductive harm.

**Contact local authorities regarding possible burn restrictions before using product.**

### Fireplace Parts Check List

• Check package for all parts needed for assembly.

- |  |   |
|--|---|
| <input type="checkbox"/> 1. Firebox              | <input type="checkbox"/> 6. Hardware            |
| <input type="checkbox"/> 2. Grate                | <input type="checkbox"/> 7. Protective Cover    |
| <input type="checkbox"/> 3. Screen Assembly      | <input type="checkbox"/> 8. Screen Lifting Tool |
| <input type="checkbox"/> 4. Firebox Support Ring | <input type="checkbox"/> 9. Leg Support Ring    |
| <input type="checkbox"/> 5. Leg Brackets         |   |

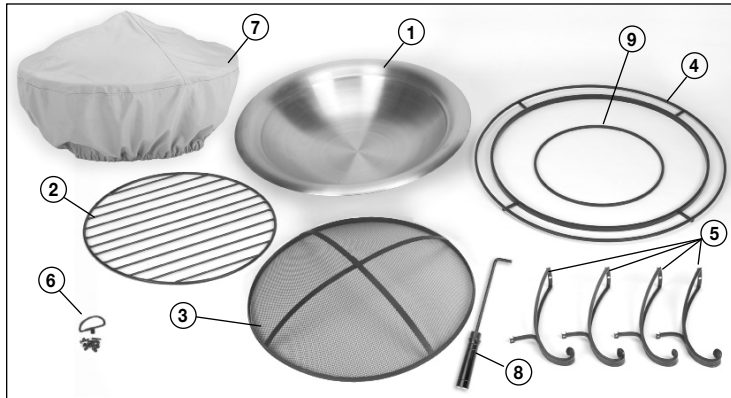

• Check all items for shipping damage. Call Coleman at 1-800-835-3278 or TDD: 316-832-8707 if you have any problems.

### Assembly

1. Carefully unpack all parts from shipping box.
2. Align holes in Leg Bracket and assemble to Leg Support Ring as shown. Attach with small bolt and nut. Hand tighten.

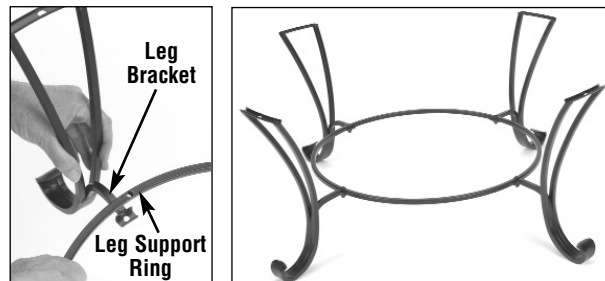

### Assembly (cont.)

3. Place Firebox Support Ring on top of Leg Brackets as shown. Carefully align holes as shown.

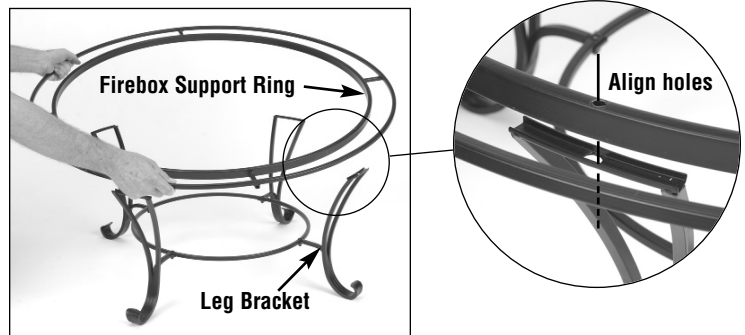

4. Insert long bolts and secure with nuts. Tighten all bolts in Leg Support Ring and Firebox Support Ring.

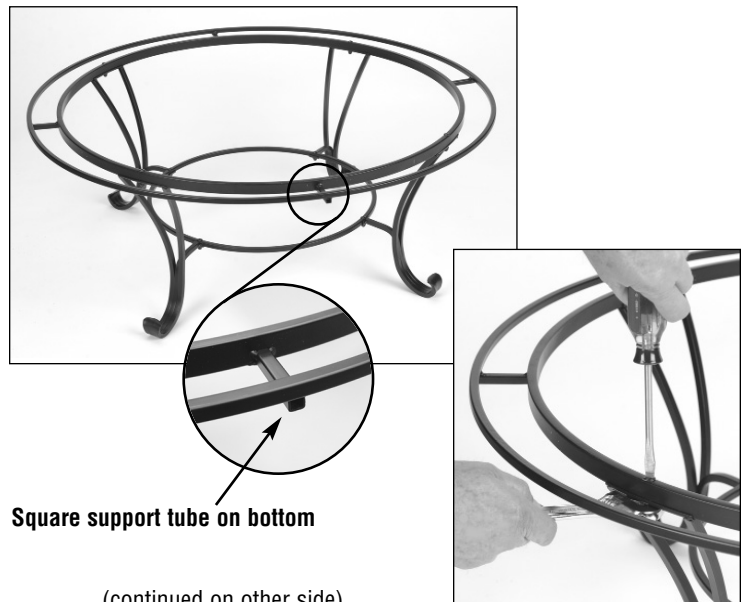

(continued on other side)

## Assembly (cont.)

- 5.** Place Copper Firebox into Firebox Support.



**Note:**

An inch or two of sand should be used in firebox beneath the grate.

- 6.** Place Grate into Firebox.



- 7.** Assemble handle to Screen Assembly and secure with screw.

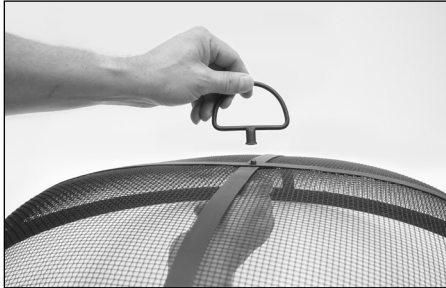

## Set Up and Use

### **⚠ WARNING**

*Never leave unit unattended when hot or in use. Keep out of reach of children. For outdoor use only. Never use in enclosed area. Use in unventilated areas will endanger your life.*

- 1.** Place unit on a level, noncombustible surface. Keep well away from house, garage, balconies or eave overhangs. Do not use on wooden decks.

- 2.** Be sure grate is placed in firebox. Add newspaper, kindling & wood on top of grate.

- 3.** Ignite newspaper & kindling with match or butane lighter. Use charcoal lighter fluid if necessary.

- 4.** Once fire is lit, place screen assembly on top of firebox.

- 5.** Screen handle is hot when in use. Use the Screen Lifting Tool to remove screen.



## After Use

### **⚠ WARNING**

*To avoid burns – use heavy gloves to remove screen assembly and grate.*

1. Completely extinguish fire before leaving.
2. Do not use water to douse the fire as this may warp the firebox.
3. Dispose of cold ashes properly.
4. Be careful – fire may be out but firebox can still be hot. Handle carefully.
5. Store in covered enclosure.

## Repair Parts List

I.D. NO.	PART NO.	DESCRIPTION
1	5059-2001	Screen Assembly
2	5059-4001	Grate
3	5059-5001	Leg Bracket
4	5059-1001	Protective Cover
5	5059-3041	Screen Lifting Tool
6	5059-4301	Hardware Package

## Coleman Limited One-Year Warranty

The Coleman Company, Inc. ("Coleman") warrants that for a period of one year from the date of original retail purchase, this product will be free from defects in material and workmanship. Coleman, at its option, will repair or replace this product or any component of the product found to be defective during the warranty period. Replacement will be made with a new or remanufactured product or component. If the product is no longer available, replacement may be made with a similar product of equal or greater value. This is your exclusive warranty.

This warranty is valid for the original retail purchaser from the date of initial retail purchase and is not transferable. Keep the original sales receipt. Proof of purchase is required to obtain warranty performance. Coleman dealers, service centers, or retail stores selling Coleman products do not have the right to alter, modify or in any way change the terms and conditions of this warranty.

This warranty does not cover normal wear and tear, including chips, scratches, abrasion, discoloration or fading from use or exposure to sunlight. Damage caused by misuse, abuse, neglect, alterations, repairs by unauthorized persons, use of non-Coleman accessories or parts, commercial use, or failure to follow recommended care or maintenance instructions. Further, the warranty does not cover Acts of God, such as fire, flood, hurricanes and tornadoes.

**COLEMAN SHALL NOT BE LIABLE FOR ANY INCIDENTAL OR CONSEQUENTIAL DAMAGES CAUSED BY THE BREACH OF ANY EXPRESS OR IMPLIED WARRANTY OR CONDITIONS. EXCEPT TO THE EXTENT PROHIBITED BY APPLICABLE LAW, ANY IMPLIED WARRANTY OF MERCHANTABILITY OR FITNESS FOR A PARTICULAR PURPOSE IS LIMITED IN DURATION TO THE DURATION OF THE ABOVE WARRANTY OR CONDITIONS. SOME STATES, PROVINCES, OR JURISDICTIONS DO NOT ALLOW THE EXCLUSION OR LIMITATION OF INCIDENTAL OR CONSEQUENTIAL DAMAGES OR LIMITATIONS ON HOW LONG AN IMPLIED WARRANTY LASTS, SO THE ABOVE LIMITATIONS OR EXCLUSION MAY NOT APPLY TO YOU. THIS WARRANTY GIVES YOU SPECIFIC LEGAL RIGHTS, AND YOU MAY ALSO HAVE OTHER RIGHTS THAT VARY FROM STATE TO STATE OR PROVINCE TO PROVINCE.**

### How to Obtain Warranty Service

Take the product to an authorized Coleman service center. You can find the nearest authorized Coleman service center by calling 1-800-835-3278 or TDD 316-832-8707 in the United States. If a service center is not conveniently located, attach to the product a tag that includes your name, address, daytime telephone number and description of the problem. Include a copy of the original sales receipt. Carefully package the product and send either by UPS or Parcel Post insured with shipping and insurance prepaid to:

For products purchased in the United States:

The Coleman Company, Inc.  
3600 North Hydraulic  
Wichita, KS 67219

Do not mail products with fuel in tanks, or with disposable propane cylinders. Remove glass globes from lanterns and wrap separately.

**DO NOT RETURN THIS PRODUCT TO THE PLACE OF PURCHASE.**

If you have any questions regarding this warranty please call 1-800-835-3278 or TDD 316-832-8707 in the United States.

The Coleman Company, Inc. • 3600 N. Hydraulic • Wichita, KS 67219  
1-800-835-3278 • TDD: 316-832-8707

©2004 The Coleman Company, Inc. All rights reserved. Coleman® is a registered trademark of The Coleman Company, Inc.

Coleman® and  are registered trademarks of The Coleman Company, Inc.

5059A050 (7/6/04)