

**DO NOT REMOVE PRIOR TO SALE!**

**OWNER'S MANUAL**

**MODEL 33A43-S27**

**APPROVED ONLY WHEN WORN**

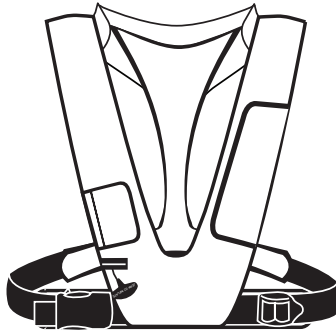

**I. APPROVAL CONDITIONS and CARRIAGE REQUIREMENTS**

This inflatable is approved by the U.S. Coast Guard as a **Special Use Type V Convertible PFD** because the inflator on this product functions in a manual or automatic mode. When armed to function in an automatic mode, this PFD meets Type II PFD performance requirements since it will automatically inflate when submerged in the water. When armed in a manual **only** mode this PFD meets Type III PFD performance requirements since you must pull the “Jerk to Inflate” tab to inflate the PFD. See Pages 8 and 9 for rearming instructions. **The user must be aware of which mode the PFD is in.** It will provide Type II in-water performance that will turn the wearer from a face down to a face up position and provide support suitable for offshore conditions.

Inflatable PFD's are not approved for water skiing or other high impact, high-speed activities. This inflatable was designed to be more comfortable and less restrictive to wear than inherently buoyant PFDs. When worn, used and serviced according to this owner's manual, this PFD can greatly increase your chances of survival in the water. **Not recommended for non-swimmers or weak swimmers.** Users of inflatable PFDs must be at least 16 years old.



# MECHANISM PARTS LIST

**Mechanism with CO2 Cylinder Attached**

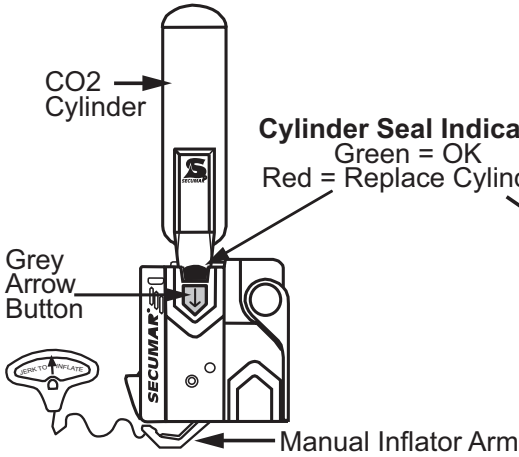

**CO2 Cylinder Only**

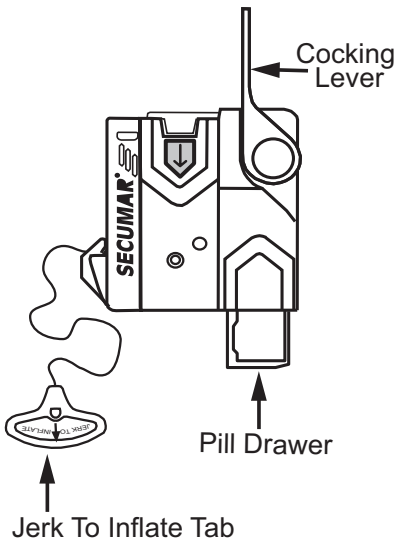
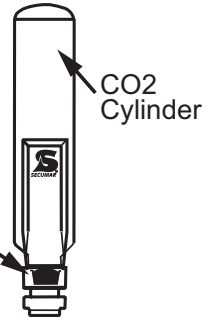

**Manual Override Tab**



**Pill Cage Assembly-**



Grey Plastic Cage and White Pill - Pill is not removeable.  
If pill is not visible or is damaged,  
**DO NOT USE!**

**Rearming Kit 0924 (parts needed):  
1-33 Gram CO2 Cylinder w/ Bayonet and 1 Pill Cage**

2007-02-19

## **SPECIFICATIONS**

**Chest Size:** 30 - 52 inches (76 - 132 cm)

**Weight Range:** More than 90 pounds (41 kg)

**Age Range:** 16 years of age and older

**Buoyancy (minimum):** 33.7 Pounds (150 Newtons) when fully inflated

**Inflation System:**

**Manual/Automatic Inflation Mechanism** (located on your right side)

**Oral Tube** (located on your left side)

**Pull Tab** (located on your right side)

used to manually activate the inflation mechanism and inflate the PFD.

**CO2 Cylinder:** 33 gram, with cylinder seal indicator.

***USE REARMING KIT #0924***

**Indicators:**

For the PFD to be fully armed, a cylinder must be inserted into the mechanism and the cylinder seal indicator must be Green.

## **I. MANDATORY CARRIAGE REQUIREMENTS**

Federal Regulations in 33 CFR 175-1993 require you to carry Coast Guard approved personal flotation devices (PFDs) legibly marked with the Coast Guard approval number, which are in good and serviceable condition and are the correct size for each person on board. To be considered serviceable, this PFD shall not exhibit deterioration that could diminish its performance such as broken or deformed hardware, detached webbing, rotted structural components, air leaks or nonfunctional oral inflation tube. Unless worn inflated, this PFD must also be properly armed with a full CO2 cylinder, in either the "Manual Only" or "Automatic Backup" mode. When armed in the "Manual Only" mode, the PFD will have a cylinder with a Green cylinder seal indicator installed in the mechanism, and a "Manual Only" tab installed in the pill drawer. When armed in the "Automatic Backup" mode, the PFD will have a cylinder with a Green cylinder seal indicator installed in the mechanism, and a pill cage assembly installed in the pill drawer. See Pages 8 and 9 for instructions. A PFD which is "approved only when worn" or "required to be worn" must be worn under the specified conditions.

## II. INSTRUCTIONS FOR USE

### PRE-DONNING INSTRUCTIONS

#### **CHECK THE FOLLOWING BEFORE EACH USE OR OUTING:**

1. INSPECT PFD FOR DAMAGE
2. BE SURE A CYLINDER IS INSERTED INTO THE MECHANISM AND CYLINDER SEAL INDICATOR IS GREEN.
3. CHECK TO BE SURE THERE IS A MANUAL OVERRIDE TAB STOWED IN THE ACCESSORY POCKET. A SPARE CO2 CYLINDER MAY ALSO BE PROVIDED.

### **READ BELOW FOR MORE DETAILED INFORMATION!**

#### **1. Inspecting Your PFD For Damage**

Make sure that the PFD is free from rips, tears or punctures. This type of damage on the outside covering indicates that the ***Inflatable Chamber*** may have been exposed to potentially damaging elements. If these defects expose the yellow inflatable chamber material, discontinue use of the PFD until you have the PFD inspected by an authorized repair facility. If these defects are noticed but the yellow inflatable chamber material is not exposed, the ***Inflatable Chamber*** should be checked for leaks. The ***Inflatable Chamber*** should also be checked for leaks at the beginning of each season and at least every two months during the boating season. The leak test procedure is described under **USER'S INSPECTION**. (Refer to Page 12 and 13.)

#### **2. How to Inspect the Mechanism**

The mechanism is located on your right side under the protective cover. Before inspecting the mechanism remove the CO2 cylinder to prevent unnecessary discharge.

Be sure the cocking lever is in a locked position. The CO2 cylinder contains the gas charge that will inflate your PFD when the inflation mechanism is fired either automatically or manually. You must verify that the CO2 cylinder installed is of the correct size specification and has not been previously fired.

Check the pill cage assembly to be sure that the pill is not cracked or otherwise damaged. To do this, first remove the CO2 cylinder, lift the cocking lever and remove the pill cage. If the pill in the pill cage assembly is cracked or damaged, replace with a new pill cage

assembly, as shown in rearming instructions on Page 8 or 9.

Be sure that a cylinder is inserted into the mechanism and that the cylinder seal indicator shows Green. If the indicator shows Red, replace with a new cylinder following the rearming instructions on Page 8 or 9.

If a new pill cage assembly is not available, replace with the Manual Override Tab that is stowed in the accessory pocket. **REMEMBER: Your PFD is now on a Manual Mode and will not inflate automatically and it is your responsibility to let any other users know this.**

### **Additional Notes on CO2 Cylinders:**

- FAILURE to properly rearm the inflation mechanism prior to installing the CO2 Cylinder will result in premature activation of the cylinder.
- CO2 Cylinders are only good for **one** (1) inflation and cannot be recharged.
- CO2 Cylinders are made with a protective coating that may wear off after a period of use or exposure to the environment. When this coating is worn off, the CO2 Cylinder may start to show some signs of rusting. If this occurs, replace the CO2 Cylinder.
- If a gram scale (such as a postal scale) is available, it is recommended to weigh the cylinder to verify that it meets the minimum weight imprinted on the cylinder.

## DONNING INSTRUCTIONS

Practice closing hardware and adjusting before use or prior to in-water testing.



**Step 1 -**  
Insert arm between  
back strap and vest.



**Step 2 -** Pull vest  
on over your head.



**Step 3 -** Buckle belt around  
your waist and adjust **BOTH**  
side adjustments to a snug fit.

*Created: 2007-11-02*

After donning, locate the **Jerk To Inflate** tab for the mechanism. It should protrude from the PFD as shown on the pictogram. Make sure that you are comfortable locating the **Jerk To Inflate** tab with either hand. Should an emergency develop, be prepared to use it! **Always wear your PFD over, not under clothing.**

**Caution:** bulky clothing may affect the ability of this PFD to turn the wearer to a face-up position in the water.

Practice closing hardware and adjusting straps before use or prior to in-water testing.

## INFLATED DONNING INSTRUCTIONS

Inflatable PFDs can be very difficult to don when fully inflated. Deflate through the Oral Tube until enough gas has escaped to don. See DEFLECTION INSTRUCTIONS on Page 10. Don as described above and re-inflate orally as described on Page 7.

## **INFLATION INSTRUCTIONS**

See Pages 14-17 for additional information on testing and inflating your PFD.

1. **Manual Inflation** - To inflate, grasp the ***Jerk to Inflate*** tab and pull sharply downward.
2. **Automatic Inflation** - The automatic ***Inflation Mechanism*** will activate when the device is totally immersed in water. Depending upon temperature, the device will obtain full buoyancy within 5 to 10 seconds. It is recommended that the user regard the automatic system as a backup and always be prepared to pull the ***Jerk to Inflate*** tab upon immersion.
3. **Oral Inflation** - The ***Oral Tube*** is located on the wearer's left side. Grasp the ***Oral Tube*** and bring to mouth. Blow air through the ***Oral Tube*** until the ***Inflatable Chamber*** is firm. **If the chamber becomes soft due to CO2 permeance, Oral Inflation will be necessary to maintain full buoyancy.** Whenever you orally inflate the PFD it would be a good practice to remove the CO2 cylinder prior to inflating. If you plan on going into the water after oral inflation, also remove the pill cage so it may be reused when rearming the PFD.
4. **Cold Inflation** - Oral Inflation may be required in addition to manual or automatic inflation if chamber is not firm due to cold temperatures at or below 40° F (4° C). Inflation time using CO2 gas will be longer at these temperatures. Activation of automatic system may also be slower. **Always be prepared to use the manual inflation system!** See FREEZING TEMPERATURES on Page 10.
5. **Other Inflation Precautions**
  - **Caution:** Do not fully inflate orally then manually or automatically inflate with the CO2 cylinder. Repeated CO2 inflation after oral inflation will damage the PFD to the point that it will not hold air or float.
  - When armed in automatic mode, never orally inflate out of the water and then go into the water because the CO2 system will automatically inflate, which could damage the PFD.
  - **Never** inflate this PFD with a Pump or Air-Compressor.
  - Permeation loss is greater when the device is inflated with CO2 than with air, and earlier replenishment by means of the oral inflation system will be necessary after several hours.

# SECUMATIC 4001 REARMING/STATUS INDICATOR INSTRUCTIONS FOR MANUAL/AUTOMATIC INFLATION

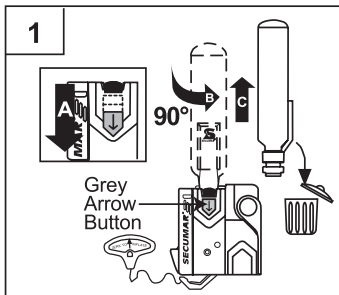

- A. To **unlock** cylinder, slide grey arrow button away from cylinder and hold.
- B. Turn cylinder 90° while holding button.
- C. Pull to remove.

Discard cylinder if indicator is **RED**.  
If indicator is **GREEN**, save cylinder for re-use.

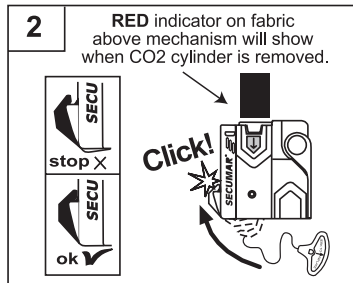

Close manual lever arm, if open.

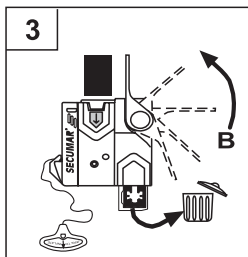

Lift cocking lever "B" and remove pill cage or manual override tab (whichever applies).

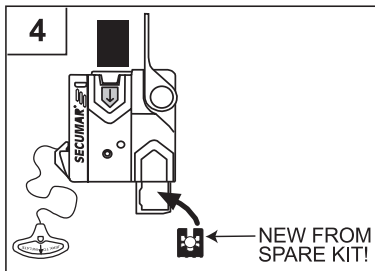

Insert new pill cage. Pill cage will sit flush in housing and will only fit in one direction.

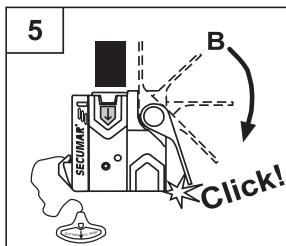

Pull cocking lever down to close pill cage housing.

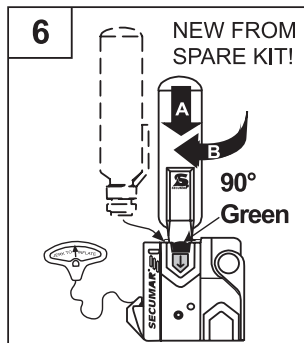

Push cylinder into housing and rotate 90° clockwise until it locks into place and **GREEN** indicator shows in window. The mechanism is now rearmed and ready for use.

**DO NOT USE A PILL CAGE PAST THE EXPIRATION DATE PRINTED ON THE CAGE.**



# SECUMATIC 4001 REARMING/STATUS INDICATOR INSTRUCTIONS FOR MANUAL ONLY INFLATION

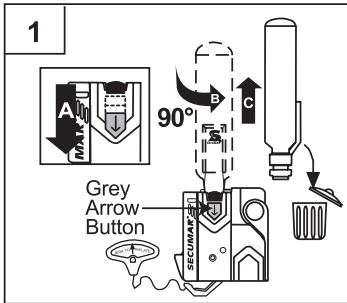

- A. To **unlock** cylinder, slide grey arrow button away from cylinder and hold.
- B. Turn cylinder 90° while holding button.
- C. Pull to remove.

Discard cylinder if indicator is **RED**.  
If indicator is **GREEN**, save cylinder for re-use.

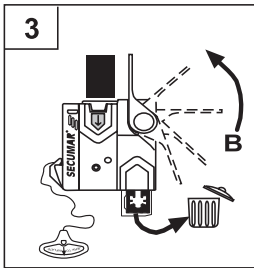

Lift cocking lever "B" and remove pill cage or manual override tab (whichever applies).

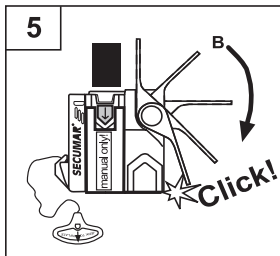

Pull cocking lever down to close pill cage housing.

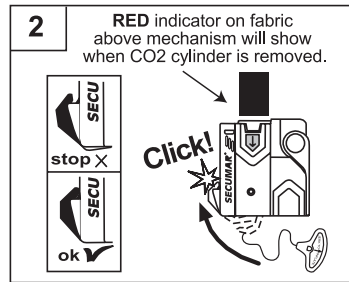

Close manual lever arm, if open.  
**If Manual Override Tab is already in place, go to Step 6.**

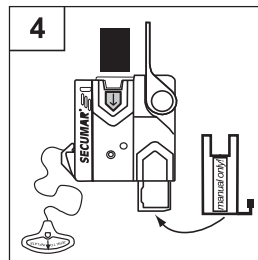

Insert Manual Override Tab. Manual Override Tab will sit flush in housing and will only fit in one direction.

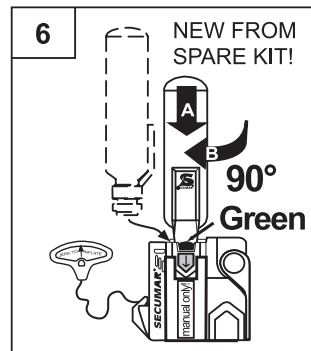

Push cylinder into housing and rotate 90° clockwise until it locks into place and **GREEN** indicator shows in window. The mechanism is now rearmed and ready for use.

## **DEFLATION INSTRUCTIONS**

Depress **Oral Valve** (located inside end of **Oral Tube**) using either the protective cap or tab provided by inserting into the end of **Oral Tube**, see drawing. Gently compress air out of the inflatable chamber while depressing the **Oral Valve**.

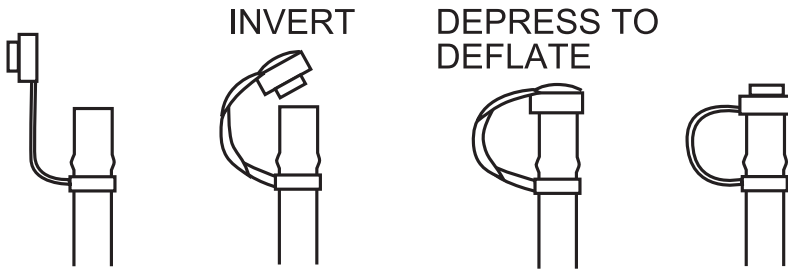

### **DO NOT TWIST OR WRING INFLATABLE CHAMBER TO DEFLATE.**

If for any reason the Oral Valve remains open, depress it several times. If it does not release, discontinue use of this PFD and take it to a certified repair station. (See Page 14 for repair station locations/information.) In an emergency situation, hold thumb over the valve if it will not close, or fold the oral tube in half and squeeze together. Refer to page 11 for Repacking Instructions.

## **FREEZING TEMPERATURES**

Never use in below freezing temperatures, unless worn partially inflated. At or below 40° F (4° C) automatic activation and inflation time with CO<sub>2</sub> gas will be longer. Wearing a partially inflated PFD in these conditions will provide some initial buoyancy while the PFD fully inflates.

**Caution:** Do not fully inflate orally and then inflate with the CO<sub>2</sub> cylinder. Repeated CO<sub>2</sub> inflation after oral inflation will damage the PFD to the point that it will not hold air or float.

## **REPACKING INSTRUCTIONS**

Always **deflate** the PFD and **rearm** the **Inflation Mechanism** - follow REARMING Instructions prior to REPACKING!

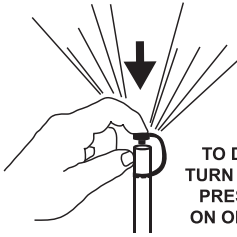

TO DEFLATE:  
TURN OVER CAP,  
PRESS DOWN  
ON ORAL TUBE.

**1. DEFLATE** chamber completely, smoothing flat.

**2. RE-ARM** mechanism.

**CAUTION:** Check to see that the cylinder is tucked under protective flap.

Protective Flap

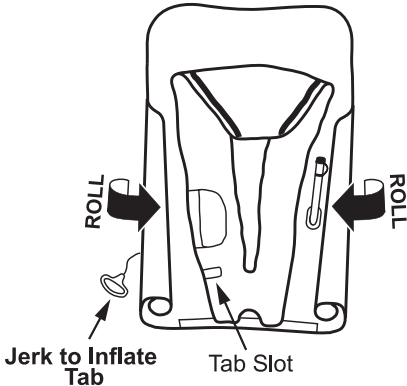
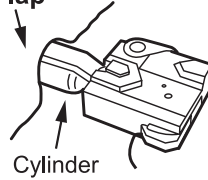

**3. ROLL** sides of chamber into shell. **SECURE** Velcro® along sides of device. **LOOP** *Jerk to Inflate Tab* through tab slot when closing inflator side.

**4. ROLL** top corners in. **FOLD** top of chamber back (in half). **SECURE** remaining Velcro® at top and bottom of device.

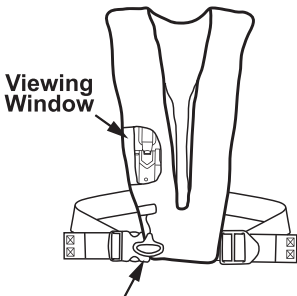
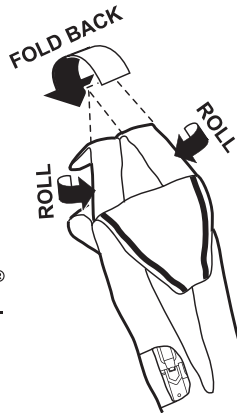

Jerk to Inflate Tab

### **IMPORTANT!**

Check to see that the **Jerk to Inflate Tab** is hanging free and the cylinder indicator is visible through the viewing window.

Created: 2007-11-05

## **OTHER USE GUIDELINES**

1. Always wear your PFD when underway unless you are inside a cabin.
2. If you need to jump from any height always fold arms over your chest to keep the PFD in place when entering the water.
3. Avoid all unnecessary activities that will be abrasive to the device.
4. Use extreme caution around sharp objects.
5. Avoid unnecessary exposure to the sunlight. See GENERAL PRODUCT LIFE EXPECTANCY below.
6. CO<sub>2</sub> gas from the cylinder will permeate through the chamber fabric over time. If you are in the water for a long time, it may be necessary to top off the inflatable orally, by blowing air in through the oral tube.
7. Inflatable PFDs are not designed for activities in which the wearer expects to encounter impact with the water at a high speed such as water skiing, riding personal watercraft, etc.
8. Inflatable PFDs are not designed for white water activities.
9. For Inflatable PFDs that have a manual-auto inflator, dropping the PFD into the water or exposing the inflation system to unnecessary water spray, will result in an inadvertent inflation.

## **III. IS YOUR PFD IN GOOD AND SERVICEABLE CONDITION?**

Check your PFD between outings to be sure that it is properly armed; that it is free of rips, tears or holes; that all seams are securely sewn; and that the fabric, straps and hardware are still strong. Inspect the inflatable portion of the PFD in accordance with Care and Maintenance Instructions.

## **IV. CARE AND MAINTENANCE INSTRUCTIONS** **GENERAL PRODUCT LIFE EXPECTANCY**

The reliability and service life of this PFD depends greatly upon how it is used and cared for. Avoid storing PFD in direct sunlight. Sunlight contains ultraviolet radiation that weakens synthetic materials. Prolonged exposures to high temperatures and high humidity may shorten service life of this PFD. While it is known that these elements degrade the materials, every use environment is unique so there is no sure way to estimate how long the PFD will last. It is for this reason that you must follow the care and cleaning instructions and perform the maintenance and service checks. This will assure that the PFD remains functional and will maximize the useful life of this PFD. Failure to follow these instructions rigorously could result in a non-functioning PFD causing **injury or death**.

## **USER'S INSPECTION**

The users should perform the following checks before each season, or before a long journey, or before each outing, as recommended below:

1. **Physical Inspection of Cover and Straps** - Examine outer shell fabric, seams, webbing attachments, buckles, slides, etc. Fabric fading can indicate

a loss of strength. Check for strength by pulling seams and attachments snugly. If device shows any signs of damage, return to a certified Stearns Repair Facility or replace the entire device. This inspection should be performed each outing.

- 2. Oral Inflation Leak Test** - This test should be performed every two months and at the start of each season. Inflate buoyancy chamber using the oral inflation valve and leave to rest for 16 hours. When buoyancy chamber remains firm and full of air, there is no leakage and chamber is operational. If the chamber deflates during this leak test, immediately bring to a certified Stearns Repair Facility for repair. The device is no longer in operational condition.
- 3. Automatic Inflation System** - This test should be performed during years when the PFD is not inspected by a certified Stearns Repair Facility, and will expend your CO2 cylinder and pill. So make sure you have a rearm kit before conducting this test. With device packed as normal, immerse the device into a tub of water and see if it inflates. DRY, REARM and REPACK as shown on Pages 8, 9 and 11.
- 4. Function Test of Oral Valve** - With the PFD inflated, remove the dust protection cap, and test the valve by pushing it down using the tab provided on the cap (refer to Page 10). The valve should depress easily, and when released it should automatically return to the closed position and reseal.

### **REARMING KIT(S)**

Use Rearming Kit No. 0924. See Rearming Instructions on Pages 8 and 9.

### **CARE AND CLEANING INSTRUCTIONS**

**Drying** - If the device is wet, place on a coat hanger to allow thorough drying. Do not place in direct sunlight to dry. Do not use any heat source or place on radiator.

**Cleaning** - Damp wipe only with mild detergent recommended for synthetic fabrics. Remove grease and oil immediately. After every use, and before rinsing, first remove CO2 cylinder and pill cage assembly and rinse well with fresh water. Read instructions provided on the device.

- **DO NOT MACHINE WASH**
- **DO NOT MACHINE DRY**
- **DO NOT DRY CLEAN**
- **DO NOT BLEACH**
- **DO NOT USE SOLVENT BASED CLEANERS**

### **STORAGE**

- Store your pill cage (water sensing element) in a ventilated package, **do not** store in a sealed container.
- Store in clean, cool, dry area.
- Do not store pill cage assemblies in high humidity or high temperatures (over 100°F) for an extended time.
- Do not store pill cage assemblies for more than 18 months before use.

## **REPAIR**

If you have any question about the condition or integrity of this product call 1-800-783-2767. **A damaged device must be repaired by certified Stearns Repair Facility or discarded.**

## **SERVICING**

Stearns strongly recommends that this device be inspected at least every 24 months by a certified Stearns Repair Facility or STEARNS® Inc. Call 1-800-783-2767 for your nearest authorized Stearns Repair Facility.

## **V. WHY ARE PFDS REQUIRED SAFETY EQUIPMENT?**

Drownings are the leading cause of fatalities involving recreational boating. A PFD provides flotation to help keep your head above water, help you to stay face up in the water, and increase your chances for survival and rescue. Most adults only need an extra 7 to 12 pounds (31 to 53 Newtons) of flotation to keep their heads above water. The proper size PFD will properly support the weight of the wearer. Since this inflatable PFD does not have inherent buoyancy, it provides flotation only when inflated. Familiarize yourself with the use of this PFD so that you will know what to do in an emergency.

## **VI. HOW AND WHY TO TEST YOUR PFD?**

Inflate your PFD and try it out in the water to:

- **Make sure it floats you:**
  - Comfortably (When worn properly)
  - Adequately for expected wave conditions  
(Body shapes/densities affect performance)
  
- **Make sure it works:**
  - A flow of bubbles should not appear  
(See Section IV on Page 13 for leak tests)
  - It should inflate quickly and easily
  
- **Learn how it works by:**
  - Activating the CO2 inflation system
  - Rearming the CO2 inflation system
  - Using the Oral inflator tube

The U.S. Coast Guard recommends that you purchase two automatic rearming kits. One to be used immediately in testing the automatic inflation system (see HOW DO YOU TEST YOUR PFD USING THE AUTOMATIC INFLATOR?) and the other to carry on board as a spare.

Since you should replace the pill cage assembly (water sensing element) each year, the U.S. Coast Guard recommends you test the automatic inflation system in-the-water at the beginning of each boating season. By doing this, you demonstrate that the automatic inflation system is still working properly and

reduce the likelihood of premature inflation and its associated dangers. The only check of the manual inflation system (with CO2 cylinder with the green indicator tab removed, and with either the pill cage or the manual only tab installed) would be to determine that the lever arm and piercing shaft move freely when moving the lever (attached to the pull tab) several times down and up.

## **HOW DO YOU TEST YOUR PFD USING THE AUTOMATIC INFLATOR?**

1. To test your inflatable PFD, you will need:
  - Your **fully armed PFD**, and
  - **Rearming kit** approved for your PFD. (This kit contains a CO2 cylinder and pill cage assembly that you will need to use following this test.)
2. Put on the PFD.
3. Get into shallow water, just deep enough that you can stand with your head above the surface. Once the automatic inflator is under water the PFD should automatically, fully inflate within 10 seconds.
4. See if the PFD will float you on your back or just slightly back of vertical. In a relaxed floating position, verify that your mouth is well above the water's surface. Note the effect of where you hold your legs on how you float.
5. Get out of the water and remove the PFD. Remove the used CO2 cylinder and the used pill cage assembly (automatic inflator element) from the PFD inflator. Deflate the PFD using the oral inflator.
6. Let the PFD dry thoroughly. **REARM** and **REPACK** (refer to Pages 8, 9 and 11) the PFD in accordance with the manufacturer's instructions!

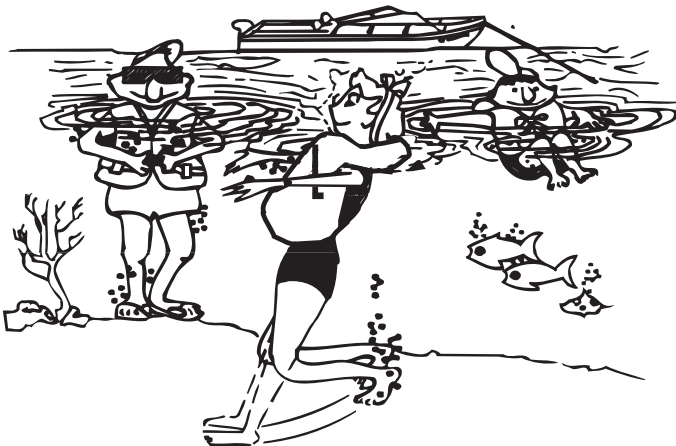

## HOW DO YOU TEST YOUR PFD USING THE MANUAL INFLATOR?

1. To test your inflatable PFD, you will need:
  - Your **fully armed PFD**, with the manual override tab in place, and
  - **Rearming kit** approved for your PFD. (This kit contains a CO2 cylinder and pill cage assembly that you will need to use following this test.)
2. Put on the PFD.
3. Actuate the inflation system by jerking firmly downward on the pull tab. The PFD should fully inflate within 5 seconds.
4. Get into shallow water, just deep enough that you can stand with your head above the surface.
5. See if the PFD will float you on your back or just slightly back of vertical. In a relaxed floating position, verify that your mouth is well above the water's surface. Note the effect of where you hold your legs on how you float.
6. Get out of the water and remove the PFD. Remove the used CO2 cylinder from the PFD inflator. Completely deflate the PFD using the oral inflator.
7. Let the PFD dry thoroughly. **REARM** in a manual only or automatic mode and **REPACK** the PFD in accordance with the manufacturer's instructions (refer to Pages 8, 9 and 11)!

## HOW DO YOU TEST YOUR PFD USING THE ORAL INFLATOR?

1. To test your inflatable PFD, you will **not need any spare parts or rearming kits**.
2. Remove the CO2 cylinder and pill cage assembly (if installed), to prevent inadvertent activation of the automatic inflation system, which could potentially damage the PFD. If the PFD was armed in the manual only mode, the "Manual Only" tab does not have to be removed.
3. Put on the PFD.
4. Get into shallow water, just deep enough that you can stand with your head above the surface.
5. If you are a weak swimmer or non-swimmer, inflate the PFD partially so that you are supported well enough to be able to complete inflation without touching bottom, either orally or manually. Note this level of inflation because it is the minimum needed for you to safely use this inflatable PFD.



6. Fully inflate the PFD using the oral inflator.
7. See if the PFD will float you on your back or just slightly back of vertical. In a relaxed floating position, verify that your mouth is well above the water's surface. Note the effect of where you hold your legs on how you float.
8. Get out of the water and remove the PFD. Completely deflate the PFD using the oral inflator.
9. Let the PFD dry thoroughly. **REARM** and **REPACK** the PFD in accordance with the manufacturer's instructions! Refer to Pages 8, 9 and 11.

## **VII. WEAR YOUR PFD**

In approximately 80 percent of all boating fatalities, the victims were not wearing a PFD. Most fatal accidents happen on calm sunny days. This inflatable PFD is much more comfortable to wear than other PFD types. Get into the habit of wearing this PFD. Non-swimmers and children especially should wear a hybrid or non-inflatable PFD at all times when on or near the water.

## **VIII. HYPOTHERMIA**

Prolonged exposure to cold water causes a condition known as hypothermia - a substantial loss of body heat, which leads to exhaustion and unconsciousness. Most drowning victims first suffer from hypothermia. The following chart shows the effects of hypothermia:

<b>HOW HYPOTHERMIA AFFECTS MOST ADULTS</b>			
<b>Water Temperature</b> °C		<b>Exhaustion or</b> <b>Unconsciousness</b>	<b>Expected Time</b> <b>of Survival</b>
	°(F)		
0.3	(32.5)	UNDER 15 MIN	UNDER 15 TO 45 MIN
0.3 TO 4	(32.5 to 40)	15 TO 30 MIN	30 TO 90 MIN
4 TO 10	(40 to 50)	30 TO 60 MIN	1 TO 3 HOURS
10 TO 16	(50 to 60)	1 TO 2 HOURS	1 TO 6 HOURS
16 TO 21	(60 to 70)	2 TO 7 HOURS	2 TO 40 HOURS
21 TO 27	(70 to 80)	2 TO 12 HOURS	3 HOURS TO INDEFINITE
Over 27	(Over 80)	INDEFINITE	INDEFINITE

PFDs can increase survival time because they allow you to float without using energy treading water and because of their insulating properties. Naturally, the warmer the water, the less insulation you will require. When operating in cold waters [below 60°F (15.6°C)] you should consider using a coat or jacket style PFD or a Type V Thermal Protective PFD as they cover more of the body than the vest or belt style PFDs.

## **Some Points to Remember About Hypothermia Protection:**

1. Always wear your PFD. Even if you become incapacitated due to hypothermia, the PFD will keep you afloat and greatly improve your chances of rescue.
2. Do not attempt to swim unless it is to reach a nearby craft, fellow survivor, or a floating object on which you can lean or climb. Swimming increases the rate of body heat loss. In cold water, drown-proofing methods that require putting your head in the water are not recommended. Keep your head out of the water. This will greatly lessen heat loss and increase your survival time.
3. Use the standard H.E.L.P. position when wearing an inflatable PFD. Wrap your arms around your torso, under the PFD, and draw your legs up to a seated position. Doing so will help you conserve body heat.
4. Keep a positive attitude about your survival and rescue. This will improve your chances of extending your survival time until rescued. Your will-to-live does make a difference!
5. If there is more than one person in the water, huddling is recommended while waiting to be rescued. This action tends to reduce the rate of heat loss and thus increase the survival time.

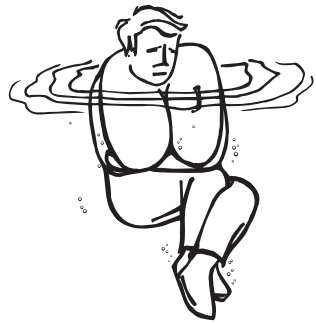

## **IX. EACH OF THESE DEVICES IS INTENDED TO HELP YOU SAVE YOUR OWN LIFE**

For your PFD to function properly follow these suggestions to verify that it fits, floats, and remains in good condition.

1. Check the status of the inflator and make sure that the status indicator is green. Check before each outing.
2. Get in the habit of rearming the inflation mechanism right after each CO2 inflation.
3. This PFD requires rearming with a new cylinder, and pill cage assembly after each CO2 inflation. Always have rearming kits to service your inflatable PFDs.
4. Try your wearable PFD on and adjust it until it fits comfortably in and out of the water.
5. Mark your PFD with your name if you are the only wearer.
6. Do not alter your PFD. If it doesn't fit properly, get one that does. An altered device is no longer Coast Guard approved.
7. Your PFD is not intended for use as a fender or kneeling pad.
8. If your PFD is wet, allow it to dry thoroughly before storing it. Store it in a well-ventilated area.
9. Do not dry your PFD in front of a radiator or other source of direct heat.

## **X. ADDITIONAL INFORMATION**

If you need more information about PFDs and safe recreational boating, contact your state boating authority, U.S. Coast Guard Auxiliary, U.S. Power Squadron, Red Cross, or your nearest unit of the U.S. Coast Guard; or call the Coast Guard Customer Information Line at 1-800-368-5647 or the Free Boating Course number 1-800-336-BOAT (in VA, 1-800-245-BOAT) or see the USCG Boating Web Page at [www.uscgboating.org](http://www.uscgboating.org).

## **DO NOT ATTACH PFD'S TO YOUR BOAT**

Each PFD has straps, hooks, buckles, or other means for securing the device in place on the wearer. Some PFDs also incorporate decorative dee rings or tabs. Such items are not to be used to attach the device to the boat. Attaching the device to the boat will not permit it to perform as intended.

## **CO2 PERMEATION LOSS**

CO2 gas will permeate the chamber fabric over time. Oral Inflation may be necessary to maintain full buoyancy.

## **BUDDY LINE INFORMATION**

Buddy lines, when provided, are to be used by people adrift in the water, to attach themselves to one another and aid in staying together. ***Buddy lines are not designed for lifting.***

**IF YOU HAVE ANY QUESTIONS ABOUT THE INITIAL ARMING,  
REARMING, REPACKING, OR NEAREST AUTHORIZED STEARNS  
REPAIR FACILITY CALL 1-800-783-2767.**

**PRODUCT REGISTRATION:  
PLEASE MAIL REGISTRATION CARD OR CALL  
1-800-783-2767  
IN ORDER TO RECEIVE IMPORTANT UPDATES  
ON THIS PFD.**