

# 5090 Tandem Bracket Installation Guide

## Parts in the box

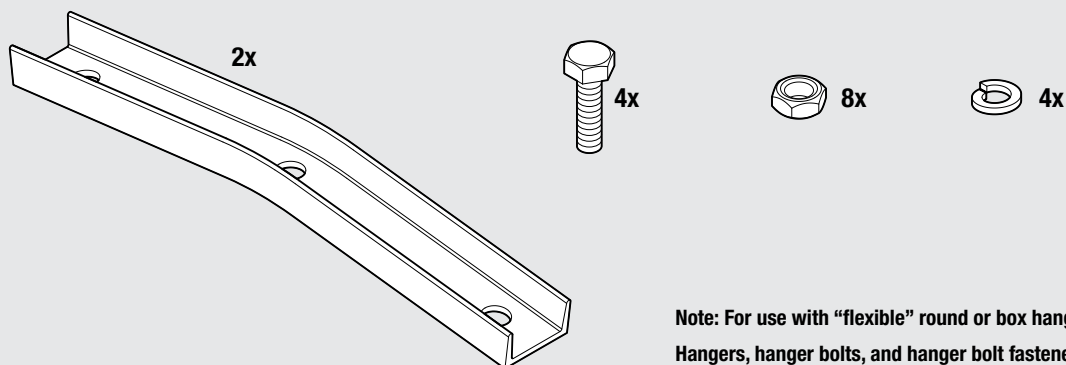

**Note:** For use with "flexible" round or box hangers only.  
Hangers, hanger bolts, and hanger bolt fasteners are not included.

**1**

Insert bolt through the hole in the hanger's trunnion.

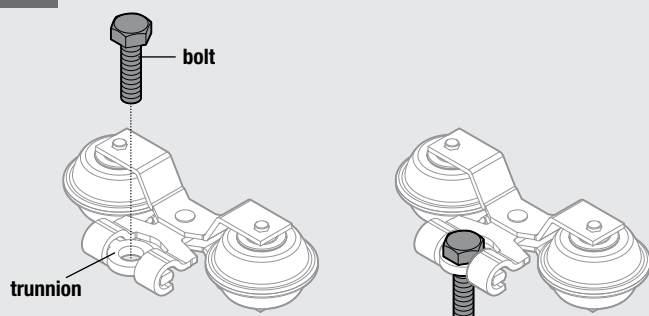
**2**

Thread nut onto bolt, leaving 1/2" to 9/16" (12,7 to 14,3mm) of thread exposed.

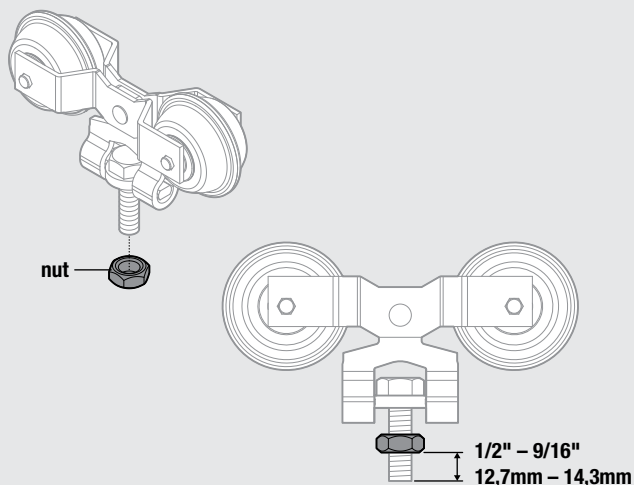

**3**

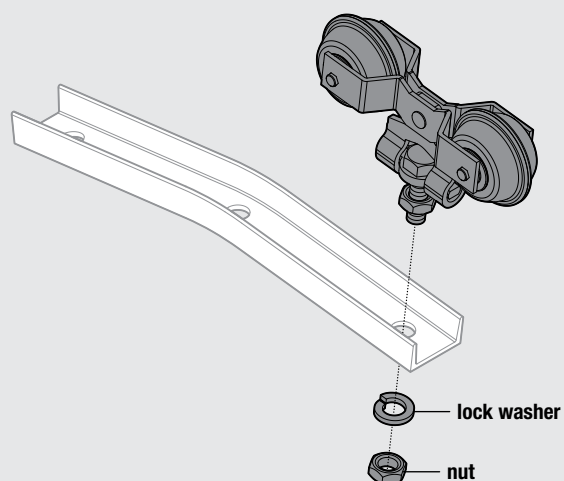
Insert bolt through the hole in the tandem bracket. Secure with lock washer and second nut. Tighten securely.

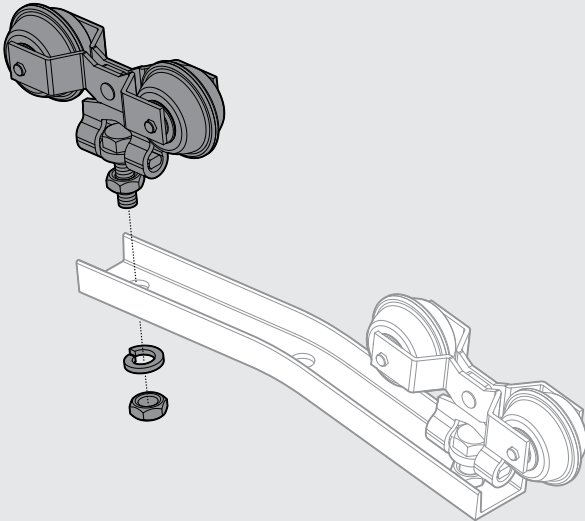

**4**

Repeat steps 1–3 for the other hanger.



**5**

Insert hanger bolt through the center hole in the tandem bracket.

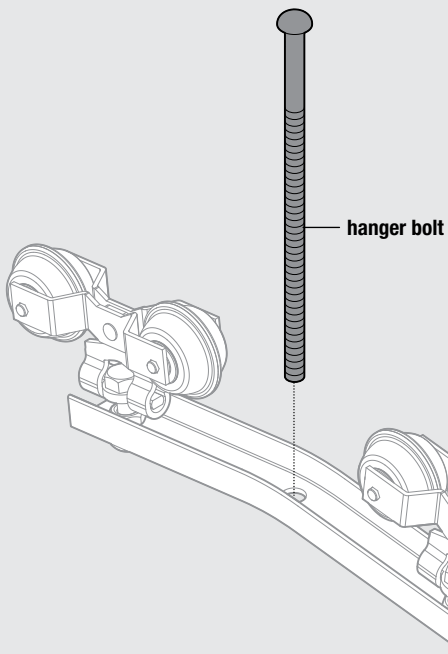

**6**

Insert hanger bolt through a hole in the top lateral of your sliding door structure. Secure with appropriate fasteners. Adjust as required and tighten securely.

