

Canon

COLORADO XL-SERIES

UVgel 3.4 m/11 ft Graphics Production Printer

ALL IN! ONE.

FAST FLEXIBLES. RELIABLE RIGIDS.



Colorado XL7R
Images Simulated

COLORADO XL-SERIES

UVGEL 3.4 M/11 FT GRAPHICS PRODUCTION PRINTER

Fast flexibles, reliable rigids

Imagine a highly automated, 3.4 m/11 ft graphics production printer that lets you produce flexible applications such as posters, banners, and soft signage at fast production speed. All with smart technology that helps you limit wrinkles without constant machine babysitting.

Now imagine that same rugged, reliable printer lets you create stunning rigid applications such as displays, packaging, and interior décor.

Smart, virtually seamless application experience

Imagine no more. Meet the Colorado XL-series, a 3.4 m/11 ft graphics production printer designed to handle both flexible and rigid media with equal speed and ease!

All in one highly-productive, modular, future-proof system. All with unique image quality and creative effects that are made possible by jetting UVgel.

Unique UVgel technology

The Colorado XL-series brings you all the unique advantages of UVgel, now with the widest and fastest UVgel applications ever. All with one gel set for both flexible and rigid media.

Our UVgel is a unique Canon technology, found only in our Colorado printers. We developed and manufacture the UVgel. We also developed and manufacture our own powerful UVgel 850 printhead technology.

That's enabled us to build a system that is designed to provide amazing printing performance for a wide range of applications. All with the UVgel advantage.

All in! One.

THE COLORADO XL-SERIES BRINGS YOU ALL THE UNIQUE ADVANTAGES OF UVGEL

COLORADO XL-SERIES OVERVIEW

Page 4-5

THE UVGEL ADVANTAGE

Page 6-7

FIVE WAYS THE COLORADO XL-SERIES CAN EMPOWER YOUR GRAPHICS BUSINESS

Page 8-15

Colorado XL7R with optional white ink

Images Simulated

ONE BLAST OF TECHNOLOGY INNOVATIONS

Page 16-23

COLORADO XL-SERIES OVERVIEW

ALL IN! ONE.

The Colorado XL-series is a productive roll-to-roll graphics printer with a smooth growth path to a full hybrid printer for both flexible and rigid applications. It's set to be available in a roll-to-roll and hybrid version with varying media handling options, including modular front-and-back rigid tables. All field upgradable.

UVGEL 850 PRINTHEAD
TECHNOLOGY

UVgel
CMYKW*

UVgel Boxes
2 LITERS PER COLOR

Express mode
211 M² OR 2,293 FT²/HOUR

Production mode
106 M² OR 1,141 FT²/HOUR

Quality mode
70 M² OR 753 FT²/HOUR

Optional
DUAL USER
INTERFACE

Maximum width
3.4 M/11 FEET

Maximum thickness
52 MM/2 INCH

Optional
FRONT-AND-BACK RIGID TABLES

COLORADO XL7 ROLL-TO-ROLL PRINTER
COLORADO XL7 HYBRID PRINTER

* UVgel white is optional.

JETTING GEL: THE UVGEL ADVANTAGE

In 2017, we launched the successful 64-inch Colorado line of roll-to-roll printers based on our first-generation UVgel technology. Today, thousands of large-format graphics print service providers around the world benefit from the advantages of our UVgel technology.



BENEFITS OF UVGEL TECHNOLOGY

Color gamut
Light fastness

Indoor usage
No drying time



Productivity
Low temperature
curing

Now for fast flexibles and reliable rigids

With the Colorado XL-series, we bring you these advantages for the production of flexible and rigid applications up to 3.4 m/11 ft wide.

Designed for fast, high-quality printing

The special consistency of UVgel offers amazing capabilities for fast, high-quality printing. The technology is designed to provide prints that have a wide color gamut; outstanding, crisp image quality; and are instantly dry without smudging or sticking.

Robust, flexible, light-fast, scratch-resistant

UVgel technology is designed to help users create prints that are robust, flexible, light-fast, and scratch-resistant, even immediately after printing, for a powerful impact across a broad range of applications.

Uniformity, repeatability, color consistency

The absence of heat in the curing process and the intrinsic UVgel ink properties in the Colorado XL-series help contribute to prints having excellent uniformity, repeatability, and color consistency. From print to print, job to job.

UVgel ADVANTAGES

- ✓ Print creative applications with a spectacular color gamut.
- ✓ Choose matte or gloss creative effects.
- ✓ Print specialty applications with intriguing textures using our PRISMAguide XL software, sold separately and optional FLXture technology.
- ✓ Enjoy UVgel White Ink, a white gel option that works like any other color.
- ✓ Benefit from low running costs thanks to efficient UVgel and low energy usage, and Smart Guided Workflow that promotes first-time right printing, all from a single low-odor system.

FOUR WAYS THE COLORADO XL-SERIES CAN EMPOWER YOUR GRAPHICS BUSINESS

ALL IN! ONE.



1 ONE FASTER, WIDER UVGEL ADVANTAGE*



True hybrid
Modular to the Max

2 ONE MODULAR DESIGN TO CHOOSE WHAT YOU USE

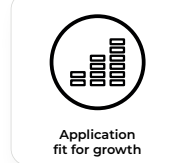

Application
fit for growth

3 ONE PRINTER FOR BIG, BOLD, BUSINESS BOOSTING GRAPHICS APPLICATIONS



Future proof
Investment

4 ONE FUTURE-PROOF INVESTMENT CONCEPT



1 ONE FASTER, WIDER UVGEL ADVANTAGE*



As the next step on our roadmap, our new UVgel printer gets wider and faster with bigger applications compared to the Colorado M-series roll-to-roll printer.

Fitted to handle two 1.6 m/64 inch rolls, the Colorado XL-series introduces UVgel technology for both rigid and roll-to-roll printing up to a comfortable 3.4 m/11 ft.

We've optimized the UVgel composition to be able to print on both flexible and rigid media with one gel set. This extends the benefits of UVgel jetting to packaging, interior décor, and retail applications.



2 ONE MODULAR DESIGN TO CHOOSE WHAT YOU USE

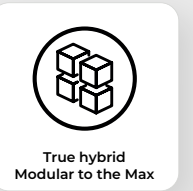

Colorado XL7 roll-to-roll



Colorado XL7 hybrid

The Colorado XL-series is a modular design concept to the max. It combines excellent roll-to-roll media handling with reliable rigid capacity. Plus production automation and quality assurance features that help improve your productivity.

Whatever applications or configuration you need, you'll likely find it in the Colorado XL-series.

Quality to Design

A Colorado XL-series is an investment in taking your business to the next level, today and in the future. It's powerful and versatile enough to become the heart of your business and can grow with you as you expand.

One machine, many configurations

You configure your Colorado XL-series to your current business needs. With the same basic printer, it can be your entry into the 3.2 m/10 ft graphics market or an extension of your current capabilities.

ALL IN! ONE. MODULAR CONCEPT TO CHOOSE WHAT YOU USE.



Images Simulated

3 ONE PRINTER FOR BIG, BOLD, GRAPHICS APPLICATIONS

Packaging

- E-commerce packaging
- Premium primary packaging
- POS display
- Prototyping and short-run

Retail

- Posters
- Signage
- Window graphics
- Backlit light boxes
- Vehicle graphics

Interior décor

- Wallpaper
- Wallcoverings
- Floor graphics
- Canvas
- Acoustic panels

With the Colorado XL-series, you got it! All in! One.

With the Colorado XL-series, you can explore and produce a growing variety of big, bold graphics applications with just one printer. Everything you need for your everyday printing today while focusing on the future:

- ✓ Vibrant brand colors with a high gloss for displays and packaging
- ✓ An amazing soft signage look and feel
- ✓ Matte or gloss creative effects
- ✓ Specialty application options with intriguing textures
- ✓ Velvety matte for interior décor
- ✓ Rigid, low-odor applications

UVgel. Ready to sell.

UVgel applications are suitable for a wide range of roll-to-roll media, including vinyl, paper, banner, film, canvas, and polyester textiles.

This also includes textured, structured, transparent, colored, metallic, reflective, and even magnetic media. And the Colorado XL-series extends the scope and advantages of UVgel jetting to rigid media such as foam board, polypropylene, acrylic, and aluminium composite boards.

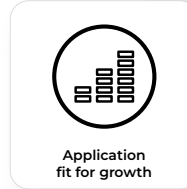

4 ONE FUTURE-PROOF INVESTMENT CONCEPT



We've designed the Colorado XL-series as a future-proof concept for you. Choose the configuration you need today and upgrade as your business grows. And future-proof service options give you control over your service response times and machine uptime. Your local Canon representative can help explain all the options.

Upgradable by design

The Colorado XL-series is designed for future-proof, in-field upgradeability. You invest only in the productivity level you need today. Then upgrade to easily increase options and productivity as your business grows.

Service concepts to keep you printing

Colorado XL-series printers are designed for high uptime and consistent print output over time. Low-maintenance by design, you can also benefit from innovative service concepts to help reduce downtime even further. These range from automated maintenance to remote service to operator-maintenance agreements.

The smart financial investment

The Colorado XL-series is designed with low Total Cost of Ownership in mind. It's a smart financial investment, which you can quantify. Ask your Canon representative for details.



ALL IN! ONE. BLAST OF INNOVATIONS FOR YOUR GRAPHICS PRINTING

The Colorado XL-series combines the proven benefits of UVgel technology with innovations that provide you with the potential to help expand your large-format graphics capabilities.

TECHNOLOGY INNOVATIONS INTRODUCED IN THE COLORADO XL-SERIES



**UVGEL
850 PRINTHEAD TECHNOLOGY
WITH UVGEL 860 GEL SET**



**UVGEL
TRIDRIVE VACUUM BELT SYSTEM**



**UVGEL
DYNAMICMOTION CONTROL**



**UVGEL
FULLBEAM CURING**

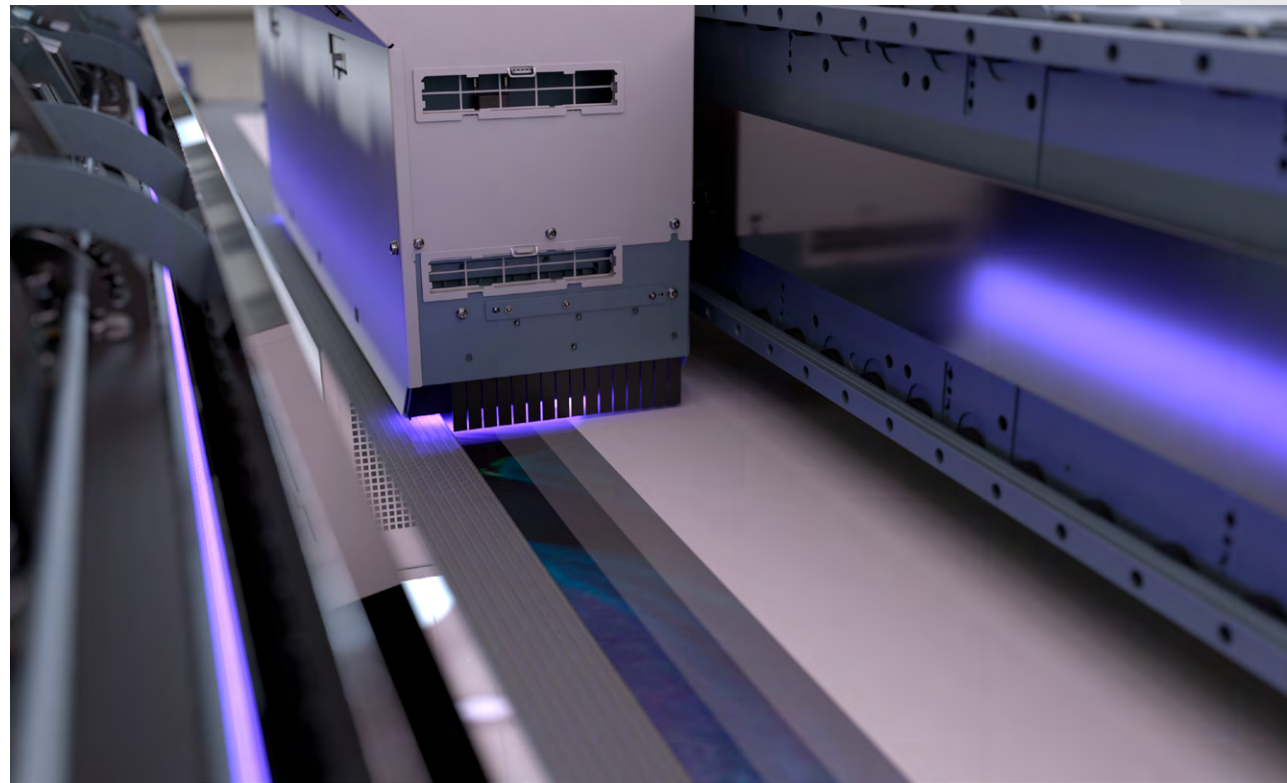

UVGEL 850 PRINTHEAD TECHNOLOGY



At the heart of the Colorado XL-series is our in-house developed and manufactured UVgel 850 printhead technology. These printheads are so advanced that we only need two of them for the regular CMYK colors and an optional third printhead for printing UVgel White ink.

Designed for productive, high-quality large-format graphics, each printhead has 4,544 nozzles, with automated nozzle monitoring and instant correction.

PAINT technology

The Colorado XL-series features PAINT, our Piezo Acoustic Integrated Nozzle Technology. It continuously monitors performance. When a nozzle malfunctions, it's temporarily switched off with neighboring nozzles kicking in to compensate. So you can just keep making excellent quality prints!

UVgel 860 gel

The Colorado XL-series introduces the UVgel 860 inks. These inks are optimized to cover a wide variety of both rigid and flexible applications while providing the well-known benefits of UVgel.

These include:

- ✓ Excellent color consistency
- ✓ Low-odor and instantly-dry prints
- ✓ Matte and gloss finishes without the need of a separate varnish
- ✓ Dimensional stability due to low-temperature curing

THE PROVEN BENEFITS OF UVGEL TECHNOLOGY

FLXture option*

Add textured finishes that mimic the look and feel of materials such as leather, wood or fabric, or specialty media, for applications such as wall coverings, retail graphics, high-end interior décor, and packaging.

UVgel White option

Print white gel like any other color and overcome common clogging and maintenance problems which may occur with some other white ink technologies.

Low gel usage, low-odor, instantly dry, usable prints

Benefit from the classic advantages that UVgel brings to large-format graphics printing: low gel usage, low-odor, instantly dry, usable prints. All from one gel set.

The proven benefits of UVgel technology

- ✓ Matte or gloss finishes
- ✓ FLXture option
- ✓ UVgel White option
- ✓ Durable, color consistent, low-odor, instant dry prints.

ALL IN! ONE. UVGEL PLATFORM

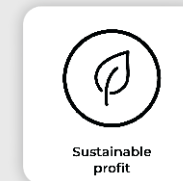
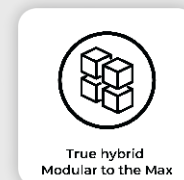

Colorado XL-series Printer

* Requires optional UVgel white ink.

UVGEL TRIDRIVE VACUUM BELT SYSTEM



The Colorado XL-series introduces our UVgel TRIdrive (Three Roller Interactive) vacuum belt system. It's designed to help limit errors at job start-up, for easy loading, highly precise media positioning, and reliable unattended printing that helps users create razor-sharp applications that truly impress.

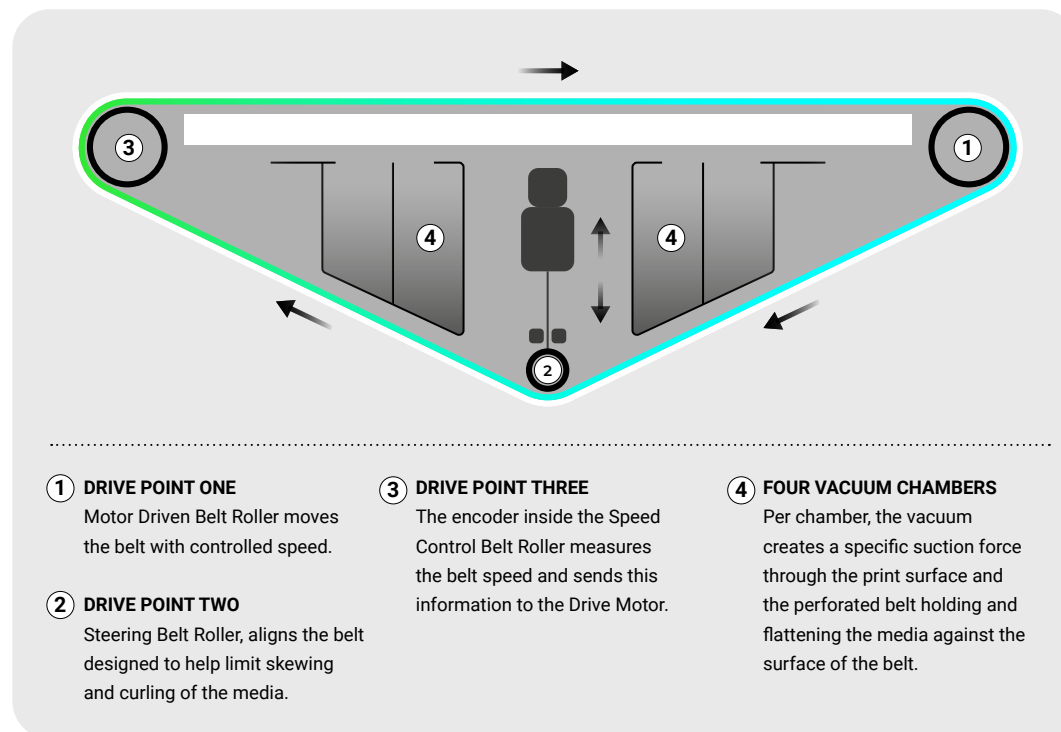

- ① **DRIVE POINT ONE**
Motor Driven Belt Roller moves the belt with controlled speed.
- ② **DRIVE POINT TWO**
Steering Belt Roller, aligns the belt designed to help limit skewing and curling of the media.
- ③ **DRIVE POINT THREE**
The encoder inside the Speed Control Belt Roller measures the belt speed and sends this information to the Drive Motor.
- ④ **FOUR VACUUM CHAMBERS**
Per chamber, the vacuum creates a specific suction force through the print surface and the perforated belt holding and flattening the media against the surface of the belt.

Accurate placement and transportation
The UVgel TRIdrive vacuum belt system features three interactive rollers and multiple powerful vacuum zones that automatically detect and correct the media positioning which help to reduce wrinkling and skewing.

Its advanced, self-steering belt system provides amazing stability and control when handling a variety of media types, from stretchable flexible materials to challenging rigid substrates.

The UVgel TRIdrive is designed to deliver a number of additional benefits for flexible media.

- These include:**
- Automatic loading and straightening for reliable operation, ideal for less experienced operators.
 - EdgeForward printing that promotes media savings.
 - Allows for unattended printing through automatic tension adjustment on the feeding and take-up spindles.

UVGEL DYNAMICMOTION CONTROL



The Colorado XL-series has an agile and precise printhead carriage that features UVgel DynamicMotion Control. This helps to provide outstanding print quality even with challenging media.

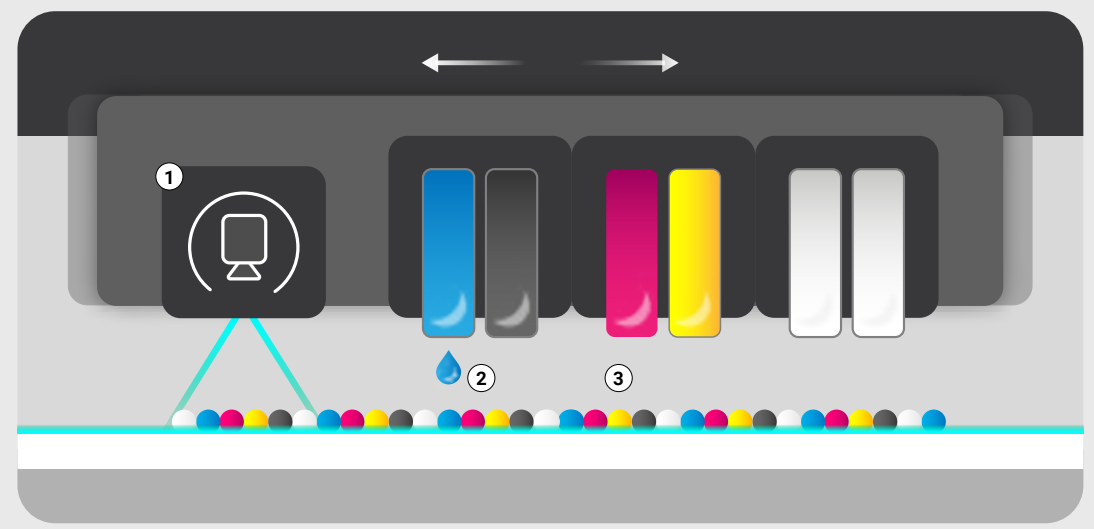

- ① **HIGH-SPEED MACHINE VISION TECHNOLOGY**
Analyzes the UVgel dot position on the media.
- ② **UVGEL DOT IDENTIFICATION**
In case a deviation is identified.
- ③ **UVGEL DOT CORRECTION**
The deviation in dot placement is corrected.

Thanks to the powerful UVgel 850 printhead technology
UVgel DynamicMotion Control is made possible thanks to our own powerful UVgel 850 printhead technology used in the Colorado XL-series. We only need two printheads, or three when printing UVgel White Ink. This enables us to create a lightweight and agile printhead carriage with ultra-precise positioning of the printheads while printing.

Amazing results even at high speeds
UVgel DynamicMotion Control uses high-speed, high-resolution machine vision technology that actively tracks any micro movement of the media while the carriage is travelling. It recalibrates the printhead positioning on-the-fly for precise alignment precision and alignment of print passes, helping to provide amazing results even at high speeds.

So each drop is placed with high precision right where it should be, despite micro movements of the media underneath. You don't need to add additional printheads to the printhead carriage.

UVGEL FULLBEAM CURING



We've reimagined UVgel curing with our innovative UVgel FullBeam Curing technology. It can open up a world of high-end applications with a wider color gamut and incredible color results. UVgel FullBeam Curing uses a unique printer-wide LED curing array that, combined with an ingenious mirror system, is designed to deliver consistent UV light dosing across the entire print width. It's designed to deliver outstanding print uniformity over large surfaces, enabling a wide color gamut.



XL7R



XL7H

Configuration	XL7R	XL7H
PRINTING		
Printing method	UVgel piezoelectric inkjet	
Printing modes: gloss in ft²/hour	●	
Gloss Express	2,271	
Gloss Speed	1,518	
Gloss Production	1,141	
Gloss Quality	753	
Gloss Specialty	570	
Printing modes: matte in ft²/hour	○	
Matte Speed	1,518	
Matte Production	1,141	
Matte Quality	753	
Matte Specialty	570	
Backlit	377	
Backlit Density	248	
Printing modes: spot white 1 layer in ft²/hour	○	
Spot White Speed	1,518	
Spot White Production	1,141	
Spot White Quality	753	
Spot White Specialty	570	
Printing modes: White underflood/overflood 2 layer in ft²/hour	○	
White Underflood Speed	764	
White Underflood Production	570	
White Underflood Quality	377	
White Underflood Specialty	291	

● Standard ○ Optional - Not available

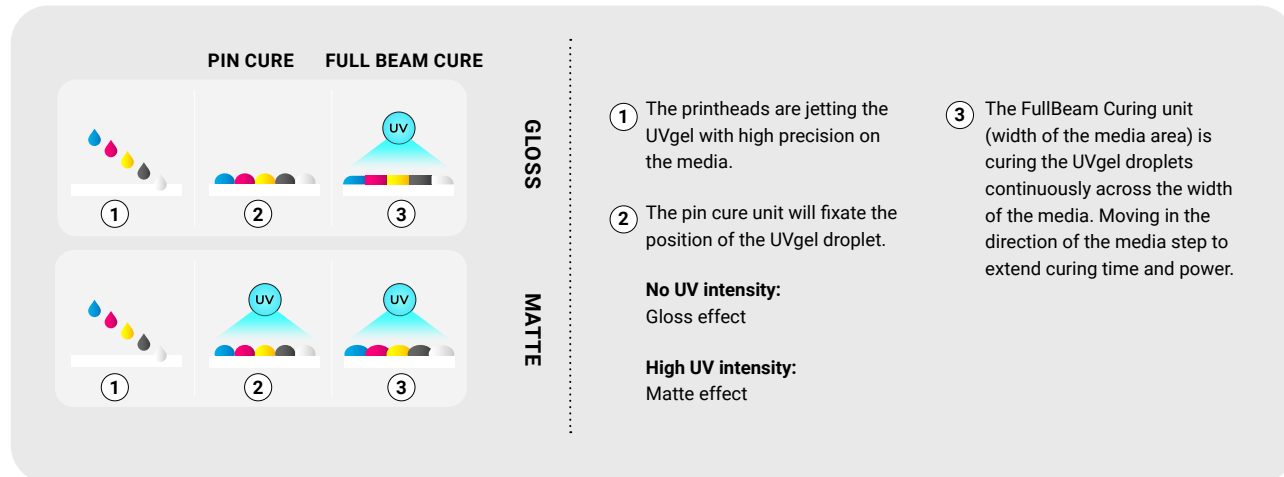

Special UVgel effects

Thanks to UVgel FullBeam Curing, you can create matte or glossy finishes. All without changing gels or media. Or use the UVgel FLXture technology option to add textures with subtle, tactile surface details. This gives your print a luxurious, intriguing and high-value feel. You can cure up to five high-density layers, all in one pass, over the full width of the media.

And it's easy

Sound complicated? It's surprisingly simple, thanks to the easy-to-use recipes in our optional PRISMAguide XL software. Simply prepare the job and you're ready to go.



Configuration	XL7R	XL7H
White Overflow Speed		764
White Overflow Production		570
White Overflow Quality		377
White Overflow Specialty		291
Printing modes: white 3 layer in ft²/hour		○
White 3 Layers High Quality		248
White 3 Layers Specialty		194
Printing modes: white 5 layer in ft²/hour		○
White 5 Layers Quality		151
White 5 Layers Specialty		118
UVGEL TECHNOLOGY		●
Ink system		
UVgel Type	Canon UVgel 860	
UVgel Color CMYK		●
UVgel White		○
UVgel packaging		
UVgel 860 Box 2 Liter		●
UVgel Reservoir Per Color	7-liter	
Refill While Printing		●
UVgel technology - instant pinning and dot gain control		●
Same UVgel suitable for roll- to-roll and rigid applications		●
Low temperature curing - suitable for thin and heat-sensitive media		●
Outstanding scratch resistance		●
Easy lamination, smooth ink film		●
High precision color-matching and consistency		●
Instant dry printout		●
FLXture, requires optional UVgel white ink kit Textured printing with layered UVgel ink		○

● Standard ○ Optional - Not available

Configuration	XL7R	XL7H
PRINTHEAD TECHNOLOGY		
Canon UVgel 850 Printheads CMYK		2
Canon UVgel 850 Printheads CMYKW		3
Nozzles per printhead		4,544
High Frequency Drop-on-demand Piezo-electric Printhead		●
Dynamic Motion Control Compensates for media alignment variances		●
PAINT Piezo Acoustic Integrated Nozzle Technology		●
Automatic Maintenance		●
UV CURING TECHNOLOGY		UV LED
Full Beam Curing Uniform and fast UV LED Curing in one go with full width curing technology including a smart mirror system for optimized multilayer curing		●
MEDIA TRANSPORT		
TRIdrive Vacuum Belt System	Unattended roll-to-roll operation	Controlled rigid transport and unattended roll-to-roll operation
Rigid Tables The optional input and output rigid tables are optimized for ergonomic rigid feeding	-	●
Input and output rigid tables, can be extended to the following sizes:	-	30 in. and 60 in.
MEDIA		
Media Input Machine vision technology to capture media location and size		●
Roll Media		
Roll Width		Up to 132 in.
Roll Weight		Up to 367 lbs (180 kg)
Roll Diameter		Up to 11.8 in.
Media Thickness		Up to 0.08 in.
Manual and semi-automatic media loading. Automatic alignment, automatic take up assistant		●
Media take-up system		●
Number of input rolls		1

● Standard ○ Optional - Not available

Configuration	XL7R	XL7H
Rigid Media	-	•
Minimum Media Width	-	11.7 in.
Maximum Media Width	-	131.9 in.
Maximum Media Weight	-	198 lbs (90 kg)
Media Thickness	-	2 in.

CERTIFICATIONS

Application Certifications

Indoor AgBB, M1, A+	•
EN15102, Type II ASTM F793	•
Émissions dans l'air intérieur	•

INTERFACE

Network connection	Ethernet (100/1,000 Mbit/s)
--------------------	-----------------------------

DIMENSIONS AND WEIGHT

Printer W x D x H	240 in. x 57 in. x 68 in.
Minimal Operational footprint XL7R W x D	319 in. x 197 in.
Minimal Operational footprint XL7H W x D	319 in. x 295 in.
Weight Printer (approximately)	4,400 lbs

WORKING ENVIRONMENT

Temperature	64 - 86 °F
Humidity	20% - 80%
Air Pressure	87 - 116 psi (6 – 8 Bar), minimal 3.5 ft ³ /hr (0.1 m ³ /hr)

Power

Standby	1.6 kW
Printing	10.8 kW
Consumption	3 phase 208V line to line voltage, 60 amps. 5 wire - 3 hot lines, 1 Neutral and 1 Ground
Source	Printer is declared under Radio Equipment Directive (RED) - 2014/53/EU

REGULATORY CERTIFICATION

Declaration of Conformity	Compliant with EN62479, EN301 489-1, EN301 489-3, EN300-331 FCC Part 15 and RSS-210 certified (module)
Radio	IEC/EN/UL/CSA 62368-1 compliant Applicable marks: CE, TÜV-GS, C-UL-US, RCM
Safety	Emission: Class A compliant according CISPR 32, FCC part 15, and ICES-003 Immunity: CISPR 24 compliant Applicable marks: CE, FCC, IC, VCCI, RCM, CETECOM

• Standard ○ Optional - Not available

Configuration	XL7R	XL7H
EMC		
Environmental	WEEE, RoHS directive 2011/65/EU, REACH, CE	
Embedded software / firmware		
Colorado XL User Interface	•	
Colorado XL User Interface Remote	•	
SOFTWARE		
PRISMAservice	•	
Factory Supported RIPs	ONYX Graphics	
WARRANTY Program¹		
Manufacturer's Warranty	•	
Printer Parts: 2 years	•	
UVgel 850 Printhead: 2 years or 538,195 ft ² —whichever comes first ²	•	

• Standard ○ Optional - Not available

Availability

The Colorado XL is currently set to be available in select countries beginning Q1 2026 through Canon's direct sales organizations and accredited partners. Global availability is currently expected in Q3 2026.

¹ Term and Conditions apply.

² Repair or replacement of an item does not extend the warranty period of the item repaired or replaced.



usa.canon.com/largeformat

Neither this publication nor parts thereof may be copied, modified, reproduced or transmitted in any form or by any means (electronic, manual, or otherwise) without the prior written permission of Canon Production Printing and Canon U.S.A., Inc.

Canon and Canon's product and service names are trademarks or registered trademarks of Canon Inc. or Canon Production Printing Netherlands B.V. All other product and company names are trademarks or registered trademarks of the respective owners and respectfully acknowledged. The content of this publication is provided for informational purposes only and does not constitute professional advice. Illustrations and printer output images are/may be simulated and do not necessarily apply to all products and services offered in the respective local market. Errors, omissions and inaccuracies excepted. No guarantees, representations or warranties are made regarding the functionality, performance, or suitability of any products, services, or technologies mentioned herein. Canon Production Printing shall not be liable for any direct, indirect or consequential damages of any nature, losses or expenses resulting from the use of or reliance on this publication. We reserve the right to modify, update, or remove any content at any time without prior notice.

©2026 Canon U.S.A., Inc. All rights reserved.

04.17.26/26-0758-14268