

# Canon



**2026**  
VOLUME 1

## BROADCAST SOLUTIONS

BROADCAST LENSES  
CINEMA LENSES  
PTZ CAMERAS



**INNOVATION**  
In TV Optics Since 1958

Toward 100 years anniversary

# TABLE OF CONTENTS

---

## **BROADCAST LENSES**

Canon Broadcast Lens Technology	4
Understanding Canon Lens Naming Conventions	8
Broadcast Lens Focal Length Table	9
Broadcast Studio and Field Lenses	10
Broadcast ENG/EFP Lenses	14
Pro-Video Lenses	16

## **CINEMA LENSES**

Cinema Lens Technology	21
Cinema Lens Focal Distance Table	22
ZOOM Lens Series	29
COMPACT ZOOM Lens Series	29
FLEX ZOOM Lens Series	30
RF PRIME Lens Series	30
SUMIRE PRIME Lens Series	31
EF PRIME Lens Series	31
CINE-SERVO Lens Series	32
COMPACT-SERVO Lens Series	32

## **4K PTZ CAMERAS**

Features and Benefits	35
Canon 4K PTZ Camera Lineup	36
Remote Camera Controllers	39





## CANON BROADCAST ZOOM LENSES

# Celebrating Canon's Storied History

### Development of Broadcast Zoom Lenses

In 1958, Canon launched its broadcast lens business by introducing the innovative high zoom ratio 6.7 IF-1 lens. Ever since, Canon has continued to listen to the demands of broadcasters and cinematographers around the world by developing lenses based on industry trends.



### Canon's Emmy®-Winning Lens Technology

Canon's highly regarded lens technology is a recipient of the Technology and Engineering Emmy® Award. The National Academy of Television Arts and Sciences awarded Canon a Technology & Engineering EMMY® Award in 2005 in recognition of our engineering creativity in Lens Technology Developments for Solid State Imager Cameras in High Definition Formats. We also received an EMMY® in 1996 for *"Implementation In Lens Technology to Achieve Compatibility with CCD Sensors."* In addition, we received an EMMY® in 2017 for "Large Format 4K Zoom Lenses".

# Canon Broadcast Lens Technology

## Optical Performance

### Superb Optical Materials Produce a High-Performance Lens

#### Fluorite · UD Glass · Hi-UD Glass

Unlike conventional optical glass, Fluorite has remarkably low dispersion properties. Realizing the effectiveness of Fluorite glass, Canon has put it to practical use in many lenses, primarily in the anterior section of zoom lenses to help correct telephoto chromatic aberration. Both UD<sup>1</sup> glass and Hi-UD glass<sup>2</sup> have dispersion properties similar to Fluorite and are effective for correcting chromatic aberration. Due to its high refractive characteristics, Hi-UD glass is especially known for its spherical aberration correction. Used in the anterior and zooming sections of a lens, Hi-UD glass is effective for controlling aberration fluctuation seen when focusing and zooming.



<sup>1</sup> UD-Ultra Low Dispersion.

<sup>2</sup> Hi-UD High Index Ultra Low Dispersion.

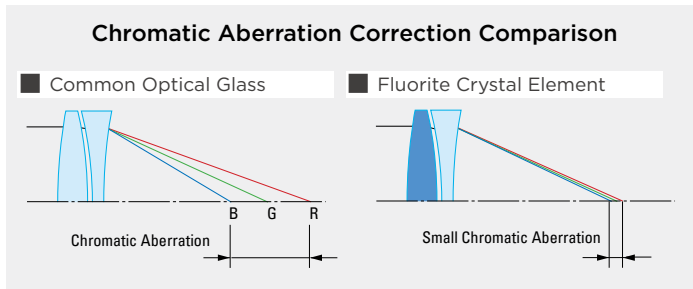

### Air Sphere Coating

In the context of HDR Optical imaging, Air Sphere Coating (ASC) technology is a critically important new innovation in broadcast field lenses. This is a Canon-developed technology that is an additional layer deposited on top of the normal multilayer coatings that are used to minimize numerous internal reflections that conspire to lower light transmission efficiency and to contaminate deep black reproduction. ASC is an ultra-low refractive index silicon dioxide film that includes microscopic air spheres having a sub-nanometer diameter arranged in regular structure. Because

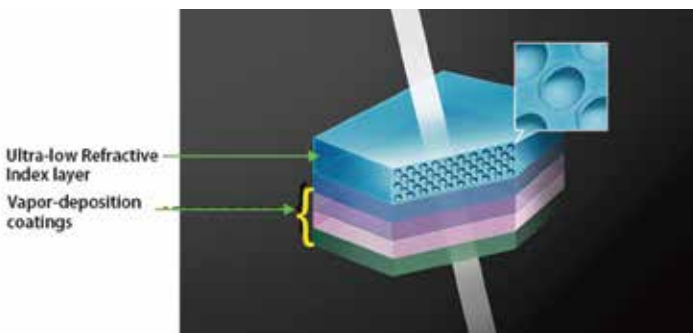

these spheres are microscopic when comparing to the wavelength of visible light and as they are in an ordered array, light does not scatter. In combination with the multilayer coatings, ASC achieves far lower reflectance and significantly reduces flare and ghosting.

### Bokeh Effect

When shooting in macro, the focus position of the lens can be changed as the focal length is adjusted, when using the optional MCJ-S02 Macro Controller, creating a bokeh effect. This built-in feature can be utilized to support special techniques in which the focus position can be shifted within the same shot just by using the Macro Controller, allowing for subtle creative defocus effects. This can help provide a degree of creativity when shooting live events such as a concert.



### High Quality, Compact Size and Weight

#### Large Aperture Aspheric Lens

Spherical aberration will increase as the diameter of a spherical lens increases. However, aspheric lenses form an ideal shape for aberration correction and are the desired lens type for improving optical performance. As they are more compact, aspheric lenses reduce the weight of the entire lens system. Through its optical design and large aperture processing techniques, Canon has developed compact, large aperture, high magnification field zoom aspheric lenses. As a result of this development, all high-magnification field zoom lenses released since 2000 have a constant total lens length regardless of zoom ratio.

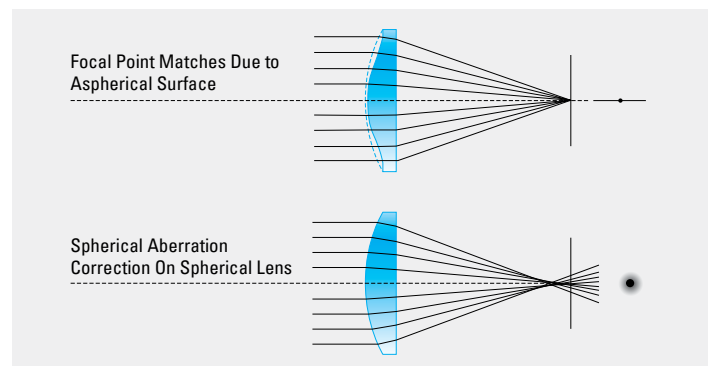

### Focus Breathing Suppression

#### Constant Angle Focusing System (CAFS)

CAFS is a technology that suppresses view-angle fluctuation (breathing) while focusing. The Zooming Effect of Focus is the phenomenon where the picture size (angle of view) changes when focusing. Canon's 32-bit CPU calculates and controls the zoom when focusing in order to counteract this phenomenon. As a result of CAFS, the UHD-DIGISUPER and DIGISUPER Series has zero Zooming Effect of Focus.

## Advanced Design Technology to Help Minimize Various Aberrations

### Image Stabilizer (IS)

Canon launched its first field zoom lens with a shift type anti-vibration mechanism in 2000\*. Prior to that, Canon introduced the IS-20B anti-vibration adapter for portable zoom lenses. Those cutting-edge technologies, along with the Vari-angle Prism image stabilizer (VAP-IS) lens, helped to usher in the era of optical image stabilization in broadcasting lenses.

*\*Adopted for DIGISUPER 86 XS (XJ86 × 9.3 B). The world's first field zoom lens for broadcasting.*

## Auto Focus

### TTL Secondary Imaging Phase Difference Detection Method

The Secondary Imaging Phase Difference Detection Method, also used in single lens reflex EOS camera lenses, was adopted for broadcast autofocus systems. As a result of this Method, Canon's Auto Focus System has excellent focusing accuracy within the entire zoom range, along with outstanding focusing speed. Due to high performance servo motors, tracking a moving object at high speed can be possible even from a largely out of focus state.

### Autofocus Two Types of Operation

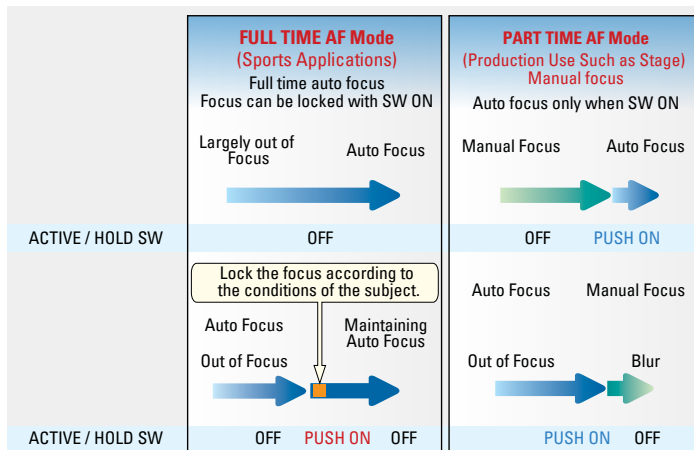

### AF Mode

Select DIGISUPER lenses provide two autofocus modes. "FULL TIME AF" provides continuous autofocus operation allowing the camera operator to focus on framing the subject. "PART TIME AF" allows for temporary autofocus use with manual focus. The modes can be switched on and off as needed, using the ACTIVE/HOLD switch.

### AF In-Focus Display

By using the FDJ - S41 dedicated focus demand, you can change the size (3 options) and position of the AF in - focus frame displayed on the viewfinder\*.

*\*To change the in-focus frame, it is necessary to interlock with the camera.*



## Digital Technology

### Digital Servo System/Digital Drive Unit

Since the release of the DIGISUPER 70 in 1995, Canon has been a leader in digital broadcast zoom lens control. Canon's ENG/EFP lenses, having the same digital technology, offer a wealth of features to make shooting more efficient. Canon's digital drive unit is installed in all ENG/EFP and Provideo broadcast lenses.

### Shuttle Shot

At the touch of a button, this feature allows the operator to zoom back and forth instantly between any two positions at the maximum speed or at any speed memorized in the Speed Presets.

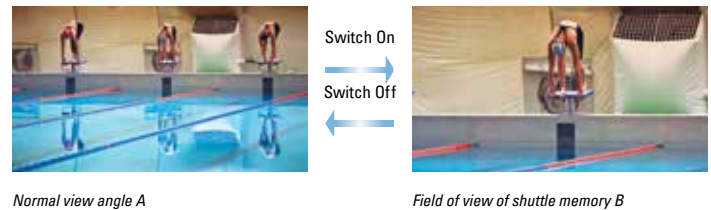

### Frame Preset

With the Frame Preset feature, a preset frame position can be saved and repeated multiple times.

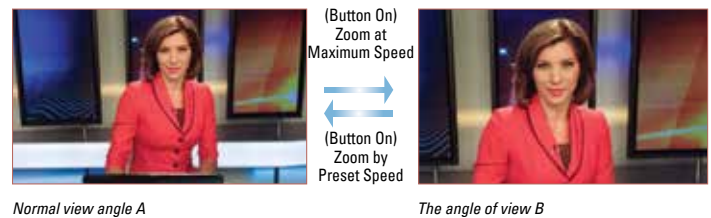

### Speed Preset

Simply press a button to recall the preset zoom speed.

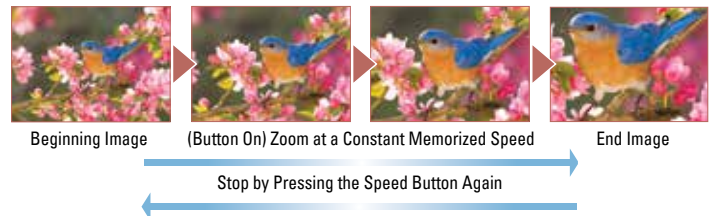

### Zoom Servo Characteristics

Zoom Servo characteristics can be selected from three curvature options on the ZDJ-G01/S01 zoom demand.

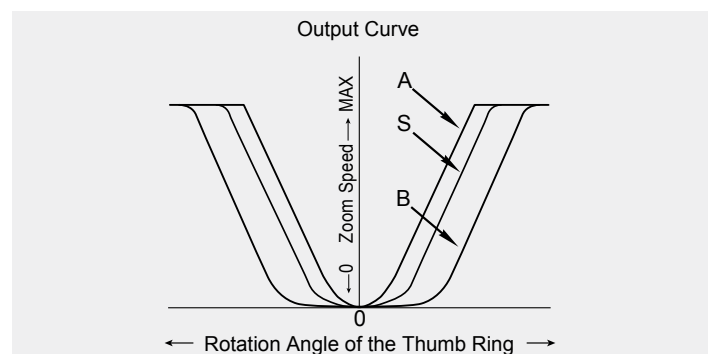

Zoom Servo Characteristics Example

## Virtual Studio System

Canon has a series of HDxs and HDGC (IRSE/IASE version) lenses which are equipped with a digital drive unit. The 16-bit resolution rotary encoder built into the drive unit can be integrated into a virtual studio system. The encoders enable precise control as the zoom servo has a range of 0.5 second quick zooms to over a 5 minute super slow zoom. Repeatability in focus and iris control are also precise. Canon's technology has made the encoder device very small, allowing it to be installed in the existing drive unit without adding size or weight.

## Further Improving Operational Efficiency

**Canon's next-generation drive unit, the e-Xs V Type T, introduced together with the CJ27ex7.3 B<sup>1</sup>, has the following new features:**

- USB-C port: allows drive unit settings, maintenance records and lens information to be saved to an external drive
- Angled 20-pin connector making for easier connectivity, less interference; allows the camera/lens to be placed on a flat surface
- The lens LCD display is now conveniently located on the top of the drive unit
- Updated and re-organized LCD display menu
- Faster Iris speed
- Focus breathing compensation can be turned on/off

### Type T and Type S Drive Units share these common features:

- Matches the aberration correction function on the camera without initialization at power-on
- Reduced power consumption by about 10%<sup>2</sup> when using a battery as compared with previous versions
- Real and virtual images can easily be calibrated with high-precision position detection
- Three 20 PIN connectors allow for simultaneous full servo and virtual system operation
- Easy operation with straightforward menu and display

## Zoom Track

The zoom control range can be set within a more limited range on both the telephoto and wide-angle sides of UHD-DIGISUPER and DIGISUPER Series lenses. With these lenses and the optional ZDJ-G01/S01 zoom demand, the zoom range can be set to virtually any range smaller than the full focal range of the lens. If not used to limit the zoom range, the feature can be used to memorize an additional preset zoom position.

## Ergonomic Design

### Compact and Lightweight Drive Unit

The grip design is ergonomic, providing an outstanding feel during operation. Additional space in the focus ring area makes manual focusing easier. The grip is positioned close to the optical axis of the lens to reduce fatigue.



Ergonomic design allows the camera operator's left hand to easily access the focus ring for manual operation.

<sup>\*1</sup>: Refer to p. 18 for more information on the drive unit and the CJ27ex7.3B.

<sup>\*2</sup>: When zoom, focus & iris in operation.

# THE ERA OF ENHANCED HDTV AND UHDTV

## BCTV LENSES DESIGNED TO SUPPORT 4K UHD CONTENT CREATION

HDTV is now firmly established worldwide and HD production is expected to continue. Ultra HDTV – generally referred to as UHD – has more recently emerged as the next generation of enhanced television service. In 2015 the International Telecommunications union published their ITU-R BT.2020 standard “Parameter Values for UHDTV Systems for Production and international Program Exchange” – that included both 4K UHD and 8K UHD production formats. This standard includes a Wide Color Gamut (WCG). In 2016 they published the ITU-R BT.2100 standard “Image Parameter Values for High Dynamic Range Television for use in Production and International Program Exchange”. This standard specifically applies the High Dynamic Range (HDR) to the HD, 4K UHD, and 8K UHD production formats (all exclusively progressive scan). In September 2017 the industry body – Ultra HD Forum – published their updated Guidelines on technologies and practices that support a commercially deployable Ultra HD real-time linear service with live and pre-recorded content in 2016, which is termed a “UHD Phase A” service. They include 4K UHD and 1080P HD (that includes both HDR and WCG).

These standards and guidelines have spurred increasing attention to the adoption of 4K UHD origination of sports, concerts, and major events. The anticipated protracted coexistence of HDTV and UHDTV has spawned a new generation of 2/3-inch multi format broadcast camera systems – from most of the major international camera manufacturers – that can selectively originate HD or UHD. To support this new era of mixed HD / UHD origination Canon has invested heavily into the development of an array of 2/3-inch 4K UHD broadcast lenses that encompass long zoom field lenses, a studio lens, and a broadening family of portable lenses.

*Simplistic mapping of the performance levels within the separate categories of box*

STUDIO / FIELD BOX LENSES			EFP / ENG PORTABLE LENSES		
LENS SERIES	PERFORMANCE		LENS SERIES	PERFORMANCE	
UHD <sub>XS</sub>	4K Premium	↑ 1080P/HDR/WCG	UHD <sub>XS</sub>	4K	↑ 1080P/HDR/WCG
UHD <sub>XS</sub>	4K		UHD <sub>GC</sub>	4K	
HD <sub>XS</sub>	HD		HD <sub>XS</sub>	HD	
		HD <sub>GC</sub>	HD		

*lenses and portable lenses.*

## IMPLICATIONS OF HDR AND WCG

Delivering the requisite high image sharpness required for 4K UHD – while simultaneously lowering traditional optical aberrations (that can be more exposed by the high resolution image sensors) – called for multiple innovations in lens design

and manufacturing. Lateral chromatic aberration causes color misregistration on high contrast edges within the imagery – especially toward picture extremities. Longitudinal chromatic aberration causes color fringing on any speculars with this imagery. HDR and WCG further enhance the visibility of these aberrations – because of the elevation in the color volume of the camera video – placing a greater onus on suppressing them to where they become subjectively invisible.

**HDR**

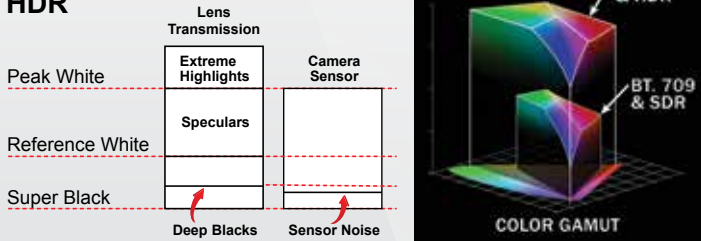

To support HDR the lens must accurately reproduce scene speculars and minimize optical artifacts stimulated by strong scene highlights.

**UHD LENS PERFORMANCE HIERARCHY**

In the case of the large box field and studio lenses and the portable EFP/ENG lenses Canon has created two performance levels in each. A special priority is assigned to elevating image sharpness (the essence of 4K UHD). An attendant high priority underlies design strategies that aggressively curtail the visibility of the two chromatic aberrations. Higher luminance levels and allied greater color volume associated with HDR / WCG combine to elevate the visibility of even small levels of these chromatic aberrations.

In the case of the Box lenses advanced design strategies allied with advanced optical glass materials are mobilized to maintain high image sharpness across the image plane, over the total focal ranges, and over a wide range of object distances. The 4K PREMIUM box lenses take these strategies to a particularly high level to further tighten those optical performance specifications.

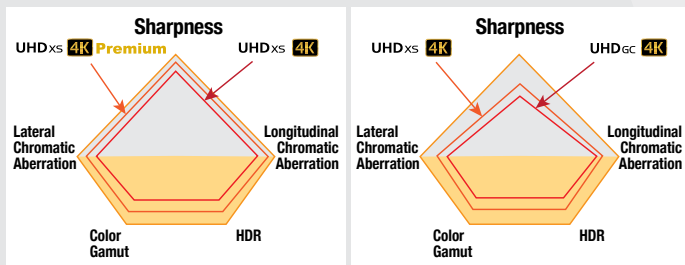

In the case of the portable lenses, similar priorities apply. The UHDxs manifests higher sharpness and lower chromatic aberrations when compared to the UHDgc – although on a different scale to the box lenses.

**MULTI-GROUP ZOOMING SYSTEM**

In seeking longer focal ranges for the box field and studio lenses and some of the longer focal length portable lenses, challenges in achieving the requisite zooming speeds while also achieving UHD performance were escalated. This called for a radical new design approach to the zooming optical subsystems. The

central goals were to achieve greater control over multiple lens aberrations to help ensure full 4K performance while at the same time expediting an increase in the speed of the zooming action (when the digital drive unit is set to maximum zoom speed).

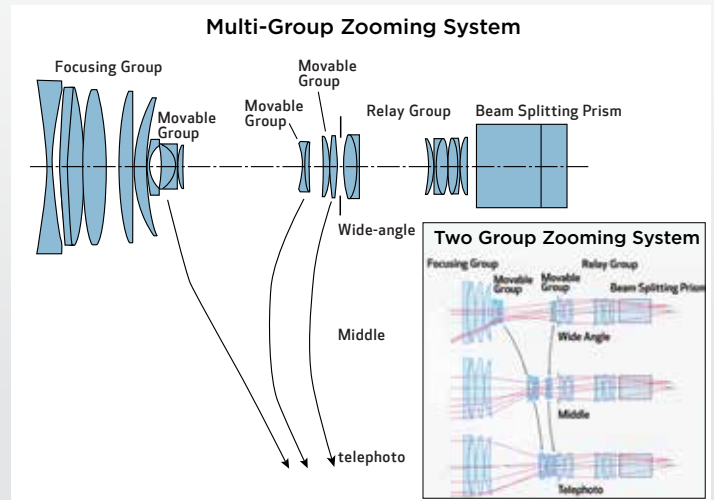

The traditional two group zooming system (right picture) is being replaced with a three group zooming system (left picture). Three movable groups move differentially with respect to each other over the zoom range. Design optimization consisted in balancing the weight of the three individual groups with their stroke distance during zooming action.

**FLOATING FOCUSING SYSTEM**

The focus optical subsystem entails high responsibility for numerous optical performance parameters and operational considerations. The lens maximum relative aperture is largely determined by the diameter of this lens input optical grouping. In addition, focus breathing (undesirable alteration to the field angle as the focus control is actuated) characteristics and aberration behavior are associated with this optical subsystem. Overall lens size and weight are heavily proportional to decisions made in the overall design of this system. Central to the design is curtailing the size and weight of the moving lens system. To help ensure UHD optical performance focus fluctuations must be suppressed – and this was accomplished by using two separate moving groups.

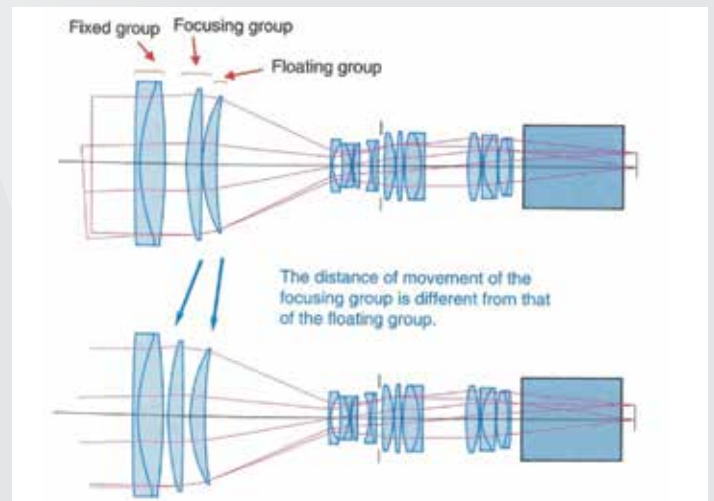

New innovations in a floating focus group support 4K UHD performance while curtailing size and weight

# CANON BROADCAST LENSES

## Understanding Canon Lens Naming Conventions

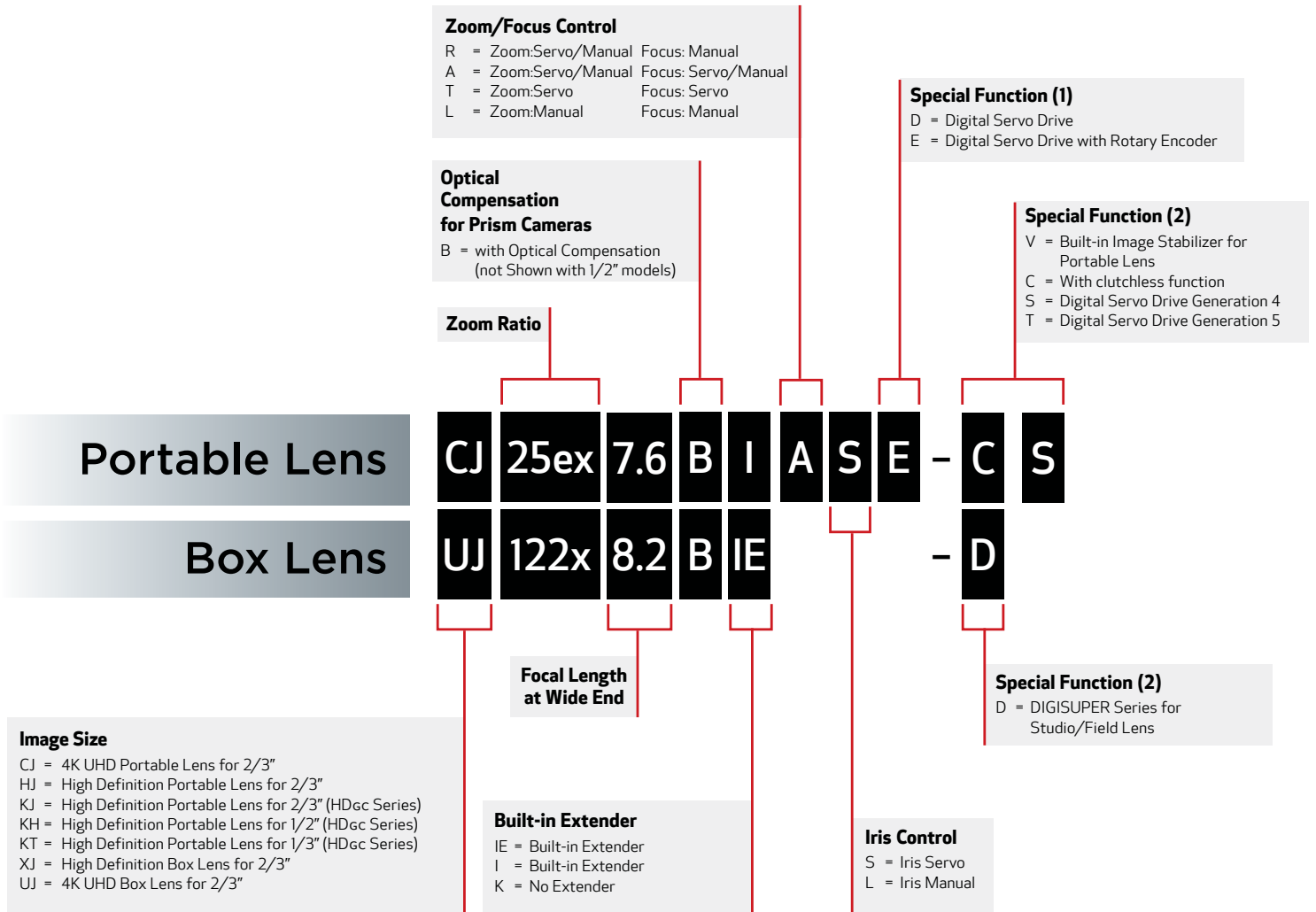

**Focal Length Table**

<b>Broadcast, Studio and Field Lenses (4K 2/3", HD 2/3")</b>																										
Angle of view horizontal (16:9)	72.9°	66.7°	60.7°	60.1°	58.3°	57.2°	56.1°	54.6°	42.3°	39.1°	3.4°	3.1°	1.02°	0.92°	0.81°	0.80°	0.77°	0.69°	0.68°	0.67°	0.65°	0.59°	0.59°	0.55°	0.47°	
Focal Length (mm)	6.5	7.3	8.2	8.3	8.6	8.8	9.0	9.3	12.4	13.5	161	180	540	600	675	690	710	800	810	820	840	925	930	1000	1178	
UHD-DIGISUPER 122AF																										
UHD-DIGISUPER 122																										
UHD-DIGISUPER 111																										
UHD-DIGISUPER 90																										
UHD-DIGISUPER 66																										
UHD-DIGISUPER 27																										
DIGISUPER 95 TELE																										
DIGISUPER 95																										
DIGISUPER 80																										

<b>Broadcast ENG/EFP Lenses (4K 2/3", HD 2/3")</b>																																													
Angle of view horizontal (16:9)	96.3°	93.7°	87.7°	77.3°	75.5°	66.7°	65.2°	64.6°	63.9°	60.7°	58.9°	52.7°	51.3°	38.9°	37.8°	35.5°	19.6°	12.2°	10.5°	9.1°	9.1°	7.0°	5.5°	5.2°	4.3°	4.2°	4.0°	3.5°	3.5°	3.4°	3.3°	3.1°	2.89°	2.79°	1.4°	1.26°	1.1°	1.0°	0.9°						
Focal Length (mm)	4.3	4.5	5.0	6	6.2	7.3	7.5	7.6	7.7	8.2	8.5	9.7	10	13.6	14	15	28	45	52	60	65	78	100	106	128	131	137	156	158	164	168	180	190	197	400	437	500	560	612						
CJ45e×13.6B																																													
CJ45e×9.7B																																													
CJ27e×7.3B																																													
CJ25e×7.6B																																													
CJ20e×5B																																													
CJ15e×4.3B																																													
CJ24e×7.5B																																													
CJ18e×28B																																													
CJ18e×7.6B																																													
CJ14e×4.3B																																													
HJ40e×14B																																													
HJ40e×10B																																													
KJ22e×7.6B																																													
KJ17e×7.7B																																													
KJ10e×4.5B																																													

<b>Pro-Video Lenses (HD 2/3")</b>																																												
Angle of view horizontal (16:9)	96.3°	93.7°	77.3°	75.5°	65.2°	64.6°	63.9°	63.2°	60.7°	58.9°	51.3°	47.1°	37.8°	35.5°	19.6°	12.2°	10.5°	9.1°	7.0°	5.2°	4.3°	4.2°	4.0°	3.5°	3.5°	3.4°	3.3°	3.1°	1.45°	1.4°	1.1°	1.15°	1.0°											
Focal Length (mm)	4.3	4.5	6	6.2	7.5	7.6	7.7	7.8	8.2	8.5	10	11	14	15	28	45	52	60	78	106	128	131	137	156	158	164	168	180	385	400	500	525	560											
KJ13×6B																																												
KJ20×8.2B																																												

# Broadcast Studio/Field Lenses

## 4K UHD 2/3"

	UHD-DIGISUPER 122AF UHDxs		UHD-DIGISUPER 122 UHDxs		UHD-DIGISUPER 111 UHDxs		UHD-DIGISUPER 27 UHDxs	
								
	4K Premium IMAGE STABILIZER		4K Premium IMAGE STABILIZER		4K Premium IMAGE STABILIZER		4K Premium	
Model Name	UJ122x8.2B AF		UJ122x8.2B		UJ111x8.3B		UJ27x6.5B	
Zoom Ratio	122x		122x		111x		27x	
Focal Length	8.2 ~ 1000mm	16.4 ~ 2000mm (2.0x)	8.2 ~ 1000mm	16.4 ~ 2000mm (2.0x)	8.3 ~ 925mm	16.6 ~ 1850 mm (2.0x)	6.5 ~ 180mm	13 ~ 360mm (2.0x)
Maximum Relative Aperture	F1.7 (8.2 ~ 340mm) F5.0 (1000mm)	F3.4 (16.4 ~ 680mm) F10.0 (2000mm)	F1.7 (8.2 ~ 340mm) F5.0 (1000mm)	F3.4 (16.4 ~ 680mm) F10.0 (2000mm)	F1.7 (8.3 ~ 340mm) F4.65 (925mm)	F3.4 (16.6 ~ 680mm) F9.3 (1850mm)	F1.5 (6.5 ~ 123mm) F2.2 (180mm)	F3.0 (13 ~ 246mm) F4.4 (360mm)
Angular Field of View	60.7°×36.5° (8.2mm) 0.55°×0.31° (100mm)	32.6°×18.7° (16.4mm) 0.28°×0.15° (2000mm)	60.7°×36.5° (8.2mm) 0.55°×0.31° (100mm)	32.6°×18.7° (16.4mm) 0.28°×0.15° (2000mm)	60.1°×36.0° (8.3mm) 0.59°×0.33° (925mm)	32.3°×18.5° (16.6mm) 0.30°×0.17° (1850mm)	72.9°×45.1° (6.5mm) 3.1°×1.7° (180mm)	40.5°×23.5° (13mm) 1.5°×0.9° (360mm)
M.O.D.*	3.0m		3.0m		3.0m		0.6m	
Object Dimensions at M.O.D.*	314.8×177.1cm (8.2mm) 2.7×1.5cm (1000mm)	157.4×88.6cm (16.4mm) 1.4×0.8cm (2000mm)	314.8×177.1cm (8.2mm) 2.7×1.5cm (1000mm)	157.4×88.6cm (16.4mm) 1.4×0.8cm (2000mm)	311.6×175.3cm (8.3mm) 2.9×1.6cm (925mm)	155.8×87.7cm (16.6mm) 1.5×0.8cm (1850mm)	106.1×59.7cm (6.5mm) 3.8×2.1cm (180mm)	53.1×29.9cm (13mm) 1.9×1.1cm (360mm)
Approx. Size (WxHxL)	9.9x10.1x26.1 in. (250.6×255.5×662.0mm)		9.9x10.1x25.1 in. (250.6×255.5×637.4mm)		9.9x10.1x25.1 in. (250.6×255.5×637.4mm)		9.9x10.1x21.7 in. (250.6×255.5×550mm)	
Approx. Weight	61.7 lbs (28.0kg) ※		58.6 lbs (26.6kg) ※		58.6 lbs (26.6kg) ※		47.4 lbs (21.5kg) ※	

## 4K UHD 2/3"

	UHD-DIGISUPER 90 UHDxs		UHD-DIGISUPER 66 UHDxs	
				
	4K IMAGE STABILIZER		4K IMAGE STABILIZER	
Model Name	UJ90x9B		UJ66x9B	
Zoom Ratio	90x		66x	
Focal Length	9 ~ 810mm	18 ~ 1620mm (2.0x)	9 ~ 600mm	18 ~ 1200mm (2.0x)
Maximum Relative Aperture	F2.4 (9 ~ 486mm) F4.0 (810mm)	F4.8 (18 ~ 972mm) F8.0 (1620mm)	F1.7 (9 ~ 340mm) F3.0 (600mm)	F3.4 (18 ~ 680mm) F6.0 (1200mm)
Angular Field of View	56.1°×33.4° (9mm) 0.68°×0.38° (810mm)	29.9°×17.1° (18mm) 0.34°×0.19° (1620mm)	56.1°×33.4° (9mm) 0.92°×0.52° (600mm)	29.9°×17.1° (18mm) 0.46°×0.26° (1200mm)
M.O.D.*	3.0m		3.0m	
Object Dimensions at M.O.D.*	287.9×161.9cm (9mm) 3.3×1.9cm (810mm)	144.0×81.0cm (18mm) 1.7×1.0cm (1620mm)	287.9×161.9 cm (9mm) 4.4×2.5 cm (600mm)	144.0×81.0 cm (18mm) 2.2×1.3 cm (1200mm)
Approx. Size (WxHxL)	9.9x10x24 in. (250.6×255.5×610mm)		9.9x10.1x24 in. (250.6×255.5×610mm)	
Approx. Weight	51.2 lbs (23.2kg) ※		51.1 lbs (23.2kg) ※	

A new optical unit that creates captivating images with shallow depth of field can be added to UHD-DIGISUPER 122 and UHD-DIGISUPER 111 in Canon service facilities.

※ Weight of lens body only (does not include servo module).  
\* M.O.D. = Minimum Object Distance.

## UHD-DIGISUPER 122 AF, UHD-DIGISUPER 122: HIGHLIGHTS

### High Zoom Ratio and Long Focal Length

While displaying performance that surpasses 4K, the lens has the high zoom ratio (122x) and long focal length (1000 mm) desired by many in television production.

### Elimination of Image "Lag" Following Operational Pan/Tilt Movements

The image stabilization system must be capable of distinguishing between unwanted physical perturbations to the lens-camera system and operational control of panning and tilting of the same. In the UHD-DIGISUPER 122 lens new correction strategies have been implemented. As a result, the vibration component of the sensor detection signal and the panning operation component can be separated rapidly and with high accuracy.

### Ideally Suited to 4K Shooting

Lens is ideally suited for 4K UHD shooting required when telecasting live sports events and other applications.

### Air Sphere Coating (ASC) Technology

This is a Canon-developed technology that is an additional layer deposited on top of the normal multilayer coatings that are used to minimize those many internal reflections that conspire to lower light transmission efficiency and to contaminate deep black reproduction.

### High Speed, High Precision Auto Focus

The UJ122AF's high-precision auto focus is enabled with Canon's Motion Tracking Feature.\*

\* Available only on UJ122AF

The UHD-DIGISUPER 122AF is compatible with the FDJ-S41 Focus Controller which allows for adjustment of focus modes (OFF/ Full Time/Part Time) and setting the size and area of the focus window.



### Compatibility with HD Lens Systems

The lens enables the use of the same Canon standard controllers for zoom and focus as well as servo modules currently used by HD equipment. It comes with a 20-pin connector compatible with virtual units and that enables high-accuracy position information of the zoom, focus and iris to be read out.



FDJ-S41

# Broadcast Studio/Field Lenses

## HD 2/3"

	<b>DIGISUPER 95 TELE</b>  		<b>DIGISUPER 95</b>  	
	Model Name XJ95x12.4B		Model Name XJ95x8.6B	
Zoom Ratio 95x		Zoom Ratio 95x		
Focal Length 12.4 ~ 1178mm		Focal Length 8.6 ~ 820mm		
Maximum Relative Aperture F2.5 (12.4 ~ 491mm) F6.0 (1178mm)		Maximum Relative Aperture F1.7 (8.6 ~ 340mm) F4.1 (820mm)		
Angular Field of View 42.3°x24.6° (12.4mm) 0.47°x0.26° (1178mm)		Angular Field of View 58.3°x34.9° (8.6mm) 0.67°x0.38° (820mm)		
M.O.D.* 3.0m		M.O.D.* 3.0m		
Object Dimensions at M.O.D.* 209.5x117.8cm (12.4mm) 2.3x1.3cm (1178mm)		Object Dimensions at M.O.D.* 298.1x167.7cm (8.6mm) 3.2x1.8cm (820mm)		
Approx. Size (WxHxL) 9.9x10x24 in. (250.6x255.5x610mm)		Approx. Size (WxHxL) 9.9x10x24 in. (250.6x255.5x610mm)		
Approx. Weight 51.1 lbs (23.2kg) ※		Approx. Weight 51.1 lbs (23.2kg) ※		

## HD 2/3"

	<b>DIGISUPER 80</b>  	
	Model Name XJ80x8.8B	
Zoom Ratio 80x		
Focal Length 8.8 ~ 710mm		
Maximum Relative Aperture F1.7 (8.8 ~ 340mm) F3.55 (710mm)		
Angular Field of View 57.2°x34.1° (8.8mm) 0.77°x0.44° (710mm)		
M.O.D.* 3.0m		
Object Dimensions at M.O.D.* 290.0x163.1cm (8.8mm) 3.7x2.1cm (710mm)		
Approx. Size (WxHxL) 9.9x10x24 in. (250.6x255.5x610mm)		
Approx. Weight 51.1 lbs (23.2kg) ※		

※ Weight of lens body only (does not include servo module).  
\* M.O.D. = Minimum Object Distance.

# ZOOM DEMAND: Highlights

ZDJ-G01    ZDJ-S01

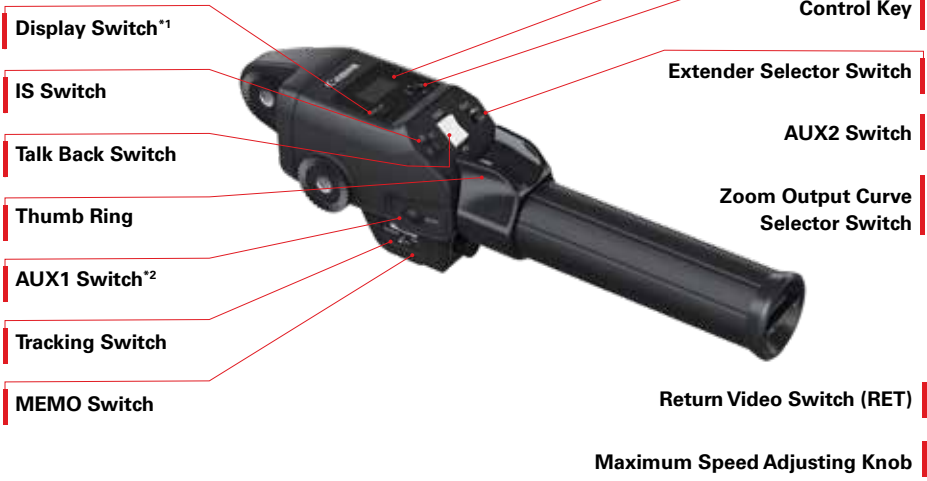

### Main Features

#### Frame Preset/Shuttle Shot/Speed Preset

This function moves to a preset zoom position with the push of a switch. Frame preset and shuttle shot each moves at maximum speed, while speed preset moves at preset speed. Letting go of the switch in shuttle shot returns to the original position. Moving speed with framing preset can be set with the ZDJ-G01.

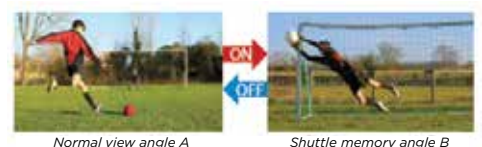

#### Zoom Track

Zoom control range can be set for both the wide angle and telephoto sides, to control zoom range required for actual shooting.

The Unit pictured is the ZDJ-G01  
\*1: Not available on the ZDJ-S01  
\*2: This is a framing preset switch on the ZDJ-S01

## Control Accessories for Studio/Field Lenses

# DIGITAL UHD-DIGISUPER/DIGISUPER Series

For:  
DIGISUPER 122AF

For:  
UHD-DIGISUPER 122 / UHD-DIGISUPER 111 / UHD-DIGISUPER 90 /  
UHD-DIGISUPER 66 / UHD-DIGISUPER 27 / DIGISUPER 95 TELE /  
DIGISUPER 95 / DIGISUPER 80

### FULL SERVO SYSTEM

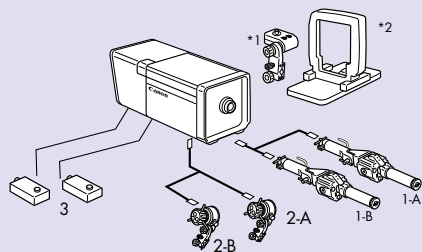

#### KIT DETAIL

No.	DESCRIPTION
1-A.	Zoom Demand ZDJ-G01 (Digital Servo)
1-B.	Zoom Demand ZDJ-S01 (Digital Servo)
2-A.	Focus Demand FDJ-S31 (Digital Servo)
2-B.	Focus Demand FDJ-S41 (Digital Servo)
3.	Servo Module SMJ-E01 (2pcs)

### FULL SERVO SYSTEM

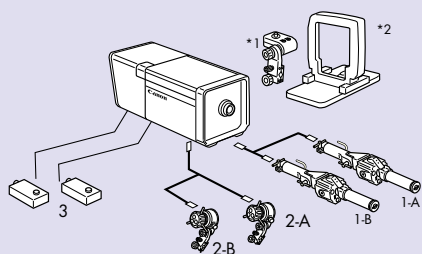

#### KIT DETAIL

No.	DESCRIPTION
1-A.	Zoom Demand ZDJ-G01 (Digital Servo)
1-B.	Zoom Demand ZDJ-S01 (Digital Servo)
2-A.	Focus Demand FDJ-G01 (Digital Servo)
2-B.	Focus Demand FDJ-S01 (Digital Servo)
3.	Servo Module SMJ-E01 (2pcs)

### SEMI-SERVO SYSTEM

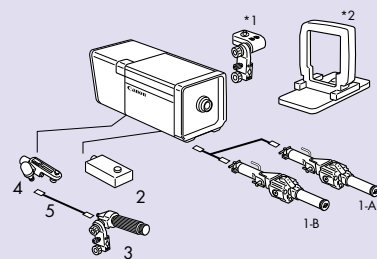

#### KIT DETAIL

No.	DESCRIPTION
1-A.	Zoom Demand ZDJ-G01 (Digital Servo)
1-B.	Zoom Demand ZDJ-S01 (Digital Servo)
2.	Servo Module SMJ-E01
3.	Flexible Focus Controller FFP-T61
4.	Flexible Module FMJ-702
5.	Flexible Cable 36"

For:  
All UHD-DIGISUPER /  
DIGISUPER Lenses

For:  
UHD-DIGISUPER 122 AF

For:  
UHD-DIGISUPER 122/  
UHD-DIGISUPER 111

### FULL MANUAL SYSTEM

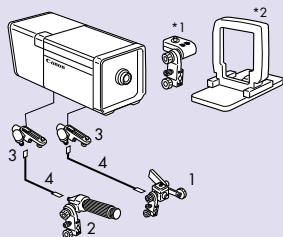

#### KIT DETAIL

No.	DESCRIPTION
1.	Flexible Zoom Controller FZP-T61
2.	Flexible Focus Controller FFP-T61
3.	Flexible Module FMJ-702 (2pcs)
4.	Flexible Cable 36" (2pcs)

### FDJ-S41 FOCUS DEMAND

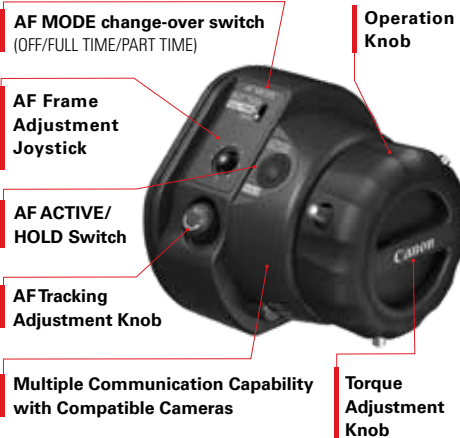

AF MODE change-over switch  
(OFF/FULL TIME/PART TIME)

Operation Knob

AF Frame Adjustment Joystick

AF ACTIVE/HOLD Switch

AF Tracking Adjustment Knob

Multiple Communication Capability with Compatible Cameras

Torque Adjustment Knob

### BOKEH EFFECT CONTROLLER

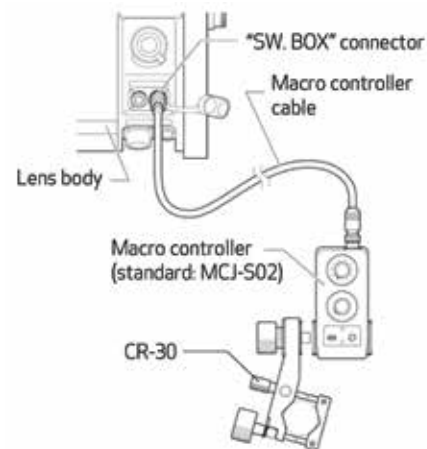

\*1: Switch Box is optionally available. The equivalent switches are integrated into Zoom Demands. It is recommended to have the Switch Box with Full Manual System.

\*2: Lens Supporter is necessary for portable camera mounting. Some cameras need separate power supply for zoom and focus servo operation.

• Zoom Demand and Focus Demand with Pre-set Box is also available.

• For detail information, please contact a Canon Sales Office.

## Studio/Field Lenses Mount Compatibility

### To Use Camera Manufacturer's Original Mount Lenses

Studio/Field lenses are made with mounts corresponding to each manufacturer's Studio/Field cameras. To make the lenses compatible with Portable Studio/Field Companion cameras, the correct lens Support System must be chosen from the following:

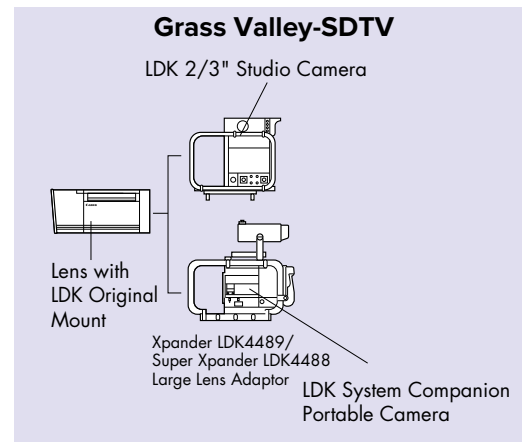
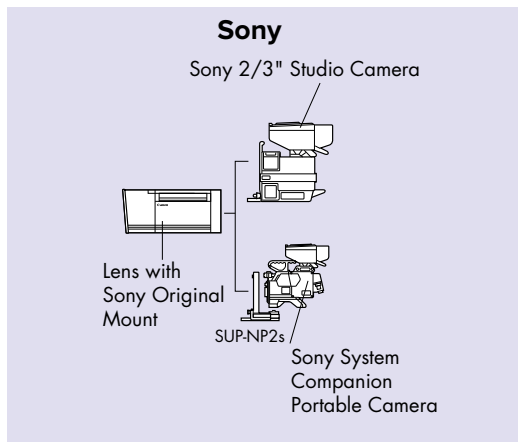
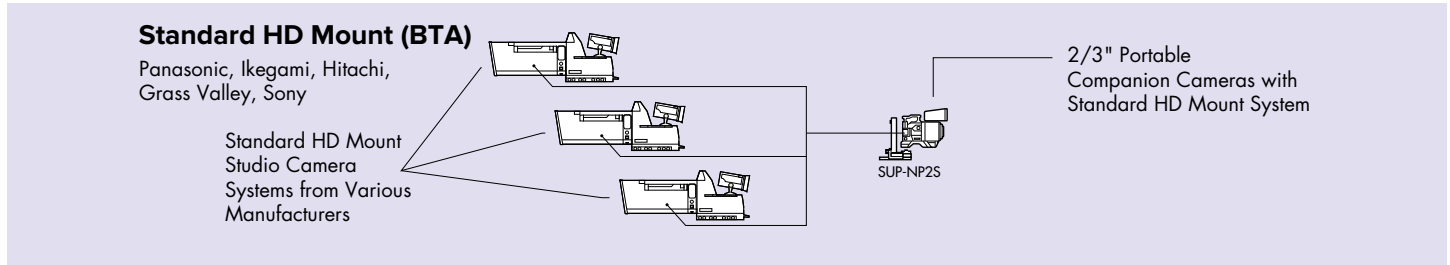

*Please confirm with camera manufacturer regarding the proper supporter to use. Some manufacturers vary by camera model.*

# Broadcast ENG/EFP Lenses

## 4K UHD 2/3"

	<b>CJ45e×13.6B</b> <b>UHDxs</b>  <b>IMAGE STABILIZER</b> <b>4K</b>	<b>CJ45e×9.7B</b> <b>UHDxs</b>  <b>IMAGE STABILIZER</b> <b>4K</b>	<b>CJ27e×7.3B</b> <b>UHDxs</b>  <b>4K</b>			
<b>Model Name</b>	CJ45e×13.6B IASE-V H		CJ45e×9.7B IASE-V H		CJ27e×7.3B IASE T	
<b>Zoom Ratio</b>	45×		45×		27×	
<b>Focal Length</b>	13.6 ~ 612mm	27.2 ~ 1224mm (2.0x)	9.7 ~ 437mm	19.4 ~ 874mm (2.0x)	7.3 ~ 197mm	14.6 ~ 394mm (2.0x)
<b>Maximum Relative Aperture</b>	F1:2.8 (13.6 ~ 312mm) F1:5.5 (612mm)	F1:5.6 (27.2 ~ 624mm) F1:11.0 (1224mm)	F1:2.0 (9.7 ~ 224mm) F1:3.9 (437mm)	F1:4.0 (19.4 ~ 448mm) F1:7.8 (874mm)	F1.8 (7.3 ~ 120mm) F2.95 (197mm)	F3.6 (114.6 ~ 240mm) F5.9 (294mm)
<b>Angular Field of View</b>	38.9°×22.5° (13.6mm) 0.90°×0.51° (612mm)	20.0°×11.3° (27.2mm) 0.45°×0.25° (1224mm)	52.7°×31.1° (9.7mm) 1.26°×0.71° (437mm)	27.8°×15.8° (19.4mm) 0.63°×0.35° (874mm)	66.7°×40.6° (7.3mm) 2.79°×1.57° (197mm)	36.4°×21.0° (14.6mm) 1.408°×0.79° (394mm)
<b>M.O.D.* from Lens Front</b>	2.8m		2.8m		0.8m	
<b>Object Dimensions at M.O.D.*</b>	182.9×102.9cm (13.6mm) 4.2×2.4cm (612mm)	91.5×51.5cm (27.2mm) 2.1×1.2cm (1224mm)	254.3×143.0cm (9.7mm) 5.8×3.3cm (437mm)	127.2×71.5cm (19.4mm) 2.9×1.7cm (874mm)	98.0×55.1cm (7.3mm) 3.8×2.2cm (197mm)	49.0×27.6cm (14.6mm) 1.9×1.1cm (394mm)
<b>Filter Thread Size (Hood/Lens Barrel)</b>	- / 127mm P0.75		- / 127mm P0.75		105mm P1 / 94mm P1	
<b>Approx. Size (WxHxL)</b>	6.8×5.8×14.0 in. (173.2×147.5×355.0mm)		6.8×5.8×13.3 in. (173.2×147.5×337.0mm)		6.7×4.6×9.0 in. (169.9×117.2×229.0mm)	
<b>Approx. Weight</b>	12.4 lbs (5.64kg)		12.3 lbs (5.60kg)		4.6 lbs (2.10kg)	

## CJ27e×7.3B IASE: Highlights

### High Optical Performance

Excellent optical performance for 4K cameras that maintains high resolution from the center of the image to the periphery.

### Suits a Variety of Shooting Needs

Combination of 7.3mm wide angle and a class-leading\* 27x zoom magnification with the portability of an ENG lens.



### Next-Generation e-Xs V Drive Unit

A new design with more advanced features and improved ergonomics.

### Built-in 2x Extender

4K Optical performance is maintained even when the 2x extender is engaged.

## e-Xs V DRIVE UNIT: Highlights

### Focus Breathing Compensation

A new feature which minimizes image distortion when racking focus. This setting can easily be turned on or off depending on preference.

### Angled 20-pin Connector

Allows the camera to be placed on a flat surface with a 20-pin cable connected.



### New USB-C Port

Allows Drive Unit settings to be saved and loaded into other lenses. End users would be able to update firmware and can record and save maintenance history.

\*Among portable lenses for 2/3-inch 4K cameras with ENG-style design

## 4K UHD 2/3"

	<b>CJ25e×7.6B</b> <b>UHDxs</b> 	<b>CJ20e×5B</b> <b>UHDxs</b>  <b>WIDE</b> <b>4K</b>		
<b>Model Name</b>	CJ25e×7.6B IASE T		CJ20e×5B IASE T	
<b>Zoom Ratio</b>	25×		20×	
<b>Focal Length</b>	7.6 ~ 190mm	15.2 ~ 380mm (2.0x)	5 ~ 100mm	10 ~ 200mm (2.0x)
<b>Maximum Relative Aperture</b>	F1.8 (7.6 ~ 1108mm) F2.9 (190mm)	F3.6 (15.2 ~ 236mm) F5.8 (380mm)	F1.8 (5 ~ 61mm) F2.95 (100mm)	F3.6 (10 ~ 122mm) F5.9 (200mm)
<b>Angular Field of View</b>	64.6°×39.1° (7.6mm) 2.89°×1.63° (190mm)	35.1°×20.1° (15.26mm) 1.458°×0.81° (380mm)	87.7°×56.7° (5mm) 5.5°×3.1° (100mm)	51.3°×30.2° (10mm) 2.7°×1.5° (200mm)
<b>M.O.D.* from Lens Front</b>	0.8m		0.4m	
<b>Object Dimensions at M.O.D.*</b>	93.9×52.8cm (7.6mm) 3.9×2.2cm (190mm)	48.1×27.1cm (15.2mm) 2.0×1.1cm (380mm)	87.1×49.0cm (5mm) 4.2×2.4cm (100mm)	43.6×24.5cm (10mm) 2.1×1.2cm (200mm)
<b>Filter Thread Size (Hood/Lens Barrel)</b>	105mm P1 / 94mm P1		127mm P0.75	
<b>Approx. Size (WxHxL)</b>	6.8×4.5×8.8 in. (169.6×114.4×223.3mm)		6.5×4.5×9.9 in. (166.2×113.5×251.7mm)	
<b>Approx. Weight</b>	4.4 lb (1.99kg)		5.05 lb (2.29kg)	

### Improved Servo Control

Faster iris speed.



### Ergonomic Design

Designed to reduce arm fatigue.







### New Information Display

Conveniently located on the top of the drive unit with a simplified menu.

\* M.O.D. = Minimum Object Distance.

## Broadcast ENG/EFP Lenses

### 4K UHD 2/3"

	<b>CJ15ex4.3B</b> <b>UHDxS</b>		<b>CJ18ex28B</b> <b>UHD<sub>GC</sub></b>		<b>CJ24ex7.5B</b> <b>UHD<sub>GC</sub></b>	
						
Model Name	CJ15ex4.3B IASE T		CJ18ex28B IASE T		CJ24ex7.5B IASE T	
Zoom Ratio	15x		18x		24x	
Focal Length	4.3 ~ 65mm	8.6 ~ 130mm (2.0x)	28 ~ 500mm	56 ~ 1000mm (2.0x)	7.5 ~ 180mm	15.0 ~ 360mm (2.0x)
Maximum Relative Aperature	F1.8 (4.3 ~ 40mm) F2.9 (65mm)	F3.6 (8.6 ~ 80mm) F5.8 (130mm)	F2.8 (28 ~ 286mm) F4.9 (500mm)	F5.6 (56 ~ 572mm) F9.8 (1000mm)	F1.8 (7.5 ~ 120mm) F1.7 (180mm)	F1.3.6 (15 ~ 240mm) F1.5.4 (360mm)
Angular Field of View	96.3°×64.2° (4.3mm) 8.4°×4.8° (65mm)	58.3°×34.9° (8.6mm) 4.2°×2.4° (130mm)	19.5°×11.0° (28mm) 1.10°×0.62° (500mm)	9.8°×5.5° (56mm) 0.55°×0.31° (1000mm)	65.2°×39.6° (7.5mm) 3.1°×1.7° (180mm)	35.5°×20.4° (15mm) 1.5°×0.9° (360mm)
M.O.D.* from Lens Front	0.3m		2.2m		0.80m	
Object Dimensions at M.O.D.*	76.1×42.8cm (4.3mm) 4.9×2.8cm (65mm)	38.1×21.4cm (8.6mm) 2.5×1.4cm (130mm)	71.0×39.9cm (28mm) 4.1×2.3cm (500mm)	35.5×20.0cm (56mm) 2.1×1.2cm (1000mm)	96.0×54.0 cm (7.5mm) 4.1×2.3 cm (180mm)	48.0×27.0 cm (15mm) 2.1×1.2 cm (360mm)
Filter Thread Size (Hood/Lens Barrel)	127mm P0.75 / -		127mm P0.75 / -		105mm P1 / 94mm P1	
Approx. Size (WxHxL)	6.4x4.2x9.8 in. (163.0x107.6x249.6mm)		7.0x4.8x10.6 in. (177.8x122.5x268.3mm)		6.5x4.3x8.7 in. (164.6x109.1x221.4mm)	
Approx. Weight	4.8 lb (2.19kg)		6.08 lbs (2.76kg)		4.0 lbs (1.82kg)	

### 4K UHD 2/3"

	<b>CJ18ex7.6B</b> <b>UHD<sub>GC</sub></b>		<b>CJ14ex4.3B</b> <b>UHD<sub>GC</sub></b>	
				
Model Name	UJ18ex7.6B IASE T		CJ14ex4.3B IASE T	
Zoom Ratio	18x		14x	
Focal Length	7.6 ~ 137 mm	15.2 ~ 274 mm (2.0x)	4.3 ~ 60mm	8.6 ~ 120 mm (2.0x)
Maximum Relative Aperature	F1:1.8 (7.6 ~ 103mm) F1:2.4 (137mm)	F 1:3.6 (15.2 ~ 206mm) F1:4.8 (274mm)	F1:1.8 (4.3 ~ 40 mm) F1:2.7 (60mm)	F1:3.6 (8.6 ~ 80mm) F1:5.4 (120mm)
Angular Field of View	64.6°×39.1° (7.6mm) 4.0°×2.3° (137mm)	35.1°×20.1° (15.2mm) 2.0°×1.1° (274mm)	96.3°×64.2° (4.3mm) 9.1°×5.2° (60mm)	58.3°×34.9° (8.6mm) 4.6°×2.6° (120mm)
M.O.D.* from Lens Front	0.56m		0.30m	
Object Dimensions at M.O.D.*	65.5×36.8 cm (7.6mm) 3.8×2.1 cm (137mm)	32.8×18.4 cm (15.2mm) 1.9×1.1 cm (274mm)	76.4×43.0 cm (4.3mm) 5.2×2.9 cm (60mm)	38.2×21.5 cm (8.6mm) 2.6×1.5 cm (120mm)
Filter Thread Size (Hood/Lens Barrel)	- / 82mm P0.75		127mm P0.75 / -	
Approx. Size (WxHxL)	6.3x4.2x8.1 in. (160.4x107.7x206.2mm)		6.4x4.3x9.8 in. (163.5x108.0x247.8mm)	
Approx. Weight	3.86 lbs (1.75kg)		4.7 lbs (2.11kg)	

\* M.O.D. = Minimum Object Distance.

## Broadcast ENG/EFP Lenses

HD 2/3"	HJ40ex14B  <b>HD XS</b>		HJ40ex10B  <b>HD XS</b>	
				
Model Name	HJ40ex14B IASE-V H		HJ40ex10B IASE-V H	
Zoom Ratio	40x		40x	
Focal Length	14 ~ 560mm	28 ~ 1120mm (2.0x)	10 ~ 400mm	20 ~ 800mm (2.0x)
Maximum Relative Aperture	F2.8 (14 ~ 307mm) F5.1 (560mm)	F5.6 (28 ~ 614mm) F10.2 (1120mm)	F2.0 (10 ~ 220mm) F3.65 (400mm)	F4.0 (20 ~ 440mm) F7.3 (800mm)
Angular Field of View	37.8°×21.8° (14mm) 1.0°×0.6° (560mm)	19.4°×11.0° (28mm) 0.5°×0.3° (1120mm)	51.3°×30.2° (10mm) 1.4°×0.8° (400mm)	27.0°×15.4° (20mm) 0.7°×0.4° (800mm)
M.O.D.* from Lens Front	2.8m		2.8m	
Object Dimensions at M.O.D.*	177.1×99.5cm (14mm) 4.5×2.5cm (560mm)	88.6×49.8cm (28mm) 2.3×1.3cm (1120mm)	248.4×139.7cm (10mm) 6.2×3.5cm (400mm)	124.2×69.9cm (20mm) 3.1×1.8cm (800mm)
Filter Thread Size (Hood/Lens Barrel)	— / 127mm P0.75		— / 127mm P0.75	
Approx. Size (WxHxL)	6.6x5.2x14 in. (167.5x133.0x355.5mm)		6.6x5.2x13.2 in. (167.5x133.0x355.4mm)	
Approx. Weight	12.2 lbs (5.55 kg)		12.1 lbs (5.5 kg)	

HD 2/3"	KJ22ex7.6B  <b>HDGC</b>	KJ17ex7.7B  <b>HDGC</b>	KJ10ex4.5B  <b>HDGC</b>
			
Model Name	KJ22ex7.6B IASE II S		KJ10ex4.5B IASE S
Zoom Ratio	22x		10x
Focal Length	7.6-168mm	15.2-336mm (2.0x)	4.5-45mm
Maximum Relative Aperture	1:1.8 at 7.6-120mm 1:2.6 at 168mm	1:3.6 at 15.2-240mm 1:5.2 at 336mm (2.0x)	1:1.8 at 4.5-34.5mm 1:2.35 at 45mm
Angular Field of View	64.6°×39.1° at 7.6mm 3.3°×1.8° at 168mm	35.1°×20.1° at 15.2mm 1.6°×0.9° at 336mm	93.7°×61.9° at 4.5mm 12.2°×6.9° at 45mm
M.O.D.* from Lens Front	0.8m		0.3m
Object Dimensions at M.O.D.*	94.7×53.3cm at 7.6mm 4.4×2.5cm at 168mm	47.4×26.7cm at 15.2mm 2.2×1.3cm at 336mm	74.1×41.7cm at 4.5mm 6.4×3.6cm at 45mm
Filter Thread Size (Hood/Lens Barrel)	105mm P1 / 94mm P1		127mm P0.75 / —
Approx. Size (WxHxL)	6.5x4.3x8.7 in. (164.6x109.1x221.4mm)		6.6x4.4x9.4 in. (168.2x111.8x237.7mm)
Approx. Weight (IRSE/IASE)	4.0 lbs (1.82kg) (IRSE II S)		4.04 lbs (1.83kg)/4.22 lbs (1.91kg)

## Pro-Video Lenses

HD 2/3"	KJ20x8.2B  <b>HDGC</b>	KJ20x8.2B  <b>HDGC</b>	KJ13x6B  <b>HDGC</b>
			
Model Name	KJ20x8.2B IRSD		KJ13x6B KRSD
Zoom Ratio	20x		13x
Focal Length	8.2-164mm	16.4-328mm (2.0x)	6-78mm
Maximum Relative Aperture	1:1.9 at 8.2-115.4mm 1:2.7 at 164mm	1:3.8 at 16.4-230.8mm 1:5.4 at 328mm	1:2.0 at 6-58mm 1:2.7 at 78mm
Angular Field of View	60.7°×36.5° at 8.2mm 3.4°×1.9° at 164mm	32.6°×18.7° at 16.4mm 1.7°×0.9° at 328mm	77.3°×48.5° at 6mm 7.0°×4.0° at 78mm
M.O.D.* from Lens Front	0.9m		0.4m
Object Dimensions at M.O.D.*	98.2×55.2cm at 8.2mm 5.0×2.8cm at 164mm	49.1×27.6cm at 16.4mm 2.5×1.4cm at 328mm	74.3×41.8cm at 6mm 5.4×3.0cm at 78mm
Filter Thread Size (Hood/Lens Barrel)	— / 82mm P0.75		105mm P1 / —
Approx. Size (WxHxL)	6.4x4.1x8.2 in. (163.3x104.1x208.0mm)		6.5x4.1x8.3 in. (165.4x104.1x211.7mm)
Approx. Weight	3.13 lbs (1.42kg)		3.51 lbs (1.59kg)

## Broadcast ENG/EFP, Pro Video Lens Optical Accessories

### Adaptor Type Converters/Attachments

CATEGORY	MODEL	CJ45e×13.6B CJ45e×9.7B CJ18e×28B	CJ15e×4.3B CJ14e×4.3B CJ20e×5B	KJ10e×4.5B HJ40e×14B HJ40e×10B	KJ13×6B	CJ27e×7.3B CJ25e×7.6B CJ24e×7.5B KJ22e×7.6B	CJ18e×7.6B KJ20×8.2B KJ17e×7.7B
CLOSE-UP LENS	105CL-UP800HG					●	
UV FILTER	UV / 82						●
	UV / 94					●	
	UV / 105				●	●	
	UV/127			●			
	UV / 127-H	●		●			
CLEAR FILTER	CL/127MM-H	●		●			

## Broadcast ENG/EFP, Pro Video Lens Accessories

### Compatible Zoom/Focus Control List

OPERATION	CATEGORY	MODEL	CJ45e×13.6B CJ45e×9.7B CJ18e×28B HJ40e×14B HJ40e×10B	CJ27e×7.3B CJ25e×7.6B CJ24e×7.5B CJ20e×5B CJ18e×7.6B	CJ15e×4.3B CJ14e×4.3B KJ22e×7.6B KJ17e×7.7B KJ10e×4.5B	KJ20×8.2B KJ13×6B	
FOCUS	FOCUS DEMAND	FPD-400D	●		●		
	FLEX CONTROLLER	FFC-200	● <sup>*1</sup>		● <sup>*2</sup>	●	
	FLEXIBLE CABLE (32 INCHES)	FC-40	● <sup>*1</sup>		● <sup>*2</sup>	●	
		OUTLET	FFM-100			● <sup>*2</sup>	
			FM-12				●
		FFM-300	● <sup>*1</sup>				
ZOOM	ZOOM DEMAND	ZSD-300D	●		●		
	PROVIDED ZOOM	ZSD-15MII				●	

\* 1: These accessories are not recommended for use with CJ45e×9.7B ,CJ45e×13.6B and CJ18e×28B.

\* 2: These controllers are not recommended for shooting 4K with CJ lenses.

## Broadcast ENG/EFP, Pro Video Lens Accessories

### Focus Controller



### Zoom Controller

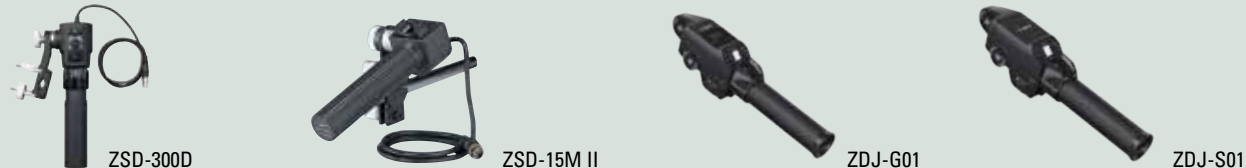

■ Conversion Cable is Necessary When Using with the Following Combinations

Model Name	Applicable Lens	Adapter Cable	Lens Side Pin#	Control Side Pin#
ZSD-300	Digital Drive Lens	CC-2008	20	8

Model Name	Applicable Lens	Adapter Cable	Lens Side Pin#	Control Side Pin#
FPD-400D	Analog Drive Lens	CC-0620	6	20
ZSD-300D		CC-0820	8	20

\* Not sold individually.

## Control Accessories for Digital Drive ENG/EFP Lenses

CJ45ex13.6B / CJ45ex9.7B / CJ27ex7.3B / CJ25ex7.6B / CJ20ex5B / CJ18ex28B / CJ24ex7.5B / CJ18ex7.6B / CJ14ex4.3B / HJ40ex14B / HJ40ex10B / KJ22ex7.6B / KJ17ex7.7B / KJ10ex4.5B

### Recommended Kit Configurations

#### MS-210D

for all listed IASE S/IRSE S/KRSE S Lenses

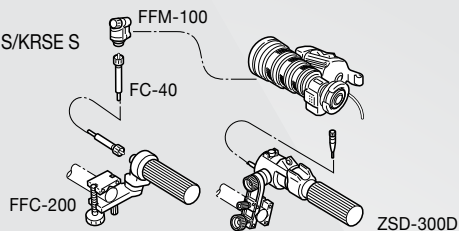

#### SEMI-SERVO KIT

#### SS-41-IASD

for all listed IASE S Lenses

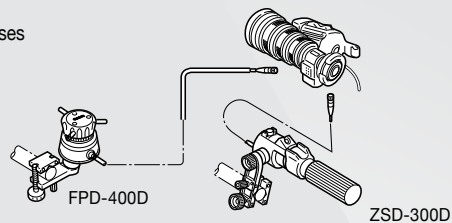

#### FULL SERVO KIT

## DIGITAL Control Accessories of Digital Drive ENG/EFP Lenses

### Applicable Component Detail

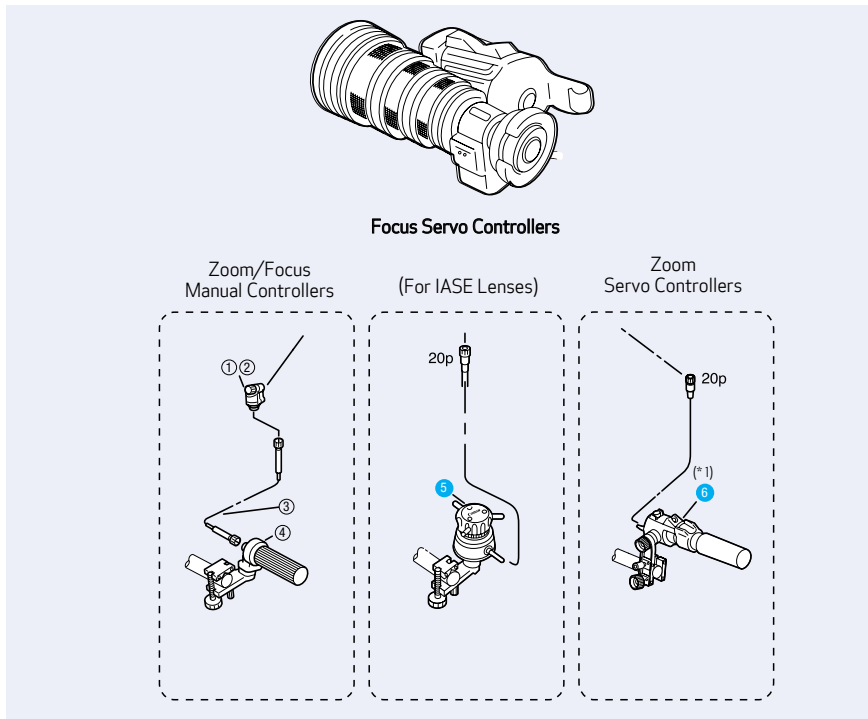

#	UNIT	DESCRIPTION
①	FFM-100	Flex Focus Module
②	FFM-300	Flex Focus Module
③	FC-40	Flex Cable
④	FFC-200	Flex Focus Controller
⑤	FPD-400D	Focus Positional Demand
⑥	ZSD-300D <sup>*1</sup>	Zoom Demand
⑦	CR-10	Clumper
⑧	CC-2008	20p-8p Cable

\*1: Analog ZSD-300A/M is also applicable but CC-2008 is needed to connect between IASE S digital drive lens and ZSD-300A/M.

● The controllers support the new DD functions.

### Applicable Kit Detail

#### For IRSE S Type Lenses

	Kit Name	Zoom	Focus
		Unit #	Unit #
Zoom Servo Only	—	⑥	—
Semi-Servo	MS-210D	⑥	① ③ ④

#### For CJ45ex13.6B, CJ45ex9.7B, HJ40ex14B and HJ40ex10B

	Kit Name	Zoom	Focus
		Unit #	Unit #
Zoom Servo Only	—	⑥	—
Semi-Servo	—	⑥	② ③ ④
Full Servo	SS-41-IASD	⑥	⑤

#### For for IASE S Type/ T Type Lenses (Except HJ40ex, CJ45ex)

	Kit Name	Zoom	Focus
		Unit #	Unit #
Zoom Servo Only	—	⑥	—
Semi-Servo	MS-210D	⑥	① ③ ④
Full Servo	SS-41-IASD	⑥	⑤

■ Recommended kit configuration.

# ANALOG Control Accessories for Analog Drive HDgc Lenses

## Recommended Kit Configuration

**MS-15** SEMI-SERVO KIT  
for all Pro-video ENG lenses

Diagram showing the MS-15 kit components: FM-12 (Flex Focus Module), FC-40 (Flex Cable), FFC-15 (Flex Focus Controller), and ZSD-15MII (Zoom Demand).

**MS-21D** SEMI-SERVO KIT  
for all Pro-video ENG lenses

Diagram showing the MS-21D kit components: FM-12 (Flex Focus Module), FC-40 (Flex Cable), FFC-200 (Flex Focus Controller), CC-0820 (Conv. Cable), and ZSD-300D (Zoom Demand).

## Applicable Component Detail

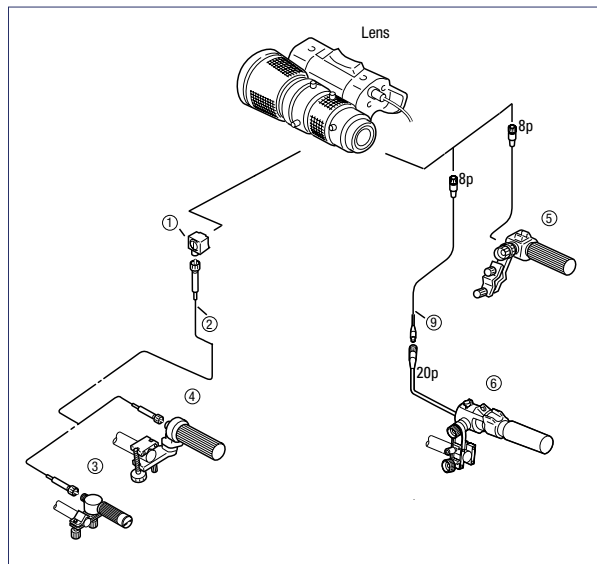

#	UNIT	DESCRIPTION
①	FM-12	Flex Focus Module
②	FC-40	Flex Cable
③	FFC-15	Flex Focus Controller
④	FFC-200	Flex Focus Controller
⑤	ZSD-15M II	Zoom Demand
⑥	ZSD-300D	Zoom Demand
⑦	CR-10	Clamper
⑧	EC-80	Zoom Extension Cable (8P)
⑨	CC-0820	Conv. Cable (8pM-20pF)

## Applicable Kit Detail

	Kit Name	Zoom	Focus
		Unit #	Unit #
Zoom Servo Only	—	⑤	—
Semi-Servo	MS-15	⑤*	① ② ③*
	MS-21D	⑥ ⑩	① ② ④

\*In USA, ⑤ and ③ are available only as MS-15 kit configuration and not as individual products.

  Recommended kit configuration.

# Canon Cinema Lens Technology

## Optical Performance

### Crystal Clear Canon Optical Technology

#### Super 35mm or Full Frame, High quality 4K/HDR

From the center to the periphery of our cinema lenses, a high-quality 4K/HDR image is achieved for both single focus and zoom lenses within the entire zoom range. Canon's optical technologies are combined to help correct various aberrations and provide high contrast while achieving a high resolution of about 80 lines/mm throughout the sensor.



### Focus Breathing Suppression

Focus breathing is caused when the focus group moves and exerts a "zooming" effect. In order to prevent this, cinema lenses implement a 3-group inner focus method and a new floating method to help minimize field angle fluctuation and achieve stable framing.

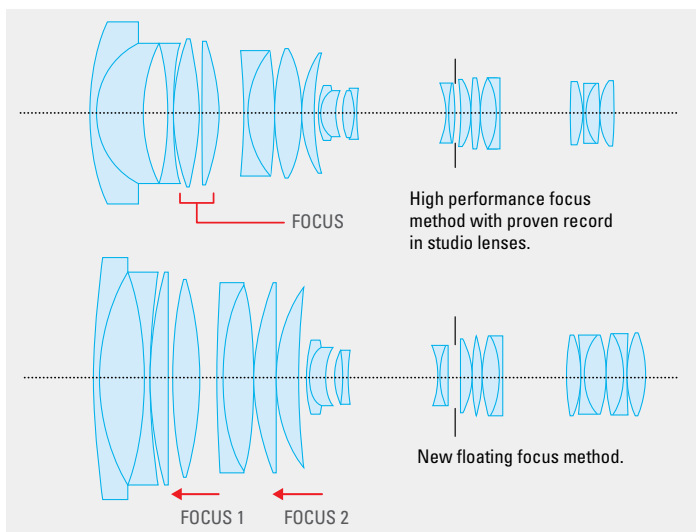

### 11 Blade Aperture

Halos from points of light at night or from rays of sunlight in shots that show the sun take on the shape of the Iris blades. The odd number of blades make the iris aperture look circular even when the Iris is contracted, enabling beautiful, round highlight bokeh.

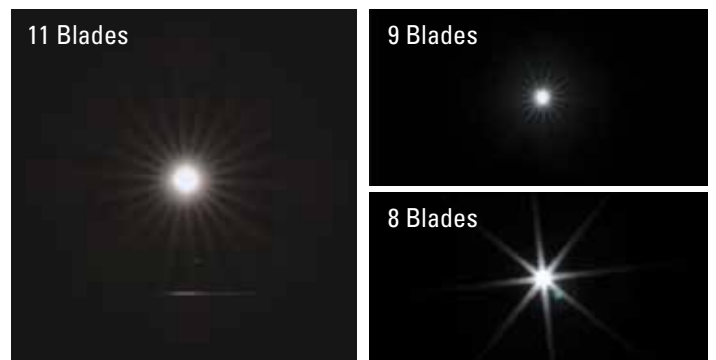

### Warm Color Balance

Cinema lens color balance, ideal for movie production, reproduces warm skin tones. Color balance is strictly uniform across all Canon cinema lenses making lens substitution during the same scene possible. Anti-reflection film technology, including super spectral coatings and thorough corrections for slight color variations caused by glass components allow Canon lenses to achieve this effect.



### Flange Back Adjustment

A flange back adjustment mechanism is installed on the zoom lens mounts to allow for back focus adjustments.

\* Excluding EF, RF and Sumire Prime Lenses.

■ Cinema Lens Focal Distance Table

ZOOM Lenses											
Angle of view horizontal (1.78:1)*1	79.2°		43.6°			22.6°			4.6°		
Focal Distance (mm)	14.5		30			60			300		
CN-E30-300mm T2.95-3.7 L											
COMPACT ZOOM Lenses											
Angle of view horizontal (1.78:1)*2	75.5°		43.6°			28.6°			13.0°		
Focal Distance (mm)	15.5		30			47			105		
CN-E30-105mm T2.8 L											
FLEX ZOOM Lenses											
Focal Distance (mm)	14	20	31.5	35	45	50	95	135			
CN-E14-35mm T1.7 L S / SP											
CN-E31.5-95mm T1.7 L S / SP											
CN-E20-50mm T2.4 L F / FP											
CN-E45-135mm T2.4 L F / FP											
RF PRIME Lenses											
Angle of view horizontal (1.78:1)*2	82.6°	63.2°	54.3°	38.7°	27.6°	16.5°	10.4°				
Focal Distance (mm)	14	20	24	35	50	85	135				
CN-R14mm T3.1 L F	●										
CN-R20mm T1.5 L F		●									
CN-R24mm T1.5 L F			●								
CN-R35mm T1.5 L F				●							
CN-R50mm T1.3 L F					●						
CN-R85mm T1.3 L F						●					
CN-R135mm T2.2 L F							●				
SUMIRE PRIME Lenses											
Angle of view horizontal (1.78:1)*2	82.6°	63.2°	54.3°	38.7°	27.6°	16.5°	10.4°				
Focal Distance (mm)	14	20	24	35	50	85	135				
CN-E14mm T3.1 FP X	●										
CN-E20mm T1.5 FP X		●									
CN-E24mm T1.5 FP X			●								
CN-E35mm T1.5 FP X				●							
CN-E50mm T1.3 FP X					●						
CN-E85mm T1.3 FP X						●					
CN-E135mm T2.2 FP X							●				
EF PRIME Lenses											
Angle of view horizontal (1.78:1)*2	82.6°	63.2°	54.3°	38.7°	27.6°	16.5°	10.4°				
Focal Distance (mm)	14	20	24	35	50	85	135				
CN-E14mm T3.1 L F	●										
CN-E20mm T1.5 L F		●									
CN-E24mm T1.5 L F			●								
CN-E35mm T1.5 L F				●							
CN-E50mm T1.3 L F					●						
CN-E85mm T1.3 L F						●					
CN-E135mm T2.2 L F							●				
CINE-SERVO Lenses											
Angle of view horizontal (1.78:1)*2	96.4°	78.7°	71.8°	52.4°	34.2°	27.6°	25.2°	11.7°	5.6°	1.4°	1.17°
Focal Distance (mm)	11	15	17	25	40	50	55	120	250	1000	1200
CN8x15 IAS S											
CN7x17 KAS S / CN7x17 KAS T											
CN5x11 IAS T											
CN10x25 IAS S											
CN20x50 IAS H											
NEW CN30x40 IAS H											
COMPACT-SERVO Lenses											
Angle of view horizontal (1.78:1)*2	68.7°		19.9°			17.5°			7.0°		
Focal Distance (mm)	18		70			80			200		
CN-E70-200mm T4.4 L IS KAS S											
CN-E18-80mm T4.4 L IS KAS S											

\*1: When the screen size is 24.0 × 13.5 mm.

\*2: When the screen size is 24.6 × 13.8 mm.

## ■ Luminous Index

The focus index on the front lens barrels is printed with luminescent paint to improve visibility at night and in dark studio conditions.



## Dust/Splash Resistant Seals and Casing\*

Our EF, RF and Sumire Prime lenses use dust and splash resistant rubber gaskets at the casing joints.

\* Lenses are not designed to be submersible in water or exposed to heavy rain.



# Sumire Prime

Canon has introduced a line of cinema prime lenses – appropriately named “SUMIRE Prime”. Pronounced “Soo-mee-ray” in Japanese. It is associated with a floral gentleness and beauty. In addition to bright T-stops and Canon’s renowned warm imagery, a unique optical design introduces a nuanced look as the lens aperture approaches its maximum setting – subtly modifying the textural renderings of the human facial close-up. It also smooths the transition to the fall-off portions of the scene resulting in a pleasing bokeh. This combination adds emotional expressiveness to a memorable scene.



Gentle and Beautiful Skin Tone

Smooth Bokeh

## PL MOUNT

CN-E14mm T3.1 FP X  
 CN-E20mm T1.5 FP X  
 CN-E24mm T1.5 FP X  
 CN-E35mm T1.5 FP X  
 CN-E50mm T1.3 FP X  
 CN-E85mm T1.3 FP X  
 CN-E135mm T2.2 FP X



## SUMIRE PRIME Lens Series: Highlights

### Covers Full-frame, Super 35mm and APS-C Sensors

The lenses are also compatible with the large imaging area of cameras equipped with a full-size 35mm-equivalent CMOS sensor.

### Phosphorescent Indicators

To improve visibility in nighttime and dark area shooting, indicator markings with phosphorescent paint have been adopted for the front barrel (for right-side viewing).

### Artistically Pleasing Image Rendering And Warm Colors

The original lens composition with large diameter aspheric lens and anomalous dispersion glass offers more solid and artistically pleasing image rendering. This brings out the impressive image quality of 4K cinema images in all their glory. And the warm color tones have been made consistent throughout the series to artistically pleasing capture people’s facial expressions and enable better depiction of the subject’s texture.

### Minimized Focus Breathing

The lens controls focus breathing, which realizes stability in images even when bokeh effects occur due to refocusing.



### Soft, Natural Bokeh Effects

The bright T-number of the PRIME lens and multi-blade iris diaphragm produce natural blur effects closer to a circle, from maximum to minimum aperture. This enables more three-dimensional bokeh even with super wide angle lenses that have deeper depth of field, broadening the range of visual expression.

### Unified Front Lens Diameter, Gear Position

Compact Zoom and Prime lenses have the same front lens diameter and consistent gear positions, so lenses within each series can be switched without adjusting the rig setup.

### Sumire Prime Lens Series

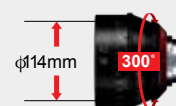

### 11-Blade Iris

With the increased number of iris blades, users can get natural bokeh that appears more circular, from maximum to minimum aperture. The use of an odd number of blades diffuses light rays in high-brightness subjects and renders images more artistically pleasing.

### PL Mount

PL mounts, which are in high demand in the cinema market, have been adopted to support a variety of cameras used in this market.

# Flex Your Creativity

## Introducing the 8K Flex Zoom Series

CINEMA EOS

The Flex Zoom series of lenses from Canon has been designed for outstanding optical performance rendering beautiful and natural images. All Flex Zoom lenses are parfocal, and offer a constant T stop across the entire focal range. Available in EF and PL mount options in Super 35mm and Full Frame sensor formats, these lenses are swappable among all four options, putting the “flex” in Flex Zoom. Advanced Lens Metadata Support includes Cooke/i Technology™ protocol on PL mount models.

### FEATURES:

#### 8K Optical Performance with Canon Cinema EOS Color Science

The lenses produce superb color rendition and detail, with sharp images from the center to the outer edges, rated for 8K HDR capture. An 11-blade aperture creates soft, beautiful bokeh and stunning depth-of-field falloff, while an internal focusing system delivers minimized focus breathing and excellent parfocal performance. The lenses render the beautiful and warm color tones synonymous with Canon’s cinema lens family.

- Canon’s advanced optical technology and lens coatings have combined to achieve 8K optical performance through the zoom range. Various types of aberrations have been corrected to achieve beautiful imagery from the center of the image out to all edges.

- All of Canon’s cinema lenses have been designed with a consistent warm color balance that expresses skin tones beautifully, making them ideal for capturing subject textures. Color reproduction is also consistent when lenses are interchanged, which can help reduce post-production work.
- HDR video offers an expanded tonal range that represents the visual expression close to its natural image. Our 8K-compatible chromatic aberration correction reduces color bleeding, and the light-shielding design and optimized coatings reduce ghosting and flaring.
- The inner focus system reduces focus breathing, giving greater stability to framing a shot.
- The 11-blade iris gives the lenses a natural bokeh effect that is almost circular from maximum to the minimum aperture. The odd number of blades diffuse the glow of high luminance subjects for softer imaging.

#### Swappable Relay Kits

A Canon first, the Flex Zoom lenses can be swapped between Super 35mm and Full Frame imaging formats, using a relay kit (sold separately). This provides even more versatility for your productions!



## FLEX ZOOM Lens Series: Highlights

#### 8K Optical Performance with Canon Cinema EOS Color Science

The lenses produce superb color rendition and detail, with sharp images from the center to the outer edges, rated for 8K HDR capture.

#### Constant T-stop Throughout the Zoom Range

Offering a constant maximum T-stop value across the zoom range. Large aperture lenses allow for more light to reach the sensor, and the light transmission remains constant throughout the zoom range.

#### Advanced Lens Metadata Support

Compliant with a wide range of communication standards thanks to the versatile lens-to-camera communication function including Cooke/i Technology™ and Zeiss eXtended Data™ [PL mount/ Lemo 4-PIN] and EF communication [EF mount].

#### Swappable Relay Kits

Lenses can be switched between Super 35mm and Full Frame imaging formats with a relay kit (sold separately).

#### Outstanding Optics

Built for longevity, the premium design and outstanding optics and components, offer quick and precise operation, with durability ideal for professional video productions.

#### Cinema Style Operability

Weighing under 8 pounds and measuring under 10 inches long, the lenses also feature focus, zoom, and iris rings with industry standard gears and 0.8mm pitch to suit many third party follow focus accessories.



#### Attractive Bokeh

The 11-blade iris gives the lenses a natural bokeh effect that is almost circular from maximum to the minimum aperture. The odd number of blades diffuse the glow of high luminance subjects for softer imaging.

#### Available in EF Mount or Cooke/i Technology™ PL Mount Options

#### Swappable Mount Kits

Lenses can be switched between EF and PL with a mount kit (sold separately).

# Outstanding Optical Performance

## Introducing the 8K RF Prime Lens Series

The RF Cinema Prime series of lenses from Canon has been designed for outstanding optical performance rendering sharp and beautiful images. This series includes seven lenses, ideal for shooting 8K as well as HDR, and represent Canon's first cinema lenses to have a native RF mount. This lens series ushers in the RF lens communication to fully manual cinema glass, ideal for shooting with RF-mount cameras including third-party cameras that utilize a native RF mount.

The RF Cinema Prime series covers seven focal lengths, with lenses at 14, 20, 24, 35, 50, 85, and 135 millimeters and share a common gear positioning and diameter across all seven lenses.

### FEATURES:

#### RF Mount Cinema Lenses for Professional Productions

Step into cinematic filmmaking with a range of RF Cinema Prime lenses that offer ultra-fast, real-time metadata capture plus all-new features such as in-camera electronic distortion correction.

#### 8K Optical Performance with Canon Cinema EOS Color Science

Rated for 8K HDR image capture the lenses produce superb color rendition and detail, with sharp resolution from the center to the outer edges. An 11-blade iris creates soft, beautiful light rays and stunning depth-of-field falloff. The lenses render the beautiful and warm color tones synonymous with Canon's cinema lens family.

Canon's advanced optical technology and lens coatings have



combined to achieve 8K optical performance. Various types of aberrations have been corrected to achieve beautiful imagery from the center of the image out to all edges.

All of Canon's cinema lenses have been designed with a consistent warm color balance that expresses skin tones beautifully, making them ideal for capturing subject textures. Color reproduction is also consistent when lenses are interchanged, which can help minimize corrections in post.

HDR video offers an expanded tonal range that represents the visual expression close to its natural image. Our 8K-compatible chromatic aberration correction reduces color bleeding, and the light-shielding design and optimized coatings reduce ghosting and flaring.

The inner focus system reduces focus breathing, giving greater stability to framing a shot.

The 11-blade iris gives the lenses a natural bokeh effect that is almost circular from maximum to the minimum aperture. The odd number of blades diffuse the glow of high luminance subjects for softer imaging.

## RF PRIME Lens Series: Highlights

### 8K Optical Performance with HDR Support

### Peripheral Illumination, Chromatic Aberration And Distortion Correction\*

### Dual Pixel Focus Guide<sup>(\*)</sup>

### Full Frame Sensor Coverage

### Refined Ergonomics, Redefined Handling

Confidently secure your lenses without the need for an adapter when utilizing RF mount Canon Cinema EOS cameras or compatible third party cameras. With a newly developed fixed ring design, RF Cinema Prime lenses make handheld operation more comfortable, intuitive, and efficient.

### Distortion Correction

High-speed data transfer makes it possible to instantly transfer lens metadata to the camera, enabling distortion correction according to lens characteristics when shooting video with compatible cameras<sup>(\*)</sup>.

### Full Frame Creativity

The RF Cinema Prime lenses are designed for Full-Frame, Large-Format cameras, enabling impressive images using bokeh with a shallow depth of field.



### Mechanical Precision in a Compact Design

With a smooth and consistent 300-degree focus rotation, consistent gear positions, front diameter and a compact, robust and drip-proof design, offering a no-compromise lightweight solution for professional productions.

### 300-degree Focus Rotation with Phosphorescent Markings

#### RF Prime Lens Series



### 11-Blade Iris

With the increased number of iris blades, users can get natural bokeh that appears more circular, from maximum to minimum aperture. The use of an odd number of blades diffuses light rays in high-brightness subjects and renders images more artistically pleasing.

### Native RF Mount & Communication On Fully Manual Lens

\*1: With Compatible Cameras

\*2: \* Supported cameras (as of September 2023): EOS C70, EOS R5 C (Movie Mode only)

## ZOOM / COMPACT ZOOM Lens Series: Highlights

### Easy-to-Read Controls

Focus, Zoom, and Iris markings are provided on angled surfaces. These markings are easy to read from behind the camera.

### Support Industry-Standard Cameras

Covers Super 35mm and APS-C sensors.

### Light, Compact

Small and light to meet a variety of shooting needs.

### Marked on Both Sides

Lenses are marked on both sides. This makes markings visible from either side of the lens.

### Switchable Unit for Focus Marking

The outer piece on marked focus rings can be switched from non-metric to metric labeling.

### Comfortable Usability

Control rings maintain the right amount of resistance while offering exceptional usability with consistent operating torque.

### Inner Focus

Helps minimize focus-induced changes in the angle of view.

### Unified Front Lens Diameter, Gear Position

Uniform gear positions within the same categories eliminate the need for accessory gear position adjustment when switching lenses.

#### Zoom Lens Series



#### Compact Zoom Lens Series



### Flange-Back Adjustment Mechanism

A covered flange-back adjustment mechanism is included, with broadcast applications in mind.



### Attractive Bokeh

11-Blade Circular Aperture enables soft, beautiful background bokeh.

## EF PRIME Lens Series: Highlights

### Covers Full-frame, Super 35mm and APS-C Sensors

The lenses are also compatible with the large imaging area of cameras equipped with a full-size 35mm-equivalent CMOS sensor.

### Light, Compact

Small and light among many conventional cinema lenses, to meet a variety of shooting needs.

### Standard Accessories Supported

Supports industry-standard accessories such as power-drive devices and matte boxes.

### Accepts 105mm filters (except for 14mm)

PL or other individual filters 105mm in diameter can be attached to the end of the lens, enabling filter work in handheld shooting or other scenarios without using a matte box.

### Phosphorescent Indicators

To improve visibility in nighttime and dark area shooting, indicator markings with phosphorescent paint have been adopted for the front barrel (for right-side viewing).

### Fast Aperture

Enables shooting with the shallow DOF and broad bokeh that large sensors offer.

### Unified Front Lens Diameter, Gear Position

Compact Zoom and Prime lenses have the same front lens diameter and consistent gear positions, so lenses within each series can be switched without adjusting the rig setup.

#### Prime Lens Series

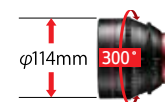

### 11-Blade Iris

With the increased number of iris blades, users can get natural bokeh that appears more circular, from maximum to minimum aperture. The use of an odd number of blades diffuses light rays in high-brightness subjects and renders images more artistically pleasing.

### EF Mount

Communication functions with Cinema EOS Cameras. It works seamlessly with our Cinema EOS cameras, allowing you to take full advantage of the camera's features and functionality.

### Switchable Unit for Focus Marking

The outer piece on marked focus rings can be switched from non-metric to metric labeling.



### Consistent Torque

Control Rings maintain the right amount of resistance while offering outstanding usability with consistent operating torque.

## CINE-SERVO Lens Series: Highlights

CINE-SERVO 50-1000mm  
CINE-SERVO 17-120mm

CINE-SERVO 25-250mm  
CINE-SERVO 15-120mm

**NEW** CINE-SERVO 11-55mm  
**NEW** CINE-SERVO 40-1200mm

**Robust and Durable Housing Structure**

**Support Industry-Standard Cameras**  
Covers Super 35mm and APS-C sensors.

**High Durability and Ruggedness**

**Multiple Communication Capability with Compatible Cameras**

**Ergonomic Design**

Ergonomically designed drive unit for ease of operation.

**4K Optical Performance with Canon Cinema EOS Color Science**

**Support High Quality 4K/HDR Shooting**

High optical performance with support for Super35mm large format cameras.

**High Durability and Ruggedness**

The CINE-SERVO Lenses offer the ruggedness and reliability required to fulfill the exacting needs of broadcast applications, with a robust chassis construction that is weather and shock-proof.

**Removable Servo Drive Unit**

Removable servo drive unit with various user setting capabilities.

**Accessory Connectors**

Three 20-pin connectors for externally operated accessories and a 16-bit metadata output for virtual studio systems.



**11-Blade Iris Provides Natural Bokeh**

**Designed for Cinema and Broadcast Applications**

**Compact and Lightweight**

Compact and lightweight lens available in an EF mount and PL mount that can be converted at an authorized Canon service facility.

RF mount is also available for CINE-SERVO 17-120mm, CINE-SERVO 11-55mm, and CINE-SERVO 40-1200mm.



**Built-In 1.5x Optical Extender\*1**  
Cover the image size of Full Frame.

**Supports 8K/4K Cameras**

Canon's optical technologies use large-diameter aspherical lenses and anomalous dispersion glass delivering optical performance that supports 8K cameras throughout the zoom range.

**Next-Generation e-Xs V Servo Drive Unit\*2**

Faster focus and iris speed, Focus Breathing Compensation, and a USB-C connector. The e-Xs V Drive Unit can also be detached to be used in manual-style cinema configurations.

\*1: Not available on CINE-SERVO 17-120mm  
\*2: Only available on CN7x17 KAS T/R1 and CN7x17 KAS T/PI

## COMPACT-SERVO Lens Series: Highlights

**Refined Iris Mechanism**

- Seamless Manual Control Capability
- 9-Blade Iris
- Iris Closing

**Compatible with EF-mount Cameras**

**Practical Layout of Switches**

**High Level 4K Optical Performance**

**Covers Super 35mm and APS-C Sensors**



**Image Stabilization**

**Minimized Focus Breathing**

**Supports a Wide Range of Accessories**

**Compact and Lightweight for Increased Mobility**

**Dual Pixel CMOS Auto-Focus (DAF)**

**Enhanced Servo Drive Unit**

- Servo Control Capability for all Zoom, Focus, and Iris
- Compatible with broadcast style servo lens controllers
- Optional ZSG-C10 Grip

**COMPACT-SERVO 4K**

## Drive Unit

### Removable Drive Unit

Canon CINE-SERVO lenses include a drive unit that provides the same user experience as found in our broadcast zoom lenses. Removing the drive unit allows for full manual operation of the lenses.



### ■ No Initialization

Initialization of the drive unit is not required at power-on. Initialization is required at power-on for conventional drive units. Immediate startup helps contribute to more efficient shooting.

### Compatible With Standard Broadcast Demands

#### Demand Supported

Compatible with Canon's standard broadcast industry demands such as ZSD-300D and FPD-400D. Canon's 8-pin demand\* can be connected via a conversion cable.

### Enables High-Precision, Natural Composition

#### Virtual Studio System

Three, 20-pin terminals allow a virtual connection even when zoom and focus demands are connected. The center terminal connects to a virtual studio system by relaying zoom, focus and iris positional data. Zoom and focus data are encoded by a high-precision, 16-bit encoder.



\* Iris operation is also possible by connecting FDJ-P01 via conversion cable. It will be selected as either virtual output or iris operation.

### Peripheral Illumination Correction

#### EF Mount Communication Protocol Support<sup>\*1</sup>

Information communication is possible via CINEMA EOS SYSTEM cameras and mounts. It is possible to record lens information at the time of shooting and peripheral illumination correction<sup>\*2</sup>.

\*1: ZOOM Lenses are excluded. Only EF mounted lenses are supported.

\*2: Some lenses require a camera firmware update. Some lenses are scheduled to be handled by firmware update.

### Supports Broadcast Industry Standards

#### 12-Pin Serial Communication\*

Supports 12-pin serial communication which is a broadcasting communication standard.

\* Applicable lens: CINE-SERVO Lens series.

It is necessary for the camera side to support 12 pin serial communication.

### Supports Communication Standards of Film Production Industry

#### /i Technology Compatible\*

Canon's PL-mount CINE-SERVO lenses are compatible with Cooke's "/i Technology" communication standard which has been widely adopted throughout the video production industry. Focus/zoom/aperture position data can be sent to the corresponding camera, recorded and displayed.

\* Applicable lens: PL mount lens of CINE-SERVO Lens series only.

The camera side must support /i Technology.

Communication is possible when drive unit is installed.

### Supports Virtual Production

#### RF Mount Communication Protocol Support<sup>\*1</sup>

In addition to the functions of EF Mount Communication, RF mount communication includes data for distortion and shading correction which helps improve workflow for virtual production.

#### Zeiss eXtended data Compatible<sup>\*2</sup>

An extension of the Cooke /i Technology communications standard. Also supports distortion and shading correction for virtual production.

\*1: Applicable lenses: CN7x17 KAS T/R1 when combined with supported cameras

\*2: Applicable lenses: CN7x17 KAS T/P1, CN8x15 KAS S/P1

## ZOOM Lens Series

	CN-E30-300mm T2.95-3.7 L S CN-E30-300mm T2.95-3.7 L SP		
	Model Name	CN-E30-300mm T2.95-3.7 L S	
Mount	EF Mount		PL Mount
Zoom Ratio	10x		
Focal Length	30 ~ 300mm		
Max. Relative Aperture (T-Number)	T2.95 30 ~ 240mm / T3.7 300mm		
Iris Blades	11		
Angle of View	43.6°×25.4° 30mm 4.6°×2.6° 300mm <sup>*1</sup>		
	44.6°×25.9° 30mm 4.7°×2.6° 300mm <sup>*2</sup>		
M.O.D. (Minimum Object Distance)	1.5m/5'		
Object Dimensions at M.O.D.	98.8×55.6cm 30mm 9.6×5.4cm 300mm <sup>*1</sup>		
	101.3×56.8cm 30mm 9.9×5.6cm 300mm <sup>*2</sup>		
Front Diameter	136.0mm		
Image Circle	Φ29.6mm		
Filter Diameter	—		
Approx. Size (WxHxL)	5.67x6.58x13.78 in. (144.0x167.1x350.1mm)	5.67x6.58x13.47 in. (144.0x167.1x342.1mm)	
Approx. Weight	12.79 lbs (5.8kg)		

※ Lenses compatible with Super 35mm Sensor cameras.

\*1: Aspect ratio 1.78: 1, Screen size 24.0 x 13.5 mm. \*2: Aspect ratio 1.78:1, Screen size 24.6 x 13.8 mm

## COMPACT ZOOM Lens Series

	CN-E30-105mm T2.8 L S CN-E30-105mm T2.8 L SP		
	Model Name	CN-E30-105mm T2.8 L S	
Mount	EF Mount		PL Mount
Zoom Ratio	3.5x		
Focal Length	30 ~ 105mm		
Max. Relative Aperture (T-Number)	T2.8 30 ~ 105mm		
Iris Blades	11		
Angle of View	43.6°×25.4° 30mm 13.0°×7.4° 105mm <sup>*1</sup>		
	47.2°×25.9° 30mm 14.2°×7.5° 105mm <sup>*2</sup>		
M.O.D. (Minimum Object Distance)	0.60m/2'		
Object Dimensions at M.O.D.	32.3×18.2cm 30mm 9.3×5.2cm 105mm <sup>*1</sup>		
	35.3×18.6cm 30mm 10.2×5.4cm 105mm <sup>*2</sup>		
Front Diameter	114mm		
Image Circle	Φ31.4mm		
Filter Diameter	105mm		
Approx. Size (WxHxL)	4.49x4.92x8.58 in. (114.0x125.0x218.0mm)	4.49x4.92x8.26 in. (114.0x125.0x210.0mm)	
Approx. Weight	4.85 lbs (2.2kg)		

※ Lenses compatible with Super 35mm Sensor cameras.

\*1: Aspect ratio 1.78:1, Screen size 24.0 x 13.5 mm. \*2: Aspect ratio 1.9:1, Screen size 26.2 x 13.8.

## FLEX ZOOM Lens Series

	CN-E14-35mm T1.7 L S / SP		CN-E31.5-95mm T1.7 L S / SP		CN-E20-50mm T2.4 L F / FP		CN-E45-135mm T2.4 L F / FP	
								
	S35		S35		Full Frame		Full Frame	
Model Name	CN-E14-35mm T1.7 L S / SP		CN-E31.5-95mm T1.7 L S / SP		CN-E20-50mm T2.4 L F / FP		CN-E45-135mm T2.4 L F / FP	
Mount	EF	PL	EF	PL	EF	PL	EF	PL
Zoom Ratio	2.5x		3x		2.5x		3	
Focal Length	14-35mm		31.5-95mm		20-50mm		45-135mm	
Maximum Diameter Ratio (T-Number)	T1.7		T1.7		T2.4		T2.4	
Number of Iris Blades	11		11		11		11	
Focus Rotation Angle	300 Degrees		300 Degrees		300 Degrees		300 Degrees	
Minimum Shooting Distance	2' (0.6m)		3/4" (1.0m)		2' (0.6m)		3/4" (1.0m)	
Front Diameter	114 mm		114 mm		114 mm		114 mm	
Image Circle	Φ31.4mm		Φ31.4mm		Φ6.4mm		Φ6.4mm	
Length (Approx.)	9.5" (241.3mm)	9.2" (233.3mm)	9.7" (246.4mm)	9.4" (238.4mm)	9.5" (241.3mm)	9.2" (233.3mm)	9.7" (246.4mm)	9.4" (238.4mm)
Weight (Approx.)	7.7 lbs. (3.4 kg)		7.8 lbs. (3.5 kg)		7.3 lbs. (3.3 kg)		7.5 lbs. (3.4 kg)	
EOS-Lens Communication	Supported		Supported		Supported		Supported	
Cooke/i Technology Communication	Supported (PL mount only)		Supported (PL mount only)		Supported (PL mount only)		Supported (PL mount only)	

## RF PRIME Lens Series

	CN-R14mm T3.1 L F	CN-R20mm T1.5 L F	CN-R24mm T1.5 L F	CN-R35mm T1.5 L F	CN-R50mm T1.3 L F	CN-R85mm T1.3 L F	CN-R135mm T2.2 L F	
								
Model Name	CN-R14mm T3.1 L F	CN-R20mm T1.5 L F	CN-R24mm T1.5 L F	CN-R35mm T1.5 L F	CN-R50mm T1.3 L F	CN-R85mm T1.3 L F	CN-R135mm T2.2 L F	
Mount	RF Mount	RF Mount	RF Mount	RF Mount	RF Mount	RF Mount	RF Mount	
Zoom Ratio	—	—	—	—	—	—	—	
Focal Length	14mm	20mm	24mm	35mm	50mm	85mm	135mm	
Max. Relative Aperture (T-Number)	T3.1	T1.5	T1.5	T1.5	T1.3	T1.3	T2.2	
Iris Blades	11	11	11	11	11	11	11	
Angle of View	1.5:1 36.0x24.0mm	104.3°x81.2° *1	84.0°x61.9° *1	73.7°x53.1° *1	54.4°x37.8° *1	39.6°x27.0° *1	23.9°x16.1° *1	15.2°x10.2° *1
	1.9:1 26.2x13.8mm	82.6°x52.5° *2	63.2°x38.1° *2	54.3°x32.1° *2	38.7°x22.3° *2	27.6°x15.7° *2	16.5°x9.3° *2	10.4°x5.9° *2
M.O.D. (Minimum Object Distance)	0.20m / 8"	0.30m / 12"	0.30m / 12"	0.30m / 12"	0.45m / 18"	0.95m / 3'2"	1.0m / 3'4"	
Object Dimensions at M.O.D	1.5:1 36.0x24.0mm	24.8x16.5cm *1	33.8x22.5cm *1	28.8x19.2cm *1	20.1x13.4cm *1	24.9x16.6cm *1	34.3x22.9cm *1	21.1x14.1cm *1
	1.9:1 26.2x13.8mm	16.9x9.5cm *2	23.1x13.0cm *2	19.7x11.0cm *2	13.7x7.7cm *2	17.0x9.5cm *2	23.4x13.1cm *2	14.4x8.1cm *2
Front Diameter	114mm	114mm	114mm	114mm	114mm	114mm	114mm	
Image Circle	Φ43.3mm	Φ43.3mm	Φ43.3mm	Φ43.3mm	Φ43.3mm	Φ43.3mm	Φ43.3mm	
Filter Diameter	—	105mm	105mm	105mm	105mm	105mm	105mm	
Approx. Size (WxHxL)	4.66x4.66x4.64 in. (118.4x118.4x118.0mm)	4.66x4.66x4.94 in. (118.4x118.4x125.5mm)	4.66x4.66x4.94 in. (118.4x118.4x125.5mm)	4.66x4.66x4.94 in. (118.4x118.4x125.5mm)	4.66x4.66x4.94 in. (118.4x118.4x125.5mm)	4.66x4.66x4.94 in. (118.4x118.4x125.5mm)	4.66x4.66x5.49 in. (118.4x118.4x139.6mm)	
Approx. Weight	2.87 lbs (1.3kg)	3.08 lbs (1.4kg)	2.87 lbs (1.3kg)	2.87 lbs (1.3kg)	2.65 lbs (1.2kg)	3.3 lbs (1.5kg)	3.3 lbs (1.5kg)	

※ Lenses compatible with Full-frame and Super 35mm Sensor cameras.

\*1: Aspect ratio 1.5:1, Screen size 36.0 x 24.0 mm. \*2: Aspect ratio 1.78:1, Screen size 24.6 x 13.8 mm.

## SUMIRE PRIME Lens Series

Sumire Prime

		CN-E14mm T3.1 FP X	CN-E20mm T1.5 FP X	CN-E24mm T1.5 FP X	CN-E35mm T1.5 FP X	CN-E50mm T1.3 FP X	CN-E85mm T1.3 FP X	CN-E135mm T2.2 FP X
								
Model Name		CN-E14mm T3.1 FP X	CN-E20mm T1.5 FP X	CN-E24mm T1.5 FP X	CN-E35mm T1.5 FP X	CN-E50mm T1.3 FP X	CN-E85mm T1.3 FP X	CN-E135mm T2.2 FP X
Mount		PL Mount	PL Mount	PL Mount	PL Mount	PL Mount	PL Mount	PL Mount
Zoom Ratio		—	—	—	—	—	—	—
Focal Length		14mm	20mm	24mm	35mm	50mm	85mm	135mm
Max. Relative Aperture (T-Number)		T3.1	T1.5	T1.5	T1.5	T1.3	T1.3	T2.2
Iris Blades		11	11	11	11	11	11	11
Angle of View	1.5:1 36.0x24.0mm	104.3°×81.2° *1	84.0°×61.9° *1	73.7°×53.1° *1	54.4°×37.8° *1	39.6°×27.0° *1	23.9°×16.1° *1	15.2°×10.2° *1
	1.9:1 26.2x13.8mm	82.6°×52.5° *2	63.2°×38.1° *2	54.3°×32.1° *2	38.7°×22.3° *2	27.6°×15.7° *2	16.5°×9.3° *2	10.4°×5.9° *2
M.O.D. (Minimum Object Distance)		0.20m / 8"	0.30m / 12"	0.30m / 12"	0.30m / 12"	0.45m / 18"	0.95m / 3'2"	1.0m / 3'3"
Object Dimensions at M.O.D	1.5:1 36.0x24.0mm	25.2×16.8cm *1	33.8×22.5cm *1	28.8×19.2cm *1	20.2×13.5cm *1	25.0×16.7cm *1	34.4×22.9cm *1	21.1×14.1cm *1
	1.9:1 26.2x13.8mm	17.2×9.7cm *2	23.1×13.0cm *2	19.7×11.0cm *2	13.8×7.7cm *2	17.1×9.6cm *2	23.5×13.2cm *2	14.4×8.1cm *2
Front Diameter		114mm	114mm	114mm	114mm	114mm	114mm	114mm
Image Circle		Φ43.3mm	Φ43.3mm	Φ43.3mm	Φ43.3mm	Φ43.3mm	Φ43.3mm	Φ43.3mm
Filter Diameter		—	105mm	105mm	105mm	105mm	105mm	105mm
Approx. Size (WxHxL)		4.66x4.66x3.39 in. (118.4×118.4×86.0mm)	4.66x4.66x3.68 in. (118.4×118.4×93.5mm)	4.66x4.66x3.68 in. (118.4×118.4×93.5mm)	4.66x4.66x3.68 in. (118.4×118.4×93.5mm)	4.66x4.66x3.68 in. (118.4×118.4×93.5mm)	4.66x4.66x3.68 in. (118.4×118.4×93.5mm)	4.66x4.66x4.24 in. (118.4×118.4×107.6mm)
Approx. Weight		2.65 lbs (1.2kg)	2.65 lbs (1.2kg)	2.65 lbs (1.2kg)	2.43 lbs (1.1kg)	2.43 lbs (1.1kg)	2.87 lbs (1.3kg)	3.09 lbs (1.4kg)

※ Lenses compatible with Full-frame and Super 35mm Sensor cameras.

\*1: Aspect ratio 1.5:1, Screen size 36.0 × 24.0 mm. \*2: Aspect ratio 1.78:1, Screen size 24.6 × 13.8 mm.

## EF PRIME Lens Series

		CN-E14mm T3.1 L F	CN-E20mm T1.5 L F	CN-E24mm T1.5 L F	CN-E35mm T1.5 L F	CN-E50mm T1.3 L F	CN-E85mm T1.3 L F	CN-E135mm T2.2 L F
								
Model Name		CN-E14mm T3.1 L F	CN-E20mm T1.5 L F	CN-E24mm T1.5 L F	CN-E35mm T1.5 L F	CN-E50mm T1.3 L F	CN-E85mm T1.3 L F	CN-E135mm T2.2 L F
Mount		EF Mount	EF Mount	EF Mount	EF Mount	EF Mount	EF Mount	EF Mount
Zoom Ratio		—	—	—	—	—	—	—
Focal Length		14mm	20mm	24mm	35mm	50mm	85mm	135mm
Max. Relative Aperture (T-Number)		T3.1	T1.5	T1.5	T1.5	T1.3	T1.3	T2.2
Iris Blades		11	11	11	11	11	11	11
Angle of View	1.5:1 36.0x24.0mm	104.3°×81.2° *1	84.0°×61.9° *1	73.7°×53.1° *1	54.4°×37.8° *1	39.6°×27.0° *1	23.9°×16.1° *1	15.2°×10.2° *1
	1.9:1 26.2x13.8mm	82.6°×52.5° *2	63.2°×38.1° *2	54.3°×32.1° *2	38.7°×22.3° *2	27.6°×15.7° *2	16.5°×9.3° *2	10.4°×5.9° *2
M.O.D. (Minimum Object Distance)		0.20m / 8"	0.30m / 12"	0.30m / 12"	0.30m / 12"	0.45m / 18"	0.95m / 3'2"	1.0m / 3'4"
Object Dimensions at M.O.D	1.5:1 36.0x24.0mm	24.8×16.5cm *1	33.8×22.5cm *1	28.8×19.2cm *1	20.1×13.4cm *1	24.9×16.6cm *1	34.3×22.9cm *1	21.1×14.1cm *1
	1.9:1 26.2x13.8mm	16.9×9.5cm *2	23.1×13.0cm *2	19.7×11.0cm *2	13.7×7.7cm *2	17.0×9.5cm *2	23.4×13.1cm *2	14.4×8.1cm *2
Front Diameter		114mm	114mm	114mm	114mm	114mm	114mm	114mm
Image Circle		Φ43.3mm	Φ43.3mm	Φ43.3mm	Φ43.3mm	Φ43.3mm	Φ43.3mm	Φ43.3mm
Filter Diameter		—	105mm	105mm	105mm	105mm	105mm	105mm
Approx. Size (WxHxL)		4.66x4.66x3.70 in. (118.4×118.4×94.0mm)	4.66x4.66x4.0 in. (118.4×118.4×101.5mm)	4.66x4.66x4.0 in. (118.4×118.4×101.5mm)	4.66x4.66x4.0 in. (118.4×118.4×101.5mm)	4.66x4.66x4.0 in. (118.4×118.4×101.5mm)	4.66x4.66x4.0 in. (118.4×118.4×101.5mm)	4.66x4.66x4.55 in. (118.4×118.4×115.6mm)
Approx. Weight		2.65 lbs (1.2kg)	2.65 lbs (1.2kg)	2.65 lbs (1.2kg)	2.43 lbs (1.1kg)	2.43 lbs (1.1kg)	2.87 lbs (1.3kg)	3.09 lbs (1.4kg)

※ Lenses compatible with Full-frame and Super 35mm Sensor cameras.

\*1: Aspect ratio 1.5:1, Screen size 36.0 × 24.0 mm. \*2: Aspect ratio 1.78:1, Screen size 24.6 × 13.8 mm.

# CINE-SERVO Lens Series

	<b>CN8X15 IAS S/E1</b> <b>CN8X15 IAS S/P1</b>		<b>CN7x17 KAS S/E1</b> <b>CN7x17 KAS S/P1</b>		<b>CN5x11 IAS T/R1</b> <b>CN5x11 IAS T/P1</b>	
						
<b>Model Name</b>	CN8X15 IAS S/E1	CN8X15 IAS S/P1	CN7x17 KAS S/E1	CN7x17 KAS S/P1	CN5x11 IAS T/R1	CN5x11 IAS T/P1
<b>Mount</b>	EF Mount	PL Mount	EF Mount	PL Mount	RF Mount	PL Mount
<b>Zoom Ratio</b>	5x		7x		5x	
<b>Focal Length</b>	15 – 120mm		17 – 120mm		11 – 55mm	
<b>Max. Relative Aperture (T-Number)</b>	T2.95 17 – 91mm / T3.9 120mm		T2.95 17 – 91mm / T3.9 120mm		T2.95 at 11 – 41mm / T3.95 at 55mm T4.4 at 16.5 – 61.5mm / T5.9 at 82.5mm <sup>*3</sup>	
<b>Iris Blades</b>	11		11		11	
<b>Angle of View</b>	78.7°x49.4°at 15mm 11.7°x6.6°at 120mm <sup>*1</sup>		71.8°x44.2° 17mm 11.7°x6.6° 120mm <sup>*1</sup>		96.4°x64.2°at 11mm 25.2°x 14.3°at 55mm <sup>*1</sup>	
	82.3°x49.4°at 15mm 12.5°x6.6°at 120mm <sup>*2,3</sup>		75.2°x44.2° 17mm 12.5°x6.6° 120mm <sup>*2</sup>		100.0°x64.2°at 11mm / 26.8°x14.3°at 55mm <sup>*2</sup> 76.9°x45.4°at 16.5mm / 18.0°x9.6°at 82.5mm <sup>*2,3</sup>	
<b>M.O.D. (Minimum Object Distance)</b>	0.85 m / 2.8'		0.85 m / 2.8'		0.6 m / 2.0'	
<b>Object Dimensions at M.O.D</b>	93.0x52.1cm at 15mm 11.3x6.3cm at 120mm <sup>*1</sup>		86.3x48.4cm 17mm 12.0x6.7cm 120mm <sup>*1</sup>		69.7 x 39.1cm at 11mm 13.3 x 7.5cm at 55mm <sup>*1</sup>	
	99.0x52.1cm at 15mm 12.0x6.3cm at 120mm <sup>*2</sup>		92.1x48.5cm 17mm 12.7x6.7cm 120mm <sup>*2</sup>		74.2 x 39.1cm at 11mm / 14.2 x 7.5cm at 55mm <sup>*2</sup> 49.5 x 26.1 cm at 16.5mm / 9.5 x 5.0 cm at 82.5mm <sup>*2,3</sup>	
<b>Front Diameter</b>	Φ29.6 (with Ext.: Φ43.3)		Φ31.4		Φ29.6 (with Ext.: Φ43.3)	
<b>Image Circle</b>	114mm		114mm		114mm	
<b>Filter Diameter</b>	Hood: UV/127mm-H, CL/127mm-M-H Lens: CL/112mm		Hood: UV/127mm-H, CL/127mm-H Lens: CL/112mm		Hood: 127mm Lens: 112mm	
<b>Approx. Size (WxHxL)</b>	7.35x5.19x11.61 in. (186.7x131.7x294.9mm)	7.35x5.19x11.30 in. (186.7x131.7x286.9mm)	6.86x4.92x10.35 in. (174.2x125.0x262.9mm)	6.86x4.92x10.04 in. (174.2x125.0x254.9mm)	7.35x5.11x11.85 in. (186.6 x 129.9 x 301.0mm)	7.35x5.11x10.59 in. (186.6 x 129.9 x 269.0mm)
<b>Approx. Weight</b>	7.5 lbs (3.4kg)		6.39 lbs (2.9kg)		6.6 lbs (3.01kg)	6.4 lbs (2.92kg)

	<b>CN7x17 KAS T/R1</b> <b>CN7x17 KAS T/P1</b>		<b>CN10x25 IAS S/E1</b> <b>CN10x25 IAS S/P1</b>		<b>CN20x50 IAS H/E1</b> <b>CN20x50 IAS H/P1</b>		<b>CN30x40 IAS H/E1</b> <b>CN30x40 IAS H/P1</b>	
								
<b>Model Name</b>	CN7x17 KAS T/R1	CN7x17 KAS T/P1	CN10x25 IAS S/E1	CN10x25 IAS S/P1	CN20x50 IAS H/E1	CN20x50 IAS H/P1	CN30x40 IAS H/E1	CN30x40 IAS H/P1
<b>Mount</b>	RF Mount	PL Mount	EF Mount	PL Mount	EF Mount	PL Mount	RF Mount	PL Mount
<b>Zoom Ratio</b>	7x		10x		20x		30x	
<b>Focal Length</b>	17 – 120mm		25 – 250mm		50 – 1000mm		40 – 1200 mm	
<b>Max. Relative Aperture (T-Number)</b>	T2.95 17 – 91mm / T3.9 120mm		T2.95 (25-187mm)/ T3.95 (250mm)	T4.4 (37.5-281mm)/ T5.9 (375mm) <sup>*2</sup>	T5.0 (50-560mm)/ T8.9 (1000mm)	T7.5 (75-840mm)/ T13.35 (1500mm) <sup>*3</sup>	T5.0 at 40 - 560 mm / T10.8 at 1200 mm	T7.5 at 60 - 840 mm / T16.2 at 1800 mm*
<b>Iris Blades</b>	11		11		11		11	
<b>Angle of View</b>	71.8°x44.2° 17mm 11.7°x6.6° 120mm <sup>*1</sup>		52.4°x30.9° 25mm 5.6°x3.2° 250mm <sup>*1</sup>		36.3°x20.9° 37.5mm 5.5°x3.7° 375mm <sup>*1,3</sup>		27.6°x15.7° 50mm 1.4°x0.8° 1000mm <sup>*1</sup>	
	75.2°x44.2° 17mm 12.5°x6.6° 120mm <sup>*2</sup>		55.3°x30.9° 25mm 6.0°x3.2° 250mm <sup>*2</sup>		38.5°x20.9° 37.5mm 4.0°x2.1° 375mm <sup>*2,3</sup>		29.4°x15.7° 50mm 1.5°x0.8° 1000mm <sup>*2</sup>	
<b>M.O.D. (Minimum Object Distance)</b>	0.85 m / 2.8'		1.2 m / 4.0'		3.5 m / 11.5'		3.5 m / 11.5'	
<b>Object Dimensions at M.O.D</b>	86.6x48.6cm 17mm 12.0x6.7cm 120mm <sup>*1</sup>		86.5x48.5cm 25mm 8.7x4.9cm 250mm <sup>*1</sup>		57.7x32.3cm 37.5mm 5.8x3.3cm 375mm <sup>*1,3</sup>		139.3x78.1cm 50mm 7.3x4.1cm 1000mm <sup>*1</sup>	
	92.2x48.6cm 17mm 12.8x6.7cm 120mm <sup>*2</sup>		92.1x48.5cm 25mm 9.3x4.9cm 250mm <sup>*2</sup>		61.4x32.3cm 37.5mm 6.2x3.3cm 375mm <sup>*2,3</sup>		148.3x78.1cm 50mm 7.8x4.1cm 1000mm <sup>*2</sup>	
<b>Front Diameter</b>	Φ31.4		Φ29.6 (with Ext.: Φ43.3)		Φ31.4		Φ29.6 (with Ext.: Φ43.3)	
<b>Image Circle</b>	114mm		114mm		136mm		136mm	
<b>Filter Diameter</b>	Hood: UV/127mm-H, CL/127mm-H Lens: CL/112mm		Hood: UV/127mm-H, CL/127mm-H Lens: CL/112mm		Lens: CL/127mm-H, UV/127mm-H		Lens: CL/127mm-H, UV/127mm-H	
<b>Approx. Size (WxHxL)</b>	6.85x4.92x11.30 in. (174.1x125.0x286.9mm)	6.85x4.92x10.04 in. (174.1x125.0x254.9mm)	7.6x5.2x11.1 in. (186.7x131.7x282.1mm)	7.6x5.2x10.8 in. (186.7x131.7x274.1mm)	6.89x6.72x16.27 in. (175.0x170.6x413.2mm)	6.89x6.72x15.95 in. (175.0x170.6x405.2mm)	6.89x6.72x17.21 in. (174.9 x 170.6 x 437.2mm)	6.89x6.72x15.95 in. (174.9 x 170.6 x 405.2mm)
<b>Approx. Weight</b>	6.86 lbs (3.11kg)	6.7 lbs (3.04kg)	6.7 lbs (3.06kg)		14.55 lbs (6.6kg)		14.8 lbs (6.7 kg)	14.6 lbs (6.6 kg)

\*: Lenses compatible with Super 35mm Sensor cameras.

\*1: Aspect ratio 1.78:1, Screen size 24.6 x 13.8 mm.

\*2: Aspect ratio 1.9:1, Screen size 26.2 x 13.8 mm.

\*3: When using the built-in extender (1.5x).

## COMPACT-SERVO Lens Series

	CN-E18-80mm T4.4 L IS KAS S	CN-E70-200mm T4.4 L IS KAS S
		
Model Name	CN-E18-80mm T4.4 L IS KAS S	CN-E70-200mm T4.4 L IS KAS S
Mount	EF Mount	EF Mount
Zoom Ratio	4.4x	2.8x
Focal Length	18 ~ 80mm	70 ~ 200mm
Max. Relative Aperture (T-Number)	T4.4 18 ~ 80mm	T4.4 70 ~ 200mm
Iris Blades	9	9
Angle of View	68.7°×41.9° 18mm 17.5°×9.9° 80mm <sup>*1</sup>	19.9°×11.3° 70mm 7.0°×4.0° 200mm <sup>*1</sup>
	72.1°×41.9° 18mm 18.6°×9.9° 80mm <sup>*2</sup>	21.2°×11.3° 70mm 7.5°×4.0° 200mm <sup>*2</sup>
M.O.D. (Minimum Object Distance)	0.5m/1.7'	1.2m/4.0'
Object Dimensions at M.O.D	43.4×24.3cm 18mm 9.5×5.3cm 80mm <sup>*1</sup>	31.3×17.5cm 70mm 11.5×6.4cm 200mm <sup>*1</sup>
	46.2×24.3cm 18mm 10.1×5.3cm 80mm <sup>*2</sup>	33.3×17.5cm 70mm 12.2×6.4cm 200mm <sup>*2</sup>
Front Diameter	84mm	84mm
Image Circle	Φ31.4mm	Φ31.4mm
Filter Diameter	77mm	77mm
Approx. Size (WxHxL)	3.67×4.22×7.18 in. (93.4×107.2×182.3mm)	3.67×4.22×7.18 in. (93.4×107.2×182.3mm)
Approx. Weight	2.65 lbs (1.2kg) (including servo unit)	2.76 lbs (1.25kg) (including servo unit)

※ Lenses compatible with Super 35mm Sensor cameras.

\*1: Aspect ratio 1.78:1, Screen size 24.6 x 13.8 mm.

\*2: Aspect ratio 1.9:1, Screen size 26.2 x 13.8 mm.

## COMPACT-SERVO Lens Accessories

## ZSG-C10



- Rocker seesaw
- Start/Stop button <sup>\*1</sup>
- ONE-SHOT AF button <sup>\*1</sup>
- 20 PIN cable <sup>\*2</sup>
- Flexible mounting angle.

※ Sold separately.

※ Support strut, bracket, hex wrench included.

\*1: For compatible cameras, please visit our website: [usa.canon.com/pro](http://usa.canon.com/pro)

\*2: For connection to the lens body.

## CINE-SERVO Lens / COMPACT-SERVO Lens Accessories

Category	Model	Notes	CN7x17 KAS T/R1 CN7x17 KAS T/P1 CN7x17 KAS S/E1 CN7x17 KAS S/P1 CN5x11 IAS T/R1	CN5x11 IAS T/P1 CN10x25 IAS S/E1 CN10x25 IAS S/P1 CN8x15 IAS S/E1 CN8x15 IAS S/P1	CN20x50 IAS H/E1 CN20x50 IAS H/P1	CN-E18-80mm CN-E70-200mm
Focus Demand	FPD-400D	There is no need for an optional cable.	●	●	●	● ※1 ※2
	FDJ-G01	BDC - 21 cable (20p - 12p) is required.	●	●	●	—
	FDJ-S01	BDC - 21 cable (20p - 12p) is required.	●	●	●	—
Zoom Demand	ZSD-300D	There is no need for an optional cable.	●	●	●	● ※1 ※2
	ZSD-15MII	CC-2008 Cable (20p - 8p) is required.	●	●	●	● ※1 ※2
	ZDJ-G01	BDC-21 cable (20p-18p) is required.	●	●	●	—
	ZDJ-S01	BDC - 21 cable (20p - 12p) is required.	●	●	●	—
Iris Demand	FDJ-G01	BDC - 21 cable (20p - 12p) is required.	●	●	●	—
	FDJ-S01	BDC - 21 cable (20p - 12p) is required.	●	●	●	—
Demand Cable	BDC-21	20p -12p cable. Required for FDJ-S01 / ZDJ-S01.	●	●	●	—
	CC-2008	20p - 8p cable. Required for ZSD-15II.	●	●	●	●
Clear Filter	77MM Protect Filter	77MM Protect filter	—	—	—	●
	CL127MM-H	CL/127MM-H	● ※4	●	●	—
	CL/112MM	CL/112MM	●	—	—	—
Polarization Filter	PL-C B 77MM	PL-C B 77MM	—	—	—	●
Close-Up Lens	CL-UP500D 77MM	CL-UP500D 77MM	—	—	—	●
Lens Holder	LH-CN7/02	Used when you want to improve the degree of freedom of Focus ring rotation operation. (The lens support attached to the main unit is supported on the front side.)	●	—	—	—
Power Cable	C-ZLPR*	For power supply from external battery. 12-pin - Dtap cable.	●	●	●	—
Extension Cable	12P-12P CABLE 200mm	12P-12P CABLE 200mm	● ※3	● ※3	● ※3	—

\* Made by IDX.

※ 1: Multiple controllers can not be connected at the same time (because there is only one connector). When installing the ZSG - C10 and enabling the operation on the grip side, you can not connect the external controller.  
 ※ 2: For use in studio configurations, an optional Zacuto Z-CNYC. Y-cable can be used to connect zoom and focus controllers to each lens. This configuration allows for simultaneous zoom and focus operation with COMPACT-SERVO lenses.

※ 3: A 12-pin extension cable is required when connected the lens 12-pin cable of the expansion unit 2 and 3 (EU-V2, EU-V3) attached to cameras such as EOS C500 Mark II or EOS C300 Mark III.

※ 4: CL/127MM-H type filter Not for use with CN7x17.

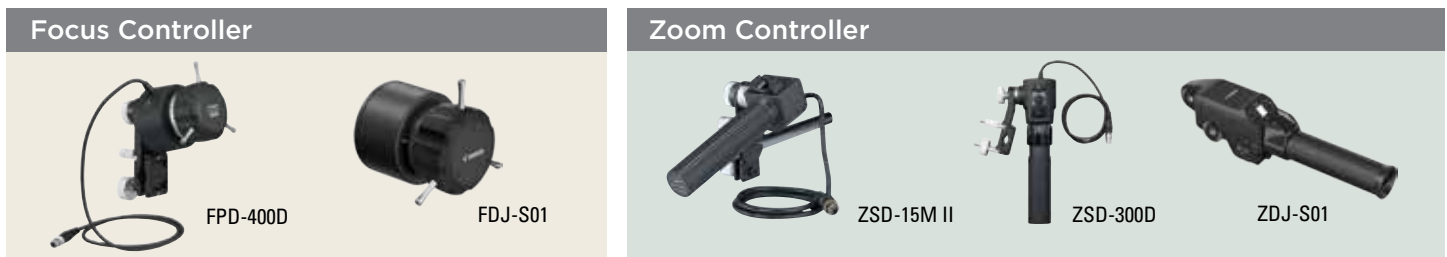

### Lens System Basic Configuration

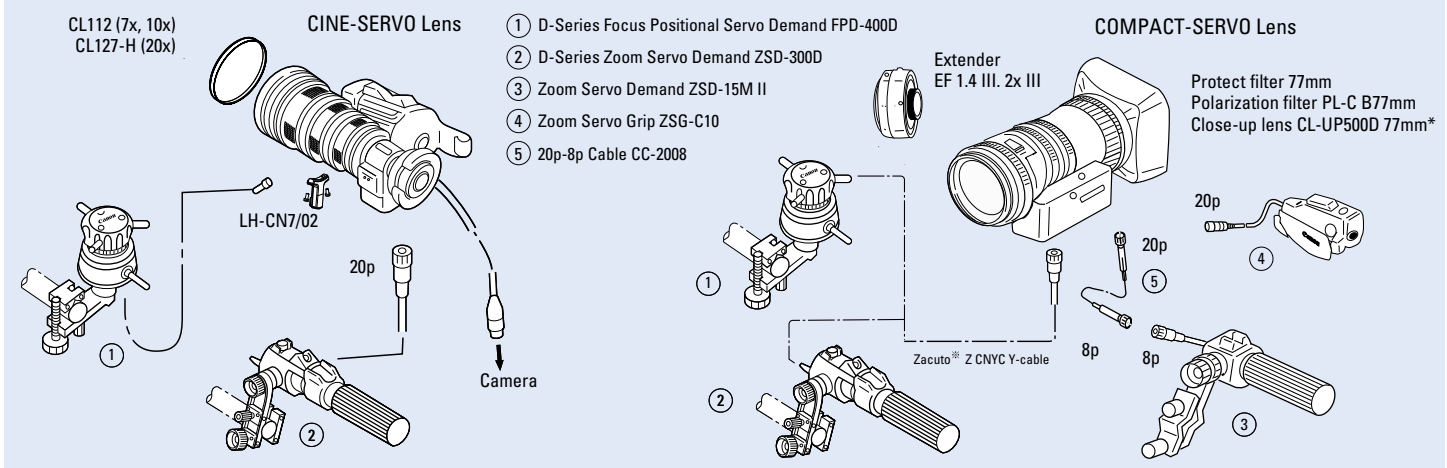

\* Some vignetting occurs when used in combination with RED's Epic system.

※ The optional Zacuto® Z-CNYC Y-cable allows for simultaneous use of zoom and focus controllers with both Compact-Servo lenses.

# 4K PTZ CAMERAS

*EXQUISITE 4K AT YOUR FINGERTIPS*

4K  
UHD

FULL HD  
1920x1080



*BROADCAST-QUALITY VIDEO*  
*INDOOR AND OUTDOOR APPLICATION*  
*FLEXIBLE CONNECTIVITY*

# FEATURES AND BENEFITS

Canon's line of professional PTZ cameras are engineered to provide the highest level of image quality and compatibility for demanding professionals in a multitude of production applications.

## >>> BROADCAST-QUALITY VIDEO

Drawing on over 80 years of imaging excellence, these cameras utilize genuine Canon lenses and a DIGIC imaging processor to provide 4K UHD video that can effortlessly match with Canon's Cinema EOS cameras to provide a uniform look to your broadcast or live stream. Common features of the 4K PTZ line of cameras include:

- Fast and precise autofocus
- Smooth on-air camera movements
- Oversampling HD processing for better looking HD video
- Built-in image stabilization
- Powerful low-light performance



## >>> FLEXIBLE CONNECTIVITY



The Canon PTZ camera lineup<sup>†</sup> offers a variety of IP connectivity possibilities, including support for Canon's XC Protocol, Standard Protocol, RTSP/RTP, RTMP/RTMPS, SRT, FreeD, and NDI HX2. Utilizing today's most popular live production protocols and streaming platforms, the cameras deliver stunning, high quality 4K video.

In addition to the various IP protocols supported, there are a variety of video features on Canon PTZ cameras that are appealing to productions of all types. HDMI and SDI outputs are vital for broadcasting, while Genlock and Timecode are key features for any multi-camera production. Select models also support the FreeD protocol for virtual set productions.

The cameras are also compatible with the Canon RC-IP100 and RC-IP1000 controllers, the Remote Camera Control Application via IP<sup>†</sup> and selected third-party controllers, making integration with existing set-ups a breeze.

<sup>†</sup>CR-X500 does not support IP or any of the IP protocols listed. Not all features available on all cameras. \*Add-on applications sold separately.

# ADD-ON APPLICATIONS

Available on Select PTZ cameras, users can install paid apps through the Add-On Applications System, and operate them within the cameras without the need for an external device.

## >>> AUTO TRACKING



The Auto Tracking Application follows a speaker and maintains their composition in the image during presentations, lectures and other events. Thanks to Canon's high-performance pan/tilt/zoom mechanism and the automatic tracking

application, the camera can smoothly capture movements of people with broadcast quality video. Auto Tracking Lite comes free of charge with supported Canon indoor cameras.

## >>> AUTO LOOP



The Auto Loop Application empowers the camera to automatically repeat pan/tilt/zoom (PTZ) staging movements ordinarily performed by camera operators during the broadcast of events, as well as TV and movie productions. "Fade mode" adjusts the speed of

the camera motions as they begin and end, enabling the automated camera system to mimic professional camerawork.

## >>> CAMERA COLOR MATCHING APPLICATION



This powerful yet easy-to-use application provides effortless color matching between the Canon CR-N700, CR-N400, and

CR-N350 PTZ camera and both Canon or third-party cameras with professional results without the need for advanced color grading skills.

## >>> MULTI-CAMERA MANAGEMENT APPLICATION



Monitor and manage up to 200 cameras direct from your PC and perform key tasks such as multi-view monitoring, device backup, assignment and registration

as well as perform firmware updates to linked cameras simultaneously.

## >>> REMOTE CAMERA CONTROL APPLICATION

Take control of your remote cameras with this free software controller, designed to operate up to 20 PTZ and Professional Video cameras over IP. Preview up to nine cameras on screen and make adjustments to focus, pan, zoom, tilt and exposure in real time, direct from your computer.



## >>> WEBCAM DRIVER

The Webcam Driver allows for compatible Canon PTZ cameras to be used as high quality webcams for teleconferencing applications.



# CANON 4K PTZ CAMERA LINEUP

INDOOR CAMERAS

## CR-N100 REMOTE CAMERA



- 1/2.3" CMOS Sensor with Hybrid Auto Focus
- High Quality 4K 30P and Full HD 60P over HDMI and IP
- 20x Optical Zoom Lens with Optical Image Stabilization
- HDMI, IP, USB Video Out
- Auto Tracking Lite Built-in
- High-precision drive mechanism for smooth, responsive PTZ performance
- Tally lamp on the front of the lens to indicate camera status at a glance
- Supports PoE+, variety of serial/IP control protocol support include Canon XC Protocol, Standard Control for Easy Integration into any Production Environment
- Supports Canon's Webcam Driver
- Built-in NDI@HX2 and SRT (supports adaptive bitrate)
- Add-On Application support



## CR-N300 REMOTE CAMERA



- 1/2.3" CMOS Sensor with Hybrid Auto Focus
- High Quality 4K 30p and Full HD 60P Video Output
- 20x Optical Zoom Lens with Optical Image Stabilization
- Renowned Canon Color Science
- 3G-SDI, HDMI, IP, and USB Video Out
- Auto Tracking Lite Built-in
- Built-in NDI@HX2 and SRT (supports adaptive bitrate)
- FreeD (with multiple destination support) support for AR/VR systems
- Supports PoE+, variety of serial/IP control protocol support include Canon XC Protocol, Standard Control for Easy Integration into any Production Environment



## CR-N350 REMOTE CAMERA



- 1/2.3" CMOS Sensor with Hybrid Auto Focus
- High Quality 4K 60p Video Output
- 20x Optical Zoom Lens (40x Advanced Zoom) with Optical Image Stabilization
- Renowned Canon Color Science with Support for Wide DR, Canon Log 3, HDR(HLG/PQ), EOS Standard/Neutral Image Modes
- 3G-SDI, HDMI, and IP Video Out
- Auto Tracking Lite Built-in
- Built-in NDI HX2 and SRT (supports adaptive bitrate) support
- FreeD (with multiple destination support) support for AR/VR systems
- Supports PoE++, variety of serial/IP control protocol support include Canon XC Protocol, Standard Control for Easy Integration into virtually any Production Environment



## CR-N400 REMOTE CAMERA



- 1/2.3" CMOS Sensor with Hybrid Auto Focus
- High Quality 4K 60P Video Output
- 20x Optical Zoom Lens (40x FHD) with Optical Image Stabilization
- Renowned Canon Color Science with Support for Wide DR, Canon Log 3, HDR(HLG/PQ), EOS Standard/Neutral Image Modes
- 12G-SDI, 3G-SDI, HDMI, and IP Video Out
- Genlock, Dual XLR and 3.5mm Audio input
- Auto Tracking Lite
- Built-in Built-in NDI HX2 and SRT (supports adaptive bitrate)
- FreeD (with multiple destination support) for AR/VR systems
- Supports PoE++, variety of serial/IP control protocol support include Canon XC Protocol, Standard Control for Easy Integration into any Production Environment



## CR-N500 REMOTE CAMERA



- 1" 4K UHD CMOS Sensor with Dual Pixel Autofocus
- High Quality 4K 30p and Full HD 60p Video Output
- 15x Optical Zoom Lens with Optical Image Stabilization
- Built-in ND Filter
- Renowned Canon Color Science with Support for Wide DR and Canon Log 3
- 3G-SDI, HDMI, and IP Video Out
- Genlock, Dual XLR and 3.5mm Audio input
- Auto Tracking Lite Built-in
- Built-in NDI@HX2 and SRT (supports adaptive bitrate)
- FreeD (with multiple destination support) support for AR/VR systems
- Supports PoE+, variety of serial/IP control protocol support include Canon XC Protocol, Standard Control for Easy Integration into any Production Environment



## CR-N700 REMOTE CAMERA



- 1" 4K UHD CMOS Sensor with Dual Pixel Autofocus with EOS iTR AF X
- High Quality 4K 60p Video Output
- 15x Optical Zoom Lens (30x FHD) with Optical Image Stabilization
- Built-in ND Filter
- Renowned Canon Color Science with Support for Wide DR, Canon Log 3, HDR(HLG/PQ), EOS Standard/Neutral Image Modes
- 12G-SDI, 3G-SDI, HDMI, and IP Video Out
- Genlock, Dual XLR and 3.5mm Audio Input
- Auto Tracking Lite Built-in
- Built-in NDI@HX2 and SRT (supports adaptive bitrate)
- FreeD (with multiple destination support) support for AR/VR systems
- Supports PoE++, variety of serial/IP control protocol support include Canon XC Protocol, Standard Control for Easy Integration into any Production Environment



## CR-X300 4K UHD FULL HD 1920x1080

REMOTE CAMERA

- 1/2.3" CMOS Sensor with Hybrid Auto Focus
- High Quality 4K 30p and Full HD 60p Video Output
- 20x Optical Zoom Lens with Optical Image Stabilization
- Renowned Canon Color Science
- Outdoor Camera with Wiper (IP65 Rated)
- 6G-SDI, HDMI, and IP Video Out
- Built-in ND1@HX2 and SRT (supports adaptive bitrate)
- Supports PoE++, variety of serial/IP control protocol support include Canon XC Protocol, Standard Control for Easy Integration into any Production Environment
- FreeD (with multiple destination support) support for AR-VR systems



## CR-X500 4K UHD FULL HD 1920x1080

REMOTE CAMERA

- 1" CMOS Sensor with Dual Pixel Autofocus
- High Quality 4K 60p Video Output
- 15x Optical Zoom Lens (30x FHD) with Optical Image Stabilization
- 12G-SDI Video Out
- Dual DIGIC DV 6 Image Processors
- Renowned Canon Color Science with Support for Wide DR and Canon Log 3 Image Modes
- Outdoor Camera with Wiper (IP55 Rated)



## CANON PTZ CAMERA MOUNTING ACCESSORIES

### CR-N100 | CR-N300



WALL MOUNT BRACKET  
A-SWD5WB2

### CR-N500 | CR-N700



WALL MOUNT BRACKET  
A-RMB7

### CR-N350 | CR-N400



WALL MOUNT BRACKET  
A-RMB5

### CR-X300



WALL MOUNT BRACKET  
A-RMB8

	CR-N100		CR-N300		CR-N350		CR-N400			
CAMERA	OPERATING CONDITION		Indoor		Indoor		Indoor			
	IMAGE SENSOR		Type 1/2.3 (1/2.3 in.) single-plate CMOS sensor Total pixels: approx. 21.14 megapixels Effective pixels: approx. 8.29 megapixels (3840 x 2160)				Type 1/2.3-inch, CMOS (single board) Total pixels: approx. 21.14 megapixels Effective pixels: approx. 8.29 megapixels (3840 x 2160)			
	LENS		f:3.67 – 73.4 mm, F/1.8 – 2.8, 8-bladed circular aperture				f:3.67 – 73.4 mm, F/1.8 – 2.8, 20x optical zoom, 8-bladed iris diaphragm			
	ZOOM		Optical: 20x Digital: 20x		Optical: 20x Digital: 20x Advanced Zoom (FHD): 40x					
	ANGLE OF VIEW		4K UHD: Horizontal: 65.6° (W) – 3.6° (T) Vertical: 39.8° (W) – 2.0° (T)		Full HD: Horizontal: 63.5° (W) – 3.4° (T) Vertical: 38.4° (W) – 1.9° (T)		Frame Frequency 59.95/50.00 Hz: Horizontal: 63.3° (W) – 3.5° (T) - Vertical: 38.9° (W) – 2.0° (T) Frame Frequency 29.97/25.00/23.98 Hz: Horizontal: 65.6° (W) – 3.6° (T) - Vertical: 39.8° (W) – 2.0° (T)			
	SHUTTER SPEED		1/6 – 1/2000 sec. <i>(specific values depend on the frame frequency)</i>				1/3 – 1/2000 sec. <i>(specific values depend on the frame frequency)</i>			
	IRIS		Manual/Automatic aperture				Manual/Automatic aperture			
	GAIN		0.0 dB – 36 dB				0.0 db - 36.0 db			
	ND FILTER		Built-in (1/8 at maximum, gradation ND), motor operated				Built-in (1/8 at maximum, gradation ND), motor operated			
	WHITE BALANCE		AUTO (AWB), Set A, Set B, preset settings (daylight: 5,600 K*, tungsten lamp: 3,200 K*), color temperature setting (2,000 K – 15,000 K), Manual <i>*Color temperatures are given for reference purposes only.</i>							
	FOCUS		Focus mode: Manual, Continuous AF, Face AF, Tracking AF type: Hybrid AF, Contrast AF				Focus mode: Manual, Continuous AF, Face Detection & Tracking, Face only AF, Eye Detection. AF type: Hybrid AF, Contrast AF			
	GAMMA		Normal 1 (Standard), Normal 3 (BT.709)				BT.709 Wide DR, BT.709 Standard, Canon Log 3, Canon 709, HDR (PQ), HDR (HLG)			
	IMAGE STABILIZER		Optical-shift							
	MIN. SUBJECT ILLUMINATION		Approx. 1.5 lux (shutter speed 1/30 sec., frame frequency 59.94 Hz, (P (Programmed AE) Shooting Mode), (Auto Slow Shutter On)				59.94/29.97 Hz: Approx. 3 lux (at shutter speed 1/60 sec, frame rate 59.94p, gain 30.0 dB), Approx. 1.5 (at shutter speed 1/30 sec, frame rate 59.94p, gain 30.0 dB) 50.00/25.00 Hz: Approx. 2.5 lux (at shutter speed 1/50 sec, frame rate 50.00p, gain 30 dB), Approx. 1.3 lux (at shutter speed 1/25 sec, frame rate 50.00p, gain 21 dB) <i>**All of the above are when high sensitivity mode is set to On.</i>			
PAN, TILT, ZOOM OPERATION		Pan Range: Horizontal ±170° Pan Speed: 0.2° – 100°/sec. (Max at preset: 300°/sec.) Tilt Range: Vertical ±30° – ±100° Tilt Speed: 0.2° – 100°/sec. (Max at preset: 180°/sec.)				Pan Range: Horizontal ±170° Pan Speed: 0.2° – 100°/sec. (Max at preset: 200°/sec.) Tilt Range: Vertical ±30° – ±100° Tilt Speed: 0.2° – 100°/sec. (Max at preset: 180°/sec.)				
VIDEO OUTPUT FORMAT	SDI		1920x1080: 59.94P/59.94i, 50.00P/50.00i/25.00P, 29.97P/23.98P (4:2:2 10 bit) 1280x720: 59.94P, 50.00P (4:2:2 10 bit)				3G-SDI: 1920 x 1080: 59.94P/59.94i/50.00P/50.00i/29.97P/25.00P/23.98P (4:2:2 10bit) 1280 x 720: 59.94p/50.00P (4:2:2 10bit) 1280 x 720: 59.94p/50.00P (4:2:2 10bit)		3G-SDI: 1920 x 1080: 59.94P/59.94i/50.00P/50.00i/29.97P/25.00P/23.98P (4:2:2 10bit) 1280 x 720: 59.94p/50.00P (4:2:2 10bit) 1280 x 720: 59.94p/50.00P (4:2:2 10bit) 720 x 576: 50.00i (4:2:2 10bit) 720 x 480: 59.94i (4:2:2 10bit)	
	HDMI		3840 x 2160: 29.97P, 25.00P, 23.98P (4:2:2 10 bit) 1920 x 1080: 59.94P/59.94i, 50.00P/50.00i/25.00P, 29.97P/23.98P (4:2:2 10 bit) 1280 x 720: 59.94P, 50.00P (4:2:2 10 bit) <i>*Same video format required for SDI and HDMI (cannot select different formats for SDI and HDMI) **When 3840 x 2160 is selected for HDMI, video will not be outputted to SDI.</i>				3840 x 2160: 59.94P/59.94i/50.00P/50.00i/29.97P/25.00P/23.98P (4:2:2 10bit) 1920 x 1080: 59.94P/59.94i/50.00P/50.00i/29.97P/25.00P/23.98P (4:2:2 10bit) 1280 x 720: 59.94P, 50.00P (4:2:2 10bit) 720x576: 50.00P (4:2:2 10bit) 720x480: 59.94P (4:2:2 10bit)			
	IP		Frame frequency 59.94 Hz 1920 x 1080: 59.94fps, 29.97fps, 14.99fps, 5.00fps (4:2:0 8 bit) 1280 x 720: 59.94fps, 29.97fps, 14.99fps, 5.00fps (4:2:0 8 bit) 640 x 360: 59.94fps, 29.97fps, 14.99fps, 5.00fps (4:2:0 8 bit)		Frame frequency 29.97 Hz 3840 x 2160: 29.97fps, 14.99fps, 5.00fps (4:2:0 8 bit) 1920 x 1080: 29.97fps, 14.99fps, 5.00fps (4:2:0 8 bit) 1280 x 720: 29.97fps, 14.99fps, 5.00fps (4:2:0 8 bit) 640 x 360: 29.97fps, 14.99fps, 5.00fps (4:2:0 8 bit)		Frame frequency 23.98 Hz 3840 x 2160: 23.98fps, 11.99fps, 5.99fps (4:2:0 8 bit) 1920 x 1080: 23.98fps, 11.99fps, 5.99fps (4:2:0 8 bit) 1280 x 720: 23.98fps, 11.99fps, 5.99fps (4:2:0 8 bit) 640 x 360: 23.98fps, 11.99fps, 5.99fps (4:2:0 8 bit)		3840 x 2160: 59.94fps, 50.00fps, 29.97 fps, 25.00fps, 23.98fps, 14.99 fps, 12.50fps, 11.99fps, 5.99fps, 5.00 fps (4:2:0 8 bit) 1920 x 1080: 59.94fps, 50.00fps, 29.97 fps, 25.00fps, 23.98fps, 14.99 fps, 12.50fps, 11.99fps, 5.99fps, 5.00 fps (4:2:0 8 bit) 1280 x 720: 59.94fps, 50.00fps, 29.97 fps, 25.00fps, 23.98fps, 14.99 fps, 12.50fps, 11.99fps, 5.99fps, 5.00 fps (4:2:0 8 bit) 640 x 360: 59.94fps, 50.00fps, 29.97 fps, 25.00fps, 23.98fps, 14.99 fps, 12.50fps, 11.99fps, 5.99fps, 5.00 fps (4:2:0 8 bit)	
	SUPPORTED PROTOCOLS		Protocol: XC Protocol, RTSP/RTMP, NDI HX2, RTMP/RTMPS, Standard Communication (Serial), Standard Communication (IP), SRT				Protocol: XC Protocol, RTSP/RTMP, NDI HX2, RTMP/RTMPS, Standard Communication (Serial), Standard Communication (IP), FreeD, SRT			
	COMMUNICATION CONTROL		LAN, Serial, IR, USB		LAN, Wi-Fi, Serial, IR, USB					
INTERFACE	NETWORK TERMINAL		LAN x 1, RJ45, 1000Base-T							
	SDI OUT TERMINAL		3G-SDI, BNC jack (output only) x 1, 0.8 Vp-p/75 Ω, unbalanced SMPTE 424, SMPTE 425, SMPTE ST 299-2 compliant Embedded audio, Time code (VITC/LTC)		3G-SDI, BNC jack x1 3G-SDI 0.8 Vp-p/75 Ω SMPTE ST 259, SMPTE ST 292, SMPTE ST 424/425, SMPTE ST2081, SMPTE ST 2082, SMPTE ST 272, SMPTE ST 299 compliant Embedded audio, Time code (VITC/LTC)		12G/3G-SDI OUT Terminal, BNC jack x1 12GSDI & x1 3G-SDI 0.8 Vp-p/75 Ω SMPTE ST 259, SMPTE ST 292, SMPTE ST 424/425, SMPTE ST2081, SMPTE ST 2082, SMPTE ST 272, SMPTE ST 299 compliant Embedded audio, Time code (VITC/LTC)			
	TIME CODE TERMINAL		-		-		BNC JACK X 1, 5-18 VP-P/100 Ω			
	GEN-LOCK TERMINAL		-		-		BNC JACK X 1, 1.0 VP-P/75 Ω			
	HDMI OUT TERMINAL		HDMI connector x 1, output only							
	RS-422 TERMINAL		RJ45 connector x 1							
	MIC TERMINAL		φ3.5 mm stereo mini jack (unbalanced, plug-in power supported) • Sensitivity (MIC): -72 dBV (Manual volume center, full scale -18 dB)/1 kΩ or more/Att.: 20 dB • Sensitivity (LINE): -10 dBV (Manual volume center, full scale -18 dB)/1 kΩ or more • Supply Voltage: 2.4 V DC (Bias resistance: 2.2 kΩ)							
	INPUT 1 / INPUT 2 XLR TERMINALS		-		-		NP1UT XLR 3-pin jack (balanced) (1) shield, (2) hot, (3) cold, two lines Sensitivity (MIC): -60 dBu (Manual volume center, full scale -18 dB)/1 kΩ or more/Att.: 20 dB Sensitivity (LINE): +4 dBu (Manual volume center, full scale -18 dB)/1 kΩ or more Supply Voltage: 48 V DC (Bias resistance: 6.8 kΩ)			
OTHER	OPERATING ENVIRONMENT		Temperature: +32°F – +104°F (0°C – +40°C) Humidity: 10% – 90% (without condensation)							
	DUST/WATER RESISTANCE		-							
	POWER SUPPLY		PoE: PoE+ power supply via LAN connector (IEEE802.3at compliant) – PoE cannot be used External power source: 24V DC (using included AC adaptor)				PoE: PoE++ power supply via LAN connector (IEEE802.3bt compliant) – Standard PoE cannot be used External power source: 12V DC (using included AC adaptor)			
	POWER CONSUMPTION		PoE+ Input: Approx. 13.9W* max. (body only) DC Input: Approx. 13.3W max. (body only) <i>*Class 4 (25.5 W required) for power supply devices</i>		PoE+ Input: Approx. 16.2W* max. (body only) DC Input: Approx. 15.0W max. (body only) <i>*Class 4 (25.5 W required) for power supply devices</i>		PoE++ Input: Approx. 26.1W max. (body only) DC Input: Approx. 23.6W max. (body only) <i>*Class 5 (40W required) for power supply devices</i>		PoE++ Input: Approx. 34.2W max. (body only) DC Input: Approx. 33.8W max. (body only) <i>*Class 5 (40W required) for power supply devices</i>	
	QUIETNESS		NC35 or Lower							
	DIMENSIONS (W X H X D)		Approx. 6.06 x 7.01 x 6.46 in. (154 x 178 x 164 mm) <i>(excluding protrusions)</i>				Approx. 6.93 x 8.66 x 7.64 in. (176 x 220 x 194 mm) <i>(excluding protrusions)</i>			
	WEIGHT		Approx. 4.86 lb. (2.2 kg) (body only)				Approx. 6.6 lb. (3.0 kg) (body only)		Approx. 6.8 lb. (4.1 kg) (body only)	
	SUPPORTED CONTROLLERS		Hardware: RC-IP100, RC-IP1000 Software: Remote Camera Control Application, Multi-Camera Control Application, Multi-Camera Management Application, Camera Search tool				Hardware: RC-IP100, RC-IP1000 Software: Camera Color Matching Application, Remote Camera Control Application, Multi-Camera Control Application, Multi-Camera Management Application, Camera Search tool			

	CR-N500		CR-N700		CR-X300		CR-X500			
CAMERA	OPERATING CONDITION		Indoor				Outdoor			
	IMAGE SENSOR		Type 1.0 (1.0 in.) single-plate CMOS sensor Total pixels: approx. 13.40 megapixels Effective pixels: approx. 8.29 megapixels (3840 x 2160)				1/2.3" 4K UHD CMOS Pro Image Sensor Total pixels: approx. 21.14 megapixels Effective pixels: approx. 8.29 megapixels (3840 x 2160)		Type 1.0 (1.0 in.) single-plate CMOS sensor Total pixels: approx. 13.40 megapixels Effective pixels: approx. 8.29 megapixels (3840 x 2160)	
	LENS		f=8.3 – 124.5 mm, F/2.8 – 4.5, 9-bladed iris diaphragm				f=3.67 – 73.4 mm, F/1.8 – 2.8, 8-bladed circular aperture		f=8.3 – 124.5 mm, F/2.8 – 4.5, 9-bladed iris diaphragm	
	ZOOM		Optical: 15x Digital: 20x		Optical: 15x Digital: 20x Advanced (FHD): 30x		Optical: 20x Digital: 20x		Optical: 15x Advanced Zoom FHD: 30x	
	ANGLE OF VIEW		Horizontal: 73.0 (W) – 5.7° (T) Vertical: 45.2° (W) – 3.2° (T)				4K UHD: Horizontal: 65.6 (W) – 3.6° (T) Vertical: 39.8° (W) – 2.0° (T) Full HD: Horizontal: 63.5 (W) – 3.4° (T) Vertical: 38.4° (W) – 1.9° (T)		Horizontal: 73.0 (W) – 5.7° (T) Vertical: 45.2° (W) – 3.2° (T)	
	SHUTTER SPEED		1/3 – 1/2000 sec. <i>(specific values depend on the frame frequency)</i>				1/6 – 1/2000 sec. <i>(specific values depend on the frame frequency)</i>		Auto, Manual 1/3 – 1/2000 sec.	
	IRIS		Manual/Automatic aperture				Manual/Automatic aperture		Manual/Automatic aperture	
	GAIN		-6.0 db - 33.0 db		-6.0 db - 36.0 db		0.0 db - 36 dB		Auto, Manual 0 db - 33.0 dB	
	ND FILTER		3 levels: ND1 (ND: 1/4), ND2 (ND: 1/16), ND3 (ND: 1/64) Material: Glass (with sunlight burn-in protection) turret switched, motor-driven				ND filter: 1/8 at maximum Enhanced ND filter: 1/32		Built-in (Off, 1/4, 1/16, 1/64), motor operated	
	WHITE BALANCE		AUTO (AWB), Set A, Set B, preset settings (daylight: 5,600 K*, tungsten lamp: 3,200 K*), color temperature setting (2,000 K – 15,000 K), Manual <i>*Color temperatures are given for reference purposes only.</i>				AUTO (AWB), Set A, Set B, preset settings (daylight: 5,600 K*, tungsten lamp: 3,200 K*), color temperature setting (2,000 K – 15,000 K), Manual <i>*Color temperatures are given for reference purposes only.</i>		AUTO, Set A, Set B, Daylight, Tungsten, Kelvin	
	FOCUS		Focus mode: Manual, AF-boosted MF, Continuous AF, Face AF, Tracking AF type: Dual Pixel CMOS AF, Contrast AF		Focus mode: Manual, AF-boosted MF, Continuous AF, Face Detection & Tracking, Face only AF, Eye Detection AF type: Dual Pixel CMOS AF, Contrast AF		Focus Mode: Manual, Continuous AF, Face Detection AF, Tracking AF type: Hybrid AF, Contrast AF		Dual Pixel CMOS AF	
	GAMMA		Normal1 (Standard), Normal2 (v4.0), Normal3 (BT.709), Normal4 (v5.0), Wide DR, Canon Log 3		BT.709 Normal, BT.709 Wide DR, BT.709 Standard, Canon Log 3, HDR (PQ), HDR(HLG)		Normal 1 (Standard), Normal 3 (BT.709)		Normal1: BT.709, Normal1: BT.2020, Wide DR: BT.709, Wide DR: BT.2020, PQ: BT.2020, HLG: BT.2020, Canon Log 3: BT.709, Canon Log 3: BT.2020	
	IMAGE STABILIZER		Optical-shift		Optical-shift		Optical-shift		Optical-shift	
	MIN. SUBJECT ILLUMINATION		Approx. 3.0 lux (with 1/60 sec. shutter speed, 59.94P frame rate) Approx. 1.5 lux (with 1/30 sec. shutter speed, 59.94P frame rate)		Approx. 3.0 lux (with 1/60 sec. shutter speed, 59.94P frame rate) Approx. 1.5 lux (with 1/30 sec. shutter speed, 59.94P frame rate)		Approx. 3.0 lux (with 1/60 sec. shutter speed and Auto Slow Shutter Off) Approx. 1.5 lux (with 1/30 sec. shutter speed and Auto Slow Shutter On)		Approx. 3.0 lux (with 1/60 sec. shutter speed and Auto Slow Shutter Off) Approx. 1.5 lux (with 1/30 sec. shutter speed and Auto Slow Shutter On)	
PAN, TILT, ZOOM OPERATION		Pan Range: Horizontal ±170° Pan Speed: 0.1° – 100°/sec. Tilt Range: Vertical -30° – +90° Tilt Speed: 0.1° – 100°/sec				Pan Range: Horizontal ±180° Pan Speed: 0.3° – 60°/sec. Tilt Range: Vertical -40° – +215° Tilt Speed: 0.3° – 60°/sec.		Pan Range: Horizontal ±170° Pan Speed: 0.5° – 25°/sec. Tilt Range: Vertical -50° – +30° Tilt Speed: 0.3° – 20°/sec.		
VIDEO OUTPUT FORMAT	SDI		1920x1080: 59.94P/59.94i, 50.00P/50.00i/25.00P, 29.97P/23.98P (4:2:2 10 bit) 1280x720: 59.94P, 50.00P (4:2:2 10 bit)		3G-SDI: 1920 x 1080: 59.94P/59.94i/50.00P/50.00i/29.97P/25.00P/23.98P (4:2:2 10bit) 1280 x 720: 59.94P/50.00P (4:2:2 10bit) 12G-SDI: 3840 x 2160: 59.94P/50.00P/29.97P/25.00P/23.98P (4:2:2 10bit) 1920 x 1080: 59.94P/59.94i/50.00P/50.00i/29.97P/25.00P/23.98P (4:2:2 10bit) 1280 x 720: 59.94P, 50.00P (4:2:2 10 bit)		3840x2160: 29.97P, 25.00P, 23.98P (4:2:2 10 bit) 1920x1080: 59.94P/59.94i, 50.00P/50.00i/25.00P, 29.97P/23.98P (4:2:2 10 bit) 1280x720: 59.94P, 50.00P (4:2:2 10 bit)		3840x2160: 59.94P/50.00P/29.97P/25.00P/23.98P (4:2:2 10 bit) 1920x1080: 59.94P/59.94i/50.00P/50.00i/29.97P/25.00P/23.98P (4:2:2 10 bit) 1280x720: 59.94P, 50.00P (4:2:2 10 bit)	
	HDMI		3840x2160: 29.97P, 25.00P, 23.98P (4:2:2 10 bit) 1920x1080: 59.94P/59.94i, 50.00P/50.00i/25.00P, 29.97P/23.98P (4:2:2 10 bit) 1280x720: 59.94P, 50.00P (4:2:2 10 bit) <i>*Same video format required for SDI and HDMI (cannot select different formats for SDI and HDMI) *When 3840 x 2160 is selected for HDMI, video will not be outputted to SDI.</i>		3840 x 2160: 59.94P/50.00P/29.97P/25.00P/23.98P (4:2:2 10bit) 1920 x 1080: 59.94P/59.94i/50.00P/50.00i/29.97P/25.00P/23.98P (4:2:2 10bit) 1280 x 720: 59.94P/50.00P (4:2:2 10bit) 720x576: 50.00P (4:2:2 10bit) 720x480: 59.94P (4:2:2 10bit)		3840x2160: 29.97P, 25.00P, 23.98P (4:2:2 10 bit) 1920x1080: 59.94P/59.94i, 50.00P/50.00i/25.00P, 29.97P/23.98P (4:2:2 10 bit) 1280x720: 59.94P, 50.00P (4:2:2 10 bit)		-	
	IP		Frame frequency 59.94 Hz 3840x2160 (CR-N700 Only): 59.94fps, 29.97fps, 14.99fps, 5.00fps (4:2:0 8 bit) 1920 x 1080: 59.94fps, 29.97fps, 14.99fps, 5.00fps (4:2:0 8 bit) 1280 x 720: 59.94fps, 29.97fps, 14.99fps, 5.00fps (4:2:0 8 bit) 640 x 360: 59.94fps, 29.97fps, 14.99fps, 5.00fps (4:2:0 8 bit)		Frame frequency 29.97 Hz 3840 x 2160: 29.97fps, 14.99fps, 5.00fps (4:2:0 8 bit) 1920 x 1080: 29.97fps, 14.99fps, 5.00fps (4:2:0 8 bit) 1280 x 720: 29.97fps, 14.99fps, 5.00fps (4:2:0 8 bit) 640 x 360: 29.97fps, 14.99fps, 5.00fps (4:2:0 8 bit)		Frame frequency 23.98 Hz 3840 x 2160: 23.98fps, 11.99fps, 5.99fps (4:2:0 8 bit) 1920 x 1080: 23.98fps, 11.99fps, 5.99fps (4:2:0 8 bit) 1280 x 720: 23.98fps, 11.99fps, 5.99fps (4:2:0 8 bit) 640 x 360: 23.98fps, 11.99fps, 5.99fps (4:2:0 8 bit)		-	
	SUPPORTED PROTOCOLS		Protocol: XC Protocol, RTSP/RTMP, NDI HX2, RTMP/RTMPS, Standard Communication (Serial), Standard Communication (IP), Freed, SRT				Control: Canon NU Protocol			
INTERFACE	COMMUNICATION CONTROL		LAN, Wi-Fi, Serial, IR		LAN, Wi-Fi, Serial, IR		LAN, Serial		Serial	
	NETWORK TERMINAL		LAN x 1, RJ45, 1000Base-T				-			
	SDI OUT TERMINAL		3G-SDI, BNC jack (output only) x 1, 0.8 Vp-p/75 Ω, unbalanced SMPTE 424, SMPTE 425, SMPTE ST 299-2 compliant Embedded audio, Time code (VITC/LTC)		12G/3G-SDI OUT Terminal, BNC jack x1 12GSDI & x1 3G-SDI, 0.8 Vp-p/75 Ω, SMPTE ST 299, SMPTE ST 292, SMPTE ST 424/425, SMPTE ST2081, SMPTE ST 2082, SMPTE ST 272, SMPTE ST 299 compliant Embedded audio, Time code (VITC/LTC)		6G-SDI, BNC jack (output only) x 1, 0.8 Vp-p/75 Ω, unbalanced SMPTE 2081, 424, 425, ST 299-2 compliant Embedded audio, Time code (VITC/LTC)		12G-SDI BNC jack (output only) x 1	
	TIME CODE TERMINAL		-		BNC jack x 1, 1.3 Vp-p/50 Ω or less		-		-	
	GEN-LOCK TERMINAL		BNC jack x 1, 1.0 Vp-p/75 Ω, input only		BNC jack x 1, 1.0 Vp-p/75 Ω, input only		BNC jack x 1, 1.0 Vp-p/75 Ω, input only		BNC jack x 1	
	HDMI OUT TERMINAL		HDMI connector x 1, output only		HDMI connector x 1, output only		HDMI connector x 1, output only		-	
	RS-422 TERMINAL		RJ45 connector x 1		RJ45 connector x 1		RJ45 connector x 1		RS-422 Serial	
	MIC TERMINAL		φ3.5 mm stereo mini jack (balanced, plug-in power supported) • Sensitivity (MIC): -72 dBV (Manual volume center, full scale -18 dB)/1 kΩ or more/Att.: 20 dB • Sensitivity (LINE): -10 dBV (Manual volume center, full scale -18 dB)/1 kΩ or more • Supply Voltage: 2.4 V DC (Bias resistance: 2.2 kΩ)		-		Built-In Waterproof Microphone		-	
INPUT 1 / INPUT 2 XLR TERMINALS		INPUT (3-pin jack) (pin1: shield, pin2: hot, pin3: cold), 2 sets, balanced Sensitivity (MIC): -50 dBu (Manual volume center, full scale -18 dB)/600 Ω/Att.: 20 dB Sensitivity (LINE): +4 dBu (Manual volume center, full scale -18 dB)/1 kΩ or more Supply Voltage: 48 V DC (Bias resistance: 6.8 kΩ)				-		-		
OTHER	OPERATING ENVIRONMENT		Temperature: +32°F – +104°F (0°C – +40°C) Humidity: 10% – 90% (without condensation)				Temperature: +5°F – +104°F (-15°C – +40°C) Humidity: 90% or less (without condensation) Startup temperature: +14°F – +104°F (-10°C – +40°C)			
	DUST/WATER RESISTANCE		-				IP65		IP55	
	POWER SUPPLY		PoE: PoE+ power supply via LAN connector (IEEE802.3bt compliant) – PoE cannot be used External power source: 24V DC (using included AC adaptor)		PoE: PoE+ power supply via LAN connector (IEEE802.3bt compliant) – PoE and PoE+ cannot be used Ext. power source: 12V DC (4-pin XLR input)		PoE: PoE+ power supply via LAN connector (IEEE802.3bt compliant) – PoE and PoE+ cannot be used External power source: 12V DC (use included power cable with DC plug)		DC 10.5 - 15V	
	POWER CONSUMPTION		PoE+ Input: Approx. 19.5W* max. (body only) DC Input: Approx. 18.6W max. (body only) <i>*Class 4 (25.5 W required) for power supply devices</i>		PoE+ Input: Approx. 39.8W* max. (body only) DC Input: Approx. 37.7W max. (body only) <i>*Class 5 (40.0 W required) for power supply device</i>		PoE+ Input: Approx. 39.8W* max. (body only) DC Input: Approx. 37.7W max. (body only) <i>*Class 5 (40.0 W required) for power supply devices</i>		90W	
	QUIETNESS		NC35 or Lower				NC45 or lower (when operating at 60°/sec)		NC55 or less	
	DIMENSIONS (W X H X D)		Approx. 7.87 x 10.59 x 8.19 in. (200 x 269 x 208 mm) <i>(excluding protrusions)</i>				Approx. 8.54 x 12.24 x 8.54 in. (217 x 311 x 217 mm) <i>(excluding protrusions and connector cover)</i>		Approx. 13.27 x 15.35 x 15.2 in. (337 x 390 x 386 mm) <i>(excluding protrusions)</i>	
	WEIGHT		Approx. 9.04 lb. (4.1 kg) (body only)		Approx. 9.7 lb. (4.4 kg) (body only)		Approx. 15.5 lb. (7 kg) (body only)		Approx. 37.48 lbs. (17.0 kg)	
	SUPPORTED CONTROLLERS		Hardware: RC-IP100, RC-IP1000 Software: Remote Camera Control Application, Multi-Camera Control Application, Multi-Camera Management Application, Camera Search tool				Hardware: RC-IP100, RC-IP1000 Software: Remote Camera Control Application, Multi-Camera Control Application, Multi-Camera Management Application, Camera Search tool			

# REMOTE CAMERA CONTROLLERS

Control your multi-camera productions, using IP or serial control, with precision joystick, zoom rocker, and a touchscreen display.



## RC-IP100

### Remote Camera Controller

The RC-IP100 Remote Camera Controller provides IP control for up to 100 supported Canon cameras. An additional Canon camera can be controlled through the serial port. The controller is equipped with a 7" interactive touch screen and a joystick in order to pan, tilt, zoom and change camera function settings remotely. The smooth precision of the joystick allows operators to capture on-air movements with confidence.

- Control up to 100 Canon Supported cameras
- Smooth PTZ movement and Precise Control for Professional Productions
- Adjust Pan, Tilt, Zoom and Change Camera Function Settings Remotely
- Equipped with 7" diagonal Touch Screen, Control and Zoom Lever and 4 Customizable Buttons
- Supports configuration and enabling of Add-On applications, such as Auto Tracking and Auto Loop



## RC-IP300

### Remote Camera Controller

The RC-IP300 is an advanced PTZ controller enabling fast operation of multiple PTZ cameras through a tactile control interface. Featuring assignable buttons, programmable trace operation, and adjustable speed and response controls, this controller helps enable intuitive control of multiple PTZ cameras quickly and easily. With a 3.5-inch touch panel that provides clear visibility, showing operation menus and live camera video feeds, capability to control up to 200 cameras over IP, and more cutting-edge capabilities, the RC-IP300 is built for multi-camera productions.

- Compact and lightweight Fully featured remote camera controller provides smooth PTZ movement and precise control
- 3.5" touch panel for a clear display of operation screens, camera configuration, live camera views, and Touch Auto Focus
- Control up to 200 supported Canon cameras
- User assignable buttons and dials allow users to customize the controller to provide easy access to their most frequently used functions
- Adjust pan, tilt, zoom and change camera function settings remotely
- Support for multiple connected cameras to be operated and configured simultaneously
- Control lever and zoom rocker with adjustable reaction rate
- Powered by Power over Ethernet or AC Adapter (included)



## RC-IP1000

### Remote Camera Controller

The RC-IP1000 is an advanced PTZ controller enabling fast operation of multiple PTZ cameras through a newly developed control interface. Featuring 42 buttons and 14 dials, including assignable buttons, programmable trace operation, and adjustable speed and response controls, this controller helps enable intuitive control of multiple PTZ cameras quickly and easily. With a 7-inch touch panel that provides clear visibility and touchscreen control, showing operation menus and camera video feeds, capability to control up to 200 cameras over IP, and more cutting-edge capabilities, the RC-IP1000 is built for large multi-camera productions.

- Full-featured remote camera controller that supports 200 cameras and provides smooth PTZ movement and precise control
- 7" touch screen provides live video previews of up to 9 cameras per screen and supports touch auto focus
- Adjust pan, tilt, zoom and change camera function settings remotely
- Control lever and zoom rocker with adjustable reaction rate
- 4K 60P video input/output via 12G SDI
- Camera OSD menu from compatible cameras can be shown on the touch panel and operated using push-button controls



4K PTZ CAMERAS: EXQUISITE 4K AT YOUR FINGERTIPS

# CarePAK PRO

CINEMA EOS



## Accidental Damage Protection for Peace of Mind.

Protect your investment from drops, spills & more with Canon CarePAK PRO.\*\*

### What does CarePAK PRO include?



Protection from Accidental Damage



Extended Coverage from Normal Wear and Tear



Service & Support Directly from Canon



\$0 Deductible



5 Business Day Service



Image Recovery\*



Free Two-Way Shipping



Transferable



Always Genuine Canon Products



Complimentary Customer Support

Learn more at [usa.canon.com/carepak-pro](http://usa.canon.com/carepak-pro) or call 1-833-CAREPAK.

CarePAK PRO available on all Cinema EOS Cameras and Cinema Lenses.

\* Image Recovery included with CarePAK PRO for Cameras with a memory card slot (only for use with the internal removable memory card).

\*\* Included with a valid CarePAK plan and active Canon Account. Most claims are serviced and shipped within five business days. Subject to availability of parts or replacement product. Products must be purchased as New from an Authorized Canon Dealer, and not intended for rental, sub-rental, or for resale. See Terms and Conditions at [usa.canon.com/carepak-pro](http://usa.canon.com/carepak-pro) for complete details.



[usa.canon.com/support](http://usa.canon.com/support)  
800-423-LENS

For more info: [usa.canon.com/pro](http://usa.canon.com/pro)

 @CanonUSApr  
 @CanonUSA  
 @CanonUSA  
 @CanonUSA



The size and weight of all lenses within this brochure may vary according to the applicable camera models.

©2026 Canon U.S.A., Inc. all rights reserved.

Certain images and effects are simulated. Specifications and availability are subject to change without notice. Products not shown to scale. Weight and dimensions are approximate. Not responsible for typographical errors. Canon is a registered trademark of Canon Inc. in the United States and may also be a registered trademark or trademark in other countries. All other product and brand names are trademarks, or service marks of their respective owners and are hereby acknowledged.

PRINTED IN U.S.A.

0216W969 04/26



**INNOVATION**

In TV Optics Since 1958

Toward 100 years anniversary

**Canon**

1-800-OK-CANON  
[usa.canon.com](http://usa.canon.com)

Canon U.S.A., Inc.  
One Canon Park  
Melville, NY 11747 U.S.A.