



Cloud Connector

imageRUNNER
ADVANCE DX

imagePRESS Lite



**CLOUD
CONNECTOR**
A Convenient
Connection in
the Cloud

Pair Supported Canon MFPs to Select Cloud Services for Virtually Seamless Print and Scan Capabilities

Connecting to cloud services in the workplace is often a major contributor to overall efficiency. Cloud Connector from Canon is an easy-to-use application that connects third-generation imageRUNNER ADVANCE, imageRUNNER ADVANCE DX, imagePRESS Lite, and supported imagePRESS models¹ with select cloud services², allowing users to expand their print and scan capabilities without the need for additional backend system configuration. This convenient solution includes simple setup and activation steps, and an uncomplicated, do-it-yourself user registration process.

There are Cloud Connector options that enable users to easily:

Connect to select cloud services



Scan and upload directly
to cloud storage



Print from the cloud
at the device



Scan to email without
admin set up



Print from email without
use of print drivers

Connect Your Canon MFP to These Cloud Services with Cloud Connector

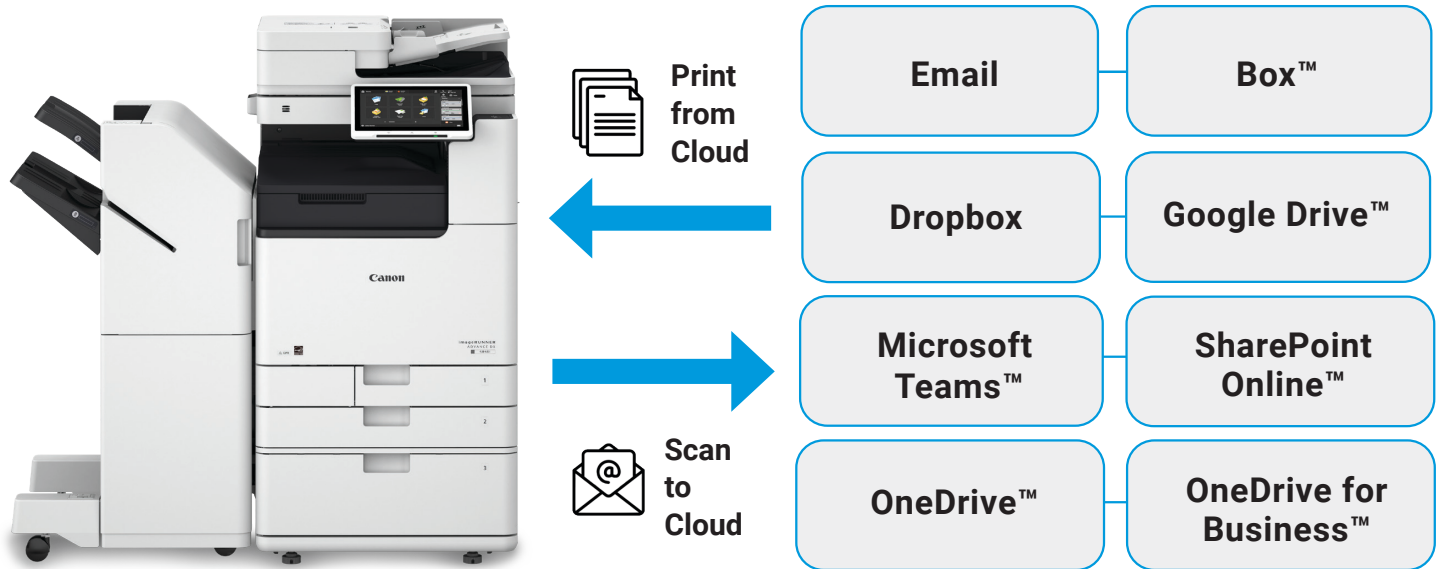

Note: One 3-year or 5-year term license required per destination per device. Each term license sold separately.³

Cloud Connector Supports Users with an Independent Installation and Configuration Process

Once activated, users can single-handedly register for Cloud Connector without additional assistance from a Systems Engineer or Administrator.

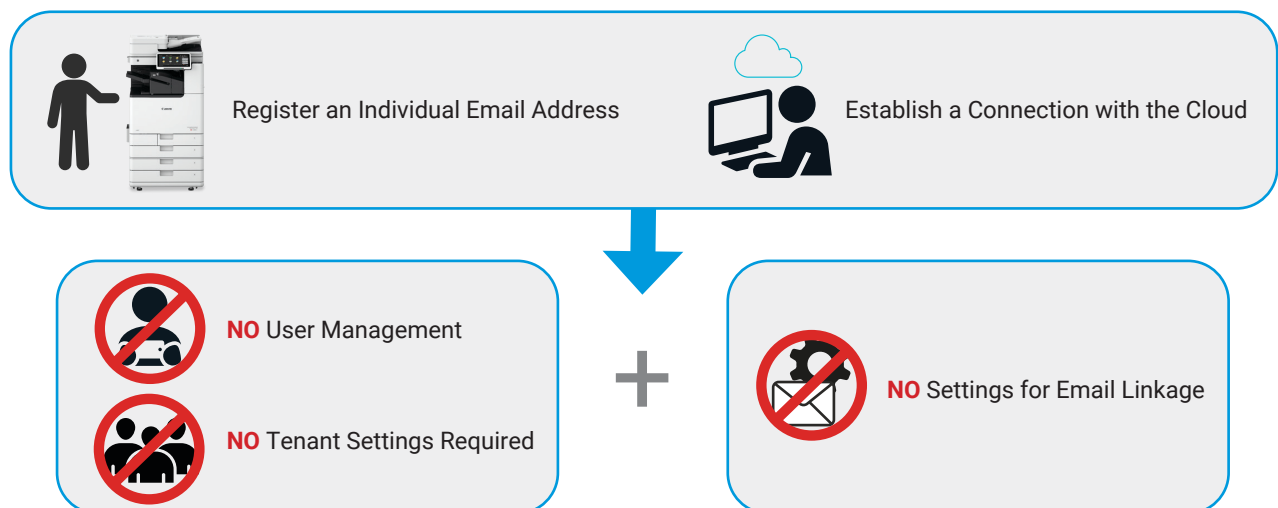

Experience Cloud Connector at Work

Simple User Registration Steps

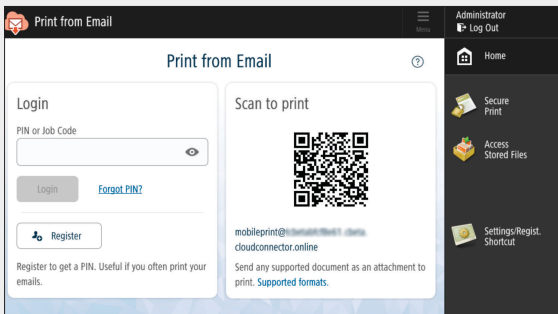

Select Register Button

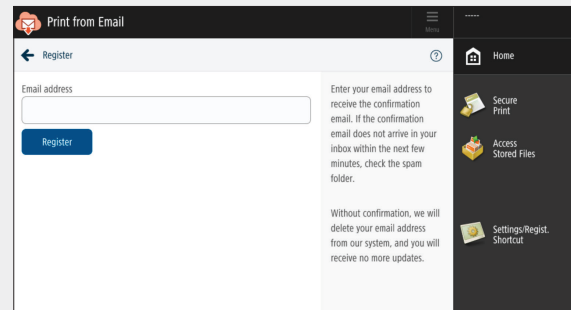

Enter Individual Email Address

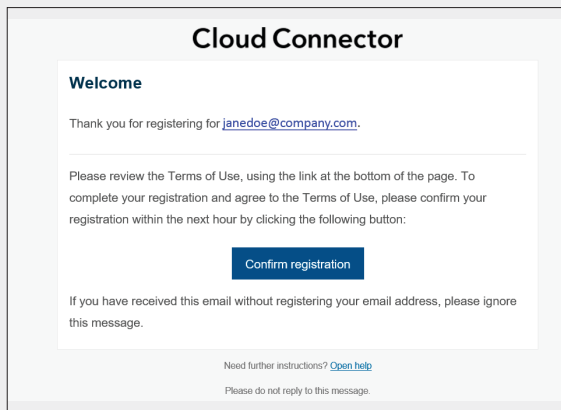

Select Confirm Registration on Email Received

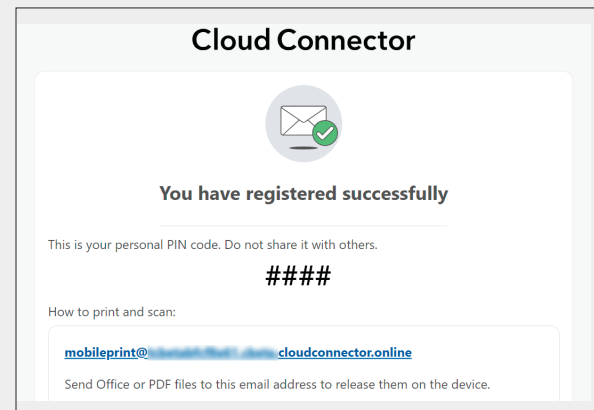

An Automatically Generated Pin Will Be Sent

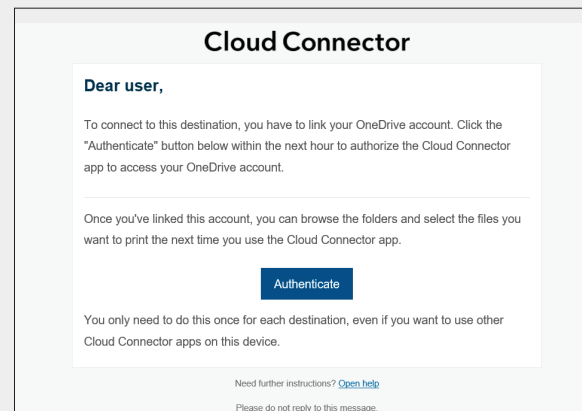
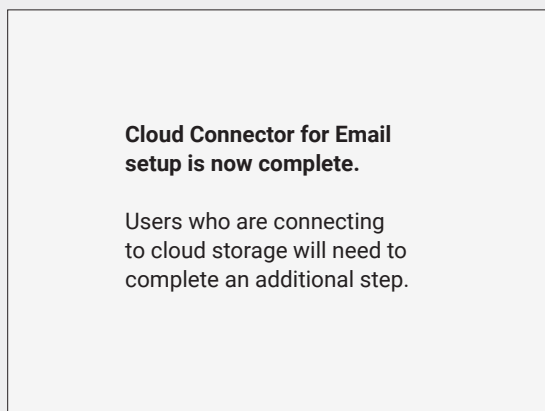

Authenticate to Cloud Service

Note: If you do not log in to Cloud Connector within 30 days, you will need to re-register with the device.

SPECIFICATIONS

Print Specifications

Functionality

Print compatible files from email or cloud storage

Supported Cloud Services

Box™, Dropbox, Google Drive™, OneDrive™, OneDrive for Business™, SharePoint Online™, Microsoft Teams™

Supported File Formats

PDF, HTML, XML, RTF, XLSX, DOCX, PPTX, WPD, BMP, GIF, ICO, JP2, JPG, PNG, TIFF (Google Drive™ only)
Google Docs™, Google Sheets™, Google Slides™

Supported Paper Sizes

Virtually all paper sizes supported by the MFP for PDF and Microsoft Office files (.xlsx/.docx/.pptx) only; other file types are only supported for A4 and Letter sizes.⁴

File Size Limit

100 MB Including attachments (Email), 30 MB (Cloud)

Number of Copies

1-9999

Color Options

Color, **Black-and-white**

Duplex Options

Simplex, **Duplex long edge**, Duplex short edge

Staple Options⁵

No Stapling, Single Staple/Eco Staple (Upper left, Lower left, Upper right, Lower right), Double Staple (Left, Top), Saddle Stitch Stapling

Scan Specifications

Functionality

Store the scanned document in the target cloud service or send it as an email attachment

Supported File Formats

TIFF, **PDF**, PDF (Compact), PDF/A
PDF, PDF (Compact), and PDF/A become searchable PDF (with OCR text)⁶

Color Options

Automatic, Color, Grayscale, Black-and-white

Scan Resolutions (dpi)

TIFF: 100 x 100/150 x 150/200 x 100/200 x 200/200 x 400/**300 x 300**
PDF: **300 x 300**/600 x 600
PDF (Compact): **300 x 300**
PDF/A: **300 x 300**/600 x 600

Image Options

Text, Image, **Text/Image**, Photo, Map, Text/Photo/Map
Image options depend on model

Duplex Options

Simplex, Duplex long edge, Duplex short edge

File Naming Options

Enter up to 255 characters. All characters are allowed except: \ / : * ? " < > |

Default: Scan_{Email address before@}_{Month} {Day} {Year (4 digits)} {Hour} {Minute} {Second}

Duplicate File Name Options

Add a unique number, Abort, Overwrite

Density

0~10

Default: **5**

Scan Size Options

Auto, Manual, Different Size Originals

Supported Cloud Services

Box™, Dropbox, Google Drive™, OneDrive™, OneDrive for Business™, SharePoint Online™, Microsoft Teams™

Email Attachment Limit

20 MB

* Blue = default value

¹ Cloud Connector is available for third-generation imageRUNNER ADVANCE, imageRUNNER ADVANCE DX, imagePRESS Lite, and the following imagePRESS models: imagePRESS V900, imagePRESS V800, imagePRESS V700.

² Subscription to a third-party cloud service required. Subject to third-party cloud service provider's terms and conditions.

Neither Canon Inc. nor Canon U.S.A., Inc. represents or warrant any third-party product or feature referenced hereunder.

³ Requires one Cloud Connector term license per destination per device (each term license sold separately), Internet connection, email service account, PC or mobile device, an account with one of the compatible cloud services (if connecting to one of the available Cloud Connector cloud destinations), and a compatible Canon MFP.

⁴ Excel data has limited printing compatibility with certain paper sizes, such as Oficio and Foolscap; attempting to print Excel data on an incompatible paper size will result in Letter-sized output.

⁵ Stapling options vary depending on finisher capabilities.

⁶ If there is no license for searchable PDF, it does not come with OCR text.



Canon

usa.canon.com/business

Cloud Connector is supported by third-generation imageRUNNER ADVANCE, imageRUNNER ADVANCE DX, imagePRESS Lite, and select imagePRESS models. Subscription to a third-party cloud service required. Subject to third-party cloud service provider's terms and conditions. Canon and imageRUNNER are registered trademarks of Canon Inc. in the United States and may also be registered trademarks or trademarks in other countries. Google Drive is a trademark of Google LLC. "Dropbox" is a trademark or registered trademark of Dropbox, Inc. in the United States. Box® is a registered trademark of Box, Inc., and/or its affiliates in the United States and other countries. Microsoft Teams, OneDrive, OneDrive for Business, and SharePoint Online are either registered trademarks or trademarks of Microsoft Corporation in the United States and other countries. All other referenced product names and marks are trademarks of their respective owners. Specifications and availability subject to change without notice. Not responsible for typographical errors. Neither Canon Inc. nor Canon U.S.A., Inc. represent or warrant any third-party product or feature referenced hereunder.

©2025 Canon U.S.A., Inc. All rights reserved.

01/25-24-2324-12255