



imageWARE
Enterprise Management Console
Version 4

Centralize Management of All Address Books

The Address Book Management (ABM) feature for imageWARE Enterprise Management Console lets you create address books for distribution to, and retrieval from, all supported imageRUNNER or imageRUNNER ADVANCE systems on your network.

Advantages of ABM:

- Centrally manage all imageRUNNER/imageRUNNER ADVANCE system address books to efficiently organize and control all address information in one location, thereby saving time and increasing productivity.
- Creating and deploying address books to multiple imageRUNNER/imageRUNNER ADVANCE systems eliminates the need to manually input and duplicate the same address book on each device.
- Retrieve multiple address books from any imageRUNNER/imageRUNNER ADVANCE system, then edit and deploy all to other imageRUNNER devices. This avoids having to edit each one individually before distribution.

SYSTEM REQUIREMENTS

- The Address Book Management feature must be used with imageWARE Enterprise Management Console and conform to the same system requirements.

Address Book Management Feature Workflow

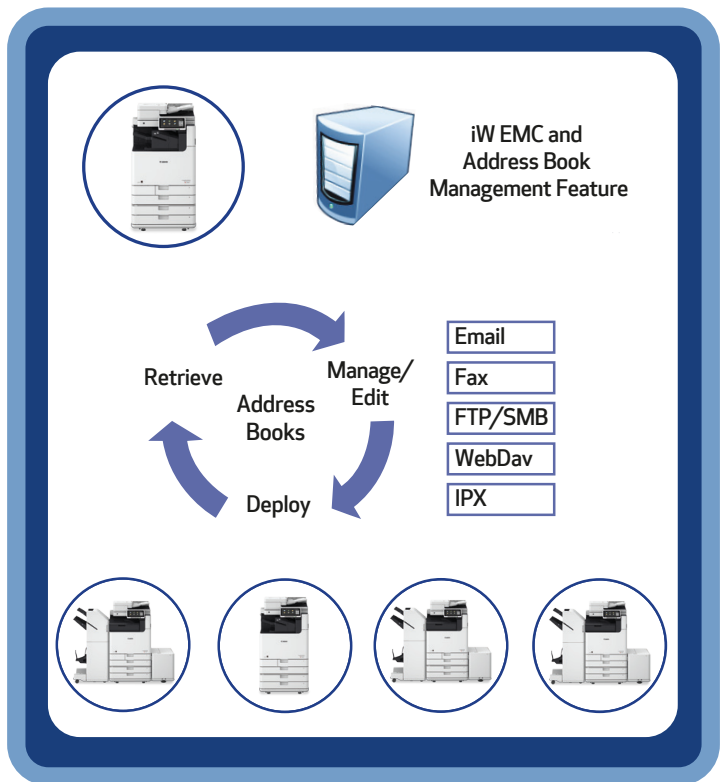

**For more information about imageWARE Enterprise Management Console
Address Book Management contact your local Canon Authorized Dealer.**

 USA.CANON.COM/SOFTWARE



Canon and imageRUNNER are registered trademarks of Canon Inc. in the United States and may also be registered trademarks or trademarks in other countries. imageWARE is a registered trademark of Canon U.S.A., Inc. in the United States and is a trademark of Canon Inc. in certain other countries. All other referenced product names and marks are trademarks of their respective owners. Some items may not be available at this time; please check for availability. Specifications and availability subject to change without notice. Not responsible for typographical errors.
©2021 Canon U.S.A., Inc. All rights reserved.